

STATE OF KANSAS
STATE CORPORATION COMMISSION

WELL PLUGGING RECORD

Give All Information Completely
Make Required Affidavit
Mail or Deliver Report to:
Conservation Division
State Corporation Commission
800 Bittling Building
Wichita, Kansas

Graham County. Sec. 33 Twp. 9S Rge. (E) 21 (W)
Location as "NE/CNW $\frac{1}{4}$ SW $\frac{1}{4}$ " or footage from lines SE, SE, SE
Lease Owner Jones, Shelburne & Farmer, Inc.
Lease Name Huston Well No. 1
Office Address Russell, Kansas
Character of Well (completed as Oil, Gas or Dry Hole) Dry
Date well completed 1-20 1952
Application for plugging filed 1-20 1952
Application for plugging approved 1-20 1952
Plugging commenced 1-20 1952
Plugging completed 1-20 1952
Reason for abandonment of well or producing formation Dry

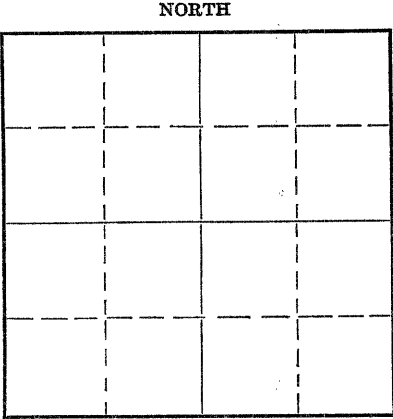

Locate well correctly on above
Section Plat

If a producing well is abandoned, date of last production Never Produced 19
Was permission obtained from the Conservation Division or its agents before plugging was commenced? Yes

Name of Conservation Agent who supervised plugging of this well Eldon Petty
Producing formation Depth to top Bottom Total Depth of Well 3926 Feet
Show depth and thickness of all water, oil and gas formations.

OIL, GAS OR WATER RECORDS

CASING RECORD

Formation	Content	From	To	Size	Put In	Pulled Out
				8 5/8"	165	None

Describe in detail the manner in which the well was plugged, indicating where the mud fluid was placed and the method or methods used in introducing it into the hole. If cement or other plugs were used, state the character of same and depth placed, from feet to feet for each plug set.

1. Filled hole with heavy mud.
2. Pushed plug to 160'.
3. Dumped 1/2 sk hulls on top of plug.
4. Mixed 15 sks cement and dumped on top of hulls.
5. Pushed plug to 40'.
6. Dumped 1/2 sk hulls on top of plug.
7. Mixed 10 sks cement and filled hole with same.

1/28/52

(If additional description is necessary, use BACK of this sheet)

Correspondence regarding this well should be addressed to Jones, Shelburne & Farmer, Inc.
Address Russell, Kansas

STATE OF Kansas, COUNTY OF Russell, ss.
John O. Farmer, Vice-President (employee of owner) or (owner or operator) of the above-described well,
being first duly sworn on oath, says: That I have knowledge of the facts, statements, and matters herein contained and the log of the above-described well as filed and that the same are true and correct. So help me God.

(Signature) John O. Farmer
Russell, Kansas
(Address)

SUBSCRIBED AND SWORN to before me this 25 th day of January, 1952.

Jerry J. Malcolm
Notary Public.

My commission expires October 24, 1955.

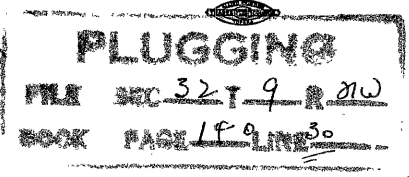

OPERATOR Jones, Shelburne & Farmer, Inc.ADDRESS Russell, Kansas

15-065-02575-00-00

FORMATION RECORD

Give detailed description and thickness of all formations drilled through, contents of sand, whether dry, water, oil or gas.

Formation	Top	Bottom	Formation	Top	Bottom
Shale	0	510	TOPS:		
Shale & Shells	510	820	Elevation - 2293 R.B.		
Sand	820	970	Haebner shale - 3510		
Shale & Shells	970	1765	Toronto - 3534		
Anhydrite	1765	1800	Lansing-Kansas City-3551		
Shale & Shells	1800	2365	Base of K.C. - 3773		
Lime & Shale	2365	2670	Marmaton-3816		
Shale & Lime	2670	2815	Conglomerate-3908		
Lime & Shale	2815	3555	T.D.-3926 R.D.		
Lime	3555	3815			
Lime & Shale	3815	3855			
Shale & Lime	3855	3880			
Lime & Shale	3880	3926			
T.D.	3926				

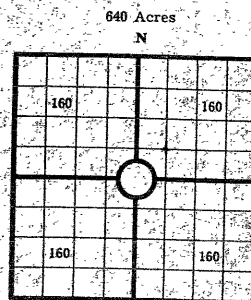

COUNTY Graham SEC. 33 TWP. 9S RGE 21W
 COMPANY OPERATING Jones, Shelburne & Farmer, Inc.
 OFFICE ADDRESS Russell, Kansas
 FARM NAME Huston WELL NO. 1
 DRILLING STARTED 12-28-1951 DRILLING FINISHED 1-21-1952
 DATE OF FIRST PRODUCTION _____ COMPLETED _____
 WELL LOCATED SE 1/4 SE 1/4 SE 1/4 North of South
 Line and _____ ft. East of West Line of Quarter Section
 Elevation (Relative to sea level) DERRICK FLOOR 2290 GROUND _____
 CHARACTER OF WELL (Oil, gas or dryhole) Dry

OIL OR GAS SANDS OR ZONES

Name	From	To	Name	From	To
1			4		
2			5		
3			6		

Perforating Record If Any

Shot Record

Formation	From	To	No. of Shots	Formation	From	To	Size of Shot

CASING RECORD

Amount Set						Amount Pulled			Packer Record		
Size	Wt.	Thds.	Make	Ft.	In.	Ft.	In.	Size	Length	Depth Set	Make
5/8"	24	8	LW	165	0			None			

Liner Record: Amount _____ Kind _____ Top _____ Bottom _____

CEMENTING AND MUDDING

Size	Amount Set		Sacks Cement	Chemical		Method of Cementing	Amount	Mudding Method	Results (See Note)
	Ft.	In.		Gal.	Make				
5/8"	165		100						

Note: What method was used to protect sands if outer strings were pulled? _____

NOTE: Were bottom hole plugs used? _____ If so, state kind, depth set and results obtained _____

TOOLS USED

Rotary Tools were used from _____ feet to _____ Cable tools were used from _____ feet to _____ feet, and from _____ feet to _____ feet, and from _____ feet to _____ feet.

Type Rig _____

INITIAL PRODUCTION TEST

Describe initial test: whether by flow through tubing or casing or by pumping _____

Amount of Oil Production _____ bbls. Size of choke, if any _____ Length of test _____ Water

Production _____ bbls. Gravity of oil _____ Type of Pump if pump is used, describe _____

I, the undersigned, being first duly sworn upon oath, state that this well record is true, correct and complete according to the records of this office and to the best of my knowledge and belief.

John Farmer
 Name and title of representative of company
 Vice-President

Subscribed and sworn to before me this 25th day of January, 1952My Commission expires October 24, 1955

Notary Public

PLUGGING
 WELL NO. 3219 R21W
 BOOK PAGE 140, LINE 30

RGE. 21W
 TWP. 9S
 SEC. 33
 COUNTY Graham
 WELL NO. 1
 COUNTY Graham
 FARM NAME Huston