

STATE OF KANSAS
STATE CORPORATION COMMISSION

Form CP-4

Give All Information Completely
Make Required Affidavit
Mail or Deliver Report to:
Conservation Division
State Corporation Commission
212 No. Market
Wichita, Kansas 67202

WELL PLUGGING RECORD

GRAHAM County, Sec. 10 Twp. 9s Rge. 22 (E) (W)

Location as "NE/CNW/SW" or footage from lines APP. NE SE

Lease Owner PETROLEUM, INC.,

Lease Name VAN LOENEN 'B' Well No. 1

Office Address R.R. #2, GREAT BEND, KANSAS

Character of Well (completed as Oil, Gas or Dry Hole) DRY HOLE

Date well completed OCTOBER 1 19 71

Application for plugging filed OCTOBER 1 19 71

Application for plugging approved OCTOBER 1 19 71

Plugging commenced OCTOBER 1 19 71

Plugging completed OCTOBER 1 19 71

Reason for abandonment of well or producing formation NO COMMERCIAL ZONE

If a producing well is abandoned, date of last production NONE 19

Was permission obtained from the Conservation Division or its agents before plugging was commenced? YES

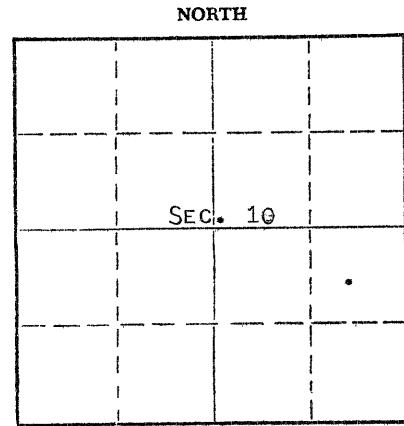

Locate well correctly on above Section Plat

Name of Conservation Agent who supervised plugging of this well W. L. NICHOLS

Producing formation _____ Depth to top _____ Bottom _____ Total Depth of Well 3560 Feet

Show depth and thickness of all water, oil and gas formations.

OIL, GAS OR WATER RECORDS

CASING RECORD

FORMATION	CONTENT	FROM	TO	SIZE	PUT IN	PULLED OUT
				8-5/8"	205'	NONE

Describe in detail the manner in which the well was plugged, indicating where the mud fluid was placed and the method or methods used in introducing it into the hole. If cement or other plugs were used, state the character of same and depth placed, from _____ feet to _____ feet for each plug set.

HEAVY MUD TO 950', FOLLOWED WITH 100 SACKS CEMENT. HEAVY MUD TO 215', FOLLOWED WITH 20 SACKS CEMENT. HEAVY MUD TO 40', WOODEN PLUG, FOLLOWED WITH 10 SACKS CEMENT ON TOP OF PLUG TO BASE OF WELL CELLAR.

RECEIVED
STATE CORPORATION COMMISSION
OCT 8 1971
CONSERVATION DIVISION
Wichita, Kansas

(If additional description is necessary, use BACK of this sheet)

Name of Plugging Contractor GARVEY DRILLING COMPANY

Address R.R. #2, GREAT BEND, KANSAS

STATE OF KANSAS, COUNTY OF BARTON, ss.

MONTE CHADD (employee of owner) or (owner or operator) of the above-described well, being first duly sworn on oath, says: That I have knowledge of the facts, statements, and matters herein contained and the log of the above-described well as filed and that the same are true and correct. So help me God. MONTE CHADD, DIST. PROD. SUPT.

(Signature) Monte Chadd

R.R. #2, GREAT BEND, KANSAS

(Address)

Subscribed and sworn to before me this 7 day of OCTOBER, 19 71

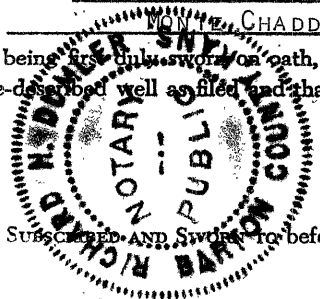

Richard H. Dunks
Notary Public.

My commission expires MAY 28, 1973

WELL LOG

COMPANY Petroleum, Inc.
FARM Van Loenen 'B' NO. 1
TOTAL DEPTH 3560'
COMM. 9-27-71 COMP. 10-1-71
CONTRACTOR Garvey Drilling Company

SEC. 10 T. 9S R. 22W

LOC. App. NE SE

COUNTY Graham, Kansas

CASING
8 5/8" @ 205' w/175sx

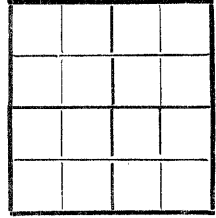

ELEVATION 2269 DF

PRODUCTION D & A

FIGURES INDICATE BOTTOM OF FORMATIONS

70' Clay & Post Rock
207' Shale
1115' Sand & Shale
1802' Shale & Sand
1830' Anhydrite
2246' Shale & Shells
2800' Shale & Lime
3070' Lime & Shale
3560' Lime & Shale
3560' RTD

RECEIVED
STATE CORPORATION COMMISSION
OCT 8 1971
CONSERVATION DIVISION
Wichita, Kansas

State of Kansas }
County of Barton } ss

I, Charlene Marker of Garvey Drilling Company
upon oath state the above and foregoing is a true and correct copy of the log of the Van Loenen 'B' #1 well.

Subscribed and sworn to before me this 5th day of October 19 71

My Commission Expires: July 8, 1974

Charlene Marker
Sumner A. Y. [Signature]
NOTARY PUBLIC