

STATE OF KANSAS
STATE CORPORATION COMMISSION

Form CP-4

Give All Information Completely
Make Required Affidavit
Mail or Deliver Report to:
Conservation Division
State Corporation Commission
212 No. Market
Wichita, Kansas

WELL PLUGGING RECORD

GRAHAM County, Sec. 29 Twp. 9S Rge 2E (X) (W)

Location as "NE/CNW%SW%" or footage from lines APP. SW NW

Lease Owner PETROLEUM, INC.,

Lease Name MANAUGH "E" Well No. 2

Office Address R.R. #2, GREAT BEND, KANSAS

Character of Well (completed as Oil, Gas or Dry Hole) DRY HOLE

Date well completed MAY 29, 1966

Application for plugging filed MAY 29, 1966

Application for plugging approved MAY 29, 19 66

Plugging commenced MAY 29, 19 66

Plugging completed MAY 29, 19 66

Reason for abandonment of well or producing formation NO PRODUCIBLE ZONE

If a producing well is abandoned, date of last production NONE 19

Was permission obtained from the Conservation Division or its agents before plugging was commenced? YES

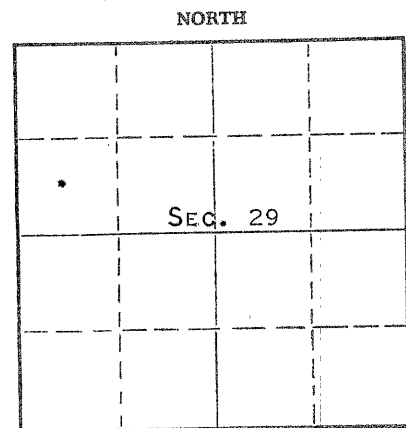

Locate well correctly on above Section Plat

Name of Conservation Agent who supervised plugging of this well W. L. NICHOLS

Producing formation _____ Depth to top _____ Bottom _____ Total Depth of Well 3890 Feet

Show depth and thickness of all water, oil and gas formations.

OIL, GAS OR WATER RECORDS

CASING RECORD

FORMATION	CONTENT	FROM	TO	SIZE	PUT IN	PULLED OUT
				8-5/8"	213	NONE

Describe in detail the manner in which the well was plugged, indicating where the mud fluid was placed and the method or methods used in introducing it into the hole. If cement or other plugs were used, state the character of same and depth placed, from _____ feet to _____ feet for each plug set.

MUDDERED UP WITH HEAVY MUD TO 540', FOLLOWED WITH 20 SACKS CEMENT THRU DRILL PIPE. MUDDERED UP WITH HEAVY MUD TO 210', FOLLOWED WITH 20 SACKS CEMENT THRU DRILL PIPE. MUDDERED UP WITH HEAVY MUD TO 40', FOLLOWED BY WOODEN PLUG, PLACED 1/2 SACK HULLS AND 10 SACKS OF CEMENT ON TOP OF PLUG TO BASE OF WELL CELLAR.

RECEIVED
STATE CORPORATION COMMISSION

JUN - 6 1966
6-6-66

(If additional description is necessary, use BACK of this sheet)

Name of Plugging Contractor GARVEY DRILLING COMPANY

Address R.R. #2, GREAT BEND, KANSAS

STATE OF KANSAS, COUNTY OF BARTON, ss.
MONTE CHADD (employee of owner) or (~~owner~~) of the above-described well, being first duly sworn on oath, says: That I have knowledge of the facts, statements, and matters herein contained and the log of the above-described well as filed and that the same are true and correct. So help me God.

(Signature) *Monte Chadd*

R.R. #2, GREAT BEND, KANSAS
(Address)

SUBSCRIBED AND SWORN TO before me this 3 day of JUNE, 19 66

Richard H. Dummer
Notary Public.

My commission expires MAY 28, 1969

WELL LOG

COMPANY Petroleum, Inc.

SEC. 29 T. 9S R. 22W

FARM Manaugh

NO. E-2

LOC. App SW NW

TOTAL DEPTH 3890'

COUNTY Graham

COMM. 5-23-66

COMP. 5-29-66

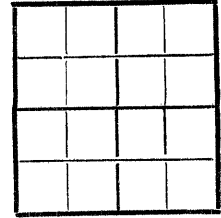

CONTRACTOR Garvey Drilling Company

CASING

8 5/8" @ 213' w/175 sx

ELEVATION 2402'

PRODUCTION D & A

FIGURES INDICATE BOTTOM OF FORMATIONS

150' Sand
 390' Shale & Shells
 565' Sand & Shale
 1260' Sand & Shells
 1285' Sand
 1460' Shale & Shells
 1690' Sand
 1940' Shale & Shells
 1975' Anhydrite
 2250' Shale & Lime
 2320' Lime
 2785' Lime & Shale
 3175' Shale & Lime
 3600' Lime & Shale
 3770' Lime
 3890' Lime & Shale
 3890' RTD

RECEIVED
STATE CORPORATION COMMISSION

JUN - 6 1966

RECORDED BY [unclear]
INDEXED [unclear]

State of Kansas }
County of Barton } ss

I, James R. Rodgers of Garvey Drilling Company

upon oath state the above and foregoing is a true and correct copy of the log of the Manaugh E-2 well.

James R. Rodgers

Subscribed and sworn to before me this 2nd day of June 19 66

My Commission Expires: November 5, 1969

Richard Doy
NOTARY PUBLIC