

15-065-30050-00-00

STATE OF KANSAS
STATE CORPORATION COMMISSION

Form CP-4

Give All Information Completely
Make Required Affidavit
Mail or Deliver Report to:
Conservation Division
State Corporation Commission
211 No. Broadway
Wichita, Kansas

WELL PLUGGING RECORD

GRAHAM County. Sec. 13 Twp. 10S Rge. 21W (X) X (W)

Location as "NE/CNW/SW" or footage from lines SE NE NW

Lease Owner PETROLEUM, INC.

Lease Name CLARY Well No. 2

Office Address ROUTE #2, GREAT BEND, KANSAS

Character of Well (completed as Oil, Gas or Dry Hole) DRY HOLE

Date well completed MAY 16 19 65

Application for plugging filed MAY 16 19 65

Application for plugging approved MAY 16 19 65

Plugging commenced MAY 16 19 65

Plugging completed MAY 16 19 65

Reason for abandonment of well or producing formation NO PRODUCIBLE ZONES

If a producing well is abandoned, date of last production NONE 19

Was permission obtained from the Conservation Division or its agents before plugging was commenced? YES

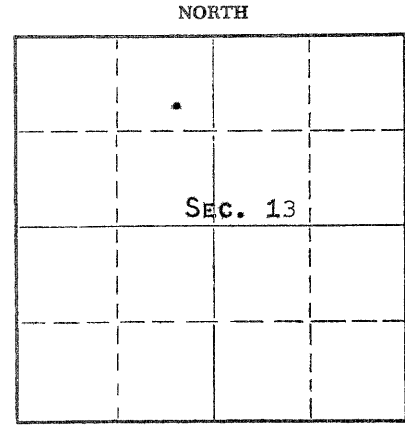

Locate well correctly on above Section Plat

Name of Conservation Agent who supervised plugging of this well W. L. NICHOLS

Producing formation - Depth to top - Bottom - Total Depth of Well 3903 Feet

Show depth and thickness of all water, oil and gas formations.

OIL, GAS OR WATER RECORDS

CASING RECORD

FORMATION	CONTENT	FROM	TO	SIZE	PUT IN	PULLED OUT
				8-5/8"	215'	NONE

Describe in detail the manner in which the well was plugged, indicating where the mud fluid was placed and the method or methods used in introducing it into the hole. If cement or other plugs were used, state the character of same and depth placed, from feet to feet for each plug set.

MUDDED UP WITH HEAVY MUD TO 540', FOLLOWED BY WOODEN PLUG, PLACED 20 SACKS CEMENT THROUGH DRILL PIPE ON TO PLUG, MUDDED UP WITH HEAVY MUD TO 40', FOLLOWED BY WOODEN PLUG, 1/2 SACK HULLS AND 26 SACKS CEMENT TO BASE OF WELL CELLAR. PLUGGED RAT HOLE WITH 2 SACKS CEMENT.

RECEIVED
STATE CORPORATION COMMISSION

JUN 7 1965
06-07-1965
CONSERVATION DIVISION
Wichita, Kansas

(If additional description is necessary, use BACK of this sheet)

Name of Plugging Contractor GARVEY DRILLING COMPANY

Address ROUTE 2, GREAT BEND, KANSAS

STATE OF KANSAS COUNTY OF BARTON, ss.

MONTE CHADD (employee of owner) or (owner or operator) of the above-described well, being first duly sworn on oath, says: That I have knowledge of the facts, statements, and matters herein contained and the log of the above-described well as filed and that the same are true and correct. So help me God. MONTE CHADD, DIST. PROD. SUPT.

(Signature) *Monte Chadd*

ROUTE #2, GREAT BEND, KANSAS (Address)

SUBSCRIBED AND SWORN TO before me this 2ND day of JUNE, 19 65

My commission expires APRIL 14, 1967

Arthur J. Wiles
Notary Public.

WELL LOG

15-065-30050-00-00

COMPANY Petroleum, Inc.

SEC. 13 T. 10S R. 21W

FARM Clary

NO. 2

LOC. SE NE NW

TOTAL DEPTH 3903'

COUNTY Graham Co., Kansas

COMM. 5-9-65

COMP. 5-16-65

CONTRACTOR Garvey Drilling Company

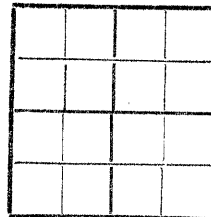

CASING 8 5/8" @ 215' w/175 sx

ELEVATION 2276' DF

PRODUCTION D & A

FIGURES INDICATE BOTTOM OF FORMATIONS

- 25' Clay
- 85' Shale and Sand
- 217' Shale
- 775' Shale and Sand
- 1240' Shale and Sand Streaks
- 1435' Sand
- 1750' Shale and Red Bed
- 1800' Anhydrite
- 1875' Shale and Shells
- 2220' Shale
- 2300' Lime and Shale
- 2665' Shale and Lime
- 3308' Lime and Shale
- 3515' Shale and Lime
- 3519' Heebner
- 3860' Lime
- 3894' Chert and Shale
- 3903' Lime
- 3903' RTD

RECEIVED
STATE CORPORATION COMMISSION

JUN 7 1965
06-07-1965
CONSERVATION DIVISION
Wichita, Kansas

State of Kansas }
County of Barton } SS

I, Sam N. Stephens of Garvey Drilling Company
upon oath state the above and foregoing is a true and correct copy of the log of the Clary #2 well.

Sam N. Stephens

Subscribed and sworn to before me this 1st day of June 19 65

My Commission Expires: April 14th, 1967

Arthur D. Wiley
NOTARY PUBLIC