

Give All Information Completely
Make Required Affidavit
Mail or Deliver Report to:
Conservation Division
State Corporation Commission
800 Biting Building
Wichita, Kansas

WELL PLUGGING RECORD

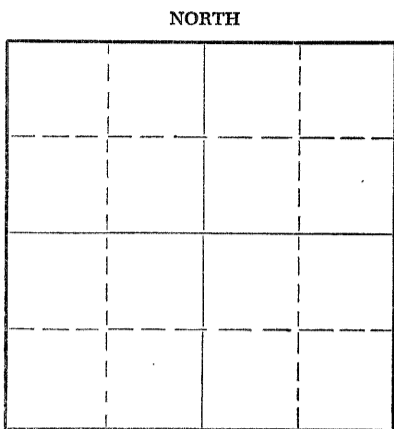

Locate well correctly on above Section Plat

Graham County. Sec. 13 Twp. 14S Rge. (E) 21 (W)
Location as "NE/CNW/SW" or footage from lines SW SW NE
Lease Owner Jones, Shelburne & Farmer, Inc.
Lease Name Holzhauser Well No. 2
Office Address Russell, Kansas
Character of Well (completed as Oil, Gas or Dry Hole) Dry
Date well completed 1-15 19 53
Application for plugging filed 1-15 19 53
Application for plugging approved 1-15 19 53
Plugging commenced 1-15 19 53
Plugging completed 1-15 19 53
Reason for abandonment of well or producing formation Dry

If a producing well is abandoned, date of last production Never produced 19
Was permission obtained from the Conservation Division or its agents before plugging was commenced? yes

Name of Conservation Agent who supervised plugging of this well Elden Petty
Producing formation _____ Depth to top _____ Bottom _____ Total Depth of Well 3872 Feet
Show depth and thickness of all water, oil and gas formations.

OIL, GAS OR WATER RECORDS

CASING RECORD

FORMATION	CONTENT	FROM	TO	SIZE	PUT IN	PULLED OUT
				8 5/8	165	None

Describe in detail the manner in which the well was plugged, indicating where the mud fluid was placed and the method or methods used in introducing it into the hole. If cement or other plugs were used, state the character of same and depth placed, from _____ feet to _____ feet for each plug set.

1. Filled hole with heavy mud
2. Pushed plug to 160'
3. Dumped 1/2 sack hulls on top of plug
4. Mixed 15 sacks cement and dumped on top of hulls
5. Filled hole to top
6. Pushed plug to 40'
7. Dumped in 1/2 sack hulls
8. Mixed 10 sacks cement and filled hole to top with same

RECEIVED
STATE CORPORATION COMMISSION
JAN 20 1953

(If additional description is necessary, use BACK of this sheet)
Name of Plugging Contractor Jones, Shelburne & Farmer, Inc.
Address Russell, Kansas

STATE OF _____, COUNTY OF _____, ss.

(employee of owner) or (owner or operator) of the above-described well, being first duly sworn on oath, says: That I have knowledge of the facts, statements, and matters herein contained and the log of the above-described well as filed and that the same are true and correct. So help me God.

(Signature) John W. Farmer
(Address) _____

SUBSCRIBED AND SWORN to before me this 17th day of January, 19 53
Donnie Berryhill
Notary Public.

My commission expires April 23, 1956

PLUGGING
FILE SEC 13 T 10 R 21 S
BOOK PAGE 23 LINE 42

OPERATOR Jones, Shelburne & Farmer, Inc.

15-065-02595-00-00

FORMATION RECORD

ADDRESS Russell, Kansas

Give detailed description and thickness of all formations drilled through, contents of sand, whether dry, water, oil or gas.

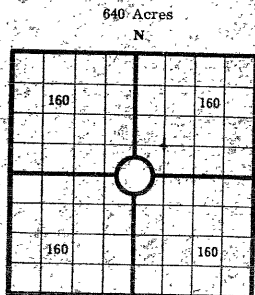

COUNTY Graban SEC 13 TWP 14S RGE 21
 COMPANY OPERATING Jones, Shelburne & Farmer, Inc.
 OFFICE ADDRESS Russell, Kansas
 FARM NAME Shelburne WELL NO. 2
 DRILLING STARTED 19 53 DRILLING FINISHED 19 53
 DATE OF FIRST PRODUCTION _____ COMPLETED _____
 WELL LOCATED 1/4 1/4 1/4 North of South
 Line and _____ ft. East of West Line of Quarter Section
 Elevation (Relative to sea level) 2277 DERRICK FLOOR _____ GROUND _____
 CHARACTER OF WELL (Oil, gas or dryhole) Dry

Formation	Top	Bottom	Formation	Top	Bottom
Shale & sand	0	160			
Shale & shells	160	1200			
Shale shells & sand	1200	1425			
Shale & shells	1425	1750			
Anhydrite	1750	1775			
Shale & shells	1775	2360			
lime & shale	2360	3590			
lime	3590	3725			
lime & shale	3725	3872			

OIL OR GAS SANDS OR ZONES

Name	From	To	Name	From	To

Perforating Record if Any

Shot Record

Formation	From	To	No. of Shots	Formation	From	To	Size of Shot

CASING RECORD

Amount Set						Amount Pulled		Packer Record	
Size	Wt.	Thds.	Make	Ft.	In.	Size	Length	Depth Set	Make
8 5/8	24	1	301	165					

Liner Record: Amount _____ Kind _____ Top _____ Bottom _____

CEMENTING AND MUDDING

Size	Amount Set		Sacks Cement	Chemical		Method of Cementing	Amount	Mudding Method	Results (See Note)
	Ft.	In.		Gal.	Make				
8 5/8	165	100							

Note: What method was used to protect sands if outer strings were pulled?

NOTE: Were bottom hole plugs used? If so, state kind, depth set and results obtained.

TOOLS USED

Rotary Tools were used from _____ feet to _____ Cable tools were used from _____ feet to _____ feet, and from _____ feet to _____ feet, and from _____ feet to _____ feet to _____

Type Rig _____

INITIAL PRODUCTION TEST

Describe initial test: whether by flow through tubing or casing or by pumping _____

Amount of Oil Production _____ bbls. Size of choke, if any _____ Length of test _____ Water Production _____ bbls. Gravity of oil _____ Type of Pump if pump is used, describe _____

7081

Elevation 2277
 Hookman 3506
 Toronto 3529
 Lansing 3549
 Frank 3855
 Total Depth 3872
 U & A

RELEASED
 WHITE OIL COMPANY
 FEB 4 1953
 CONSERVATION DIVISION
 Wichita, Kansas

PLUGGING
 FILE SEC 13 T 14 R 2124
 2701 11 13 1953

I, the undersigned, being first duly sworn upon oath, state that this well record is true, correct and complete according to the records of this office and to the best of my knowledge and belief.

John W. Farmer
 Vice-President Name and title of representative of company

Subscribed and sworn to before me this 17th day of January, 1953
 My Commission expires April 23, 1956
Bonnie Perryhill
 Notary Public

SEC 13 TWP 14S RGE 21W
 COUNTY Graban
 WELL NO. 2