

Give All Information Completely  
Make Required Affidavit  
Mail or Deliver Report to:  
Conservation Division  
State Corporation Commission  
211 No. Broadway  
Wichita, Kansas

WELL PLUGGING RECORD

GRAHAM County, Sec. 30 Twp. 9S Rge. 22 (E) (W)

Location as "NE/CNW/SW" or footage from lines. APP. NW SW

Lease Owner PETROLEUM, INC.,

Lease Name BLAKELY Well No. 1

Office Address ROUTE #2, GREAT BEND, KANSAS

Character of Well (completed as Oil, Gas or Dry Hole) DRY HOLE

Date well completed AUG. 21 1965

Application for plugging filed AUG. 21 1965

Application for plugging approved AUG. 21 1965

Plugging commenced AUG. 21 1965

Plugging completed AUG. 21 1965

Reason for abandonment of well or producing formation NO PRODUCIBLE ZONE

If a producing well is abandoned, date of last production NONE 19

Was permission obtained from the Conservation Division or its agents before plugging was commenced? YES

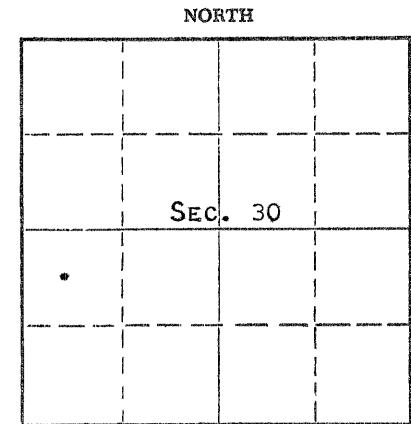

Locate well correctly on above Section Plat

Name of Conservation Agent who supervised plugging of this well W. L. NICHOLS

Producing formation Depth to top Bottom Total Depth of Well 3915' Feet

Show depth and thickness of all water, oil and gas formations.

OIL, GAS OR WATER RECORDS

CASING RECORD

FORMATION	CONTENT	FROM	TO	SIZE	PUT IN	PULLED OUT
				8-5/8"	226'	NONE

Describe in detail the manner in which the well was plugged, indicating where the mud fluid was placed and the method or methods used in introducing it into the hole. If cement or other plugs were used, state the character of same and depth placed, from feet to feet for each plug set.

MUDDED UP WITH HEAVY MUD TO 550', FOLLOWED BY WOODEN PLUG, PLACED 20 SACKS CEMENT THROUGH DRILL PIPE ON TOP OF PLUG. MUDDED UP WITH HEAVY MUD TO 210', FOLLOWED BY WOODEN PLUG, PLACED 1/4 SACK HULLS AND 20 SACKS CEMENT THROUGH DRILL PIPE ON TOP OF PLUG. MUDDED UP WITH HEAVY MUD TO 40', FOLLOWED BY WOODEN PLUG, PLACED 10 SACKS CEMENT ON TOP OF PLUG TO BASE OF WELL CELLAR.

RECEIVED  
STATE CORPORATION COMMISSION  
8/31/65  
AUG 31 1965  
CONSERVATION DIVISION  
Wichita, Kansas

(If additional description is necessary, use BACK of this sheet)

Name of Plugging Contractor GARVEY DRILLING Co.

Address R.R. #2, GREAT BEND, KANSAS

STATE OF KANSAS, COUNTY OF BARTON, ss.

MONTE CHADD (employee of owner) or (owner) of the above-described

well, being first duly sworn on oath, says: That I have knowledge of the facts, statements, and matters herein contained and the log of the above-described well as filed and that the same are true and correct. So help me God. MONTE CHADD, DIST. PROD. SUPT.

(Signature)

R.R. #2, GREAT BEND, KANSAS

(Address)

SUBSCRIBED AND SWORN TO before me this 30 day of AUGUST, 19 65

My commission expires MAY 28, 1969

Notary Public.

Richard W. Dumber

# WELL LOG

15-065-30067-00-00

COMPANY Petroleum, Inc.

SEC. 30 T. 9S R. 22W

FARM Blakely NO. 1

LOC. App NW SW

TOTAL DEPTH 3915'

COUNTY Graham

COMM. 8-13-65 COMP. 8-21-65

CONTRACTOR Garvey Drilling Company

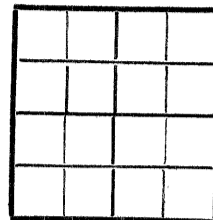

CASING 8 5/8" @ 226' w/175 sx

ELEVATION 2411' KB

PRODUCTION D & A

FIGURES INDICATE BOTTOM OF FORMATIONS

- 1434' Shale
- 1480' Red Bed and Shale
- 1710' Sand
- 1959' Red Bed
- 1995' Anhydrite
- 2185' Shale and Shells
- 2650' Shale
- 3010' Shale and Lime
- 3145' Lime
- 3340' Shale and Lime
- 3520' Lime and Shale
- 3915' Lime
- 3915' RTD

**RECEIVED**  
STATE CORPORATION COMMISSION

AUG 31 1965

CONSERVATION DIVISION  
Wichita, Kansas

State of Kansas  
County of Barton } ss

I, Sam N. Stephens of Garvey Drilling Company

upon oath state the above and foregoing is a true and correct copy of the log of the Blakely #1 well.

Sam N. Stephens

Subscribed and sworn to before me this 26th day of August 19 65

My Commission Expires: May 28, 1969

Richard W. Dunks  
NOTARY PUBLIC