

15-065-00979-00-00

STATE OF KANSAS  
STATE CORPORATION COMMISSION

WELL PLUGGING RECORD

Give All Information Completely  
Make Required Affidavit  
Mail or Deliver Report to:  
Conservation Division  
State Corporation Commission  
211 No. Broadway  
Wichita, Kansas

GRAHAM County. Sec. 30 Twp. 9 Rge. 22 (E) W (W)

Location as "NE/CNW&SW&" or footage from lines NW NE SE

Lease Owner PETROLEUM, INC.

Lease Name MANAUGH "C" Well No. 1

Office Address ROUTE 2, GREAT BEND, KANSAS

Character of Well (completed as Oil, Gas or Dry Hole) DRY HOLE

Date well completed December 13, 19 57

Application for plugging filed December 14, 19 57

Application for plugging approved December 16, 19 57

Plugging commenced December 13, 19 57

Plugging completed December 13, 19 57

Reason for abandonment of well or producing formation \_\_\_\_\_

No Producing Zones

If a producing well is abandoned, date of last production None 19 \_\_\_\_\_

Was permission obtained from the Conservation Division or its agents before plugging was commenced? Yes

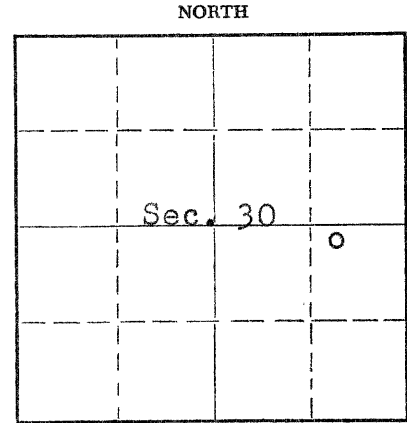

Locate well correctly on above Section Plat

Name of Conservation Agent who supervised plugging of this well Eldon Petty, Box 326, Hays, Kansas

Producing formation \_\_\_\_\_ Depth to top \_\_\_\_\_ Bottom \_\_\_\_\_ Total Depth of Well 4107 Feet

Show depth and thickness of all water, oil and gas formations.

OIL, GAS OR WATER RECORDS

CASING RECORD

FORMATION	CONTENT	FROM	TO	SIZE	PUT IN	PULLED OUT
				8-5/8"	254.43'	None

Describe in detail the manner in which the well was plugged, indicating where the mud fluid was placed and the method or methods used in introducing it into the hole. If cement or other plugs were used, state the character of same and depth placed, from \_\_\_\_\_ feet to \_\_\_\_\_ feet for each plug set.

Mud up with heavy mud to 650' followed by a wooden plug. Placed 20 sacks cement through drill pipe on to plug. Mud up to 240' followed by a wooden plug. Placed 15 sacks cement through drill pipe on to plug. Mud up to 40' followed by wooden plug and 10 sacks cement to base of well cellar.

RECEIVED  
STATE CORPORATION COMMISSION  
12/27/57  
DEC 27 1957  
CONSERVATION DIVISION  
Wichita, Kansas

(If additional description is necessary, use BACK of this sheet)

Name of Plugging Contractor GARVEY DRILLING COMPANY

Address ROUTE 2, GREAT BEND, KANSAS

STATE OF KANSAS, COUNTY OF BARTON, ss.  
Don Searle (employee of owner) or (owner or operator) of the above-described

well, being first duly sworn on oath, says: That I have knowledge of the facts, statements, and matters herein contained and the log of the above-described well as filed and that the same are true and correct. So help me God.

(Signature) Don Searle

Route 2, Great Bend, Kansas  
(Address)

SUBSCRIBED AND SWORN TO before me this 26th day of December, 19 57

Ed J. Brown  
Notary Public.

My commission expires July 11, 1960

PLUGGING  
FILE SEC 30 T 9 R 22  
BOOK PAGE 69 LINE 12

# WELL LOG

15-065-00979-00-00

COMPANY PETROLEUM, INCORPORATED

SEC. 30 T. 9S R. 22W

FARM MANAUGH "C" NO. 1

LOC. NW, NE, SE

TOTAL DEPTH 4107'

COUNTY GRAHAM CO., KANSAS

COMM. December 2, 1957 COMP. December 13, 1957

CONTRACTOR GARVEY DRILLING COMPANY

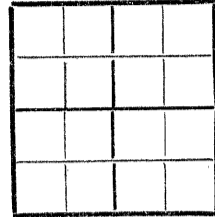

CASING 8 5/8" @ 254.43' W/225 sax.

ELEVATION 2397' DF

PRODUCTION D & A

FIGURES INDICATE BOTTOM OF FORMATIONS

60	Surface clay
92	Sand & clay
210	Clay
660	Shale
1930	Sand & shale
1967	Anhydrite
2370	Shale & shells
3210	Lime & shale
3881	Lime
3978	Lime & shale
4007	Chert
4107	Lime & chert
4107	T. D.

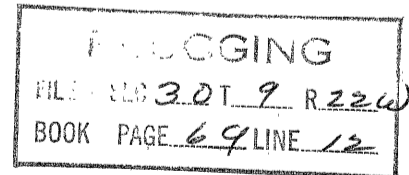

State of KANSAS }  
County of BARTON } ss:

I, VERNE A. MORRIS of GARVEY DRILLING COMPANY

upon oath state that the above and foregoing is a true and correct copy of the log of the #1 Manaugh "C" well

Verne A. Morris

Subscribed and sworn to before me this 26th day of December 19 57

My Commission Expires: July 11, 1960

[Signature]  
NOTARY PUBLIC