

KANSAS

WELL COMPLETION REPORT AND DRILLER'S LOG

API No. 15 — 065 County — 21,485 Number -00-00

S. 21 T. 9 R. 21 E. W
Loc. W/2 NW SE
County Shawnee

Operator DANE G. HANSEN TRUST

Address P.O. Box 187, Logan, KS 67646

Well No. 1 Lease Name Hodierne

Footage Location feet from (N) (S) line feet from (E) (W) line

Principal Contractor C-G Drilling Co., Inc. Geologist Jerry Jespersen

Spud Date 8/31/81 Date Completed 9/4/81 Total Depth 3800' P.B.T.D.

Directional Deviation Oil and/or Gas Purchaser

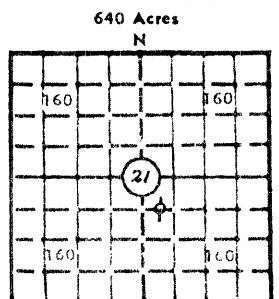

Locate well correctly
Elev.: Gr. 2264
DF 2267 KB 2269

CASING RECORD

Report of all strings set — surface, intermediate, production, etc.

Purpose of string	Size hole drilled	Size casing set (in O.D.)	Weight lbs/ft.	Setting depth	Type cement	Sacks	Type and percent additives
Surface	12 1/4"	8 5/8	20#	229'	Common	200	3% C.C. + 2% Gel

LINER RECORD

PERFORATION RECORD

Top, ft.	Bottom, ft.	Sacks cement	Shots per ft.	Size & type	Depth interval

TUBING RECORD

Size	Setting depth	Packer set at

ACID, FRACTURE, SHOT, CEMENT SQUEEZE RECORD

Amount and kind of material used	Depth interval treated

INITIAL PRODUCTION

Date of first production	Producing method (flowing, pumping, gas lift, etc.)
RATE OF PRODUCTION PER 24 HOURS	Oil bbls. Gas MCF Water Gas-oil ratio bbls. CFPB
Disposition of gas (vented, used on lease or sold)	Producing interval(s)

RECEIVED STATE CORPORATION COMMISSION JAN 22 1982 CONSERVATION DIVISION Wichita, Kansas

RECEIVED STATE CORPORATION COMMISSION 11-30-81 CONSERVATION DIVISION Wichita, Kansas

INSTRUCTIONS: As provided in KCC Rule 82-2-125, within 90 days after completion of a well, one completed copy of this Drillers Log shall be transmitted to the State Geological Survey of Kansas, 4150 Monroe Street, Wichita, Kansas 67209. Copies of this form are available from the Conservation Division, State Corporation Commission, 245 No. Water, Wichita, Kansas 67202. Phone AC 316-522-2206. If confidential custody is desired, please note Rule 82-2-125. Drillers Logs will be on open file in the Oil and Gas Division, State Geological Survey of Kansas, Lawrence, Kansas 66044.

DESIGNATE TYPE OF COMP.: OIL, GAS, DRY HOLE, SWDW, ETC.:

Operator
DANE G. HANSEN TRUST

D&A

Well No.
1

Lease Name
Hodierne

S 21 T 9 R 21 EX
W

WELL LOG

Show all important zones of porosity and contents thereof; cored intervals, and all drill-stem tests, including depth interval tested, cushion used, time tool open, flowing and shut-in pressures, and recoveries.

SHOW GEOLOGICAL MARKERS, LOGS RUN, OR OTHER DESCRIPTIVE INFORMATION.

FORMATION DESCRIPTION, CONTENTS, ETC.	TOP	BOTTOM	NAME	DEPTH
Anhydrite	1728			
Heebner	3440	-1171		
Toronto	3463	-1194		
Lansing	3478	-1209		
Base Kansas City	3697	-1428		
Arbuckle	3795	-1526		
T.D.	3800			
DST #1 - 3596-3677, 15-45-15-45, 878/821, FFP 29-29 Rec 5' Mud				
DST #2 - 3780-3800', 15-45-60-45, FFP 229-964, BHP 973-964, 2046 S/Wtr w/scum oil.				
D&A				

USE ADDITIONAL SHEETS, IF NECESSARY, TO COMPLETE WELL RECORD.

Date Received

Earlene M. Lumry
 Earlene M. Lumry Signature
 Secretary
Title
September 30, 1991
Date