

Give All Information Completely  
Make Required Affidavit  
Mail or Deliver Report to:  
Conservation Division  
State Corporation Commission  
211 No. Broadway  
Wichita, Kansas

WELL PLUGGING RECORD

Graham County, Sec. 36 Twp. 9 Rge. 22W (E) (W)

Location as "NE/CNW%SW%" or footage from lines SW SE NW

Lease Owner Chief Drilling Co., Inc.

Lease Name Gustafson Well No. 1

Office Address Suite 905 Century Plaza, Wichita, Kansas 67202

Character of Well (completed as Oil, Gas or Dry Hole) Dry Hole

Date well completed 7/9/72 19

Application for plugging filed 7/8/72 19

Application for plugging approved 7/8/72 19

Plugging commenced 7/9/72 19

Plugging completed 7/9/72 19

Reason for abandonment of well or producing formation Dry Hole

If a producing well is abandoned, date of last production \_\_\_\_\_ 19

Was permission obtained from the Conservation Division or its agents before plugging was commenced? Yes

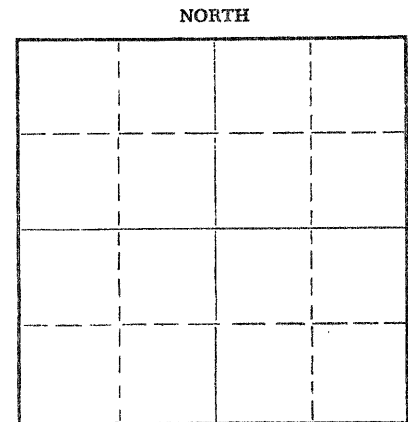

Locate well correctly on above  
Section Plat

Name of Conservation Agent who supervised plugging of this well Leo Massey

Producing formation \_\_\_\_\_ Depth to top \_\_\_\_\_ Bottom \_\_\_\_\_ Total Depth of Well 3815 Feet

Show depth and thickness of all water, oil and gas formations.

OIL, GAS OR WATER RECORDS

CASING RECORD

| FORMATION | CONTENT | FROM | TO   | SIZE   | PUT IN | PULLED OUT |
|-----------|---------|------|------|--------|--------|------------|
|           |         | 0    | 216' | 8 5/8" |        |            |
|           |         |      |      |        |        |            |
|           |         |      |      |        |        |            |
|           |         |      |      |        |        |            |
|           |         |      |      |        |        |            |
|           |         |      |      |        |        |            |
|           |         |      |      |        |        |            |
|           |         |      |      |        |        |            |
|           |         |      |      |        |        |            |

Describe in detail the manner in which the well was plugged, indicating where the mud fluid was placed and the method or methods used in introducing it into the hole. If cement or other plugs were used, state the character of same and depth placed, from \_\_\_\_\_ feet to \_\_\_\_\_ feet for each plug set.

Plugged through drill pipe @ 900' w/70 sacks cement.

Plugged through drill pipe @ 210' w/20 sacks cement.

Plugged through drill pipe @ 40' w/10 sacks cement.

RECEIVED  
STATE CORPORATION COMMISSION

JUL 12 1972  
7-12-72  
CONSERVATION DIVISION  
Wichita, Kansas

(If additional description is necessary, use BACK of this sheet)

Name of Plugging Contractor Chief Drilling Co., Inc.

Address Suite 905 Century Plaza, Wichita, Kansas 67202

STATE OF KANSAS, COUNTY OF SEDGWICK, ss.  
Jim Robinson (employee of owner) or (owner or operator) of the above-described

well, being first duly sworn on oath, says: That I have knowledge of the facts, statements, and matters herein contained and the log of the above-described well has been filed and that the same are true and correct. So help me God.

(Signature) Jim Robinson

Suite 905 Century Plaza, Wichita, Kansas  
(Address)

SUBSCRIBED AND SWORN to before me this 10th day of July, 1972

My commission expires August 5, 1975  
Virginia S. Fabian Notary Public.

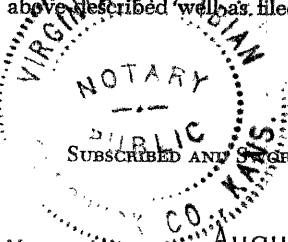

15-065-20558-00-00

**KANSAS DRILLERS LOG**

API No. 15 \_\_\_\_\_ County \_\_\_\_\_ Number \_\_\_\_\_

Operator  
 Chief Drilling Co., Inc. & Jet Drilling Co., Inc.  
 Address  
 905 Century Plaza, Wichita, Kansas 67202

Well No. \_\_\_\_\_ Lease Name  
 Gustafson

Footage Location  
 feet from (N) (S) line \_\_\_\_\_ feet from (E) (W) line \_\_\_\_\_

Principal Contractor  
 Chief Drilling Co., Inc. Geologist  
 Roger Welty

Spud Date  
 7/3/72 Total Depth  
 3815' P.B.T.D.

Date Completed  
 7/9/72 Oil Purchaser

S. 36 T. 9 R. 22W<sup>E</sup>  
 Loc. SW SE NW  
 County Graham  
 640 Acres  
 N

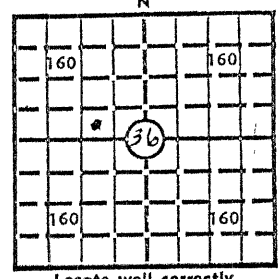

Locate well correctly  
 Elev.: Gr. 2347  
 DF 2349 KB 2352

**CASING RECORD**

Report of all strings set— surface, intermediate, production, etc.

| Purpose of string | Size hole drilled | Size casing set (in O.D.) | Weight lbs/ft. | Setting depth | Type cement      | Sacks | Type and percent additives |
|-------------------|-------------------|---------------------------|----------------|---------------|------------------|-------|----------------------------|
|                   | 12 1/4            | 8 5/8"                    | 28             | 225'          | common quick set |       |                            |
|                   |                   |                           |                |               |                  |       |                            |
|                   |                   |                           |                |               |                  |       |                            |
|                   |                   |                           |                |               |                  |       |                            |

**RECEIVED**  
 STATE CORPORATION COMMISSION  
 AUG 17 1972  
 CONSERVATION DIVISION  
 Wichita, Kansas

**LINER RECORD**

**PERFORATION RECORD**

| Top, ft. | Bottom, ft. | Sacks cement | Shots per ft. | Size & type | Depth interval |
|----------|-------------|--------------|---------------|-------------|----------------|
|          |             |              |               |             |                |

**TUBING RECORD**

| Size | Setting depth | Packer set at |
|------|---------------|---------------|
|      |               |               |

**ACID, FRACTURE, SHOT, CEMENT SQUEEZE RECORD**

| Amount and kind of material used | Depth interval treated |
|----------------------------------|------------------------|
|                                  |                        |
|                                  |                        |
|                                  |                        |

**INITIAL PRODUCTION**

|  |  |   |     |                        |               |
|--|--|---|-----|------------------------|---------------|
| Date of first production                           |  | Producing method (flowing, pumping, gas lift, etc.) |     |                        |               |
| RATE OF PRODUCTION PER 24 HOURS                    |  | Oil   | Gas | Water                  | Gas-oil ratio |
|  |  | bbls.   | MCF | bbls.                  | CFPB          |
| Disposition of gas (vented, used on lease or sold) |  |   |     | Producing interval (s) |               |

INSTRUCTIONS: As provided in KCC Rule 82-2-125, within 90 days after completion of a well, one completed copy of this Drillers Log shall be transmitted to the State Geological Survey of Kansas, 4150 Monroe Street, Wichita, Kansas 67209. Copies of this form are available from the Conservation Division, State Corporation Commission, 3830 So. Meridian (P.O. Box 17027), Wichita, Kansas 66217. Phone AC 316-522-2206. If confidential custody is desired, please note Rule 82-2-125. Drillers Logs will be on open file in the Oil and Gas Division, State Geological Survey of Kansas, Lawrence, Kansas 66044.

Operator  
 Chief Drilling Co., Inc. & Jet Drilling Co., Inc.

DESIGNATE TYPE OF COMP.: OIL, GAS,  
 DRY HOLE, SWDW, ETC.:

Well No. 1 Lease Name Gustafson Dry Hole

S 36 T 9 R 22 W<sup>E</sup><sub>W</sub>

**WELL LOG**

Show all important zones of porosity and contents thereof; cored intervals, and all drill-stem tests, including depth interval tested, cushion used, time tool open, flowing and shut-in pressures, and recoveries.

SHOW GEOLOGICAL MARKERS, LOGS RUN,  
 OR OTHER DESCRIPTIVE INFORMATION.

| FORMATION DESCRIPTION, CONTENTS, ETC.  | TOP  | BOTTOM | NAME  | DEPTH  |
|--|------|--------|---|--|
| DST #1 3606-3630'<br>Open 30"<br>Rec. 25' mud<br>IBHP: 473#<br>FBHP: 0<br>FP: 13 - 18# | 3606 | 3630   | Anhydrite<br>Base Anhy.<br>Topeka<br>Heebner<br>Toronto<br>Lansing<br>Base K.C.<br>R.T.D. | 1833<br>1868<br>3332<br>3541<br>3566<br>3581<br>3810<br>3815 |

USE ADDITIONAL SHEETS, IF NECESSARY, TO COMPLETE WELL RECORD.

|               |                     |
|---------------|---------------------|
| Date Received | <i>Jim Robinson</i> |
|               | Signature           |
|               | Office Manager      |
|               | Title               |
|               | July 11, 1972       |
|               | Date                |