

PEA 8-17-89

STATE CORPORATION COMMISSION OF KANSAS  
OIL & GAS CONSERVATION DIVISION  
WELL COMPLETION OR RECOMPLETION FORM  
ACO-1 WELL HISTORY  
DESCRIPTION OF WELL AND LEASE

API NO. 15-065-21,338-00-00

County.....Graham  
2640 FNL  
1980 FWL ..... Sec.18. Twp.10S. Rge.21W. East  
..... West

Operator: License # ..6677.....  
Name Sandlin Oil Corporation.....  
Address 1616 Glenarm Place, #2300.....  
...Denver, Colorado, 80202.....  
City/State/Zip .....

2640' KCC KG  
1980' FNL  
3398' FWL  
KCC KG  
Ft North from Southeast Corner of Section  
Ft West from Southeast Corner of Section  
(Note: Locate well in section plat below)

Purchaser Clear Creek, Inc.....

Lease Name Maxfield Estate..... Well #.....1

Operator Contact Person Gary Sandlin.....  
Phone 303-623-5055.....

Field Name Wheeler.....

Producing Formation Marmaton.....

Contractor: License # ..  
Name Emphasis.....

Elevation: Ground 2299..... KB 2304

Wellsite Geologist Michael Whistler.....  
Phone..... Russell, Kansas

STATE CORPORATION COMMISSION  
JUL 25 1990  
07-25-1990  
CONSERVATION DIVISION  
Wichita, Kansas

Designate Type of Completion  
 New Well  Re-Entry  Workover  
  
 Oil  SWD  Temp Abd  
 Gas  Inj  Delayed Comp.  
 Dry  Other (Core, Water Supply etc.)

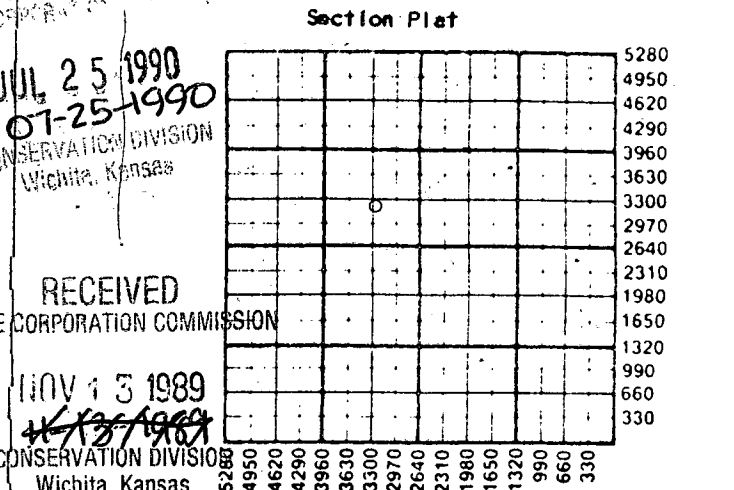

If OMWO: old well info as follows:  
Operator ..  
Well Name ..  
Comp. Date ..... Old Total Depth.....

NOV 13 1989  
CONSERVATION DIVISION  
Wichita, Kansas

WATER SUPPLY INFORMATION  
Disposition of Produced Water:  Disposal  
Docket # .....  Repressuring

WELL HISTORY

Drilling Method:  
 Mud Rotary  Air Rotary  Cable  
9/24/80... 10/2/80... 11-1-80 KCC KG  
Spud Date Date Reached TD Completion Date  
3945' KCC 3887' KCC  
9/24/80 KCC 10/2/80 KCC 11-1-88 KCC KG  
Total Depth PBTD

Questions on this portion of the ACO-1 call:  
Water Resources Board (913) 296-3717  
Source of Water:  
Division of Water Resources Permit #.....  
 Groundwater.....Ft North from Southeast Corner  
(Well) .....Ft West from Southeast Corner of  
Sec Twp Rge East West  
 Surface Water.....Ft North from Southeast Corner  
(Stream, pond etc).....Ft West from Southeast Corner  
Sec Twp Rge East West  
 Other (explain).....  
(purchased from city, R.W.D. #)

Amount of Surface Pipe Set and Cemented at 250 feet  
Multiple Stage Cementing Collar Used?  Yes  No  
If yes, show depth set.....feet  
If alternate 2 completion, cement circulated  
from.....feet depth to.....w/.....SX cmt  
Cement Company Name ..  
Invoice # ..

INSTRUCTIONS: This form shall be completed in triplicate and filed with the Kansas Corporation Commission, 200 Colorado Derby Building, Wichita, Kansas 67202, within 120 days of the spud date of any well. Rule 82-3-130, 82-3-107 and 82-3-106 apply.  
Information on side two of this form will be held confidential for a period of 12 months if requested in writing and submitted with the form. See rule 82-3-107 for confidentiality in excess of 12 months.  
One copy of all wireline logs and drillers time log shall be attached with this form. Submit CP-4 form with all plugged wells. Submit CP-111 form with all temporarily abandoned wells.

All requirements of the statutes, rules and regulations promulgated to regulate the oil and gas industry have been fully complied with and the statements herein are complete and correct to the best of my knowledge.

SANDLIN OIL CORPORATION  
Signature Gary Sandlin  
Title President Date 11/9/89

Subscribed and sworn to before me this 9th day of November 1989  
Notary Public Kacie D. Sandlin  
Date Commission Expires October 25, 1990

K.C.C. OFFICE USE ONLY  
F Letter of Confidentiality Attached  
C Wireline Log Received  
C Drillers Timelog Received  
Distribution  
 KCC  SWD/Rep  NGPA  
 KGS  Plug  Other  
(Specify)

ORIGINAL

91

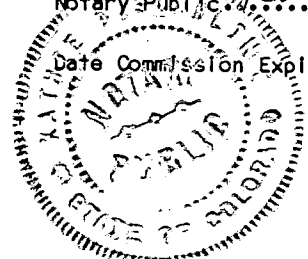

SIDE TWO

Operator Name Sandlin Oil Corporation Lease Name Maxfield Estate Well # 1

Sec. 18 Twp. 10S Rge. 21W East West County Graham

WELL LOG

INSTRUCTIONS: Show important tops and base of formations penetrated. Detail all cores. Report all drill stem tests giving interval tested, time tool open and closed, flowing and shut-in pressures, whether shut-in pressure reached static level, hydrostatic pressures, bottom hole temperature, fluid recovery, and flow rates if gas to surface during test. Attach extra sheet if more space is needed. Attach copy of log.

Drill Stem Tests Taken  Yes  No  
 Samples Sent to Geological Survey  Yes  No  
 Cores Taken  Yes  No

Formation Description  
 Log  Sample

Name	Top	Bottom
Anhydrite	1781'	
Topeka	3312'	
Heebner	3519'	
Lansing K.C.	3560'	
Base K.C.	3785'	
Simpson	3894'	
Arbuckle	3903'	

DST No. 1, 3876-3907 = Open 30 min, w/ weak blow increasing to strong blow throughout test. Tool SI for 30 min, Tool open for 30 min. w/ strong blow. Tool SI 30 min. Rec 305' OCM, 60' sulpher water, 69' gas above fluid.

DST No. 2, 3904-3914, Open 30 min w/very good blow, through out, SI 30 min. Rec 1090' OCM, 35% oil, 290' oily water, 60' gas, Clock stopped no pressures.

CASING RECORD  New  Used  
 Report all strings set-conductor, surface, intermediate, production, etc.

Purpose of String	Size Hole Drilled	Size Casing Set (In O.D.)	Weight Lbs/Ft.	Setting Depth	Type of Cement	#Sacks Used	Type and Percent Additives
Surface	12-1/4"	8-5/8"	20	250	reg	160	3% CACL, 2% gel
Production	7-7/8"	5-1/2"	17	3969	reg	100	

PERFORATION RECORD			Acid, Fracture, Shot, Cement Squeeze Record	
Shots Per Foot	Specify Footage of Each Interval Perforated		(Amount and Kind of Material Used)	Depth
4	3906-08', 3908-3909', 3762-65'		350 gal. acid, reacidize w/ 1500 gal. acid	

TUBING RECORD Size 2-7/8" Set At 3850' Packer at Liner Run  Yes  No

Date of First Production 11/1780 Producing Method  Flowing  Pumping  Gas Lift  Other (explain)

Estimated Production Per 24 Hours	Oil Bbls	Gas MCF	Water Bbls	Gas-Oil Ratio	Gravity
	247	0	0		

METHOD OF COMPLETION Production Interval

Disposition of gas:  Vented  Sold  Used on Lease  Open Hole  Perforation  Other (Specify)  Dually Completed  Commingled

ORIGINAL

