

For KCC Use: 3-208
 Effective Date: 4
 District # _____
 SGA? Yes No

KANSAS CORPORATION COMMISSION
 OIL & GAS CONSERVATION DIVISION

Form C-1

October 2007

Form must be Typed
 Form must be Signed
 All blanks must be Filled

NOTICE OF INTENT TO DRILL

Must be approved by KCC five (5) days prior to commencing well

Expected Spud Date: March 10 2008
month day year

OPERATOR: License# 3956
 Name: Brungardt Oil & Leasing, Inc.
 Address 1: P.O. Box 871
 Address 2: _____
 City: Russell State: KS Zip: 67665 + _____
 Contact Person: Gary L. Brungardt
 Phone: 785-483-4975
 CONTRACTOR: License# 5184
 Name: Shields Oil Producers

Well Drilled For: Oil Gas Enh Rec Storage Disposal Seismic; # of Holes _____ Other: _____
 Well Class: Infield Pool Ext. Wildcat Other _____
 Type Equipment: Mud Rotary Air Rotary Cable

Operator: _____
 Well Name: _____
 Original Completion Date: _____ Original Total Depth: _____

Directional, Deviated or Horizontal wellbore? Yes No
 If Yes, true vertical depth: _____
 Bottom Hole Location: _____
 KCC DKT #: _____

Spot Description: NE NE SE Sec. 20 Twp. 13 S. R. 12 E W
(AAA) 1,920 feet from N / S Line of Section
130 feet from E / W Line of Section

Is SECTION: Regular Irregular?
 (Note: Locate well on the Section Plat on reverse side)
 County: Russell

Lease Name: Holland Pool Well #: 1
 Field Name: Unknown

Is this a Prorated / Spaced Field? Yes No
 Target Formation(s): Arbuckle

Nearest Lease or unit boundary line (in footage): 1920'
 Ground Surface Elevation: 1642 feet MSL

Water well within one-quarter mile: Yes No
 Public water supply well within one mile: Yes No

Depth to bottom of fresh water: 180
 Depth to bottom of usable water: 300' 260'

Surface Pipe by Alternate: I II
 Length of Surface Pipe Planned to be set: 200'

Length of Conductor Pipe (if any): None
 Projected Total Depth: 3500'

Formation at Total Depth: Arbuckle
 Water Source for Drilling Operations:
 Well Farm Pond Other: _____

DWR Permit #: _____
 (Note: Apply for Permit with DWR)

Will Cores be taken? Yes No
 If Yes, proposed zone: _____

Oil & Gas Leases w/pooling clauses submitted.

AFFIDAVIT

The undersigned hereby affirms that the drilling, completion and eventual plugging of this well will comply with K.S.A. 55 et. seq.
 It is agreed that the following minimum requirements will be met:

1. Notify the appropriate district office **prior** to spudding of well;
2. A copy of the approved notice of intent to drill **shall be** posted on each drilling rig;
3. The minimum amount of surface pipe as specified below **shall be set** by circulating cement to the top; in all cases surface pipe **shall be set** through all unconsolidated materials plus a minimum of 20 feet into the underlying formation.
4. If the well is dry hole, an agreement between the operator and the district office on **plug length** and placement is necessary **prior to plugging**;
5. The appropriate district office will be notified before well is either plugged or production casing is cemented in;
6. If an ALTERNATE II COMPLETION, production pipe shall be cemented from below any **usable water** to surface within **120 DAYS** of spud date.
 Or pursuant to Appendix "B" - Eastern Kansas surface casing order #133,891-C, which applies to the KCC District 3 area, alternate II cementing must be completed within 30 days of the spud date or the well shall be plugged. **In all cases, NOTIFY district office** prior to any cementing.

I hereby certify that the statements made herein are true and correct to the best of my knowledge and belief.

Date: 2/15/08 Signature of Operator or Agent: Gary L. Brungardt Title: Owner

RECEIVED
 FEB 25 2008
 KCC WICHITA

For KCC Use ONLY
 API # 15 - 167-23491-0000
 Conductor pipe required None feet
 Minimum surface pipe required 200 feet per ALT. I II
 Approved by: Art 2-26-08
 This authorization expires: 2-26-09
(This authorization void if drilling not started within 12 months of approval date.)
 Spud date: _____ Agent: _____

Remember to:
 - File Drill Pit Application (form CDP-1) with Intent to Drill;
 - File Completion Form ACO-1 within 120 days of spud date;
 - File acreage attribution plat according to field proration orders;
 - Notify appropriate district office 48 hours prior to workover or re-entry;
 - Submit plugging report (CP-4) after plugging is completed (within 60 days);
 - Obtain written approval before disposing or injecting salt water.
 - If this permit has expired (See: authorized expiration date) please check the box below and return to the address below.
 Well Not Drilled - Permit Expired Date: _____
 Signature of Operator or Agent: _____

20
 13
 12
 m
 w

IN ALL CASES PLOT THE INTENDED WELL ON THE PLAT BELOW

Plat of acreage attributable to a well in a prorated or spaced field

If the intended well is in a prorated or spaced field, please fully complete this side of the form. If the intended well is in a prorated or spaced field complete the plat below showing that the well will be properly located in relationship to other wells producing from the common source of supply. Please show all the wells and within 1 mile of the boundaries of the proposed acreage attribution unit for gas wells and within 1/2 mile of the boundaries of the proposed acreage attribution unit for oil wells.

API No. 15 - 167-23491-0000
 Operator: _____
 Lease: _____
 Well Number: _____
 Field: _____
 Number of Acres attributable to well: _____
 QTR / QTR / QTR of acreage: _____

Location of Well: County: _____
 _____ feet from N / S Line of Section
 _____ feet from E / W Line of Section
 Sec. _____ Twp. _____ S. R. _____ East West
 Is Section: Regular or Irregular
 If Section is Irregular, locate well from nearest corner boundary.
 Section corner used: NE NW SE SW

PLAT

(Show location of the well and shade attributable acreage for prorated or spaced wells.)
 (Show footage to the nearest lease or unit boundary line.)

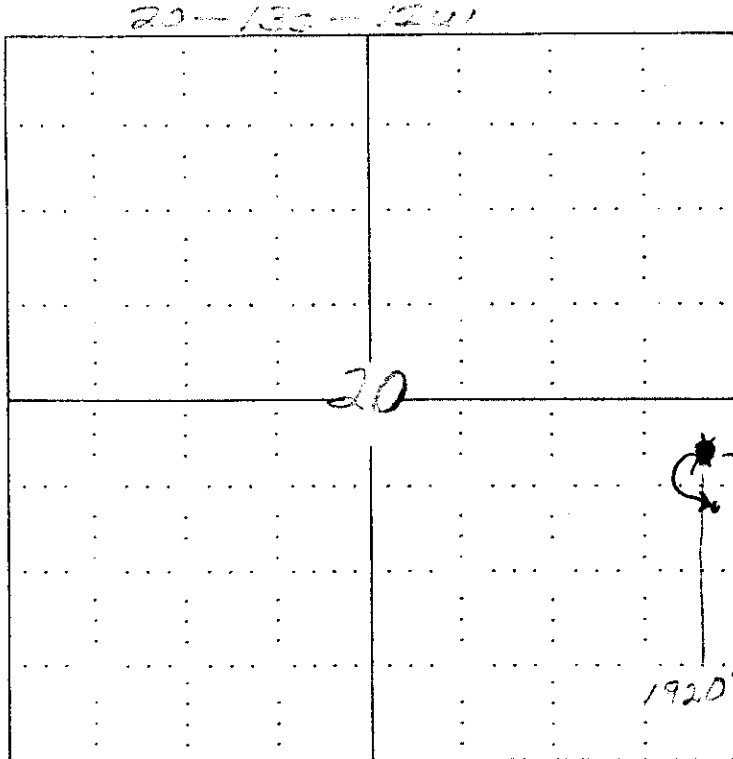

RECEIVED
 21 2008
 FEB 25 2008 KCC WICHITA
 KCC WICHITA

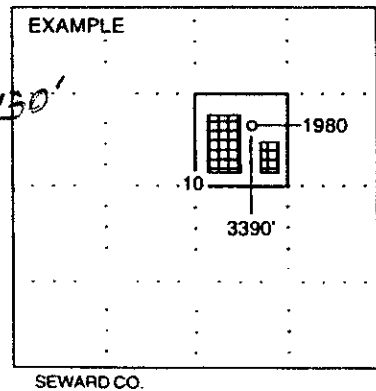

NOTE: In all cases locate the spot of the proposed drilling locaton.

- In plotting the proposed location of the well, you must show:
1. The manner in which you are using the depicted plat by identifying section lines, i.e. 1 section, 1 section with 8 surrounding sections, 4 sections, etc.
 2. The distance of the proposed drilling location from the section's south / north and east / west.
 3. The distance to the nearest lease or unit boundary line.
 4. If proposed location is located within a prorated or spaced field a certificate of acreage attribution plat must be attached: (C0-7 for oil wells; CG-8 for gas wells).

**KANSAS CORPORATION COMMISSION
OIL & GAS CONSERVATION DIVISION
APPLICATION FOR SURFACE PIT**

Form CDP-1
April 2004
Form must be Typed

Submit in Duplicate

Operator Name: Brungardt Oil & Leasing, Inc.		License Number: 3956	
Operator Address: P.O. Box 871		Russell KS 67665	
Contact Person: Gary L. Brungardt		Phone Number: 785-483-4975	
Lease Name & Well No.: Holland Pool 1		Pit Location (QQQQ): NE^{SE} NE SE	
Type of Pit: <input type="checkbox"/> Emergency Pit <input type="checkbox"/> Burn Pit <input type="checkbox"/> Settling Pit <input checked="" type="checkbox"/> Drilling Pit <input type="checkbox"/> Workover Pit <input type="checkbox"/> Haul-Off Pit <i>(If WP Supply API No. or Year Drilled)</i>		Pit is: <input checked="" type="checkbox"/> Proposed <input type="checkbox"/> Existing If Existing, date constructed: _____ Pit capacity: _____ (bbbls)	
Is the pit located in a Sensitive Ground Water Area? <input type="checkbox"/> Yes <input checked="" type="checkbox"/> No		Chloride concentration: _____ mg/l <i>(For Emergency Pits and Settling Pits only)</i>	
Is the bottom below ground level? <input checked="" type="checkbox"/> Yes <input type="checkbox"/> No		Artificial Liner? <input type="checkbox"/> Yes <input checked="" type="checkbox"/> No	
How is the pit lined if a plastic liner is not used? Drilling Mud			
Pit dimensions (all but working pits): <u>70</u> Length (feet) <u>70</u> Width (feet) <input type="checkbox"/> N/A: Steel Pits Depth from ground level to deepest point: <u>5</u> (feet) <input type="checkbox"/> No Pit			
If the pit is lined give a brief description of the liner material, thickness and installation procedure.		Describe procedures for periodic maintenance and determining liner integrity, including any special monitoring. Pit monitored 24 hours a day while drilling. Haul all free water off reserve pit while drilling and after drilling.	
Distance to nearest water well within one-mile of pit <u>N/A</u> feet Depth of water well <u>N/A</u> feet		Depth to shallowest fresh water <u>180</u> feet. Source of information: <u>Kiowa</u> <input type="checkbox"/> measured <input type="checkbox"/> well owner <input type="checkbox"/> electric log <input type="checkbox"/> KDWR	
Emergency, Settling and Burn Pits ONLY: Producing Formation: _____ Number of producing wells on lease: _____ Barrels of fluid produced daily: _____ Does the slope from the tank battery allow all spilled fluids to flow into the pit? <input type="checkbox"/> Yes <input type="checkbox"/> No		Drilling, Workover and Haul-Off Pits ONLY: Type of material utilized in drilling/workover: <u>Drilling Mud</u> Number of working pits to be utilized: <u>3</u> Abandonment procedure: <u>All free water hauled off reserve pit while drilling and after drilling.</u> Drill pits must be closed within 365 days of spud date.	
I hereby certify that the above statements are true and correct to the best of my knowledge and belief.			
<u>2/15/08</u> Date	 Signature of Applicant or Agent		RECEIVED FEB 25 2008 KCC-WICHITA

15-167-23491-0002

KCC OFFICE USE ONLY		Steel Pit <input type="checkbox"/> RFAC <input type="checkbox"/> RFAS <input type="checkbox"/>
Date Received: <u>2/25/08</u> Permit Number: _____	Permit Date: <u>2/25/08</u>	Lease Inspection: <input type="checkbox"/> Yes <input checked="" type="checkbox"/> No

Mail to: KCC - Conservation Division, 130 S. Market - Room 2078, Wichita, Kansas 67202