

OWWO

For KCC Use: Effective Date: 3-16-08 District # 4 SGA? Yes No

KANSAS CORPORATION COMMISSION OIL & GAS CONSERVATION DIVISION

Form C-1 October 2007 Form must be Typed Form must be Signed All blanks must be Filled

NOTICE OF INTENT TO DRILL

Must be approved by KCC five (5) days prior to commencing well

Expected Spud Date March 23 2008 month day year

Spot Description: NE SW SE Sec 2 Twp. 11 S Rng. 34 E W

OPERATOR: License # 5003 Name: McCoy Petroleum Corporation Address 1: 8080 E. Central, Suite #300 City: Wichita State: KS Zip: 67206-2366 Contact Person: Scott Hampel Phone: 316-636-2737 x 104

990 feet from N / S Line of Section 1650 feet from E / W Line of Section Is SECTION: Regular Irregular? (Note: Locate well on the Section Plat on reverse side)

CONTRACTOR: License # 30606 Name: Murfin Drilling Company

County: Logan Lease Name: SEELE "A" - OWWO Well #: 4-2 Field Name: Monument NW

Well Drilled For: Oil Gas Seismic: # of Holes Other: Water Supply Well Class: Infield Pool Ext. Wildcat Other Type Equipment: Mud Rotary Air Rotary Cable

Is this a Prorated / Spaced Field? Cedar Hills Nearest Lease or unit boundary (in footage): 990' Ground Surface Elevation: 3198' feet MSL

If OWWO: old well information as follows: Operator: McCoy Petroleum Corporation Well Name: SEELE "A" #4-2 (Prev. API: 15-109-20710-0000) Original Completion Date: 9/3/03 Original Total Depth: 4775'

Water well within one-quarter mile: Public water supply well within one mile: Depth to bottom of fresh water: 200' Depth to bottom of usable water: 1800' Surface Pipe by Alternate: Length of Surface Pipe: 260' Existing Length of Conductor Pipe (if any): None Projected Total Depth: 2000' Formation at Total Depth: Cedar Hills

Directional, Deviated or Horizontal wellbore? If Yes, true vertical depth: Bottom Hole Location: KCC DKT #:

Water Source for Drilling Operations: Well Farm Pond Other: Haul DWR Permit #: Will Cores be taken? If Yes, proposed zone:

AFFIDAVIT

RECEIVED KANSAS CORPORATION COMMISSION

The undersigned hereby affirms that the drilling, completion and eventual plugging of this well will comply with K.S.A. 55 et. seq.

MAR 10 2008

It is agreed that the following minimum requirements will be met:

- 1. Notify the appropriate district office prior to spudding of well; 2. A copy of the approved notice of intent to drill shall be posted on each drilling rig; 3. The minimum amount of surface pipe as specified below shall be set by circulating cement to the top, in all cases surface pipe shall be set through all unconsolidated materials plus a minimum of 20 feet into the underlying formation. 4. If the well is dry hole, an agreement between the operator and the district office on plug length and placement is necessary prior to plugging; 5. The appropriate district office will be notified before well is either plugged or production casing is cemented in; 6. If an ALTERNATE II COMPLETION, production pipe shall be cemented from below any unable water to surface within 120 days of plug date. Or pursuant to Appendix "B" - Eastern Kansas surface casing order #133,891-C, which applies to the KCC District 3 area, alternate II cementing must be completed within 30 days of the spud date or the well shall be plugged. In all cases, NOTIFY district office prior to any cementing.

I hereby certify that the statements made herein are true and to the best of my knowledge and belief.

Date: 3/7/08 Signature of Operator or Agent: Scott Hampel Title: Vice President - Production

For KCC Use ONLY API # 15 - 109-20710-00-01 Conductor pipe required None feet Minimum surface pipe required 260 feet per ALT. I II Approved by: 3-11-08 This authorization expires: 3-11-09 (This authorization void if drilling not started within 12 months of effective date.) Spud date: Agent:

- Remember to: File Drill Pit Application (form CDP-1) with Intent to Drill; File Completion Form ACO-1 within 120 days of spud date; File acreage attribution plat according to field proration orders; Notify appropriate district office 48 hours prior to workover or re-entry; Submit plugging report (CP-4) after plugging is completed (within 60 days); Obtain written approval before disposing or injecting salt water; If this permit has expired (See: authorized expiration date) please check the box below and return to the address below. Well Not Drilled - Permit Expired Date: Signature of Operator or Agent:

2-11-34

IN ALL CASES PLOT THE INTENDED WELL ON THE PLAT BELOW

Plat of acreage attributable to a well in a prorated or spaced field

If the intended well is in a prorated or spaced field, please fully complete this side of the form. If the intended well is in a prorated or spaced field complete the plat below showing that the well will be properly located in relationship to other wells producing from the common source of supply. Please show all the wells and within 1 mile of the boundaries of the proposed acreage attribution unit for gas wells and within 1/2 mile of the boundaries of the proposed acreage attribution unit for oil wells.

API No. 15 - 109-20710-00-01
 Operator: McCoy Petroleum Corporation
 Lease: SELLE "A" OWWO
 Well Number: #4-2
 Field: Monument NW
 Number of Acres attributable to well: _____
 QTR / QTR / QTR of acreage: _____

Location of Well: County: NE SW SE, Logan County, KS
 _____ 990 feet from N S (check one) Line of Section
 _____ 1650 feet from E W (check one) Line of Section
 Sec 2 Twp 11 S. R. 34 East West
 Is Section: Regular Irregular?
If Section is Irregular, locate well from nearest corner boundary.
 Section corner used: NE NW SE SW

PLAT

*(Show location of the well and shade attributable acreage for prorated or spaced wells)
 (Show footage to the nearest lease or unit boundary fine.)*

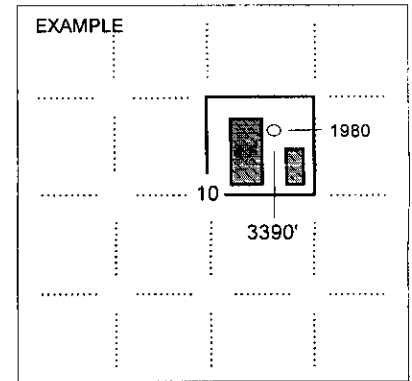
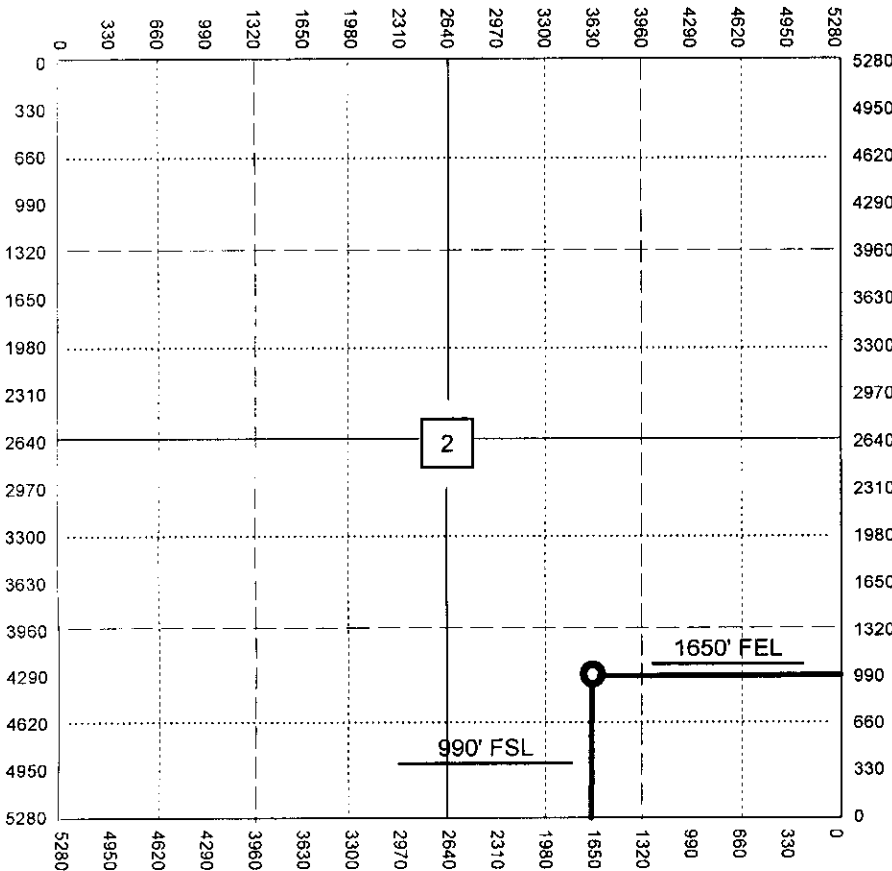

NOTE: In all cases locate the spot of the proposed drilling location.

In plotting the proposed location of the well, you must show.

1. The manner in which you are using the depicted plat by identifying section lines, i.e. 1 section, 1 section with 8 surrounding sections, 4 sections, etc.
2. The distance of the proposed drilling location from the south / north and east / west outside section lines.
3. The distance to the nearest lease or unit boundary line (in footage).
4. If proposed location is located within a prorated or spaced field a certificate of acreage attribution plat must be attached: (CO-7 for oil wells; CG-8 for gas wells).

**KANSAS CORPORATION COMMISSION
OIL & GAS CONSERVATION DIVISION
APPLICATION FOR SURFACE PIT**

Form CDP-1
April 2004
Form must be Typed

Submit in Duplicate

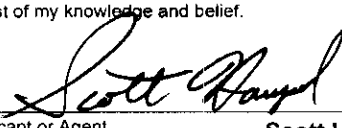
Operator Name: McCoy Petroleum Corporation		License Number: 5003
Operator Address: 8080 E. Central, Suite #300, Wichita, KS 67206-2366		
Contact Person: Scott Hampel		Phone Number: 316-636-2737x104
Lease Name & Well No.: SEELE "A" OWWO #4-2		Pit Location (QQQ):
Type of Pit: <input type="checkbox"/> Emergency Pit <input type="checkbox"/> Burn Pit <input type="checkbox"/> Settling Pit <input checked="" type="checkbox"/> Drilling Pit <input type="checkbox"/> Workover Pit <input type="checkbox"/> Haul-Off Pit <small>(If WP Supply API No. or Year Drilled)</small>		Pit is: <input checked="" type="checkbox"/> Proposed <input type="checkbox"/> Existing If Existing, date constructed: _____ Pit capacity: 3600 (bbls)
		NE SW SE Sec. 2 Twp. 11s R. 34 <input type="checkbox"/> East <input checked="" type="checkbox"/> West 990 Feet from <input type="checkbox"/> North / <input checked="" type="checkbox"/> South Line of Section 1650 Feet from <input checked="" type="checkbox"/> East / <input type="checkbox"/> West Line of Section Logan County
Is the pit located in a Sensitive Ground Water Area? <input type="checkbox"/> Yes <input checked="" type="checkbox"/> No		Chloride concentration: _____ mg/l <small>(For Emergency Pits and Settling Pits only)</small>
Is the bottom below ground level? <input checked="" type="checkbox"/> Yes <input type="checkbox"/> No	Artificial Liner? <input type="checkbox"/> Yes <input checked="" type="checkbox"/> No	How is the pit lined if a plastic liner is not used? Bentonite / Drilling Mud
Pit dimensions (all but working pits): 80 Length (feet) 80 Width (feet) N/A : Steel Pits Depth from ground level to deepest point: 4 (feet)		
If the pit is lined give a brief description of the liner material, thickness and installation procedure.		Describe procedures for periodic maintenance and determining liner integrity, including any special monitoring.
		RECEIVED KANSAS CORPORATION COMMISSION MAR 10 2008 CONSERVATION DIVISION WICHITA, KS
Distance to nearest water well within one-mile of pit NA feet Depth of water well NA feet	Depth to shallowest fresh water NA feet. Source of information: <input type="checkbox"/> measured <input checked="" type="checkbox"/> well owner <input type="checkbox"/> electric log <input type="checkbox"/> KDWR	
Emergency, Settling and Burn Pits ONLY: Producing Formation: _____ Number of producing wells on lease: _____ Barrels of fluid produced daily: _____ Does the slope from the tank battery allow all spilled fluids to flow into the pit? <input type="checkbox"/> Yes <input type="checkbox"/> No	Drilling, Workover and Haul-Off Pits ONLY: Type of material utilized in drilling/workover: Bentonite Number of working pits to be utilized: 3 Abandonment procedure: Let dry, backfill, return surface to original condition. Drill pits must be closed within 365 days of spud date.	
I hereby certify that the above statements are true and correct to the best of my knowledge and belief.		
Date 3/7/08	Signature of Applicant or Agent  Scott Hampel	
KCC OFFICE USE ONLY		
Date Received: 3/10/08	Permit Number: _____	Permit Date: 3/10/08 Lease Inspection: <input type="checkbox"/> Yes <input checked="" type="checkbox"/> No

15-109-20710-00-01

STATE OF KANSAS
STATE CORPORATION COMMISSION
130 S. Market, Room 2078
Wichita, KS 67202

WELL PLUGGING RECORD
K.A.R.-62-3-117

API NUMBER 109-20710-00-00

LEASE NAME Seele A

WELL NUMBER 4 - 2

990 Ft. from S Section Line

1650 Ft. from E Section Line

SEC. 2 TWP. 11 RGE. 34 (E) or (W)

COUNTY Logan

Date Well Completed 9-03-03

Plugging Commenced 9-03-03

Plugging Completed 9-03-03

RECEIVED
SEP 11 2003
KCC WICHITA

TYPE OR PRINT
NOTICE: Fill out completely
and return to Cons. Div.
office within 30 days.

LEASE OPERATOR McCoy Petroleum Corporation

ADDRESS P.O. Box 780208, Wichita, KS 67278

PHONE#(316) 636-2737 OPERATORS LICENSE NO. _____

Character of Well D & A

(Oil, Gas, O&A, SWD, Input, Water Supply Well)

The plugging proposal was approved on 9-03-03 (date)

by Herb Deines (KCC District Agent's Name).

Is ACO-1 filed? by operator if not, is well log attached? _____

Producing Formation _____ Depth to Top _____ Bottom _____ T.D. 4775'

Show depth and thickness of all water, oil and gas formations.

OIL, GAS OR WATER RECORDS

CASING RECORD

Formation	Content	From	To	Size	Put in	Pulled out
Surface		0	260	8 5/8"	260	0

Describe in detail the manner in which the well was plugged, indicating where the mud fluid was placed and the method or methods used in introducing it into the hole. If cement or other plug were used, state the character of same and depth placed, from feet to feet each set
1st Plug @ 2725 w/25 sx., 2nd Plug @ 1800 w/100 sx., 3rd Plug 310 w/40 sx.,
4th Plug @ 40 w/10 sx. & Whipper Plug 5th Plug @ Rathole w/15 sx.,
Total 190 sx., 60/40 Pozmix 6% Gel w/1/4# Flo Seal per sx., by Allied Cementing
Plug Down @ 4:00 am 9-03-03

Name of Plugging Contractor L. D. Drilling, Inc. License No. 6039

Address 7 SW 26 Ave, Great Bend, KS 67530

NAME OF PARTY RESPONSIBLE FOR PLUGGING FEES: McCoy Petroleum Corporation

STATE OF Kansas COUNTY OF Barton, ss.

Bessie DeWerff (Employee of Operator) or (Operator) of above-described well, being first duly sworn on oath, says: That I have knowledge of the facts statements, and matters herein contained and the log of the above-described well as filed the the same are true and correct, so help me God.

(Signature) Bessie DeWerff

(Address) 7 SW 26 Ave, Great Bend, KS 67530

SUBSCRIBED AND SWORN TO before me this 03 day of September, 2003

Rashell Patten
Notary Public Rashell Patten

My Commission Expires: 2-02-07

