

For KCC Use: 3-17-08
Effective Date: 3
District # 3
SGA? Yes No

KANSAS CORPORATION COMMISSION
OIL & GAS CONSERVATION DIVISION
NOTICE OF INTENT TO DRILL

Must be approved by KCC five (5) days prior to commencing well

Form C-1
December 2002
Form must be Typed
Form must be Signed
All blanks must be Filled

Expected Spud Date 03 month 21 day 2008 year

OPERATOR: License# 33829 ✓
Name: Terry Brake
Address: R.R. 1 Box 269
City/State/Zip: Caney, KS 67333
Contact Person: Terry Brake
Phone: 620-289-4438

CONTRACTOR: License# 5989 ✓
Name: Kurt Finney, Finney Drilling

| | | |
|--|---|--|
| Well Drilled For: | Well Class: | Type Equipment: |
| <input checked="" type="checkbox"/> Oil | <input checked="" type="checkbox"/> Infield | <input checked="" type="checkbox"/> Mud Rotary |
| <input type="checkbox"/> Gas | <input type="checkbox"/> Pool Ext. | <input type="checkbox"/> Air Rotary |
| <input type="checkbox"/> CWMO | <input type="checkbox"/> Wildcat | <input type="checkbox"/> Cable |
| <input type="checkbox"/> Seismic; # of Holes | <input type="checkbox"/> Other | |
| <input type="checkbox"/> Other | | |

If OWWO: old well information as follows:

Operator: _____
Well Name: _____
Original Completion Date: _____ Original Total Depth: _____
Directional, Deviated or Horizontal wellbore? Yes No
If Yes, true vertical depth: _____
Bottom Hole Location: _____
KCC DKT #: _____

RECEIVED
KANSAS CORPORATION COMMISSION

MAR 12 2008

CONSERVATION DIVISION
WICHITA, KS
AFFIDAVIT

The undersigned hereby affirms that the drilling, completion and eventual plugging of this well will comply with K.S.A. 55 et. seq.
It is agreed that the following minimum requirements will be met:

1. Notify the appropriate district office **prior** to spudding of well;
2. A copy of the approved notice of intent to drill **shall be posted** on each drilling rig;
3. The minimum amount of surface pipe as specified below **shall be set** by circulating cement to the top; in all cases surface pipe **shall be set** through all unconsolidated materials plus a minimum of 20 feet into the underlying formation.
4. If the well is dry hole, an agreement between the operator and the district office on **plug length** and placement is necessary **prior to plugging**;
5. The appropriate district office will be notified before well is either plugged or production casing is cemented in;
6. If an ALTERNATE II COMPLETION, production pipe shall be cemented from below any usable water to surface within **120 days** of spud date.
Or pursuant to Appendix "B" - Eastern Kansas surface casing order #133,891-C, which applies to the KCC District 3 area, alternate II cementing must be completed within 30 days of the spud date or the well shall be plugged. **In all cases, NOTIFY district office** prior to any cementing.

I hereby certify that the statements made herein are true and to the best of my knowledge and belief.

Date: 3-10-08 Signature of Operator or Agent: Terry Brake Title: Operator

Remember to:

- File Drill Pit Application (form CDP-1) with Intent to Drill;
- File Completion Form ACO-1 within 120 days of spud date;
- File acreage attribution plat according to field proration orders;
- Notify appropriate district office 48 hours prior to workover or re-entry;
- Submit plugging report (CP-4) after plugging is completed;
- Obtain written approval before disposing or injecting salt water.
- If this permit has expired (See: authorized expiration date) please check the box below and return to the address below.

Well Not Drilled - Permit Expired

Signature of Operator or Agent: _____
Date: _____

For KCC Use ONLY

API # 15 - 125-31561-0000
Conductor pipe required None feet
Minimum surface pipe required 20 feet per ft. **X(2)**
Approved by: 4/4 3-12-08
This authorization expires: 3-12-09
(This authorization void if drilling not started within 12 months of effective date.)
Spud date: _____ Agent: _____

23
34
14E

IN ALL CASES PLOT THE INTENDED WELL ON THE PLAT BELOW

Plat of acreage attributable to a well in a prorated or spaced field

If the intended well is in a prorated or spaced field, please fully complete this side of the form. If the intended well is in a prorated or spaced field complete the plat below showing that the well will be properly located in relationship to other wells producing from the common source of supply. Please show all the wells and within 1 mile of the boundaries of the proposed acreage attribution unit for gas wells and within 1/2 mile of the boundaries of the proposed acreage attribution unit for oil wells.

API No. 15 - 125-31561-0000
 Operator: Terry Brake
 Lease: Freidline
 Well Number: 10
 Field: Wayside-Havana
 Number of Acres attributable to well: _____
 QTR / QTR / QTR of acreage: _____

Location of Well: County: Montgomery
 _____ 1820 feet from N / S Line of Section
 _____ 1800 feet from E / W Line of Section
 Sec. 23 Twp. 34 S. R. 14 East West

Is Section: Regular or Irregular

If Section is Irregular, locate well from nearest corner boundary.

Section corner used: NE NW SE SW

CONSERVATION DIVISION
 WICHITA, KS

MAR 12 2008

PLAT

(Show location of the well and shade attributable acreage for prorated or spaced wells.)
 (Show footage to the nearest lease or unit boundary line.)

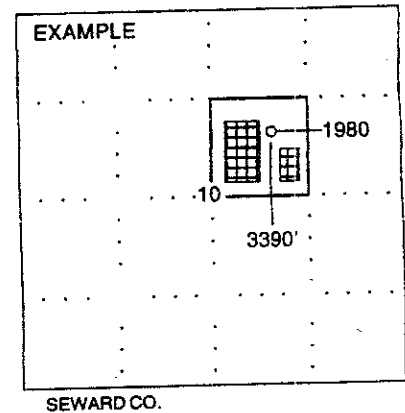
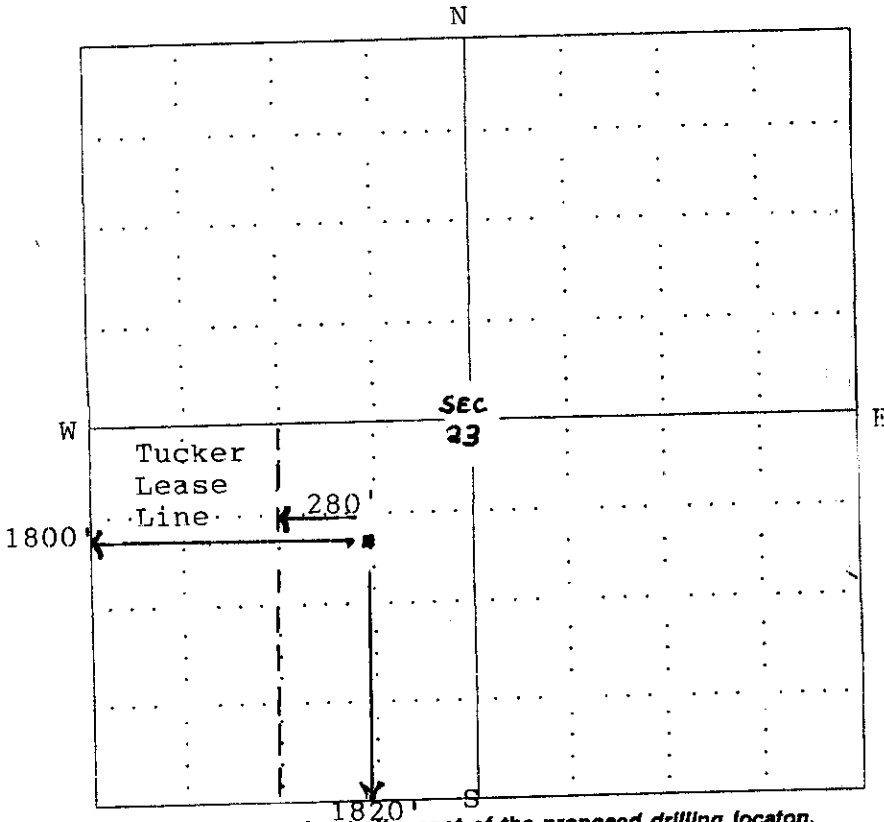

NOTE: In all cases locate the spot of the proposed drilling location.

In plotting the proposed location of the well, you must show:

1. The manner in which you are using the depicted plat by identifying section lines, i.e. 1 section, 1 section with 8 surrounding sections, 4 sections, etc.
2. The distance of the proposed drilling location from the section's south / north and east / west.
3. The distance to the nearest lease or unit boundary line.
4. If proposed location is located within a prorated or spaced field a certificate of acreage attribution plat must be attached: (CO-7 for oil wells; CG-8 for gas wells).

KANSAS CORPORATION COMMISSION
OIL & GAS CONSERVATION DIVISION
APPLICATION FOR SURFACE PIT

Form CDP-1
April 2004
Form must be Typed

Submit in Duplicate

| | | | |
|---|--|---|--|
| Operator Name: <u>Terry Brake</u> | | License Number: <u>33829</u> | |
| Operator Address: <u>Rt Box 269</u> | | | |
| Contact Person: <u>Terry Brake</u> | | Phone Number: <u>(620) 289-4438</u> | |
| Lease Name & Well No.: <u>Freidline #10</u> | | Pit Location (QQQQ): <u>E 1/2 - SW 1/4 - - - -</u> | |
| Type of Pit: <input type="checkbox"/> Emergency Pit <input type="checkbox"/> Burn Pit <input type="checkbox"/> Settling Pit <input checked="" type="checkbox"/> Drilling Pit <input type="checkbox"/> Workover Pit <input type="checkbox"/> Haul-Off Pit (If WP Supply API No. or Year Drilled) | | Pit is: <input checked="" type="checkbox"/> Proposed <input type="checkbox"/> Existing If Existing, date constructed: _____ Pit capacity: <u>150</u> (bbls) | |
| | | Sec. <u>23</u> Twp. <u>34</u> R. <u>14</u> <input checked="" type="checkbox"/> East <input type="checkbox"/> West <u>1820</u> Feet from <input type="checkbox"/> North / <input checked="" type="checkbox"/> South Line of Section <u>1800</u> Feet from <input type="checkbox"/> East / <input checked="" type="checkbox"/> West Line of Section <u>MONTGOMERY</u> County | |
| Is the pit located in a Sensitive Ground Water Area? <input type="checkbox"/> Yes <input checked="" type="checkbox"/> No | | Chloride concentration: _____ mg/l (For Emergency Pits and Settling Pits only) | |
| Is the bottom below ground level? <input checked="" type="checkbox"/> Yes <input type="checkbox"/> No | | Artificial Liner? <input type="checkbox"/> Yes <input checked="" type="checkbox"/> No | |
| How is the pit lined if a plastic liner is not used? | | | |
| Pit dimensions (all but working pits): <u>40</u> Length (feet) <u>8</u> Width (feet) _____ N/A: Steel Pits Depth from ground level to deepest point: <u>3</u> (feet) | | | |
| If the pit is lined give a brief description of the liner material, thickness and installation procedure. | | Describe procedures for periodic maintenance and determining liner integrity, including any special monitoring. | |
| | | RECEIVED KANSAS CORPORATION COMMISSION MAR 12 2008 | |
| Distance to nearest water well within one-mile of pit <u>2600</u> feet Depth of water well <u>80</u> feet | | Depth to shallowest fresh water <u>80</u> feet Source of information: _____ measured _____ well owner <input checked="" type="checkbox"/> electric log _____ KDWR | |
| Emergency, Settling and Burn Pits ONLY: Producing Formation: _____ Number of producing wells on lease: _____ Barrels of fluid produced daily: _____ Does the slope from the tank battery allow all spilled fluids to flow into the pit? <input type="checkbox"/> Yes <input type="checkbox"/> No | | Drilling, Workover and Haul-Off Pits ONLY: Type of material utilized in drilling/workover: <u>Fresh Water</u> Number of working pits to be utilized: <u>1</u> Abandonment procedure: <u>allow to air dry and back fill</u> Drill pits must be closed within 365 days of spud date. | |
| I hereby certify that the above statements are true and correct to the best of my knowledge and belief. | | | |
| <u>3-10-08</u> Date | | <u>Terry Brake</u> Signature of Applicant or Agent | |

15-125-31501-0000

KCC OFFICE USE ONLY

Date Received: 3/12/08 Permit Number: _____ Permit Date: 3/12/08 Lease Inspection: Yes No