

For KCC Use:  
 Effective Date: 3-26-08  
 District #: 3  
 SGA?  Yes  No

KANSAS CORPORATION COMMISSION  
 OIL & GAS CONSERVATION DIVISION

Form C-1  
 October 2007  
**Form must be Typed**  
**Form must be Signed**  
**All blanks must be Filled**

**NOTICE OF INTENT TO DRILL**

Must be approved by KCC five (5) days prior to commencing well

Expected Spud Date: 03/24/2008  
 month day year  
 OPERATOR: License# 6766  
 Name: N & W Enterprises, Inc  
 Address 1: 1111 S Margrave  
 Address 2:  
 City: Fort Scott State: KS Zip: 66701  
 Contact Person: Tom Norris  
 Phone: 620-223-6559  
 CONTRACTOR: License# 33734  
 Name: Hat Drilling, LLC

Spot Description:  
S/2-S/2 E - NW Sec. 29 Twp. 28 S. R. 22  E  W  
 (a/a/a/a)  
2,970 feet from  N /  S Line of Section  
3,960 feet from  E /  W Line of Section

Is SECTION:  Regular  Irregular?  
 (Note: Locate well on the Section Plat on reverse side)  
 County: Crawford  
 Lease Name: Hammerbacher Well #: Inj 4  
 Field Name: Walnut SE  
 Is this a Prorated / Spaced Field?  Yes  No  
 Target Formation(s): Bartlesville

Well Drilled For: Well Class: Type Equipment:  
 Oil  Enh Rec  Infield  Mud Rotary  
 Gas  Storage  Pool Ext.  Air Rotary  
 Disposal  Wildcat  Cable  
 Seismic; # of Holes  Other  
 Other:

Nearest Lease or unit boundary line (in footage): 465 330  
 Ground Surface Elevation: \_\_\_\_\_ feet MSL  
 Water well within one-quarter mile:  Yes  No  
 Public water supply well within one mile:  Yes  No  
 Depth to bottom of fresh water: 1000+  
 Depth to bottom of usable water: 1000+  
 Surface Pipe by Alternate:  I  II  
 Length of Surface Pipe Planned to be set: 20  
 Length of Conductor Pipe (if any): \_\_\_\_\_  
 Projected Total Depth: 450  
 Formation at Total Depth: Bartlesville

If OWWO: old well information as follows:  
 Operator: \_\_\_\_\_  
 Well Name: \_\_\_\_\_  
 Original Completion Date: \_\_\_\_\_ Original Total Depth: \_\_\_\_\_

Water Source for Drilling Operations:  
 Well  Farm Pond  Other:  
 DWR Permit #: \_\_\_\_\_  
 (Note: Apply for Permit with DWR )

Directional, Deviated or Horizontal wellbore?  Yes  No  
 If Yes, true vertical depth: \_\_\_\_\_  
 Bottom Hole Location: \_\_\_\_\_  
 KCC DKT #: \_\_\_\_\_

Will Cores be taken?  Yes  No  
 If Yes, proposed zone: \_\_\_\_\_

**AFFIDAVIT**

RECEIVED  
 KANSAS CORPORATION COMMISSION

The undersigned hereby affirms that the drilling, completion and eventual plugging of this well will comply with K.S.A. 55 et. seq.  
 It is agreed that the following minimum requirements will be met:

MAR 20 2008

1. Notify the appropriate district office **prior** to spudding of well;
2. A copy of the approved notice of intent to drill **shall be posted** on each drilling rig;
3. The minimum amount of surface pipe as specified below **shall be set** by circulating cement to the top; in all cases surface pipe **shall be set** through all unconsolidated materials plus a minimum of 20 feet into the underlying formation.
4. If the well is dry hole, an agreement between the operator and the district office on **plug length** and placement is necessary **prior to plugging**;
5. The appropriate district office will be notified before well is either plugged or production casing is cemented in;
6. If an ALTERNATE II COMPLETION, production pipe shall be cemented from below any usable water to surface within **120 DAYS** of spud date. Or pursuant to Appendix "B" - Eastern Kansas surface casing order #133,891-C, which applies to the KCC District 3 area, alternate II cementing must be completed within 30 days of the spud date or the well shall be plugged. **In all cases, NOTIFY district office** prior to any cementing.

CONSERVATION DIVISION  
 WICHITA, KS

I hereby certify that the statements made herein are true and correct to the best of my knowledge and belief.

Date: 03/16/2008 Signature of Operator or Agent: [Signature] Title: President

**For KCC Use ONLY**  
 API # 15 - 037-21964-0000  
 Conductor pipe required None feet  
 Minimum surface pipe required 20 feet per ALT.  I  II  
 Approved by: [Signature] 3-21-08  
 This authorization expires: 3-21-09  
 (This authorization void if drilling not started within 12 months of approval date.)  
 Spud date: \_\_\_\_\_ Agent: \_\_\_\_\_

- Remember to:**
- File Drill Pit Application (form CDP-1) with Intent to Drill;
  - File Completion Form ACO-1 within 120 days of spud date;
  - File acreage attribution plat according to field proration orders;
  - Notify appropriate district office 48 hours prior to workover or re-entry;
  - Submit plugging report (CP-4) after plugging is completed (within 60 days);
  - Obtain written approval before disposing or injecting salt water.
  - If this permit has expired (See: authorized expiration date) please check the box below and return to the address below.
- Well Not Drilled - Permit Expired Date: \_\_\_\_\_  
 Signature of Operator or Agent: \_\_\_\_\_

29  
 28  
 22  
 E  
 W

**IN ALL CASES PLOT THE INTENDED WELL ON THE PLAT BELOW**

*Plat of acreage attributable to a well in a prorated or spaced field*

**If the intended well is in a prorated or spaced field, please fully complete this side of the form.** If the intended well is in a prorated or spaced field complete the plat below showing that the well will be properly located in relationship to other wells producing from the common source of supply. Please show all the wells and within 1 mile of the boundaries of the proposed acreage attribution unit for gas wells and within 1/2 mile of the boundaries of the proposed acreage attribution unit for oil wells.

API No. 15 - 037-21964-0000  
Operator: N & W Enterprises, Inc  
Lease: Hammerbacher  
Well Number: Inj 4  
Field: Walnut SE

Location of Well: County: Crawford  
2,970 feet from  N /  S Line of Section  
3,960 feet from  E /  W Line of Section  
Sec. 29 Twp. 28 S. R. 22  E  W

Number of Acres attributable to well: \_\_\_\_\_  
QTR/QTR/QTR/QTR of acreage: SE - NW - \_\_\_\_\_  
5/2-5/2 -

Is Section:  Regular or  Irregular

**If Section is irregular, locate well from nearest corner boundary.**  
Section corner used:  NE  NW  SE  SW

**PLAT**

*(Show location of the well and shade attributable acreage for prorated or spaced wells.)  
(Show footage to the nearest lease or unit boundary line.)*

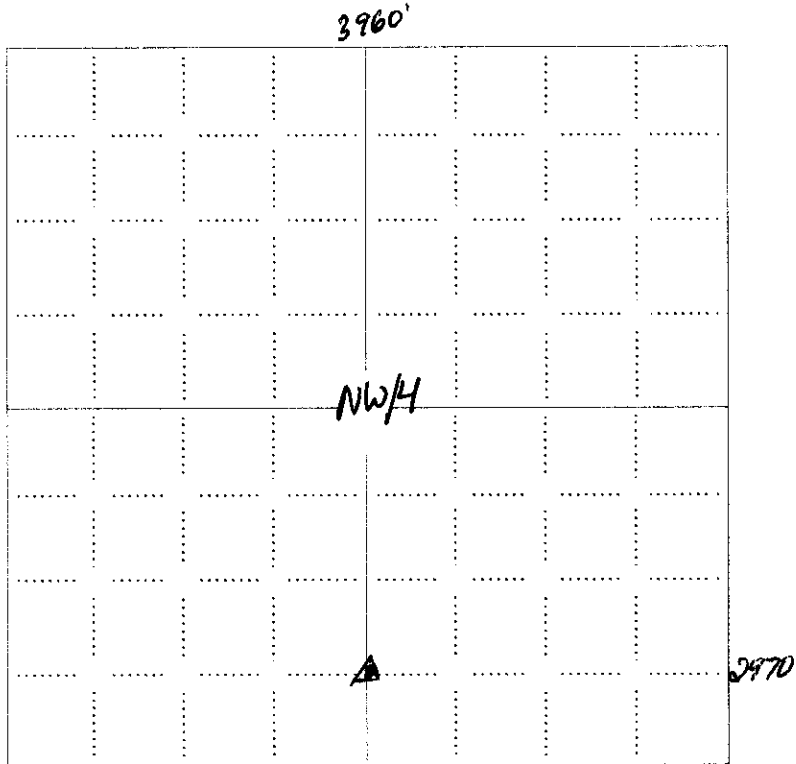

RECEIVED  
KANSAS CORPORATION COMMISSION  
MAR 20 2008  
CONSERVATION DIVISION  
WICHITA, KS

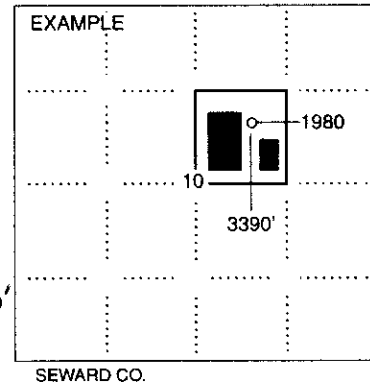

**NOTE: In all cases locate the spot of the proposed drilling location.**

**In plotting the proposed location of the well, you must show:**

1. The manner in which you are using the depicted plat by identifying section lines, i.e. 1 section, 1 section with 8 surrounding sections, 4 sections, etc.
2. The distance of the proposed drilling location from the south / north and east / west outside section lines.
3. The distance to the nearest lease or unit boundary line (in footage).
4. If proposed location is located within a prorated or spaced field a certificate of acreage attribution plat must be attached: (CO-7 for oil wells; CG-8 for gas wells).

Plat and Certificate of Injection Well Location and Surrounding Acreages

15-03721964-0000

Operator: NW Enterprises Inc. Location of Well: \_\_\_\_\_  
Lease: HAMMER BACHER Feet from SOUTH Section Line \_\_\_\_\_  
Well Number: \_\_\_\_\_ Feet from EAST Section Line \_\_\_\_\_  
County: CRAWFORD Sec. 29 Twp. 28 S. R. 22  East  West

**Plat**  
Show the following information: applicant injection well, all producing wells, inactive wells, plugged wells, and other wells within a one-half mile radius, all lease boundaries, lease operators, unleased mineral rights owners, well numbers, and producing wells producing formation tops.

- #1 2805 FSL 2805 FEL SE SE NW 4
- #2 2805 FSL 3135 FEL SE SE NW 4
- #3 2805 FSL 3465 FEL SW SE NW 4
- #4 2805 FSL 3795 FEL SW SE NW 4
- #5 2805 FSL 4125 FEL SE SW NW 4
- #6 2805 FSL 4455 FEL SE SW NW 4
- #7 2805 FSL 4785 FEL SW SW NW 4
- #8 2805 FSL 5155 FEL SW SW NW 4
- #9 3135 FSL 2805 FEL X
- #10 3135 FSL 3135 FEL X
- #11 3135 FSL 3465 FEL X
- #12 3135 FSL 3795 FEL X
- #13 3135 FSL 4125 FEL X
- #14 3135 FSL 4455 FEL X
- #15 3135 FSL 4785 FEL X
- #16 3135 FSL 5155 FEL X
- #17 3465 FSL 2805 FEL X
- #18 3465 FSL 3135 FEL X
- #19 3465 FSL 3465 FEL X
- #20 3465 FSL 3795 FEL X SE SW
- #21 3465 FSL 4125 FEL X SE SW
- #22 3465 FSL 4455 FEL X SE SW
- #23 3465 FSL 4785 FEL X SW SW

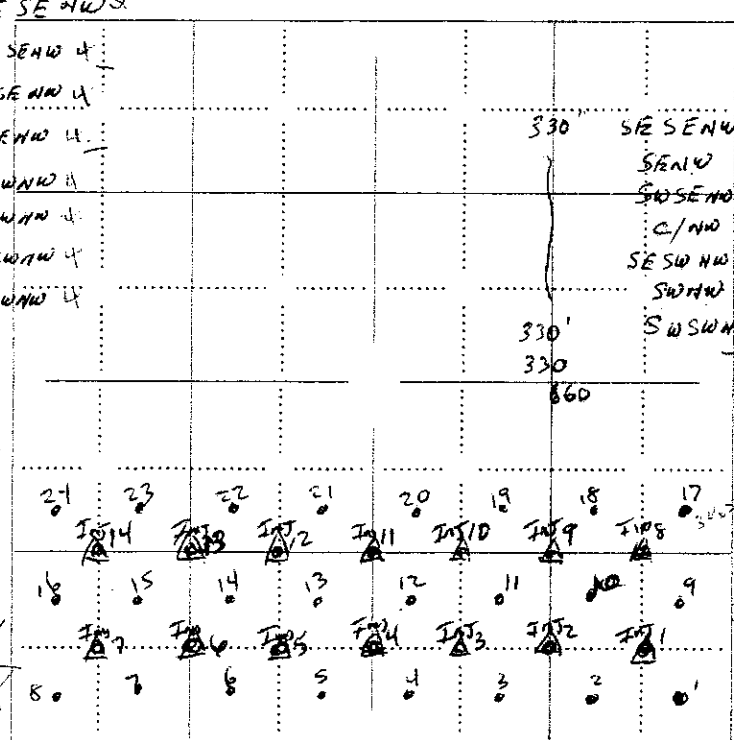

- NW/4  
INT Wells
- 1 2970 FSL 2970 FEL X
  - 2 2970 FSL 3300 FEL X
  - 3 2970 FSL 3630 FEL X
  - 4 2970 FSL 3960 FEL X
  - 5 2970 FSL 4290 FEL X
  - 6 2970 FSL 4620 FEL X
  - 7 2970 FSL 4950 FEL X
  - 8 3300 FSL 2970 FEL X
  - 9 3300 FSL 3300 FEL X
  - 10 3300 FSL 3630 FEL X
  - 11 3300 FSL 3960 FEL X
  - 12 3300 FSL 4290 FEL X
  - 13 3300 FSL 4620 FEL X
  - 14 3300 FSL 4950 FEL X

applicant well  $\Delta$       producing well  $\bullet$       plugged injection well  $\square$   
 other injection well  $\blacktriangle$       temporary abandoned well  $\blacksquare$   
 D & A well  $\circ$       water supply well  $\odot$   
 plugged producer  $\bullet$

RECEIVED  
KANSAS CORPORATION COMMISSION  
MAR 20 2008  
CONSERVATION DIVISION  
WICHITA, KS

The undersigned hereby certifies that he / she is a duly authorized agent for \_\_\_\_\_, and that all of the information shown herein is true, complete and correct to the best of his / her knowledge.

#24 3465 FSL 5155 FEL SW SW 4

\_\_\_\_\_  
Applicant or Duly Authorized Agent

Subscribed and sworn before me this \_\_\_\_\_ day of \_\_\_\_\_

\_\_\_\_\_  
Notary Public

My Commission Expires: \_\_\_\_\_

**KANSAS CORPORATION COMMISSION  
OIL & GAS CONSERVATION DIVISION  
APPLICATION FOR SURFACE PIT**

Form CDP-1  
April 2004  
Form must be Typed

*Submit in Duplicate*

Operator Name: <b>N &amp; W Enterprises, Inc</b>		License Number: <b>6766</b>
Operator Address: <b>1111 S Margrave</b>		<b>Fort Scott KS 66701</b>
Contact Person: <b>Tom Norris</b>		Phone Number: <b>620-223-6559</b>
Lease Name & Well No.: <b>Hammerbacher Inj 4</b>		Pit Location (QQQQ): <b>E<sup>2</sup> NW</b>
Type of Pit: <input type="checkbox"/> Emergency Pit <input type="checkbox"/> Burn Pit <input type="checkbox"/> Settling Pit <input checked="" type="checkbox"/> Drilling Pit <input type="checkbox"/> Workover Pit <input type="checkbox"/> Haul-Off Pit <small>(If WP Supply API No. or Year Drilled)</small>	Pit is: <input checked="" type="checkbox"/> Proposed <input type="checkbox"/> Existing If Existing, date constructed: _____ Pit capacity: _____ (bbls)	Sec. <b>29</b> Twp. <b>28</b> R. <b>22</b> <input checked="" type="checkbox"/> East <input type="checkbox"/> West <b>2,970</b> Feet from <input type="checkbox"/> North / <input checked="" type="checkbox"/> South Line of Section <b>3,960</b> Feet from <input checked="" type="checkbox"/> East / <input type="checkbox"/> West Line of Section <b>Crawford</b> County
Is the pit located in a Sensitive Ground Water Area? <input type="checkbox"/> Yes <input checked="" type="checkbox"/> No		Chloride concentration: _____ mg/l <small>(For Emergency Pits and Settling Pits only)</small>
Is the bottom below ground level? <input checked="" type="checkbox"/> Yes <input type="checkbox"/> No	Artificial Liner? <input type="checkbox"/> Yes <input checked="" type="checkbox"/> No	How is the pit lined if a plastic liner is not used? <b>Mud</b>
Pit dimensions (all but working pits): <u>5</u> Length (feet) <u>5</u> Width (feet) <input type="checkbox"/> N/A: Steel Pits Depth from ground level to deepest point: <u>4</u> (feet) <input type="checkbox"/> No Pit		
If the pit is lined give a brief description of the liner material, thickness and installation procedure.		Describe procedures for periodic maintenance and determining liner integrity, including any special monitoring.
		<b>RECEIVED</b> KANSAS CORPORATION COMMISSION <b>MAR 20 2008</b> CONSERVATION DIVISION WICHITA, KS
Distance to nearest water well within one-mile of pit _____ feet    Depth of water well _____ feet	Depth to shallowest fresh water _____ feet. Source of information: <input type="checkbox"/> measured <input type="checkbox"/> well owner <input type="checkbox"/> electric log <input type="checkbox"/> KDWR	
<b>Emergency, Settling and Burn Pits ONLY:</b> Producing Formation: _____ Number of producing wells on lease: _____ Barrels of fluid produced daily: _____ Does the slope from the tank battery allow all spilled fluids to flow into the pit? <input type="checkbox"/> Yes <input type="checkbox"/> No	<b>Drilling, Workover and Haul-Off Pits ONLY:</b> Type of material utilized in drilling/workover: <u>Water</u> Number of working pits to be utilized: <u>2</u> Abandonment procedure: <u>Fill with earth</u> Drill pits must be closed within 365 days of spud date.	
I hereby certify that the above statements are true and correct to the best of my knowledge and belief.		
<u>03/16/2008</u> Date	 Signature of Applicant or Agent	

15-037-21964-0000

<b>KCC OFFICE USE ONLY</b>		Steel Pit <input type="checkbox"/>	RFAC <input type="checkbox"/>	RFAS <input type="checkbox"/>
Date Received: <u>3/20/08</u>	Permit Number: _____	Permit Date: <u>3/20/08</u>	Lease Inspection: <input type="checkbox"/> Yes <input checked="" type="checkbox"/> No	

Mail to: KCC - Conservation Division, 130 S. Market - Room 2078, Wichita, Kansas 67202



*Kathleen Sebelius, Governor  
Thomas E. Wright, Chairman  
Michael C. Moffet, Commissioner  
Joseph F. Harkins, Commissioner*

**NOTICE TO OPERATORS FILING INTENT TO DRILL  
FOR DISPOSAL OR ENHANCED RECOVERY  
INJECTION WELLS, (CLASS II INJECTION WELL)**

The attached approved Notice of Intent to Drill indicates the proposed well is to be used for injection. An approved "Intent to Drill" does not approve injection authority as a Class II Injection Well in Kansas.

Before any well is used for injection purposes, the operator must file an application for injection authority in accordance with K.A.R. 82-3-401 and provide notice in accordance with K.A.R. 82-3-402. The Conservation Division must issue a written permit granting the application before commencement of injection.

The Conservation Division requirements and restrictions associated with Class II Injection are identified in **K.A.R. 82-3-400 et seq** of our regulations. Associated regulations governing drilling, completion and injection applications may be found in K.A.R. 82-3-135, Table I, Table II, in the Cedar Hills Sandstone Moratorium, (Docket #156,397-C), and the Eastern Kansas Surface Casing Order, (Docket #133,891-C).

If you have questions regarding the approval of injection authority, an injection application may be filed as a "Design Approval" before actual drilling and completion of the well occurs. If you have any questions or concerns regarding Class II injection wells or regulations, call the Underground Injection Control Department at 316-337-6200.

Failure to obtain commission approval before beginning injection is punishable by a penalty, shut-in of the well or both.