

For KCC Use: 3-26-08
 Effective Date: _____
 District # 1
 SGA? Yes No

KANSAS CORPORATION COMMISSION
 OIL & GAS CONSERVATION DIVISION

Form C-1
 October 2007
 Form must be Typed
 Form must be Signed
 All blanks must be Filled

NOTICE OF INTENT TO DRILL

Must be approved by KCC five (5) days prior to commencing well

Expected Spud Date: April 6 2008
month day year

OPERATOR: License# 32198
 Name: PetroSantander (USA) Inc.
 Address 1: 6363 Woodway Drive, Ste. 350
 Address 2: _____
 City: Houston State: TX Zip: 77057 + 1 7 9 8
 Contact Person: Liliana Hernandez
 Phone: 713-784-8700

CONTRACTOR: License# 5142
 Name: Sterling Drilling Company

Well Drilled For: Oil Gas Seismic; # of Holes _____
 Enh Rec Storage Disposal Other: _____
 Well Class: Infield Pool Ext. Wildcat Other _____
 Type Equipment: Mud Rotary Air Rotary Cable

If OWWO: old well information as follows:
 Operator: _____
 Well Name: _____
 Original Completion Date: _____ Original Total Depth: _____

Directional, Deviated or Horizontal wellbore? Yes No
 If Yes, true vertical depth: _____
 Bottom Hole Location: _____
 KCC DKT #: _____

Spot Description: _____
SE - SE - SW Sec. 2 Twp. 33 S. R. 30 E W
(Q/Q/Q/Q)
658 feet from N / S Line of Section
1,981 feet from E / W Line of Section

Is SECTION: Regular Irregular?
 (Note: Locate well on the Section Plat on reverse side)

County: Meade
 Lease Name: Stevens (Morrow) Unit Well #: SMU 214
 Field Name: Stevens

Is this a Prorated / Spaced Field? Yes No
 Target Formation(s): Morrow

Nearest Lease or unit boundary line (in footage): 658
 Ground Surface Elevation: 2718 feet MSL

Water well within one-quarter mile: Yes No
 Public water supply well within one mile: Yes No

Depth to bottom of fresh water: ~ 540
 Depth to bottom of usable water: 580

Surface Pipe by Alternate: I II
 Length of Surface Pipe Planned to be set: 1500

Length of Conductor Pipe (if any): (none)
 Projected Total Depth: 5900

Formation at Total Depth: Mississippian
 Water Source for Drilling Operations:
 Well Farm Pond Other: _____

DWR Permit #: _____
 (Note: Apply for Permit with DWR)

Will Cores be taken? Yes No
 If Yes, proposed zone: _____

AFFIDAVIT

RECEIVED
 KANSAS CORPORATION COMMISSION

MAR 21 2008

The undersigned hereby affirms that the drilling, completion and eventual plugging of this well will comply with K.S.A. 55 et. seq.

It is agreed that the following minimum requirements will be met:

1. Notify the appropriate district office **prior** to spudding of well;
2. A copy of the approved notice of intent to drill **shall be** posted on each drilling rig;
3. The minimum amount of surface pipe as specified below **shall be set** by circulating cement to the top; in all cases surface pipe **shall be set** through all unconsolidated materials plus a minimum of 20 feet into the underlying formation.
4. If the well is dry hole, an agreement between the operator and the district office on plug length and placement is necessary **prior to plugging**;
5. The appropriate district office will be notified before well is either plugged or production casing is cemented in;
6. If an ALTERNATE II COMPLETION, production pipe shall be cemented from below any usable water to surface within **120 DAYS** of spud date. Or pursuant to Appendix "B" - Eastern Kansas surface casing order #133,891-C, which applies to the KCC District 3 area, alternate II cementing must be completed within 30 days of the spud date or the well shall be plugged. **In all cases, NOTIFY district office** prior to any cementing.

I hereby certify that the statements made herein are true and correct to the best of my knowledge and belief.

Date: 03/20/08 Signature of Operator or Agent: Liliana Hernandez Title: Senior Engineer

For KCC Use ONLY
 API # 15 - 119-21203-0000
 Conductor pipe required None feet
 Minimum surface pipe required 600 feet per ALT. I II
 Approved by: 3-21-08
 This authorization expires: 3-21-09
(This authorization void if drilling not started within 12 months of approval date.)
 Spud date: _____ Agent: _____

Remember to:

- File Drill Pit Application (form CDP-1) with Intent to Drill;
- File Completion Form ACO-1 within 120 days of spud date;
- File acreage attribution plat according to field proration orders;
- Notify appropriate district office 48 hours prior to workover or re-entry;
- Submit plugging report (CP-4) after plugging is completed (within 60 days);
- Obtain written approval before disposing or injecting salt water.
- If this permit has expired (See: authorized expiration date) please check the box below and return to the address below.

Well Not Drilled - Permit Expired Date: _____
 Signature of Operator or Agent: _____

2
33
30
 E
 W

IN ALL CASES PLOT THE INTENDED WELL IN A PRORATED OR SPACED FIELD

PLAT OF ACREAGE ATTRIBUTABLE TO A WELL IN A PRORATED OR SPACED FIELD

If the intended well is in a prorated or spaced field, please fully complete this side of the form. If the intended well is in a prorated or spaced field complete the plat below showing that the well will be properly located in relationship to other wells producing from the common source of supply. Please show all the wells and within 1 mile of the boundaries of the proposed acreage attribution unit for gas wells and within 1/2 mile of the boundaries of the proposed acreage attribution unit for oil wells.

API No. 15- 119-21203-0000
 Operator: PetroSantander (USA) Inc.
 Lease: Stevens (Morrow) Unit
 Well Number: 214
 Field: Stevens
 NUMBER OF ACRES ATTRIBUTABLE TO WELL _____
 QTR/QTR/QTR OF ACREAGE SE-SE-SW

Location of Well: County: Meade
658 feet from N / S Line of Section
1981 feet from E / W Line of Section
 Sec. 2 Twp. 33S R. 30 E W
 IS SECTION X REGULAR or _____ IRREGULAR
If Section is irregular, locate well from nearest corner boundary
 Section corner used: _____ NE _____ NW _____ SE _____ SW

PLAT

*(Show location of the well and shade attributable acreage for prorated or spaced wells.)
 (Show footage to the nearest lease or unit boundary line.)*

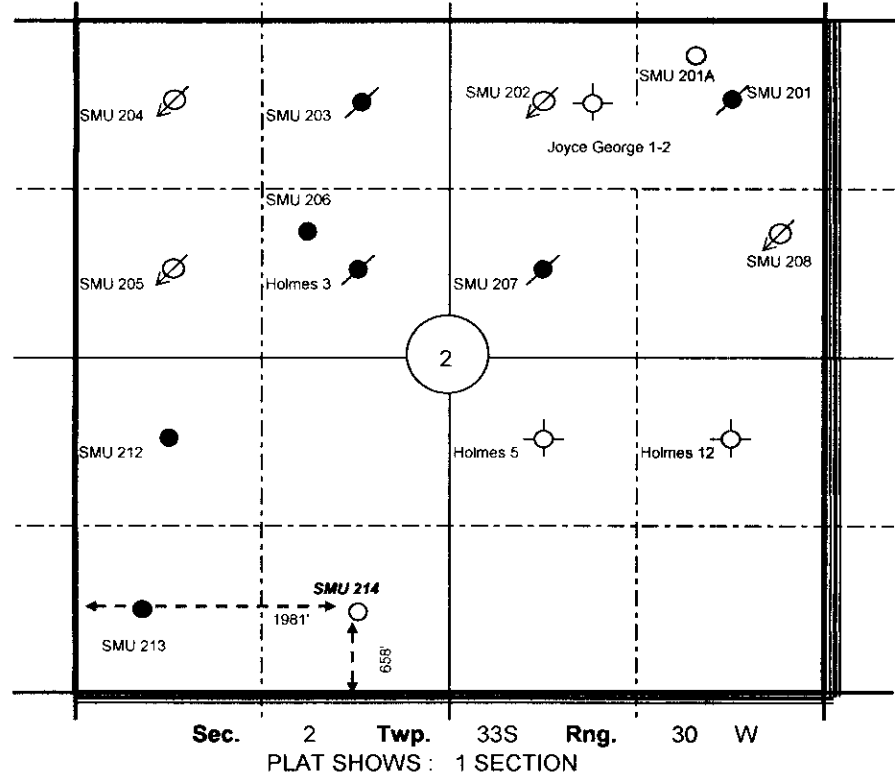

RECEIVED
 KANSAS CORPORATION COMMISSION
 MAR 21 2008
 CONSERVATION DIVISION
 WICHITA, KS

In plotting the proposed location of the well, you must show:

1. The manner in which you are using the depicted plat by identifying section lines, i.e. 1 section, 1 section with 8 surrounding sections, 4 sections, etc.
2. The distance of the proposed drilling location from the section's south / north and east / west.
3. The distance to the nearest lease or unit boundary line.
4. If proposed location is located within a prorated or space field a certificate of acreage attribution plat must be attached: (C0-7 for oil wells; CG-8 for gas wells).

**KANSAS CORPORATION COMMISSION
OIL & GAS CONSERVATION DIVISION
APPLICATION FOR SURFACE PIT**

Form CDP-1
April 2004
Form must be Typed

Submit in Duplicate

Operator Name: PetroSantander (USA) Inc.		License Number: 32198
Operator Address: 6363 Woodway Drive, Ste. 350		
Contact Person: Liliana Hernandez		Phone Number: 713-784-8700
Lease Name & Well No.: SMU 214		Pit Location (QQQQ): SE SE SW
Type of Pit: <input type="checkbox"/> Emergency Pit <input type="checkbox"/> Burn Pit <input type="checkbox"/> Settling Pit <input checked="" type="checkbox"/> Drilling Pit <input type="checkbox"/> Workover Pit <input type="checkbox"/> Haul-Off Pit <small>(If WP Supply API No. or Year Drilled)</small>	Pit is: <input checked="" type="checkbox"/> Proposed <input type="checkbox"/> Existing If Existing, date constructed: _____ Pit capacity: 10,000 (bbls)	Sec. 2 Twp. 33 R. 30 <input type="checkbox"/> East <input checked="" type="checkbox"/> West 658 Feet from <input type="checkbox"/> North / <input checked="" type="checkbox"/> South Line of Section 1,981 Feet from <input type="checkbox"/> East / <input checked="" type="checkbox"/> West Line of Section Meade County
Is the pit located in a Sensitive Ground Water Area? <input type="checkbox"/> Yes <input checked="" type="checkbox"/> No		Chloride concentration: _____ mg/l <small>(For Emergency Pits and Settling Pits only)</small>
Is the bottom below ground level? <input checked="" type="checkbox"/> Yes <input type="checkbox"/> No	Artificial Liner? <input type="checkbox"/> Yes <input checked="" type="checkbox"/> No	How is the pit lined if a plastic liner is not used? Natural Clay and Drilling Mud
Pit dimensions (all but working pits): 125 Length (feet) 125 Width (feet) <input checked="" type="checkbox"/> N/A: Steel Pits Depth from ground level to deepest point: 4 (feet) <input type="checkbox"/> No Pit		
If the pit is lined give a brief description of the liner material, thickness and installation procedure.		Describe procedures for periodic maintenance and determining liner integrity, including any special monitoring.
Distance to nearest water well within one-mile of pit 4321 feet Depth of water well 320 feet		Depth to shallowest fresh water 168 feet. Source of information: <input type="checkbox"/> measured <input type="checkbox"/> well owner <input type="checkbox"/> electric log <input type="checkbox"/> KDWR
Emergency, Settling and Burn Pits ONLY: Producing Formation: _____ Number of producing wells on lease: _____ Barrels of fluid produced daily: _____ Does the slope from the tank battery allow all spilled fluids to flow into the pit? <input type="checkbox"/> Yes <input type="checkbox"/> No		Drilling, Workover and Haul-Off Pits ONLY: Type of material utilized in drilling/workover: drilling mud Number of working pits to be utilized: 3 Abandonment procedure: backfill and level when sufficiently dry Drill pits must be closed within 365 days of spud date.
I hereby certify that the above statements are true and correct to the best of my knowledge and belief.		
03/20/08 Date	<i>Liliana Hernandez</i> Signature of Applicant or Agent	RECEIVED KANSAS CORPORATION COMMISSION MAR 21 2008 CONSERVATION DIVISION WICHITA, KS
KCC OFFICE USE ONLY		
Steel Pit <input type="checkbox"/> RFAC <input type="checkbox"/> RFAS <input type="checkbox"/>		
Date Received: 3/21/08 Permit Number: _____ Permit Date: _____ Lease Inspection: <input type="checkbox"/> Yes <input type="checkbox"/> No		

15-119-21203-0000