

STATE OF KANSAS
STATE CORPORATION COMMISSION

Give All Information Completely
Make Required Affidavit
Mail or Deliver Report to:
Conservation Division
State Corporation Commission
211 No. Broadway
Wichita, Kansas

WELL PLUGGING RECORD

NORTH

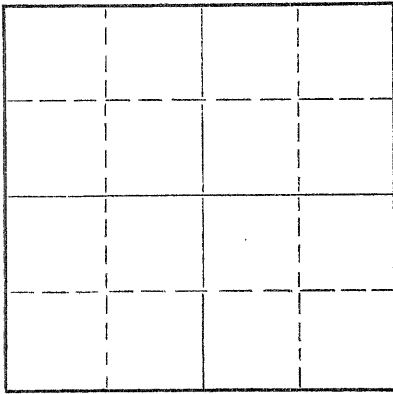

Locate well correctly on above
Section Plat

Graham County. Sec. 32 Twp. 8 Rge. (E) 21 (W)
Location as "NE/CNW/SW" or footage from lines SE NW NW
Lease Owner Jones, Shelburne & Farmer, Inc.
Lease Name EVERIST Well No. 1
Office Address Russell, Kansas
Character of Well (completed as Oil, Gas or Dry Hole) Dry
Date well completed 11-6 1956
Application for plugging filed 11-6 1956
Application for plugging approved 11-6 1956
Plugging commenced 11-6 1956
Plugging completed 11-6 1956
Reason for abandonment of well or producing formation Dry

If a producing well is abandoned, date of last production 19
Was permission obtained from the Conservation Division or its agents before plugging was commenced? yes

Name of Conservation Agent who supervised plugging of this well Eldon Petty
Producing formation _____ Depth to top _____ Bottom _____ Total Depth of Well 3766 Feet
Show depth and thickness of all water, oil and gas formations.

OIL, GAS OR WATER RECORDS

CASING RECORD

FORMATION	CONTENT	FROM	TO	SIZE	PUT IN	PULLED OUT
				8-5/8	165	None

Describe in detail the manner in which the well was plugged, indicating where the mud fluid was placed and the method or methods used in introducing it into the hole. If cement or other plugs were used, state the character of same and depth placed, from _____ feet to _____ feet for each plug set.

1. Filled hole with heavy mud
2. Pushed plug to 160
3. Dumped 1/2 sack hulls on top of plug
4. Mixed 15 sacks cement and dumped on top of hulls
5. Filled hole to top
6. Pushed plug to 40 feet
7. Dumped in 1/2 sack hulls
8. Mixed 10 sacks cement and filled hole to top with same.

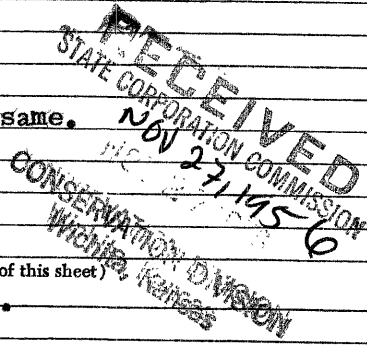

(If additional description is necessary, use BACK of this sheet)

Name of Plugging Contractor Jones, Shelburne & Farmer, Inc.
Address Russell, Kansas

STATE OF Kansas, COUNTY OF Russell, ss.
JOHN O. FARMER (employee of owner) or (owner or operator) of the above-described well, being first duly sworn on oath, says: That I have knowledge of the facts, statements, and matters herein contained and the log of the above-described well as filed and that the same are true and correct. So help me God.

(Signature) [Handwritten Signature]
Russell, Kansas
(Address)

SUBSCRIBED AND SWORN TO before me this 12th day of November, 19 56

My commission expires 10-11-58
[Handwritten Signature] Notary Public.

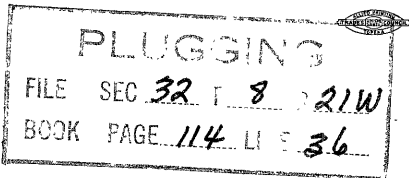

OPERATOR Jones, Shelburne & Farmer, Inc.

ADDRESS Russell, Kansas

FORMATION RECORD

Give detailed description and thickness of all formations drilled through, contents of sand, whether dry, water, oil or gas.

15-065-00912-00-02
 SEC. 32, TWP. 8, RGE. 21
 COUNTY GRAHAM
 WELL NO. 1
 FARM NAME EVERIST

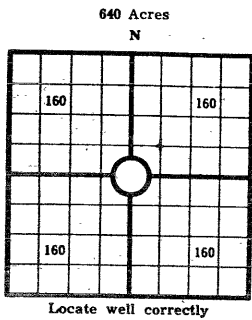

COUNTY Graham SEC. 32 TWP. 8 RGE. 21
 COMPANY OPERATING Jones, Shelburne & Farmer, Inc.
 OFFICE ADDRESS Russell, Kansas
 FARM NAME EVERIST WELL NO. 1
 DRILLING STARTED 10-27-56 DRILLING FINISHED 11-6, 1956
 DATE OF FIRST PRODUCTION _____ COMPLETED _____
 WELL LOCATED SE 1/4 NW 1/4 NW 1/4 North of South
 Line and _____ ft. East of West Line of Quarter Section
 Elevation (Relative to sea level) DERRICK FLOOR 2190 GROUND 2187
 CHARACTER OF WELL (Oil, gas or dryhole) Dry

OIL OR GAS SANDS OR ZONES

Name	From	To	Name	From	To
			4		
			5		
			6		

Performing Record If Any

Shot Record

Formation	From	To	No. of Shots	Formation	From	To	Size of Shot

CASING RECORD

Amount Set				Amount Pulled		Packer Record	
Size	Thds.	Make	Ft.	In.	Ft.	In.	Make
8-5/8			165				

Liner Record: Amount _____ Kind _____ Top _____ Bottom _____

CEMENTING AND MUDDING

Size	Amount Set		Sacks Cement	Chemical		Method of Cementing	Amount	Mudding Method	Results (See Note)
	Ft.	In.		Gal.	Make				
8-5/8	165		100						

Note: What method was used to protect sands if outer strings were pulled? _____

NOTE: Were bottom hole plugs used? _____ If so, state kind, depth set and results obtained _____

TOOLS USED

Rotary Tools were used from _____ feet to _____ Cable tools were used from _____ feet to _____ feet, and from _____ feet to _____ feet, and from _____ feet to _____ feet to _____

Type Rig _____

INITIAL PRODUCTION TEST

Describe initial test: whether by flow through tubing or casing or by pumping _____

Amount of Oil Production _____ bbls. Size of choke, if any _____ Length of test _____ Water

Production _____ bbls. Gravity of oil _____ Type of Pump if pump is used, describe _____

Formation	Top	Bottom	Formation	Top	Bottom
Surface	0	165			
Shale	165	1080			
Shale & sand	1080	1215			
Sand	1215	1455			
RedBed	1455	1727			
Anhydrite	1727	1758			
Shale & shells	1758	2245			
Shale & lime	2245	2938			
Lime & shale	2938	3015			
Shale & lime	3015	3245			
Lime & shale	3245	3675			
Shale & lime	3675	3735			
Arbuckle	3735	3766			
T.D.					3766
D & A					

SAMPLE TOPS:

Elevation RB	2192
Anhdrite	1727
Topeka	3175
Heebner	3361
Toronto	3383
Lansing	3401
B/Kansas City	3609
Arbuckle	3735
T.D.	3766
D & A	

PLUGGERS
 FILE SEC 32 T 8 RGE 21
 BOOK PAGE 14 LINE 36

I, the undersigned, being first duly sworn upon oath, state that this well record is true, correct and complete according to the records of this office and to the best of my knowledge and belief.

John W. Farwood - Pres.
 Name and title of representative of company

Subscribed and sworn to before me this 12th day of November, 19 56
 My Commission expires 10-11-1956
Lucius L. ...
 Notary Public.