

STATE OF KANSAS  
STATE CORPORATION COMMISSION  
CONSERVATION DIVISION  
245 North Water  
WICHITA, KANSAS 67202

Rev. 6-3-74  
FORM CP-1

RECEIVED  
STATE CORPORATION COMMISSION  
10/1/80  
OCT - 1 1980  
CONSERVATION DIVISION  
Wichita, Kansas

WELL PLUGGING APPLICATION FORM  
File One Copy

API Number 15 - 173 - 20,261-00-00 (of this well)  
Lease Owner Walnut Valley Oil, Inc.  
Address 150 So. Rock Rd., Wichita, Ks. 67207  
Lease (Farm Name) V.E. KUZAP Lygrisse #1 Well No. \_\_\_\_\_  
Well Location 40' S of SESENW Sec. 15 Twp. 26S Rge. 2E (E) \_\_\_\_\_ (W) \_\_\_\_\_  
County Sedgwick Total Depth 3370' Field Name \_\_\_\_\_  
Oil Well \_\_\_\_\_ Gas Well \_\_\_\_\_ Input Well \_\_\_\_\_ SWD Well \_\_\_\_\_ Rotary D & A X  
Well Log attached with this application as required Yes  
Date and hour plugging is desired to begin 10-6-80 8:00 AM

PLUGGING OF THIS WELL WILL BE DONE IN ACCORDANCE WITH K.S.A. 55-128 OF THE RULES AND REGULATIONS OF THE STATE CORPORATION COMMISSION.

Name of company representative authorized to be in charge of plugging operations:

Dale Smith

Address Box 837, Winfield, Ks. 67156

Plugging Contractor B & S Well Service License No. 685

Address Box 837, Winfield, Ks. 67156

Invoice covering assessment for plugging this well should be sent to:

Name Walnut Valley Oil, Inc.

Address 150 So. Rock Rd., Wichita, Ks. 67207

and payment will be guaranteed by applicant or acting agent.

Signed:

Barbara A. Hunter  
Applicant or Acting Agent  
Barbara A. Hunter, Sec.

Date: 9-30-80

**WELL COMPLETION REPORT AND  
DRILLER'S LOG**

S. 15 T. 26S R. 2E W  
 Loc. 40' S of SE SE NW  
 County Sedgwick

API No. 15 — 173 — 20,261 — 00 — 00  
 County Number

Operator  
Walnut Valley Oil, Inc.

Address  
150 S. Rock Road Wichita, KS 67207

Well No. 1 Lease Name  
V.E. KCCZAP  
Lygrisse

Footage location  
 feet from (N) (S) line — feet from (E) (W) line

Principal Contractor  
Aspen Oil, Inc. Geologist  
Robert Braden

Spud Date  
3-28-80 Date Completed  
4-09-80 Total Depth  
3370' P.B.T.D.

Directional Deviation Oil and/or Gas Purchaser

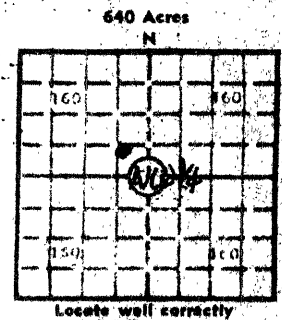

Elev.: Gr. 1387  
 DF KB 1393

**CASING RECORD**

Report of all strings set — surface, intermediate, production, etc.

Purpose of string	Size hole drilled	Size casing set (in O.D.)	Weight lbs/ft.	Setting depth	Type cement	Socks	Type and percent additives
Surface	12 1/2"	8 5/8"		203'	Common	100	
Production	7 7/8"	4 1/2"	10 1/2#	3461'	Common	150	

**LINER RECORD**

**PERFORATION RECORD**

Top, ft.	Bottom, ft.	Sacks cement	Shots per ft.	Size & type	Depth interval
			2	3 1/2" DMI	3195'
			n 1 1/2	3 1/2" DMI	2896' - 2899'

Size	Setting depth	Packer set at

**ACID, FRACTURE, SHOT, CEMENT SQUEEZE RECORD**

Amount and kind of material used	Depth interval treated
NONE	

RECEIVED  
 STATE CORPORATION COMMISSION  
 10/1/80  
 OCT 1 1980

**INITIAL PRODUCTION**

Date of first production	Producing method (flowing, pumping, gas lift, etc.)
NONE	

RATE OF PRODUCTION PER 24 HOURS	Oil	Gas	Water	Gas-oil ratio
	bbls.	MCF	bbls.	CFPB

Disposition of gas (vented, used on lease or sold)	Producing interval(s)

CONSERVATION DIVISION  
 Wichita, Kansas

INSTRUCTIONS: As provided in KCC Rule 82-2-125, within 90 days after completion of a well, one completed copy of this Drillers Log shall be transmitted to the State Geological Survey of Kansas, 4150 Monroe Street, Wichita, Kansas 67209. Copies of this form are available from the Conservation Division, State Corporation Commission, 245 No. Water, Wichita, Kansas 67202. Phone AC 316-522-2206. If confidential custody is desired, please note Rule 82-2-125. Drillers Logs will be on open file in the Oil and Gas Division, State Geological Survey of Kansas, Lawrence, Kansas 66044.

Operator  
Walnut Valley Oil, Inc.

DESIGNATE TYPE OF COMP.: OIL, GAS,  
DRY HOLE, SWDW, ETC.:

Well No.  
1

Lease Name  
Lygrisse

DRY HOLE

S 15 T 26 S R 2 E W

**WELL LOG**

Show all important zones of porosity and contents thereof; cored intervals, and all drill-stem tests, including depth interval tested, cushion used, time tool open, flowing and shut-in pressures, and recoveries.

SHOW GEOLOGICAL MARKERS, LOGS RUN,  
OR OTHER DESCRIPTIVE INFORMATION.

FORMATION DESCRIPTION, CONTENTS, ETC.	TOP	BOTTOM	NAME	DEPTH
Sand	0	150		
Top soil	150	418		
Shale	418	1115		
Shale / Lime	1115	1997		
Shale	1997	2143		
Shale / Lime	2143	2409		
Lime / Shale	2409	2677		
Shale / Lime	2677	2770		
Lime / Shale	2770	2965		
Lime	2965	3347		
Shale / Lime	3347	3370	T.D.	

USE ADDITIONAL SHEETS, IF NECESSARY, TO COMPLETE WELL RECORD.

Date Received

*Robert Brown*  
Signature  
President  
8-15-80  
Date