

STATE OF KANSAS
STATE CORPORATION COMMISSION

Form CP-4

WELL PLUGGING RECORD

Give All Information Completely
Make Required Affidavit
Mail or Deliver Report to:
Conservation Division
State Corporation Commission
212 No. Market
Wichita, Kansas

Graham

County. Sec. 29 Twp. 8S Rge. (E) 22 (W)

Location as "NE/CNW/SW" or footage from lines. NE/4 SW/4 NW/4

Lease Owner Skelly Oil Company

Lease Name J. M. Moore Well No. 2

Office Address 1860 Lincoln Street, Denver, Colo. 80203

Character of Well (completed as Oil, Gas or Dry Hole) Oil

Date well completed May 21, 19 59

Application for plugging filed September 21 19 67

Application for plugging approved September 22, 19 67

Plugging commenced October 23, 19 67

Plugging completed October 25, 19 67

Reason for abandonment of well or producing formation Uneconomical to operate

If a producing well is abandoned, date of last production Shut Down 7/25 19 66

Was permission obtained from the Conservation Division or its agents before plugging was commenced? Yes

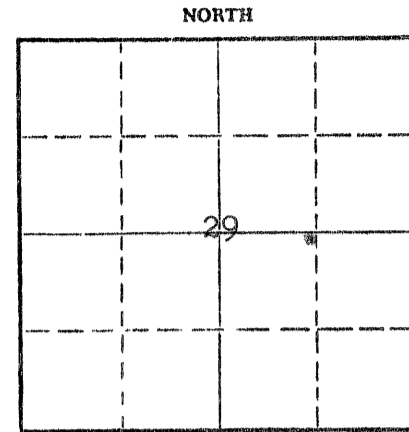

Locate well correctly on above Section Plat

Name of Conservation Agent who supervised plugging of this well Mr. W. L. Nichols

Producing formation Lansing Lime Depth to top 3431' Bottom _____ Total Depth of Well 3700' Feet

Show depth and thickness of all water, oil and gas formations. PB 3658'

OIL, GAS OR WATER RECORDS

CASING RECORD

FORMATION	CONTENT	FROM	TO	SIZE	PUT IN	PULLED OUT
Lansing Lime	Oil	3506'	3618'	8-5/8"	234 1/2'	None
					3727'	3168'

Describe in detail the manner in which the well was plugged, indicating where the mud fluid was placed and the method or methods used in introducing it into the hole. If cement or other plugs were used, state the character of same and depth placed, from _____ feet to _____ feet for each plug set.

Sand		3658'	to	3490'		
5 sacks of cement		3490'	to	3450'		
20 sacks of gel and 5 sacks of hulls		3450'	to	1175'		
100 sacks of cement		1175'	to	850'		
12 sacks of gel		850'	to	260'		
20 sacks of cement		260'	to	190'		
3 sacks of gel		190'	to	30'		
10 sacks of cement		30'	to	6'		
Surface soil		6'	to	Surface		

RECEIVED
NOV 26 1967
CONSERVATION DIVISION
Wichita, Kansas

(If additional description is necessary, use BACK of this sheet)

Name of Plugging Contractor Southwest Casing Pulling Co., Inc.

Address P. O. Box 364, Great Bend, Kansas 67530

STATE OF Colorado, COUNTY OF Denver, ss.

J. G. George (employee of owner) or (owner or operator) of the above-described well, being first duly sworn on oath, says: That I have knowledge of the facts, statements, and matters herein contained and the log of the above-described well as filed and that the same are true and correct. So help me God.

(Signature) Leland Frank
1860 Lincoln St., Denver, Colo. 80203
(Address)

SUBSCRIBED AND SWORN TO before me this 17th day of November, 19 67.

My commission expires My Commission expires June 17, 1970

[Signature]
Notary Public.

SKELLY OIL COMPANY

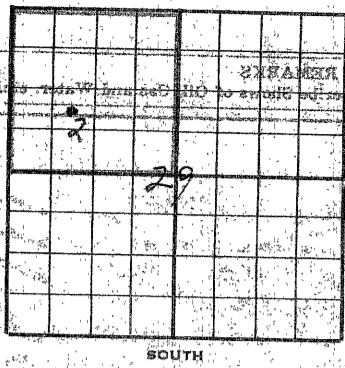

Well Record

Lease Name and No. L. R. Moore 14083 Well No. 2 Elev. 2177'

Lease Description NE/4 of Section 29-33-27N,
Graham County, Kansas (150 Acres)

Location made April 22, 1959 by L. R. Moore

feet from North line _____ feet from East line _____

feet from South line 990 feet from West line 990

Work com'd. 4/23 1959 Rig comp'd. 6/24 1959 Drlg. com'd. 4/24 1959 Drlg. comp'd. 5/7

Rig Contractor Claude Hentworth Drilling Co., Inc.

Drilling Contractor Claude Hentworth Drilling Co., Inc., Tulsa, Okla.

Rotary Drilling from 0' to 3700' Cable Tool Drilling from to complete to _____

Commenced Producing May 21, 1959 Initial Prod. before shot or acid show

Initial Prod. after shot or acid FOR 6 hrs. 25.4 BO. 2.24

Dry Gas Well Press. _____ Volume _____

Casing Head Gas Pressure _____ Volume _____

Braden Head (5/8" Size) Gas Pressure _____ Volume _____

Braden Head (_____ Size) Gas Pressure _____ Volume _____

PRODUCING FORMATION Linning Linn (Name) Top 3506' Bottom 3618' TOTAL DEPTH 3700'

CASING RECORD

OD	Size	Wt.	Thds.	Where Set	PULLED OUT			LEFT IN			KIND	Cond'n	CEMENTING	
					Jts.	Feet	In.	Jts.	Feet	In.			Sacks Used	Method Employed
	8-5/8"	22.7	24	235'				6	234	6	Armed 36"	A	169	Hallib. 232'
	6-1/2"	14.2	24	3700'				116	727	0	55 12 34 A	A	150	Hallib. 3698'
(8-5/8" casing set 1' below ground level and 5' set above ground level) 5' casing performance open Above 23 TD: 3506'-12' with 42 holes, 3559'-62' with 21 holes, 3582'-62' with 28 holes, 3593'-96' with 24 holes, and 3613'-18' with 35 holes Below 23 TD: none														

Liner Set at _____ Length _____ Perforated at _____

Liner Set at _____ Length _____ Perforated at _____

Packer Set at _____ Size and Kind _____

Packer Set at _____ Size and Kind _____

SHOT OR ACID TREATMENT RECORD

	FIRST	SECOND	THIRD	FOURTH
Date	<u>5/14/59</u>	<u>5/25/59</u>	<u>5/31/59</u>	
Acid Used				
Size Shot	<u>500</u>	<u>1500</u>	<u>500</u>	
Shot Between	<u>3613 Ft. and 3618 Ft.</u>	<u>3613 Ft. and 3618 Ft.</u>	<u>3593 Ft. and 3596 Ft.</u>	
Size of Shell				
Put in by (Co.)	<u>Halliburton</u>	<u>Halliburton</u>	<u>Halliburton</u>	
Length anchor				
Distance below Cas'g.				
Damage to Casing or Casing Shoulder				

SIGNIFICANT GEOLOGICAL FORMATIONS

NAME	Top	Bottom	GAS		OIL		REMARKS
			From	To	From	To	
<u>Apache Linn</u>	<u>3209'</u>						
<u>Harker Shale</u>	<u>3303'</u>						
<u>Dewey</u>	<u>3418'</u>						
<u>Linning Linn</u>	<u>3431'</u>				<u>3613'</u>	<u>3618'</u>	<u>Prod. thru cas. perf.</u>
<u>Even Run Clay</u>	<u>3637'</u>				<u>3593'</u>	<u>3596'</u>	<u>*</u>
<u>Harker Sand</u>	<u>3643'</u>				<u>3582'</u>	<u>3586'</u>	<u>*</u>
					<u>3559'</u>	<u>3562'</u>	<u>*</u>
					<u>3306'</u>	<u>3512'</u>	<u>*</u>

CLEANING OUT RECORDS

	DATE COMMENCED	DATE COMPLETED	PROD. BEFORE	PROD. AFTER	REMARKS
1st					<u>See Reverse for other det</u>
2nd					<u>" " " "</u>
3rd					<u>" " " "</u>
4th					<u>" " " "</u>

PLUGGING BACK AND DEEPENING RECORDS

	Date Commenced	Date Completed	No. Feet Plugged Back or Deepened	Prod. Before	Prod. After	REMARKS
1st						<u>See Reverse for other det</u>
2nd						<u>" " " "</u>
3rd						<u>" " " "</u>
4th						<u>" " " "</u>

(See Reverse for Record of Formation)

RECORD OF FORMATIONS

FORMATION	TOP	BOTTOM	REMARKS
surface soil and shale	0	150	Set and cemented 8-5/8" OD, 22.77, Armon, S.H., S.J. steel casing (A cond.) at 235' with 165 sacks of Pozmix cement with 3% calcium chloride. Cement circulated. Finished 7:30 p.m. 4/24/59.
shale	150	235	
shale and shells	235	1190	
shale and shells	1190	1350	
shale	1350	1520	
shale	1520	1690	
shale	1690	1775	TOP ANHYDRITE 1760'
shale and shells	1775	1810	BASE ANHYDRITE 1800'
shale	1810	2020	
shale	2020	2165	TOP WASHINGTON 2075'
shale and shells	2165	2385	BASE WASHINGTON 2250'
shale and lime	2385	3410	TOP NYA 2372'
lime	3410	3508	TOP NYA 2372'
lime, crystalline, slightly calcitic	3508	3512	TOP NYA 2372'
lime	3512	3515	TOP NYA 2372'
lime	3515	3566	TOP NYA 2372'
lime, finely crystalline	3566	3569	TOP NYA 2372'
lime	3569	3574	TOP NYA 2372'
lime	3574	3582	TOP NYA 2372'
light gray, finely crystalline	3582	3584	TOP NYA 2372'
lime	3584	3597	TOP NYA 2372'
light gray, finely crystalline	3597	3601	TOP NYA 2372'
lime	3601	3608	TOP NYA 2372'
lime	3608	3613	TOP NYA 2372'
light gray, finely crystalline	3613	3617	TOP NYA 2372'
lime	3617	3625	TOP NYA 2372'
lime	3625	3635	TOP NYA 2372'
lime, finely crystalline	3635	3637	TOP NYA 2372'
lime	3637	3644	TOP NYA 2372'
lime	3644	3700	TOP NYA 2372'
TOTAL DEPTH 3700'			
Total Depth Reached: 5/7/59			Has Halliburton drill stem test No. 5, packer set at 3622', used 62' anchor, open 1 hour, weak blow for 5 mins., INHP-0% in 20 mins., IFF-0%, YFP-0%, FHP-30% in 20 mins.

RECEIVED
 NOV 20 1967
 NATIONAL OILFIELD DIVISION
 NOV 20 1967

Has Helox Guard Log

Ben Halliburton drill stem test No. 6 with 18" anchor packer, found hole caved back from 3700' to 3690', unable to make packer hold. Cleaned out cavings and reconditioned hole and mud.

Ben Halliburton drill stem test No. 7, packer set at 3684', used 18" anchor, open 1 hour, work blow for 3 mins, recovered 5' mud, no oil, IHP-O₂ in 20 mins., IFF-O₂, FFF-O₂, 7HP-O₂ in 20 mins.

Set and cemented 5 1/2" OD, 147.8K chd., 2-2, 1-95, 5.8. casing (1 cond.) at 3700' with 150 sacks of special oil well cement, opened stage collar at 3145' with 6000-CP. Spotted 150 barrels of heavy oil behind 5 1/2" casing, oil circulated. Closed stage collar with 20000-CP. Finished conducting 9:00 a.m. 5/10/59.

On May 13, moved in and rigged up cable tools, snubbed hole dry to top of stage collar at 3145'. Drilled out stage collar and snubbed hole dry to top of cement plug at 3685'. Ben Lane-Wells collar locator:

Casing Perforation No. 1 - Logging Line - 3611'-3616'
3611'-3618' 15 4-2 holes
20 Lane shots

Slight show oil, no water. Treated through 5 1/2" casing with 300 gallons of Halliburton 15% acid as follows:

TREATMENT NO. 1 - Acidized between 3611' and 3616'

Treatment put in 5/14/59 by Halliburton, using 300 gallons of acid and 89 barrels of oil.

TIME	SP	IP	REMARKS
6:15 am	1500		Acid on formation
6:00 am	725		
6:05 am	675		
6:15 am	300		
6:20 am	500		
6:27 am	550		Treatment completed

Snubbed through 5 1/2" casing 6 hours, 89 barrels of oil used in treating; then snubbed 15 hours, 39 barrels formation oil with trace of water (last 8 hours averaged 1-3/4 barrel oil per hour with 1 1/2 water). Reacidized through 5 1/2" casing with 1500 gallons of Halliburton 15% acid as follows:

TREATMENT NO. 2 - Acidized between 3611' and 3616'

Treatment put in 5/15/59 by Halliburton, using 1500 gallons of acid and 98 barrels of oil.

TIME	SP	IP	REMARKS
9:51 am			Start acid
10:06 am			Acid on formation
10:09 am	625		
10:14 am	625		Treatment completed

Snubbed through 5 1/2" casing 7 hours, 98 barrels of oil used in treating; then snubbed 8 hours, 38 barrels of formation oil with trace of acid water (tested 3 1/2 barrels oil with trace acid water per hour for last 4 hours).

Set Lane-Wells bridging plug at 3685' and snubbed hole dry.

Casing Perforation No. 2 - Logging Line - 3591'-3596'
3595'-3598' 12 4-2 holes
12 Lane shots

Tested 1 hour, 20' oil with trace water in hole.

TREATMENT NO. 3 - Acidized between 3591' and 3596'

Treatment put in 5/15/59 by Halliburton, using 300 gallons of acid and 89 barrels of oil.

TIME	SP	IP	REMARKS
12:05 am			Start acid
12:18 am	07		Acid on formation
12:21 am	07		Treatment completed

No pressures, indicating communication. Snubbed through 5 1/2" casing 5 hours, 39 barrels of oil used in treating. On May 16, snubbed through 5 1/2" casing 7 hours, 41 barrels formation oil and 1 barrels water (last 3 hours, 1 barrel of oil per hour with 3% water).

Drove bridging plug from 3605' to 3664' and snubbed through 5 1/2" casing 8 hours, 29 barrels of oil and 1/2 barrel of water (1 1/2 barrels oil per hour with 2% water).

Set bridging plug at 3589' and bailed hole dry.

Casing Perforation No. 1 - Lansing Line - Between 3582' and 3586'
 12 A-2 holes
 16 Kone shots

Treated 1 barrel oil per hour. Treated through 5 1/2" casing with 500 gallons Halliburton 15% acid as follows:

TREATMENT NO. 4 - Acidized between 3582' and 3586'

Treatment put in 5/17/59 by Halliburton, using 500 gallons of acid and 88 barrels of oil.

TIME	IN	OUT	REMARKS
6:13 am			Start acid
6:27 am	0/		Acid on formation
7:30 am	0/		Treatment completed

Snubbed through 5 1/2" casing 5 hours, 88 barrels of oil used in treating with traces of water; then snubbed 8 hours, 29 barrels of oil and 1/2 barrel of water (1-3/4 barrel oil with 2% water per hour).

Drove bridging plug from 3589' to 3643'. Snubbed through 5 1/2" casing 8 hours, 33 barrels of oil and 2/3 barrel of water (last 4 hours, 3 1/2 barrels of oil per hour with 1/2 barrel water per hour). Reacidized through 5 1/2" casing with 2500 gallons Halliburton 17% acid as follows:

TREATMENT NO. 5 - Acidized between 3582' and 3586'

Treatment put in 5/18/59 by Halliburton, using 2500 gallons acid and 98 barrels of oil.

TIME	IN	OUT	REMARKS
1:00 pm			Start acid
1:23 pm			Hole loaded
1:27 pm	625/		Treatment completed

Snubbed through 5 1/2" casing 3 hours, 98 barrels oil used in treating; then snubbed 10 hours, 59 barrels oil and 1 1/4 barrels of water.

Set Lane-Wells bridging plug at 3574' and snubbed hole dry.

Casing Perforation No. 4 - Lansing Line - 3557'-3562'

3559'-3562' 9 A-2 holes
 12 Kone shots, no shows

Treated through 5 1/2" casing with 500 gallons Halliburton 15% acid as follows:

TREATMENT NO. 6 - Acidized between 3557' and 3562'

Treatment put in 5/19/59 by Halliburton, using 500 gallons of acid and 88 barrels of oil.

TIME	IN	OUT	REMARKS
1:15 pm			Start acid
1:30 pm	0/		Acid on formation
1:45 pm	0/		Start pump
1:50 pm	0/		Treatment completed

Snubbed through 5 1/2" casing 5 hours, 88 barrels oil used in treating; then snubbed 4 hours, 23 barrels of oil and 1/4 barrel of water.

Drove bridging plug from 3574' to 3660'. Set Lane-Wells bridging plug at 3520' and snubbed hole dry.

Casing Perforation No. 5 - Lansing Line 3506'-3512'

3508'-3512' 10 A-2 holes
 24 Kone shots, no shows

Treated through 5 1/2" casing with 500 gallons of Halliburton 15% acid as follows:

TREATMENT NO. 7 - Acidized between 3506' and 3512'

Treatment put in 5/20/59 by Halliburton, using 500 gallons of acid and 88 barrels of oil.

TIME	IN	OUT	REMARKS
2:35 am			Start acid
2:46 am	100/		Acid on formation
3:15 am	250/		
3:40 am	500/		
3:53 am	300/		
3:56 am	50/		
3:59 am	Var.		Treatment completed

SKELLY OIL COMPANY

CHANGE IN WELL RECORD

Give complete description of all cleaning out, deepening, plugging back and fishing jobs, changes in casing, material lost in hole, etc, not recorded in original well record.

LEASE NAME J. M. Moore
 SEC. 29 T. 25 R. 22W
 BLOCK _____ SURVEY _____

WELL NO. 2 DISTRICT Rocky Mountain
 COUNTY Graham AFE NO. 23153
 STATE Kansas

TYPE OF WORK PLUG AND ABANDON WELL

Date commenced October 23, 1967 Date completed October 25, 1967
 Deepened from _____ to _____ Total Depth _____
 Plugged back from 3658' to Surface P.B.T.D. _____
 Cleaned out from _____ to _____
 Production before Shut Down bbls. oil _____ bbls. water _____ cu. ft.
 Production after _____ bbls. oil _____ bbls. water _____ cu. ft.
 Tools owned by: Southwest Casing Pulling Co., Inc. Kind used: Pulling Unit No. days rig time: Cont.
 Cost of Job \$ _____ Revised Estimated Payout (Mos.) _____

TREATMENT RECORD

DATE	TYPE TREATMENT	INTERVAL TREATED	AMOUNT OF TREATMENT

CHANGES IN CASING RECORD

STRINGS	SIZE	WHERE SET (Depth)	CEMENTING RECORD		REMARKS
			Sacks Used	Top Cem't. Bh'd. Cas'g.	
Production					
Liner					Top liner;

SIZE	WT.	THDS.	KIND	COND.	LEFT IN				PULLED OUT					
					Jts.	LTM		WTM		Jts.	LTM		WTM	
						Feet	In.	Feet	In.		Feet	In.	Feet	In.
5-1/2"	145	BR	555 R2 SS	0	17	555	0	559	0	78	2486	0	2485	0
5-1/2"	145	BR	555 R2 SS	0						21	678	0	683	0

PRODUCING FROM

FORMATION _____ thru OPEN HOLE PERFORATIONS _____ TOP _____ BOTTOM _____ Total No. Shots _____

REMARKS (Give review of work performed and any other comment of interest)

As the well was Shut Down July 25, 1966, as uneconomical to operate and as there are no secondary recovery prospects, nor zones considered worthy of testing, regular authority was granted to plug and abandon it.

On October 10, 1967, moved in pulling unit of Brown Bros. and pulled tubing and rods. Moved out pulling unit.

On October 23, 1967, moved in machine of Southwest Casing Pulling Co., and plugged the well as follows:

Sand 3658' to 3690'
 5 sacks of cement 3690' to 3650'

Shot 5 1/2" casing at 3145' and pulled 3168' of 5 1/2" OD casing.

20 sacks of gel and 5 sacks of hulls 3450' to 1175'
 100 sacks of cement 1175' to 850'
 12 sacks of gel 850' to 260'
 20 sacks of cement 260' to 190'
 3 sacks of gel 190' to 30'
 10 sacks of cement 30' to 6'
 Surface soil 6' to Surface

Plugged and abandoned October 25, 1967.

Snubbed through 5 1/2" casing 3 hours, 86 barrels of oil used in treating; then snubbed through 5 1/2" casing 7 hours, 42 barrels of oil and 2 1/2 barrels of water.

Drove bridging plug from 3520' to 3658' SLK. Swabbed, bailed and cleaned up hole. Ran 2" tubing and rods. On May 21, PCH 4 hours, 32 barrels of oil and 2 barrels of water.

On May 21, PCH 8 hours on physical potential, 91.4 barrels of oil and 2.96 barrels of water to establish 24 hour State Corporation Commission potential of 28 1/2 barrels, 3 1/2 water. Allowable 28 barrels per day.

PLUGGED BACK TOTAL DEPTH 3658'

SLOPE TEST DATA	
DEPTH	ANGLE OF DEFLECTION
500'	0 degrees
750'	0 "
1250'	1/2 "
1750'	1/2 "
2000'	1/2 "
2450'	1/2 "
2700'	3/4 "