

KANSAS DRILLERS LOG

S. 35 T. 8S R. 18 ^{EX}_W

API No. 15 — 163 — 20,608 - 90-00
County Number

Loc. C NE NE NW

County Rooks

Operator
ABERCROMBIE DRILLING, INC.

Address
 801 Union Center, Wichita, Kansas 67202

Well No. 1 Lease Name RADKE "B"

Footage Location
330 feet from (N) line 2310 feet from (W) line

Principal Contractor Abercrombie Drilling, Inc. Geologist Charles Johnson

Spud Date March 10, 1976 Total Depth 3195' P.B.T.D.

Date Completed March 15, 1976 Oil Purchaser

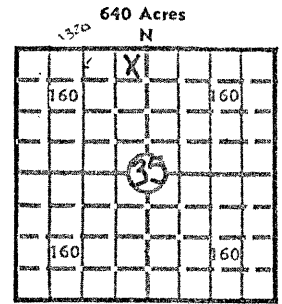

Locate well correctly
 Elev.: Gr. 1988'

DF 1994' KB 1996'

CASING RECORD

Report of all strings set — surface, intermediate, production, etc.

Purpose of string	Size hole drilled	Size casing set (in O.D.)	Weight lbs./ft.	Setting depth	Type cement	Sacks	Type and percent additives
Surface	12 1/4"	8 5/8"	28#	213 K.B.	Quick-set	160	

ma 23/1976

LINER RECORD

PERFORATION RECORD

Top, ft.	Bottom, ft.	Sacks cement	Shots per ft.	Size & type	Depth interval

TUBING RECORD		
Size	Setting depth	Packer set at

ACID, FRACTURE, SHOT, CEMENT SQUEEZE RECORD

Amount and kind of material used	Depth interval treated

INITIAL PRODUCTION

Date of first production		Producing method (flowing, pumping, gas lift, etc.)			
RATE OF PRODUCTION PER 24 HOURS	Oil bbls.	Gas MCF	Water bbls.	Gas-oil ratio CFPB	
Disposition of gas (vented, used on lease or sold)			Producing interval (s)		

INSTRUCTIONS: As provided in KCC Rule 82-2-125, within 90 days after completion of a well, one completed copy of this Drillers Log shall be transmitted to the State Geological Survey of Kansas, 4150 Monroe Street, Wichita, Kansas 67209. Copies of this form are available from the Conservation Division, State Corporation Commission, 3830 So. Meridian (P.O. Box 17027), Wichita, Kansas 66217. Phone AC 316-522-2206. If confidential custody is desired, please note Rule 82-2-125. Drillers Logs will be on an open file in the Oil and Gas Division, State Geological Survey of Kansas, Lawrence, Kansas 66044.

Operator

Abercrombie Drilling, Inc.

DESIGNATE TYPE OF COMP.: OIL, GAS, ~~WATER~~
DRY HOLE, SWDW, ETC.:

Well No.

1

Lease Name

RADKE "B"

Dry hole

S 35 T 8S R 18 ~~W~~
W

WELL LOG

SHOW GEOLOGICAL MARKERS, LOGS RUN,
OR OTHER DESCRIPTIVE INFORMATION.

Show all important zones of porosity and contents thereof; cored intervals, and all drill-stem tests, including depth interval tested, cushion used, time tool open, flowing and shut-in pressures, and recoveries.

FORMATION DESCRIPTION, CONTENTS, ETC.	TOP	BOTTOM	NAME	DEPTH
Clay & Rock	0	60		
Sand & Shale	60	160		
Shale	160	500		
Sand	500	600		
Shale & Sand	600	862		
Sand	862	1050		
Shale	1050	1349		
Anhydrite	1349	1386		
Shale	1386	1670		
Shale & Lime	1670	1925		
Lime & Shale	1925	3100		
Lime	3100	3195		
Rotary Total Depth		3195		

DST #1 (3133'-3160') 30", 45", 60", 45".
Fair blow. Rec. 70' gassy HOCH IFP 51-51#;
FFP 51-59#; IBHP 470#; FBHP 462#.

USE ADDITIONAL SHEETS, IF NECESSARY, TO COMPLETE WELL RECORD.

Date Received

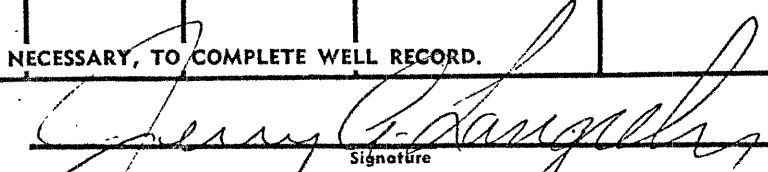
 Signature
 Jerry A. Langwehr, Executive Vice President
 Title
 March 19, 1976
 Date