

OWWO

For KCC Use: 4-8-08  
Effective Date: 4  
District # 4  
SGA?  Yes  No

KANSAS CORPORATION COMMISSION  
OIL & GAS CONSERVATION DIVISION

Form C-1  
October 2007  
Form must be Typed  
Form must be Signed  
All blanks must be Filled

NOTICE OF INTENT TO DRILL

Must be approved by KCC five (5) days prior to commencing well

Expected Spud Date: April 4 2008  
month day year

OPERATOR: License# 4419  
Name: Bear Petroleum, Inc.  
Address 1: PO Box 438  
Address 2:  
City: Haysville State: KS Zip: 67060 + 0 4 3 8  
Contact Person: Dick Schremmer  
Phone: 316-524-1225

CONTRACTOR: License# 33724  
Name: Warren Drilling, LLC

Well Drilled For:  Oil  Gas  Seismic; # of Holes  Other:  
Well Class:  Enh Rec  Storage  Disposal  Other  
Type Equipment:  Mud Rotary  Air Rotary  Cable  Infield  Pool Ext.  Wildcat

If OWWO: old well information as follows:  
Operator: Castelli Exploration, Inc.  
Well Name: Pearson-Brown #1-11  
Original Completion Date: 3/02/2008 Original Total Depth: 4075

Directional, Deviated or Horizontal wellbore?  Yes  No  
If Yes, true vertical depth:  
Bottom Hole Location:  
KCC DKT #:

Spot Description:  
SW NW Sec. 11 Twp. 12 S. R. 22  E  W  
(a.o.o.) 1,980 feet from  N /  S Line of Section  
660 feet from  E /  W Line of Section  
Is SECTION:  Regular  Irregular?

(Note: Locate well on the Section Plat on reverse side)  
County: Trego  
Lease Name: Pearson-Brown Well #: 1-11 OWWO  
Field Name: Shaw Creek South  
Is this a Prorated / Spaced Field?  Yes  No  
Target Formation(s): Marmaton  
Nearest Lease or unit boundary line (in footage): 660  
Ground Surface Elevation: 2359 feet MSL  
Water well within one-quarter mile:  Yes  No  
Public water supply well within one mile:  Yes  No  
Depth to bottom of fresh water: 150  
Depth to bottom of usable water: 980  
Surface Pipe by Alternate:  I  II 210  
Length of Surface Pipe Planned to be set: In Place-200  
Length of Conductor Pipe (if any): None  
Projected Total Depth: 4075'  
Formation at Total Depth: Arbuckle  
Water Source for Drilling Operations:  
 Well  Farm Pond  Other: Haul  
DWR Permit #:  Yes  No  
(Note: Apply for Permit with DWR )  
Will Cores be taken?  Yes  No  
If Yes, proposed zone:

AFFIDAVIT

The undersigned hereby affirms that the drilling, completion and eventual plugging of this well will comply with K.S.A. 55 et. seq.  
It is agreed that the following minimum requirements will be met:

1. Notify the appropriate district office **prior** to spudding of well;
2. A copy of the approved notice of intent to drill **shall be** posted on each drilling rig;
3. The minimum amount of surface pipe as specified below **shall be set** by circulating cement to the top; in all cases surface pipe shall be set through all unconsolidated materials plus a minimum of 20 feet into the underlying formation.
4. If the well is dry hole, an agreement between the operator and the district office on plug length and placement is necessary **prior to plugging**;
5. The appropriate district office will be notified before well is either plugged or production casing is cemented in;
6. If an ALTERNATE II COMPLETION, production pipe shall be cemented from below any usable water to surface within **120 DAYS** of spud date. Or pursuant to Appendix "B" - Eastern Kansas surface casing order #133,891-C, which applies to the KCC District 3 area, alternate II cementing must be completed within 30 days of the spud date or the well shall be plugged. **In all cases, NOTIFY district office** prior to any cementing.

I hereby certify that the statements made herein are true and correct to the best of my knowledge and belief.

Date: April 2, 2008 Signature of Operator or Agent: [Signature] Title: Agent

RECEIVED  
KANSAS CORPORATION COMMISSION  
APR 03 2008

CONSERVATION DIVISION  
WICHITA, KS

For KCC Use ONLY  
API # 15 - 195-22531-00-01  
Conductor pipe required None feet  
Minimum surface pipe required 210 feet per ALT.  I  II  
Approved by: [Signature] 4-3-08  
This authorization expires: 4-3-09  
(This authorization void if drilling not started within 12 months of approval date.)  
Spud date: Agent:

Remember to:  
- File Drill Pit Application (form CDP-1) with Intent to Drill;  
- File Completion Form ACO-1 within 120 days of spud date;  
- File acreage attribution plat according to field proration orders;  
- Notify appropriate district office 48 hours prior to workover or re-entry;  
- Submit plugging report (CP-4) after plugging is completed (within 60 days);  
- Obtain written approval before disposing or injecting salt water.  
- If this permit has expired (See: authorized expiration date) please check the box below and return to the address below.  
 Well Not Drilled - Permit Expired Date:   
Signature of Operator or Agent:

11  
12  
22  
 E  
 W

**IN ALL CASES PLOT THE INTENDED WELL ON THE PLAT BELOW**

*Plat of acreage attributable to a well in a prorated or spaced field*

**If the intended well is in a prorated or spaced field, please fully complete this side of the form.** If the intended well is in a prorated or spaced field complete the plat below showing that the well will be properly located in relationship to other wells producing from the common source of supply. Please show all the wells and within 1 mile of the boundaries of the proposed acreage attribution unit for gas wells and within 1/2 mile of the boundaries of the proposed acreage attribution unit for oil wells.

API No. 15 - 195-22531-0001  
Operator: Bear Petroleum, Inc.  
Lease: Pearson-Brown  
Well Number: 1-11 OWWO  
Field: Shaw Creek South

Location of Well; County: Trego  
1,980 feet from  N /  S Line of Section  
660 feet from  E /  W Line of Section  
Sec. 11 Twp. 12 S. R. 22  E  W

Number of Acres attributable to well: \_\_\_\_\_  
QTR/QTR/QTR/QTR of acreage: \_\_\_\_\_ - \_\_\_\_\_ - SW - NW

Is Section:  Regular or  Irregular

**If Section is Irregular, locate well from nearest corner boundary.**  
Section corner used:  NE  NW  SE  SW

**PLAT**

*(Show location of the well and shade attributable acreage for prorated or spaced wells.)  
(Show footage to the nearest lease or unit boundary line.)*

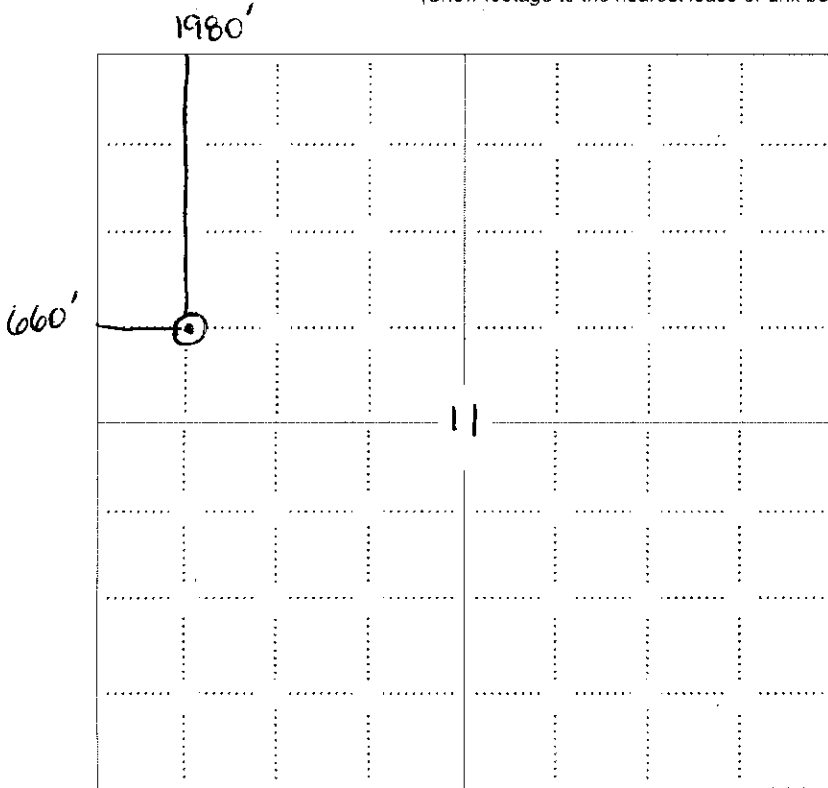

RECEIVED  
KANSAS CORPORATION COMMISSION  
**APR 03 2008**  
CONSERVATION DIVISION  
WICHITA, KS

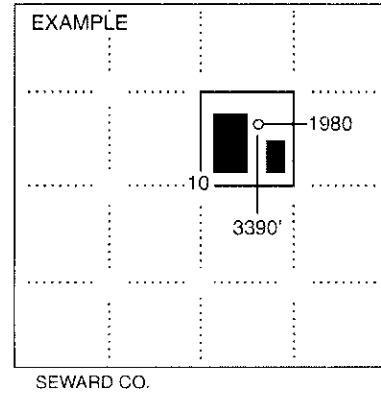

**NOTE: In all cases locate the spot of the proposed drilling location.**

**In plotting the proposed location of the well, you must show:**

1. The manner in which you are using the depicted plat by identifying section lines, i.e. 1 section, 1 section with 8 surrounding sections, 4 sections, etc.
2. The distance of the proposed drilling location from the south / north and east / west outside section lines.
3. The distance to the nearest lease or unit boundary line (in footage).
4. If proposed location is located within a prorated or spaced field a certificate of acreage attribution plat must be attached: (CO-7 for oil wells; CG-8 for gas wells).

**KANSAS CORPORATION COMMISSION  
OIL & GAS CONSERVATION DIVISION  
APPLICATION FOR SURFACE PIT**

Form CDP-1  
April 2004  
Form must be Typed

*Submit in Duplicate*

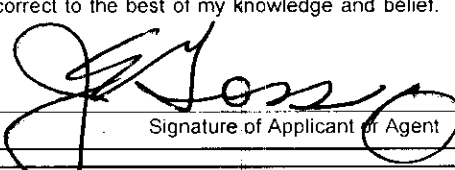
Operator Name: <b>Bear Petroleum, Inc.</b>		License Number: <b>4419</b>	
Operator Address: <b>PO Box 438</b>		<b>Haysville KS 67060</b>	
Contact Person: <b>Dick Schremmer</b>		Phone Number: <b>316-524-1225</b>	
Lease Name & Well No.: <b>Pearson-Brown 1-11 OWWO</b>		Pit Location (QQQQ): <b>SW NW</b>	
Type of Pit: <input type="checkbox"/> Emergency Pit <input type="checkbox"/> Burn Pit <input type="checkbox"/> Settling Pit <input checked="" type="checkbox"/> Drilling Pit <input type="checkbox"/> Workover Pit <input type="checkbox"/> Haul-Off Pit <i>(If WP Supply API No. or Year Drilled)</i>		Pit is: <input type="checkbox"/> Proposed <input checked="" type="checkbox"/> Existing If Existing, date constructed: <b>February 2008</b> Pit capacity: <b>7,000</b> (bbls)	
Is the pit located in a Sensitive Ground Water Area? <input type="checkbox"/> Yes <input checked="" type="checkbox"/> No		Chloride concentration: _____ mg/l <i>(For Emergency Pits and Settling Pits only)</i>	
Is the bottom below ground level? <input checked="" type="checkbox"/> Yes <input type="checkbox"/> No		Artificial Liner? <input type="checkbox"/> Yes <input checked="" type="checkbox"/> No	
How is the pit lined if a plastic liner is not used? <b>Native clay &amp; fresh mud</b>			
Pit dimensions (all but working pits): <u>100</u> Length (feet) <u>100</u> Width (feet) <input type="checkbox"/> N/A: Steel Pits Depth from ground level to deepest point: <u>4</u> (feet) <input type="checkbox"/> No Pit			
If the pit is lined give a brief description of the liner material, thickness and installation procedure.		Describe procedures for periodic maintenance and determining liner integrity, including any special monitoring.	
		<b>RECEIVED</b> <b>KANSAS CORPORATION COMMISSION</b>  <b>APR 03 2008</b>	
Distance to nearest water well within one-mile of pit <u>N/A</u> feet    Depth of water well _____ feet		Depth to shallowest fresh water _____ feet. <b>CONSERVATION DIVISION WICHITA, KS</b> Source of information: <input type="checkbox"/> measured <input type="checkbox"/> well owner <input type="checkbox"/> electric log <input type="checkbox"/> KDWR	
<b>Emergency, Settling and Burn Pits ONLY:</b> Producing Formation: _____ Number of producing wells on lease: _____ Barrels of fluid produced daily: _____ Does the slope from the tank battery allow all spilled fluids to flow into the pit? <input type="checkbox"/> Yes <input type="checkbox"/> No		<b>Drilling, Workover and Haul-Off Pits ONLY:</b> Type of material utilized in drilling/workover: <u>Bentonite Gel</u> Number of working pits to be utilized: <u>1</u> Abandonment procedure: <u>Let dry and backfill pits as conditions allow.</u> Drill pits must be closed within 365 days of spud date.	
I hereby certify that the above statements are true and correct to the best of my knowledge and belief.			
<u>4/2/08</u> Date		 Signature of Applicant or Agent	
<b>KCC OFFICE USE ONLY</b>			
Date Received: <u>4/3/08</u> Permit Number: _____		Steel Pit <input type="checkbox"/> RFAC <input type="checkbox"/> RFAS <input type="checkbox"/>	
Permit Date: <u>4/3/08</u>		Lease Inspection: <input type="checkbox"/> Yes <input checked="" type="checkbox"/> No	

15-195-22531-00-01