

For KCC Use:  
 Effective Date: 4-12-08  
 District #: 3  
 SGA?  Yes  No

KANSAS CORPORATION COMMISSION  
 OIL & GAS CONSERVATION DIVISION

Form C-1  
 October 2007  
 Form must be Typed  
 Form must be Signed  
 All blanks must be Filled

NOTICE OF INTENT TO DRILL

Must be approved by KCC five (5) days prior to commencing well

Expected Spud Date: 2 4 12 08  
 month day year

Spot Description: NW-NW-SW-SE  
~~NW SW SE NW~~ Sec. 1 Twp. 15 S. R. 20  E  W  
 (1/2/00) 1,155 feet from  N /  S Line of Section  
2,475 feet from  E /  W Line of Section

OPERATOR: License# 32218  
 Name: TDR Construction, Inc.  
 Address 1: 1207 N. 1st Street East  
 Address 2: \_\_\_\_\_  
 City: Louisburg State: KS Zip: 66053 + \_\_\_\_\_  
 Contact Person: Lori Driskell  
 Phone: 913-406-4236  
 CONTRACTOR: License# 33715  
 Name: Town Oilfield Service, Inc.

Is SECTION:  Regular  Irregular?

(Note: Locate well on the Section Plat on reverse side)

County: Douglas  
 Lease Name: Lester Kalb Well #: 24  
 Field Name: Baldwin

Is this a Prorated / Spaced Field?  Yes  No

Target Formation(s): Squirrel

Nearest Lease or unit boundary line (in footage): 200'

Ground Surface Elevation: \_\_\_\_\_ feet MSL

Water well within one-quarter mile:  Yes  No

Public water supply well within one mile:  Yes  No

Depth to bottom of fresh water: 100'

Depth to bottom of usable water: 200' 250'

Surface Pipe by Alternate:  I  II

Length of Surface Pipe Planned to be set: 28' 40'

Length of Conductor Pipe (if any): None

Projected Total Depth: 900'

Formation at Total Depth: Squirrel

Water Source for Drilling Operations:  
 Well  Farm Pond  Other: X

DWR Permit #: \_\_\_\_\_

(Note: Apply for Permit with DWR )

Will Cores be taken?  Yes  No

If Yes, proposed zone: \_\_\_\_\_

Well Drilled For: Well Class: Type Equipment:

Oil  Enh Rec  Infield  Mud Rotary  
 Gas  Storage  Pool Ext.  Air Rotary  
 Disposal  Wildcat  Cable  
 Seismic: \_\_\_\_\_ # of Holes  Other  
 Other: \_\_\_\_\_

If OWWO: old well information as follows:

Operator: \_\_\_\_\_

Well Name: \_\_\_\_\_

Original Completion Date: \_\_\_\_\_ Original Total Depth: \_\_\_\_\_

Directional, Deviated or Horizontal wellbore?  Yes  No

If Yes, true vertical depth: \_\_\_\_\_

Bottom Hole Location: \_\_\_\_\_

KCC DKT #: \_\_\_\_\_

AFFIDAVIT

The undersigned hereby affirms that the drilling, completion and eventual plugging of this well will comply with K.S.A. 55 et. seq.

It is agreed that the following minimum requirements will be met:

1. Notify the appropriate district office **prior** to spudding of well;
2. A copy of the approved notice of intent to drill **shall be posted** on each drilling rig;
3. The minimum amount of surface pipe as specified below **shall be set** by circulating cement to the top; in all cases surface pipe shall be set through all unconsolidated materials plus a minimum of 20 feet into the underlying formation.
4. If the well is dry hole, an agreement between the operator and the district office on plug length and placement is necessary **prior to plugging**;
5. The appropriate district office will be notified before well is either plugged or production casing is cemented in;
6. If an ALTERNATE II COMPLETION, production pipe shall be cemented from below any usable water to surface within **120 DAYS** of spud date. Or pursuant to Appendix "B" - Eastern Kansas surface casing order #133,891-C, which applies to the KCC District 3 area, alternate II cementing must be completed within 30 days of the spud date or the well shall be plugged. **In all cases, NOTIFY district office** prior to any cementing.

I hereby certify that the statements made herein are true and correct to the best of my knowledge and belief.

Date: 3/28/08 Signature of Operator or Agent: L. Driskell Title: Agent

RECEIVED  
 KANSAS CORPORATION COMMISSION

APR 03 2008

CONSERVATION DIVISION  
 WICHITA, KS

**For KCC Use ONLY**  
 API # 15 - 045-21393-0000  
 Conductor pipe required None feet  
 Minimum surface pipe required 40 feet per ALT.  I  II  
 Approved by: [Signature] 4-7-08  
 This authorization expires: 4-7-09  
 (This authorization void if drilling not started within 12 months of approval date.)  
 Spud date: \_\_\_\_\_ Agent: \_\_\_\_\_

Remember to:

- File Drill Pit Application (form CDP-1) with Intent to Drill;
- File Completion Form ACO-1 within 120 days of spud date;
- File acreage attribution plat according to field proration orders;
- Notify appropriate district office 48 hours prior to workover or re-entry;
- Submit plugging report (CP-4) after plugging is completed (within 60 days);
- Obtain written approval before disposing or injecting salt water.
- If this permit has expired (See: authorized expiration date) please check the box below and return to the address below.

Well Not Drilled - Permit Expired Date: \_\_\_\_\_  
 Signature of Operator or Agent: \_\_\_\_\_

1  
15  
20  
 E  W

### IN ALL CASES PLOT THE INTENDED WELL ON THE PLAT BELOW

Plat of acreage attributable to a well in a prorated or spaced field

If the intended well is in a prorated or spaced field, please fully complete this side of the form. If the intended well is in a prorated or spaced field complete the plat below showing that the well will be properly located in relationship to other wells producing from the common source of supply. Please show all the wells and within 1 mile of the boundaries of the proposed acreage attribution unit for gas wells and within 1/2 mile of the boundaries of the proposed acreage attribution unit for oil wells.

API No. 15 - 045-21393-0000  
Operator: TDR Construction, Inc.  
Lease: Lester Kalb  
Well Number: 24  
Field: Baldwin

Number of Acres attributable to well: \_\_\_\_\_  
QTR/QTR/QTR/QTR of acreage: ~~NW~~ - ~~SW~~ - ~~SE~~ - ~~NW~~  
NW NW - SW - SE

Location of Well: County: Douglas  
1,155 feet from  N /  S Line of Section  
2,475 feet from  E /  W Line of Section  
Sec. 1 Twp. 15 S. R. 21  E  W  
20

Is Section:  Regular or  Irregular

If Section is Irregular, locate well from nearest corner boundary.  
Section corner used:  NE  NW  SE  SW

### PLAT

(Show location of the well and shade attributable acreage for prorated or spaced wells.)  
(Show footage to the nearest lease or unit boundary line.)

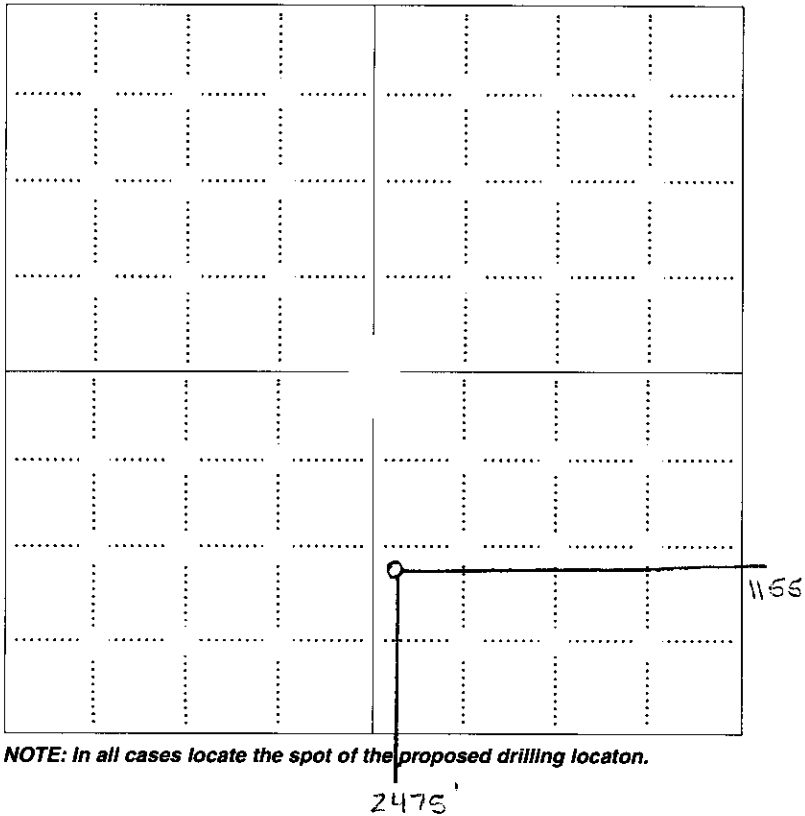

NOTE: In all cases locate the spot of the proposed drilling location.

RECEIVED  
KANSAS CORPORATION COMMISSION  
APR 03 2008  
CONSERVATION DIVISION  
WICHITA, KS

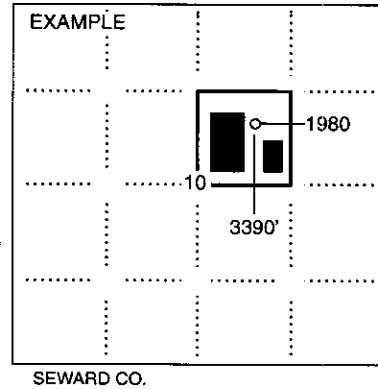

#### In plotting the proposed location of the well, you must show:

1. The manner in which you are using the depicted plat by identifying section lines, i.e. 1 section, 1 section with 8 surrounding sections, 4 sections, etc.
2. The distance of the proposed drilling location from the south / north and east / west outside section lines.
3. The distance to the nearest lease or unit boundary line (in footage).
4. If proposed location is located within a prorated or spaced field a certificate of acreage attribution plat must be attached: (CO-7 for oil wells; CG-8 for gas wells).

**KANSAS CORPORATION COMMISSION  
OIL & GAS CONSERVATION DIVISION  
APPLICATION FOR SURFACE PIT**

Form CDP-1  
April 2004  
Form must be Typed

*Submit in Duplicate*

Operator Name: <b>TDR Construction, Inc.</b>		License Number: <b>32218</b>	
Operator Address: <b>1207 N. 1st Street East</b>		<b>Louisburg KS 66053</b>	
Contact Person: <b>Lori Driskell</b>		Phone Number: <b>913-406-4236</b>	
Lease Name & Well No.: <b>Lester Kalb 24</b>		Pit Location (QQQQ): <b>NW SW SE NW</b> <b>NW SW SE NW</b>	
Type of Pit: <input type="checkbox"/> Emergency Pit <input type="checkbox"/> Burn Pit <input type="checkbox"/> Settling Pit <input checked="" type="checkbox"/> Drilling Pit <input type="checkbox"/> Workover Pit <input type="checkbox"/> Haul-Off Pit <i>(If WP Supply API No. or Year Drilled)</i>		Pit is: <input checked="" type="checkbox"/> Proposed <input type="checkbox"/> Existing If Existing, date constructed: _____ Pit capacity: <b>100</b> (bbls)	
Is the pit located in a Sensitive Ground Water Area? <input type="checkbox"/> Yes <input checked="" type="checkbox"/> No		Sec. <u>1</u> Twp. <u>15</u> R. <u>21</u> <input checked="" type="checkbox"/> East <input type="checkbox"/> West 1,155 Feet from <input type="checkbox"/> North / <input checked="" type="checkbox"/> South Line of Section 2,475 Feet from <input checked="" type="checkbox"/> East / <input type="checkbox"/> West Line of Section <b>Douglas</b> County	
Is the bottom below ground level? <input checked="" type="checkbox"/> Yes <input type="checkbox"/> No		Chloride concentration: _____ mg/l <i>(For Emergency Pits and Settling Pits only)</i>	
Artificial Liner? <input type="checkbox"/> Yes <input checked="" type="checkbox"/> No		How is the pit lined if a plastic liner is not used?	
Pit dimensions (all but working pits): <u>8</u> Length (feet) <u>12</u> Width (feet) <input type="checkbox"/> N/A: Steel Pits Depth from ground level to deepest point: <u>5</u> (feet) <input type="checkbox"/> No Pit			
If the pit is lined give a brief description of the liner material, thickness and installation procedure.		Describe procedures for periodic maintenance and determining liner integrity, including any special monitoring. <div style="text-align: center;"> <b>RECEIVED</b>                      KANSAS CORPORATION COMMISSION  <b>APR 03 2008</b> </div>	
Distance to nearest water well within one-mile of pit <u>2878</u> feet    Depth of water well <u>100</u> feet		Depth to shallowest fresh water <u>KS</u> feet. <b>CONSERVATION DIVISION WICHITA, KS</b> Source of information: <input type="checkbox"/> measured <input type="checkbox"/> well owner <input type="checkbox"/> electric log <input type="checkbox"/> KDWR	
<b>Emergency, Settling and Burn Pits ONLY:</b> Producing Formation: _____ Number of producing wells on lease: _____ Barrels of fluid produced daily: _____ Does the slope from the tank battery allow all spilled fluids to flow into the pit? <input type="checkbox"/> Yes <input type="checkbox"/> No		<b>Drilling, Workover and Haul-Off Pits ONLY:</b> Type of material utilized in drilling/workover: <u>Fresh Water</u> Number of working pits to be utilized: <u>2</u> Abandonment procedure: <u>Pits filled as soon as well is completed</u> Drill pits must be closed within 365 days of spud date.	
I hereby certify that the above statements are true and correct to the best of my knowledge and belief.			
Date: <u>3/28/08</u>		Signature of Applicant or Agent: <u>L. Driskell</u>	
<b>KCC OFFICE USE ONLY</b>			
Date Received: <u>4/3/08</u>		Permit Number: _____	
Permit Date: <u>4/4/08</u>		Lease Inspection: <input type="checkbox"/> Yes <input checked="" type="checkbox"/> No	

15-045-21393-0000

Mail to: KCC - Conservation Division, 130 S. Market - Room 2078, Wichita, Kansas 67202

\* Public water well Sec. 12-15-20E  
SENE