

For KCC Use: 4-21-08
 Effective Date: 4-21-08
 District #: 3
 SGA? Yes No

KANSAS CORPORATION COMMISSION
 OIL & GAS CONSERVATION DIVISION

Form C-1
 October 2007
 Form must be Typed
 Form must be Signed
 All blanks must be Filled

NOTICE OF INTENT TO DRILL

Must be approved by KCC five (5) days prior to commencing well

Expected Spud Date: April 22, 2008
month day year

OPERATOR: License# 33365
 Name: Layne Energy Operating, LLC
 Address 1: 1900 Shawnee Mission Parkway
 Address 2: _____
 City: Mission Woods State: KS Zip: 66205 + 2001
 Contact Person: Timothy H. Wright
 Phone: 913-748-3960

CONTRACTOR: License# 33606
 Name: Thornton Air

Well Drilled For: Oil Gas Enh Rec Storage Disposal Seismic; # of Holes _____ Other: _____
 Well Class: Infield Pool Ext. Wildcat Other _____
 Type Equipment: Mud Rotary Air Rotary Cable

If OWWO: old well information as follows:
 Operator: _____
 Well Name: _____
 Original Completion Date: _____ Original Total Depth: _____

Directional, Deviated or Horizontal wellbore? Yes No
 If Yes, true vertical depth: _____
 Bottom Hole Location: _____
 KCC DKT #: _____

Spot Description: _____
 _____ S2 - SW - NE Sec. 16 Twp. 31 S. R. 16 E W
 (0000) 2,231 feet from N / S Line of Section
1,999 feet from E / W Line of Section

Is SECTION: Regular Irregular?

(Note: Locate well on the Section Plat on reverse side)
 County: Montgomery

Lease Name: Martin Well #: 7-16
 Field Name: Cherokee Basin Coal

Is this a Prorated / Spaced Field? Yes No
 Target Formation(s): Cherokee Coals

Nearest Lease or unit boundary line (in footage): 442'
 Ground Surface Elevation: 819 feet MSL

Water well within one-quarter mile: Yes No
 Public water supply well within one mile: Yes No

Depth to bottom of fresh water: 150'
 Depth to bottom of usable water: 150'

Surface Pipe by Alternate: I II
 Length of Surface Pipe Planned to be set: 20'

Length of Conductor Pipe (if any): None
 Projected Total Depth: 1200'

Formation at Total Depth: Mississippian

Water Source for Drilling Operations:
 Well Farm Pond Other: _____

DWR Permit #: _____
 (Note: Apply for Permit with DWR)

Will Cores be taken? Yes No
 If Yes, proposed zone: _____

AFFIDAVIT

RECEIVED
 KANSAS CORPORATION COMMISSION
 APR 16 2008
 CONSERVATION DIVISION
 WICHITA, KS

The undersigned hereby affirms that the drilling, completion and eventual plugging of this well will comply with K.S.A. 55 et. seq.
 It is agreed that the following minimum requirements will be met:

1. Notify the appropriate district office **prior** to spudding of well;
2. A copy of the approved notice of intent to drill **shall be** posted on each drilling rig;
3. The minimum amount of surface pipe as specified below **shall be set by** circulating cement to the top; in all cases surface pipe **shall be set** through all unconsolidated materials plus a minimum of 20 feet into the underlying formation.
4. If the well is dry hole, an agreement between the operator and the district office on plug length and placement is necessary **prior to plugging**;
5. The appropriate district office will be notified before well is either plugged or production casing is cemented in;
6. If an ALTERNATE II COMPLETION, production pipe shall be cemented from below any usable water to surface within **120 DAYS** of spud date. Or pursuant to Appendix "B" - Eastern Kansas surface casing order #133,891-C, which applies to the KCC District 3 area, alternate II cementing must be completed within 30 days of the spud date or the well shall be plugged. **In all cases, NOTIFY district office** prior to any cementing.

I hereby certify that the statements made herein are true and correct to the best of my knowledge and belief.

Date: April 15, 2008 Signature of Operator or Agent: _____ Title: Agent

For KCC Use ONLY
 API # 15 - 125-31604-0000
 Conductor pipe required None feet
 Minimum surface pipe required 20 feet per ALT. I II
 Approved by: MA 4-16-08
 This authorization expires: 4-16-09
 (This authorization void if drilling not started within 12 months of approval date.)
 Spud date: _____ Agent: _____

Remember to:

- File Drill Pit Application (form CDP-1) with Intent to Drill;
- File Completion Form ACO-1 within 120 days of spud date;
- File acreage attribution plat according to field proration orders;
- Notify appropriate district office 48 hours prior to workover or re-entry;
- Submit plugging report (CP-4) after plugging is completed (within 60 days);
- Obtain written approval before disposing or injecting salt water.
- If this permit has expired (See: authorized expiration date) please check the box below and return to the address below.

Well Not Drilled - Permit Expired Date: _____
 Signature of Operator or Agent: _____

IN ALL CASES PLOT THE INTENDED WELL ON THE PLAT BELOW

Plat of acreage attributable to a well in a prorated or spaced field

If the intended well is in a prorated or spaced field, please fully complete this side of the form. If the intended well is in a prorated or spaced field complete the plat below showing that the well will be properly located in relationship to other wells producing from the common source of supply. Please show all the wells and within 1 mile of the boundaries of the proposed acreage attribution unit for gas wells and within 1/2 mile of the boundaries of the proposed acreage attribution unit for oil wells.

API No. 15 - 12531604-0000
 Operator: Layne Energy Operating, LLC
 Lease: Martin
 Well Number: 7-16
 Field: Cherokee Basin Coal

Location of Well: County: Montgomery
2,231 feet from N / S Line of Section
1,999 feet from E / W Line of Section
 Sec. 16 Twp. 31 S. R. 16 E W

Number of Acres attributable to well: _____
 QTR/QTR/QTR/QTR of acreage: _____ - S2 - SW - NE

Is Section: Regular or Irregular

If Section is Irregular, locate well from nearest corner boundary.

Section corner used: NE NW SE SW

PLAT

(Show location of the well and shade attributable acreage for prorated or spaced wells.)

(Show footage to the nearest lease or unit boundary line.)

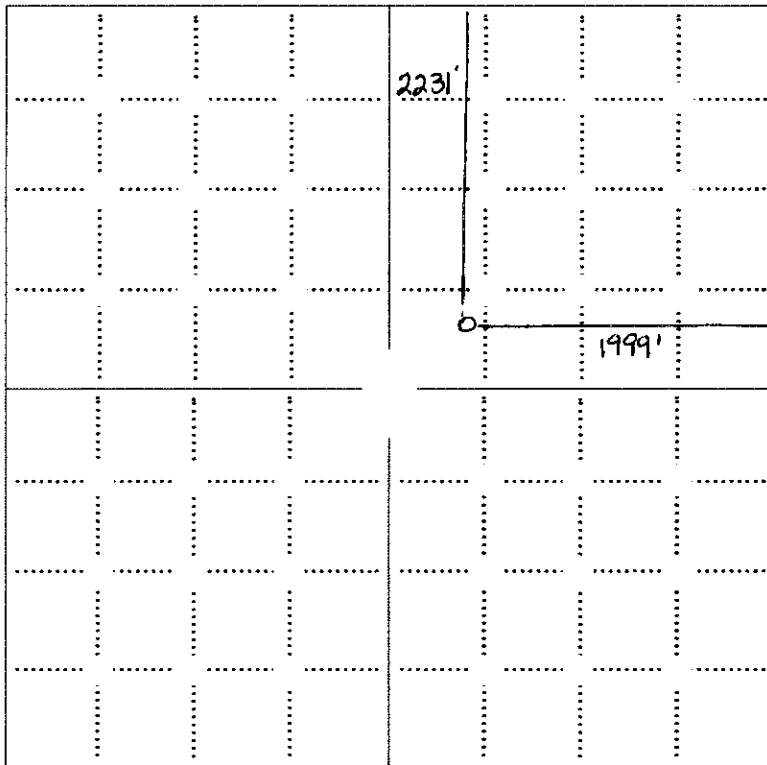

RECEIVED
 KANSAS CORPORATION COMMISSION
 APR 16 2008
 CONSERVATION DIVISION
 WICHITA, KS

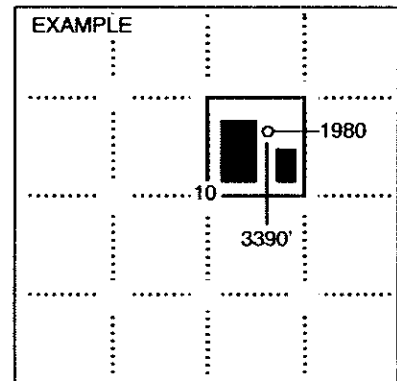

SEWARD CO.

NOTE: In all cases locate the spot of the proposed drilling locaton.

In plotting the proposed location of the well, you must show:

1. The manner in which you are using the depicted plat by identifying section lines, i.e. 1 section, 1 section with 8 surrounding sections, 4 sections, etc.
2. The distance of the proposed drilling location from the south / north and east / west outside section lines.
3. The distance to the nearest lease or unit boundary line (in footage).
4. If proposed location is located within a prorated or spaced field a certificate of acreage attribution plat must be attached: (CO-7 for oil wells; CG-8 for gas wells).

KANSAS CORPORATION COMMISSION
OIL & GAS CONSERVATION DIVISION

Form CDP-1
April 2004
Form must be Typed

APPLICATION FOR SURFACE PIT

Submit in Duplicate

| | | |
|--|---|---|
| Operator Name: Layne Energy Operating, LLC | | License Number: 33365 |
| Operator Address: 1900 Shawnee Mission Parkway | | Mission Woods KS 66205 |
| Contact Person: Timothy H. Wright | | Phone Number: 913-748-3960 |
| Lease Name & Well No.: Martin 7-16 | | Pit Location (QQQQ): S2 SW NE |
| Type of Pit: <input type="checkbox"/> Emergency Pit <input type="checkbox"/> Burn Pit <input type="checkbox"/> Settling Pit <input checked="" type="checkbox"/> Drilling Pit <input type="checkbox"/> Workover Pit <input type="checkbox"/> Haul-Off Pit <small>(If WP Supply API No. or Year Drilled)</small> | Pit is: <input checked="" type="checkbox"/> Proposed <input type="checkbox"/> Existing If Existing, date constructed: _____ Pit capacity: _____ (bbls) | Sec. 16 Twp. 31 R. 16 <input checked="" type="checkbox"/> East <input type="checkbox"/> West 2,231 Feet from <input checked="" type="checkbox"/> North / <input type="checkbox"/> South Line of Section 1,999 Feet from <input checked="" type="checkbox"/> East / <input type="checkbox"/> West Line of Section Montgomery County |
| Is the pit located in a Sensitive Ground Water Area? <input checked="" type="checkbox"/> Yes <input type="checkbox"/> No | | Chloride concentration: _____ mg/l <small>(For Emergency Pits and Settling Pits only)</small> |
| Is the bottom below ground level? <input checked="" type="checkbox"/> Yes <input type="checkbox"/> No | Artificial Liner? <input type="checkbox"/> Yes <input checked="" type="checkbox"/> No | How is the pit lined if a plastic liner is not used? self-sealing |
| Pit dimensions (all but working pits): 30 Length (feet) 20 Width (feet) <input type="checkbox"/> N/A: Steel Pits Depth from ground level to deepest point: 3 (feet) <input type="checkbox"/> No Pit | | |
| If the pit is lined give a brief description of the liner material, thickness and installation procedure. | | Describe procedures for periodic maintenance and determining liner integrity, including any special monitoring. |
| Distance to nearest water well within one-mile of pit none 2948 feet Depth of water well 42 feet | | Depth to shallowest fresh water 48 feet. Source of information: <input type="checkbox"/> measured <input type="checkbox"/> well owner <input type="checkbox"/> electric log <input checked="" type="checkbox"/> KDWR |
| Emergency, Settling and Burn Pits ONLY: Producing Formation: _____ Number of producing wells on lease: _____ Barrels of fluid produced daily: _____ Does the slope from the tank battery allow all spilled fluids to flow into the pit? <input type="checkbox"/> Yes <input type="checkbox"/> No | | Drilling, Workover and Haul-Off Pits ONLY: Type of material utilized in drilling/workover: fresh water mud Number of working pits to be utilized: 2 Abandonment procedure: Let evaporate until dry, then backfill and restore RECEIVED Drill pits must be closed within 365 days of spud date. KANSAS CORPORATION COMMISSION |
| I hereby certify that the above statements are true and correct to the best of my knowledge and belief. | | APR 16 2008 |
| April 15, 2008 Date |  Signature of Applicant or Agent | |
| KCC OFFICE USE ONLY | | Steel Pit <input type="checkbox"/> RFAC <input type="checkbox"/> RFAS <input type="checkbox"/> |
| Date Received: 4/16/08 Permit Number: _____ | Permit Date: 4/16/08 Lease Inspection: <input type="checkbox"/> Yes <input checked="" type="checkbox"/> No | |

15-125-31604-0000