

CORRECTION

5-707  
**CORRECTED**

Form C-1  
October 2007  
Form must be Typed  
Form must be Signed  
All blanks must be Filled

For KCC Use:  
Effective Date: 2-19-08  
District #: 21  
SGA?  Yes  No

KANSAS CORPORATION COMMISSION  
OIL & GAS CONSERVATION DIVISION

**NOTICE OF INTENT TO DRILL**

Must be approved by KCC five (5) days prior to commencing well

Expected Spud Date: February 25 2008  
month day year

OPERATOR: License# 5004  
Name: Vincent Oil Corporation  
Address 1: 155 N. Market  
Address 2: Suite 700  
City: Wichita State: KS Zip: 67202  
Contact Person: Rick Hiebsch  
Phone: 316-262-3573

CONTRACTOR: License# 33575  
Name: WW Drilling, LLC

Well Drilled For:  Oil  Gas  Seismic  Other: \_\_\_\_\_  
Well Class:  Enh Rec  Storage  Disposal  Other: \_\_\_\_\_  
Type Equipment:  Mud Rotary  Air Rotary  Cable  Pool Ext.  Wildcat

If OWWO: old well information as follows:  
Operator: \_\_\_\_\_  
Well Name: \_\_\_\_\_  
Original Completion Date: \_\_\_\_\_ Original Total Depth: \_\_\_\_\_

Directional, Deviated or Horizontal wellbore?  Yes  No  
If Yes, true vertical depth: \_\_\_\_\_  
Bottom Hole Location: \_\_\_\_\_  
KCC DKT #: \_\_\_\_\_

\* WAS: 2240' FWL  
IS: 2440' FWL

*Oil lease leases w/ pooling clauses submitted.* **AFFIDAVIT**

The undersigned hereby affirms that the drilling, completion and eventual plugging of this well will comply with K.S.A. 55-2201. It is agreed that the following minimum requirements will be met:

1. Notify the appropriate district office **prior** to spudding of well;
2. A copy of the approved notice of intent to drill **shall be** posted on each drilling rig;
3. The minimum amount of surface pipe as specified below **shall be set** by circulating cement to the top; in all cases surface casing shall be set through all unconsolidated materials plus a minimum of 20 feet into the underlying formation.
4. If the well is dry hole, an agreement between the operator and the district office on plug length and placement is necessary **prior to plugging**;
5. The appropriate district office will be notified before well is either plugged or production casing is cemented in;
6. If an ALTERNATE II COMPLETION, production pipe shall be cemented from below any usable water to surface within **120 DAYS** of spud date. Or pursuant to Appendix "B" - Eastern Kansas surface casing order #133,891-C, which applies to the KCC District 3 area, alternate II cementing must be completed within 30 days of the spud date or the well shall be plugged. **In all cases, NOTIFY district office** prior to any cementing.

I hereby certify that the statements made herein are true and correct to the best of my knowledge and belief.

Date: February 13, 2008 Signature of Operator or Agent: Richard H. Dickel Title: President

**For KCC Use ONLY**  
API # 15 - 065-23411-0000  
Conductor pipe required None feet  
Minimum surface pipe required 200 feet per ALT.  I  II  
Approved by: Rick 2-14-08 / WW 5-707  
This authorization expires: 2-14-09  
(This authorization void if drilling not started within 12 months of approval date.)  
Spud date: \_\_\_\_\_ Agent: \_\_\_\_\_

Spot Description: \_\_\_\_\_  
NE SE NW Sec. 29 Twp. 7 S. R. 22  E  W  
1,000 feet from  N /  S Line of Section  
2,240 feet from  E /  W Line of Section  
Is SECTION:  Regular  Irregular?

(Note: Locate well on the Section Plat on reverse side)  
County: Graham  
Lease Name: Webb Well #: 2-29  
Field Name: Quarry Hill  
Is this a Prorated / Spaced Field?  Yes  No

Target Formation(s): Arbuckle  
Nearest Lease or unit boundary line (in footage): 530 ft.  
Ground Surface Elevation: 2280 feet MSL  
Water well within one-quarter mile:  Yes  No  
Public water supply well within one mile:  Yes  No  
Depth to bottom of fresh water: 150 ft.  
Depth to bottom of usable water: 1050 ft.  
Surface Pipe by Alternate:  I  II  
Length of Surface Pipe Planned to be set: 210 ft.  
Length of Conductor Pipe (if any): none  
Projected Total Depth: 3900 ft.  
Formation at Total Depth: Arbuckle

Water Source for Drilling Operations:  
 Well  Farm Pond  Other: unknown - will haul  
DWR Permit #: \_\_\_\_\_  
(Note: Apply for Permit with DWR)   
Will Cores be taken?  Yes  No  
If Yes, proposed zone: \_\_\_\_\_

RECEIVED  
KANSAS CORPORATION COMMISSION  
FEB 14 2008

**Remember to:**  
- File Drill Plat Application (form GDP-1) with Intent to Drill;  
- File Completion Form ACO-1 within 120 days of spud date;  
- File acreage attribution plat according to field proration orders;  
- Notify appropriate district office 48 hours prior to workover or re-entry;  
- Submit plugging report (CP-4) after plugging is completed (within 60 days);  
- Obtain written approval before disposing or injecting salt water.  
- If this permit has expired (See: authorized expiration date) please check the box below and return to the address below.  
 Well Not Drilled - Permit Expired Date: \_\_\_\_\_  
Signature of Operator or Agent: \_\_\_\_\_

RECEIVED  
KANSAS CORPORATION COMMISSION  
MAY 02 2008

Mail to: KCC - Conservation Division, 130 S. Market - Room 2078, Wichita, Kansas 67202

CONSERVATION DIVISION  
WICHITA, KS

**CORRECTED**

**IN ALL CASES PLOT THE INTENDED WELL ON THE PLAT BELOW**

*Plat of acreage attributable to a well in a prorated or spaced field*

*If the intended well is in a prorated or spaced field, please fully complete this side of the form.* If the intended well is in a prorated or spaced field complete the plat below showing that the well will be properly located in relationship to other wells producing from the common source of supply. Please show all the wells and within 1 mile of the boundaries of the proposed acreage attribution unit for gas wells and within 1/2 mile of the boundaries of the proposed acreage attribution unit for oil wells.

API No. 15 - D65-23411-0000  
Operator: Vincent Oil Corporation  
Lease: Webb  
Well Number: 2-29  
Field: Quarry Hill

Location of Well: County: Graham  
1,680 feet from  N /  S Line of Section  
~~2,200~~ 2,440 feet from  E /  W Line of Section  
Sec. 29 Twp. 7 S. R. 22  E  W

Number of Acres attributable to well: \_\_\_\_\_  
QTR/QTR/QTR/QTR of acreage: \_\_\_\_\_ - NE - SE - NW

Is Section:  Regular or  Irregular

If Section is Irregular, locate well from nearest corner boundary.  
Section corner used:  NE  NW  SE  SW

**PLAT**

*(Show location of the well and shade attributable acreage for prorated or spaced wells.)  
(Show footage to the nearest lease or unit boundary line.)*

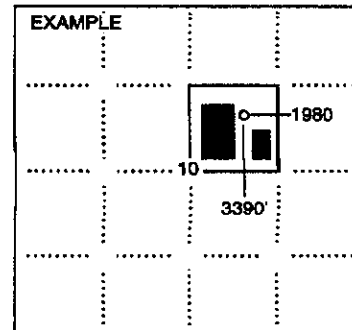
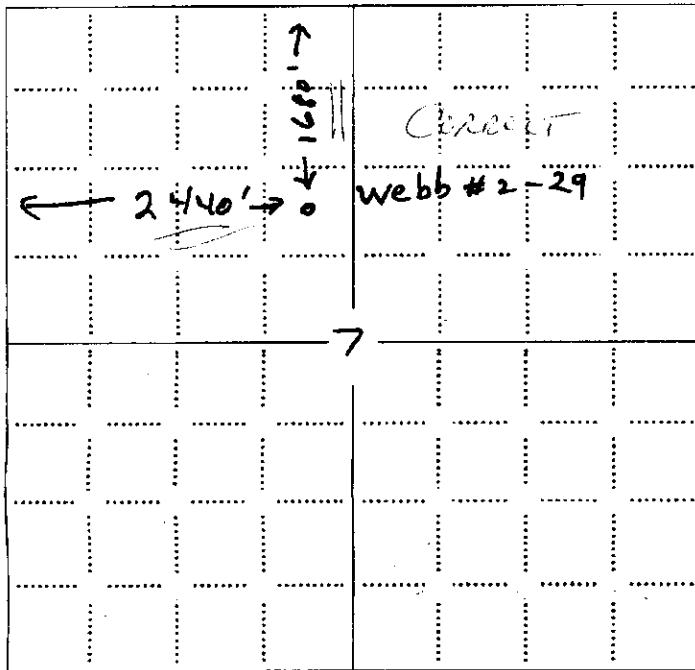

SEWARD CO.

**NOTE: in all cases locate the spot of the proposed drilling location.**

**In plotting the proposed location of the well, you must show:**

1. The manner in which you are using the depicted plat by identifying section lines, i.e. 1 section, 1 section with 8 surrounding sections, 4 sections, etc.
2. The distance of the proposed drilling location from the south / north and east / west outside section lines.
3. The distance to the nearest lease or unit boundary line (in footage).
4. If proposed location is located within a prorated or spaced field a certificate of acreage attribution plat must be attached: (CO-7 for oil wells; CG-8 for gas wells).