

For KCC Use: Effective Date: 5-17-08 District # 3 SGA? Yes No

KANSAS CORPORATION COMMISSION OIL & GAS CONSERVATION DIVISION

Form C-1 October 2007 Form must be Typed Form must be Signed All blanks must be Filled

NOTICE OF INTENT TO DRILL

Must be approved by KCC five (5) days prior to commencing well

Expected Spud Date: May 14 2008 month day year

OPERATOR: License# 5970 Name: John A. Elmore Address 1: 776 HWY 99 Address 2: City: Sedan State: KS Zip: 67361 Contact Person: John A. Elmore Phone: 620-249-2519 CONTRACTOR: License# 32884 Name: Elmore's Inc.

Well Drilled For: Oil Gas Enh Rec Storage Disposal Seismic; # of Holes Other: Well Class: Infield Pool Ext. Wildcat Other: Type Equipment: Mud Rotary Air Rotary Cable If OWWO: old well information as follows:

Operator: Well Name: Original Completion Date: Original Total Depth:

Directional, Deviated or Horizontal wellbore? Yes No If Yes, true vertical depth: Bottom Hole Location: KCC DKT #:

Spot Description: SE SW NW Sec. 32 Twp. 33 S. R. 12 E W 3,295 feet from N / S Line of Section 4,535 feet from E / W Line of Section

Is SECTION: Regular Irregular? (Note: Locate well on the Section Plat on reverse side)

County: Chautauqua Lease Name: Berlin Well #: 27 Field Name: Peru

Is this a Prorated / Spaced Field? Yes No Target Formation(s): Peru

Nearest Lease or unit boundary line (in footage): 655 Ground Surface Elevation: 915 feet MSL

Water well within one-quarter mile: Yes No Public water supply well within one mile: Yes No

Depth to bottom of fresh water: 40' Depth to bottom of usable water: 225

Surface Pipe by Alternate: I II Length of Surface Pipe Planned to be set: 40'

Length of Conductor Pipe (if any): NA Projected Total Depth: 1100

Formation at Total Depth: Peru Water Source for Drilling Operations: Well Farm Pond Other:

DWR Permit #: (Note: Apply for Permit with DWR)

Will Cores be taken? Yes No

If Yes, proposed zone:

AFFIDAVIT

RECEIVED KANSAS CORPORATION COMMISSION

MAY 09 2008

The undersigned hereby affirms that the drilling, completion and eventual plugging of this well will comply with K.S.A. 55 et. seq.

It is agreed that the following minimum requirements will be met:

- 1. Notify the appropriate district office prior to spudding of well;
2. A copy of the approved notice of intent to drill shall be posted on each drilling rig;
3. The minimum amount of surface pipe as specified below shall be set by circulating cement to the top; in all cases surface pipe shall be set through all unconsolidated materials plus a minimum of 20 feet into the underlying formation.
4. If the well is dry hole, an agreement between the operator and the district office on plug length and placement is necessary prior to plugging;
5. The appropriate district office will be notified before well is either plugged or production casing is cemented in;
6. If an ALTERNATE II COMPLETION, production pipe shall be cemented from below any usable water to surface within 120 DAYS of spud date. Or pursuant to Appendix "B" - Eastern Kansas surface casing order #133,891-C, which applies to the KCC District 3 area, alternate II cementing must be completed within 30 days of the spud date or the well shall be plugged. In all cases, NOTIFY district office prior to any cementing.

I hereby certify that the statements made herein are true and correct to the best of my knowledge and belief.

Date: 5-5-08 Signature of Operator or Agent: John A. Elmore Title: Owner

For KCC Use ONLY API # 15 - 019-26906-0000 Conductor pipe required None feet Minimum surface pipe required 40 feet per ALT. I II Approved by: John A. Elmore This authorization expires: 5-12-09 (This authorization void if drilling not started within 12 months of approval date.) Spud date: Agent:

Remember to:

- File Drill Pit Application (form CDP-1) with Intent to Drill;
- File Completion Form ACO-1 within 120 days of spud date;
- File acreage attribution plat according to field proration orders;
- Notify appropriate district office 48 hours prior to workover or re-entry;
- Submit plugging report (CP-4) after plugging is completed (within 60 days);
- Obtain written approval before disposing or injecting salt water.
- If this permit has expired (See: authorized expiration date) please check the box below and return to the address below.

Well Not Drilled - Permit Expired Date: Signature of Operator or Agent:

32 33 12 E W

IN ALL CASES PLOT THE INTENDED WELL ON THE PLAT BELOW

Plat of acreage attributable to a well in a prorated or spaced field

If the intended well is in a prorated or spaced field, please fully complete this side of the form. If the intended well is in a prorated or spaced field complete the plat below showing that the well will be properly located in relationship to other wells producing from the common source of supply. Please show all the wells and within 1 mile of the boundaries of the proposed acreage attribution unit for gas wells and within 1/2 mile of the boundaries of the proposed acreage attribution unit for oil wells.

API No. 15 - 019-26906-0000
 Operator: John A. Elmore
 Lease: Berlin
 Well Number: 27
 Field: Peru

Location of Well: County: Chautauqua
 3,295 feet from N / S Line of Section
 4,535 feet from E / W Line of Section
 Sec. 32 Twp. 33 S. R. 12 E W

Number of Acres attributable to well: 1
 QTR/QTR/QTR/QTR of acreage: SE - SW - NW -

Is Section: Regular or Irregular

If Section is Irregular, locate well from nearest corner boundary.

Section corner used: NE NW SE SW

PLAT

*(Show location of the well and shade attributable acreage for prorated or spaced wells.)
 (Show footage to the nearest lease or unit boundary line.)*

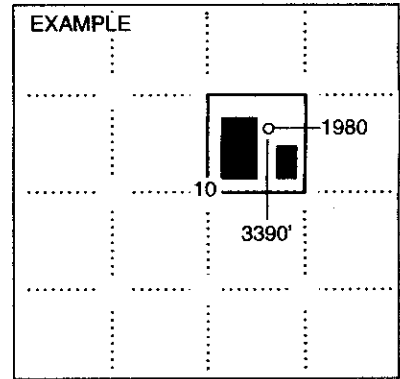
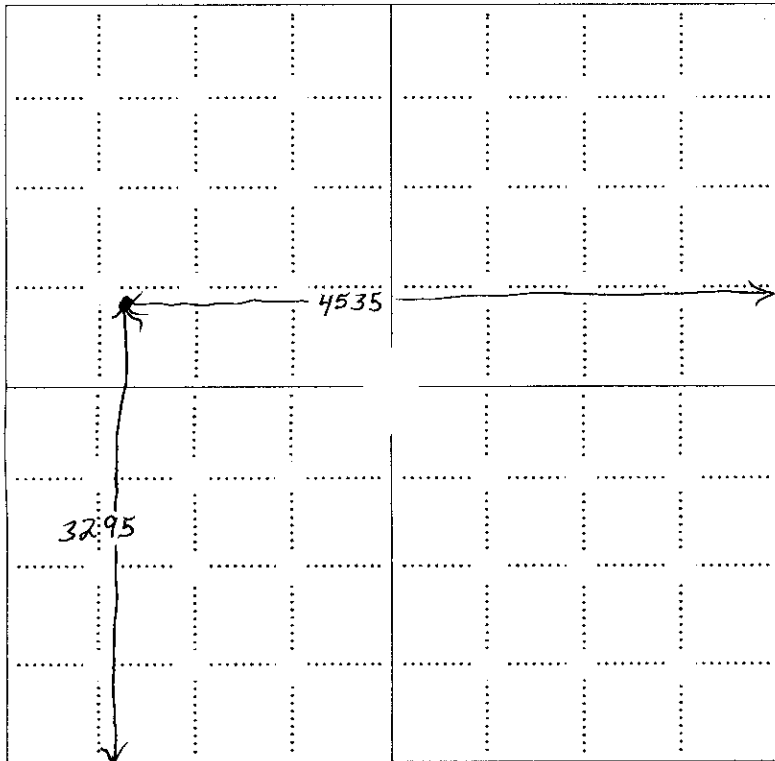

NOTE: In all cases locate the spot of the proposed drilling location.

In plotting the proposed location of the well, you must show:

1. The manner in which you are using the depicted plat by identifying section lines, i.e. 1 section, 1 section with 8 surrounding sections, 4 sections, etc.
2. The distance of the proposed drilling location from the south / north and east / west outside section lines.
3. The distance to the nearest lease or unit boundary line (in footage).
4. If proposed location is located within a prorated or spaced field a certificate of acreage attribution plat must be attached: (C0-7 for oil wells;

**KANSAS CORPORATION COMMISSION
OIL & GAS CONSERVATION DIVISION
APPLICATION FOR SURFACE PIT**

Form CDP-1
April 2004
Form must be Typed

Submit in Duplicate

Operator Name: John A. Elmore		License Number: 5970	
Operator Address: 776 HWY 99 Sedan, KS. 67361			
Contact Person: John A. Elmore		Phone Number: 620-249-2519	
Lease Name & Well No.: Berlin #27		Pit Location (QQQQ): SE SW NW	
Type of Pit: <input type="checkbox"/> Emergency Pit <input type="checkbox"/> Burn Pit <input type="checkbox"/> Settling Pit <input checked="" type="checkbox"/> Drilling Pit <input type="checkbox"/> Workover Pit <input type="checkbox"/> Haul-Off Pit <i>(If WP Supply API No. or Year Drilled)</i>		Pit is: <input checked="" type="checkbox"/> Proposed <input type="checkbox"/> Existing If Existing, date constructed: _____ Pit capacity: 300 (bbis)	
Is the pit located in a Sensitive Ground Water Area? <input type="checkbox"/> Yes <input checked="" type="checkbox"/> No		Chloride concentration: _____ mg/l <i>(For Emergency Pits and Settling Pits only)</i>	
Is the bottom below ground level? <input checked="" type="checkbox"/> Yes <input type="checkbox"/> No		Artificial Liner? <input type="checkbox"/> Yes <input checked="" type="checkbox"/> No	
How is the pit lined if a plastic liner is not used? Clay Packed			
Pit dimensions (all but working pits): <u>70</u> Length (feet) <u>8</u> Width (feet) <input type="checkbox"/> N/A: Steel Pits Depth from ground level to deepest point: <u>5</u> (feet) <input type="checkbox"/> No Pit			
If the pit is lined give a brief description of the liner material, thickness and installation procedure.		Describe procedures for periodic maintenance and determining liner integrity, including any special monitoring.	
		RECEIVED KANSAS CORPORATION COMMISSION MAY 09 2008 CONSERVATION DIVISION WICHITA, KS	
Distance to nearest water well within one-mile of pit <u>2640</u> feet Depth of water well <u>100</u> feet		Depth to shallowest fresh water <u>100</u> feet. Source of information: <input type="checkbox"/> measured <input checked="" type="checkbox"/> well owner <input type="checkbox"/> electric log <input type="checkbox"/> KDWR	
Emergency, Settling and Burn Pits ONLY: Producing Formation: _____ Number of producing wells on lease: _____ Barrels of fluid produced daily: _____ Does the slope from the tank battery allow all spilled fluids to flow into the pit? <input type="checkbox"/> Yes <input type="checkbox"/> No		Drilling, Workover and Haul-Off Pits ONLY: Type of material utilized in drilling/workover: <u>Fresh Water</u> Number of working pits to be utilized: <u>2</u> Abandonment procedure: <u>Vacuum Truck to empty pit.</u> <u>Close with dozer</u> Drill pits must be closed within 365 days of spud date.	
I hereby certify that the above statements are true and correct to the best of my knowledge and belief.			
_____ 5-5-08 Date		 _____ Signature of Applicant or Agent	
KCC OFFICE USE ONLY			
Date Received: <u>5/9/08</u> Permit Number: _____		Permit Date: <u>5/9/08</u> Lease Inspection: <input type="checkbox"/> Yes <input checked="" type="checkbox"/> No	

15-019-26906-0000