

For KCC Use: 5-26-08
Effective Date: 5-26-08
District # 3
SGA? Yes No

KANSAS CORPORATION COMMISSION
OIL & GAS CONSERVATION DIVISION

Form C-1
October 2007
Form must be Typed
Form must be Signed
All blanks must be Filled

NOTICE OF INTENT TO DRILL

Must be approved by KCC five (5) days prior to commencing well

Expected Spud Date: June 16 2008
month day year

OPERATOR: License# 5697
Name: Jackson Brothers, L.L.C.
Address 1: 116 East Third St.
Address 2: _____
City: Eureka State: KS Zip: 67045-1747
Contact Person: Roscoe G. Jackson II
Phone: (620) 583-5122

CONTRACTOR: License# 33217
Name: Three Rivers Exploration LLC

Well Drilled For: Oil Gas Seismic; # of Holes _____
 Enh Rec Storage Disposal Other: _____
Well Class: Infield Pool Ext. Wildcat Other: _____
Type Equipment: Mud Rotary Air Rotary Cable

If OWWO: old well information as follows:
Operator: _____
Well Name: _____
Original Completion Date: _____ Original Total Depth: _____

Directional, Deviated or Horizontal wellbore? Yes No
If Yes, true vertical depth: _____
Bottom Hole Location: _____
KCC DKT #: _____

Spot Description: _____
near C - NE - SW Sec. 3 Twp. 26 S. R. 8E E W
(0000) _____ feet from N / S Line of Section
_____ feet from E / W Line of Section
Is SECTION: Regular Irregular?

(Note: Locate well on the Section Plat on reverse side)
County: Greenwood
Lease Name: Barrier Well #: 45
Field Name: Sallyards
Is this a Prorated / Spaced Field? Yes No
Target Formation(s): Bartlesville sands
Nearest Lease or unit boundary line (in footage): est. 1400 feet
Ground Surface Elevation: 1460 feet MSL
Water well within one-quarter mile: Yes No
Public water supply well within one mile: Yes No
Depth to bottom of fresh water: 100 feet or less
Depth to bottom of usable water: 100 feet or less
Surface Pipe by Alternate: I II
Length of Surface Pipe Planned to be set: 100 feet
Length of Conductor Pipe (if any): none
Projected Total Depth: 2560 feet
Formation at Total Depth: Cherokee

Water Source for Drilling Operations: Well Farm Pond Other: _____
DWR Permit #: _____
(Note: Apply for Permit with DWR)
Will Cores be taken? Yes No
If Yes, proposed zone: _____

AFFIDAVIT

RECEIVED

The undersigned hereby affirms that the drilling, completion and eventual plugging of this well will comply with K.S.A. 55 et. seq. KANSAS CORPORATION COMMISSION
It is agreed that the following minimum requirements will be met:

1. Notify the appropriate district office **prior** to spudding of well;
2. A copy of the approved notice of intent to drill **shall be** posted on each drilling rig;
3. The minimum amount of surface pipe as specified below **shall be set** by circulating cement to the top; in all cases surface pipe shall be cemented through all unconsolidated materials plus a minimum of 20 feet into the underlying formation.
4. If the well is dry hole, an agreement between the operator and the district office on plug length and placement is necessary **prior to plugging**;
5. The appropriate district office will be notified before well is either plugged or production casing is cemented in;
6. If an ALTERNATE II COMPLETION, production pipe shall be cemented from below any usable water to surface within **120 DAYS** of spud date. Or pursuant to Appendix "B" - Eastern Kansas surface casing order #133,891-C, which applies to the KCC District 3 area, alternate II cementing must be completed within 30 days of the spud date or the well shall be plugged. **In all cases, NOTIFY district office** prior to any cementing.

I hereby certify that the statements made herein are true and correct to the best of my knowledge and belief.

Date: 19 May 2008 Signature of Operator or Agent: Roscoe G. Jackson II Title: Co-Manager

For KCC Use ONLY
API # 15 - 073-24081-00-00
Conductor pipe required None feet
Minimum surface pipe required 100 feet per ALT. I II
Approved by: SB 5-21-08
This authorization expires: 5-21-09
(This authorization void if drilling not started within 12 months of approval date.)
Spud date: _____ Agent: _____

Remember to:

- File Drill Pit Application (form CDP-1) with Intent to Drill;
- File Completion Form ACO-1 within 120 days of spud date;
- File acreage attribution plat according to field proration orders;
- Notify appropriate district office 48 hours prior to workover or re-entry;
- Submit plugging report (CP-4) after plugging is completed (within 60 days);
- Obtain written approval before disposing or injecting salt water.
- If this permit has expired (See: authorized expiration date) please check the box below and return to the address below.

Well Not Drilled - Permit Expired Date: _____
Signature of Operator or Agent: _____

3
26
8
 E W

IN ALL CASES PLOT THE INTENDED WELL ON THE PLAT BELOW

Plat of acreage attributable to a well in a prorated or spaced field

If the intended well is in a prorated or spaced field, please fully complete this side of the form. If the intended well is in a prorated or spaced field complete the plat below showing that the well will be properly located in relationship to other wells producing from the common source of supply. Please show all the wells and within 1 mile of the boundaries of the proposed acreage attribution unit for gas wells and within 1/2 mile of the boundaries of the proposed acreage attribution unit for oil wells.

API No. 15 - 073-24081-00-00
 Operator: Jackson Brothers, L.L.C.
 Lease: Barrier
 Well Number: 45 (Forty-Five)
 Field: Sallyards
 Number of Acres attributable to well: 5 (Five)
 QTR/QTR/QTR/QTR of acreage: near center. NE - SW

Location of Well: County: Greenwood
1980 feet from N / S Line of Section
2035 feet from W / E Line of Section
 Sec. 3 Twp. 26 S. R. 8E E W

Is Section: Regular or Irregular

If Section is Irregular, locate well from nearest corner boundary.
 Section corner used: NE NW SE SW

NOTE: This intended well is not in a prorated or spaced field.

PLAT

(Show location of the well and shade attributable acreage for prorated or spaced wells.)

(Show footage to the nearest lease or unit boundary line.)

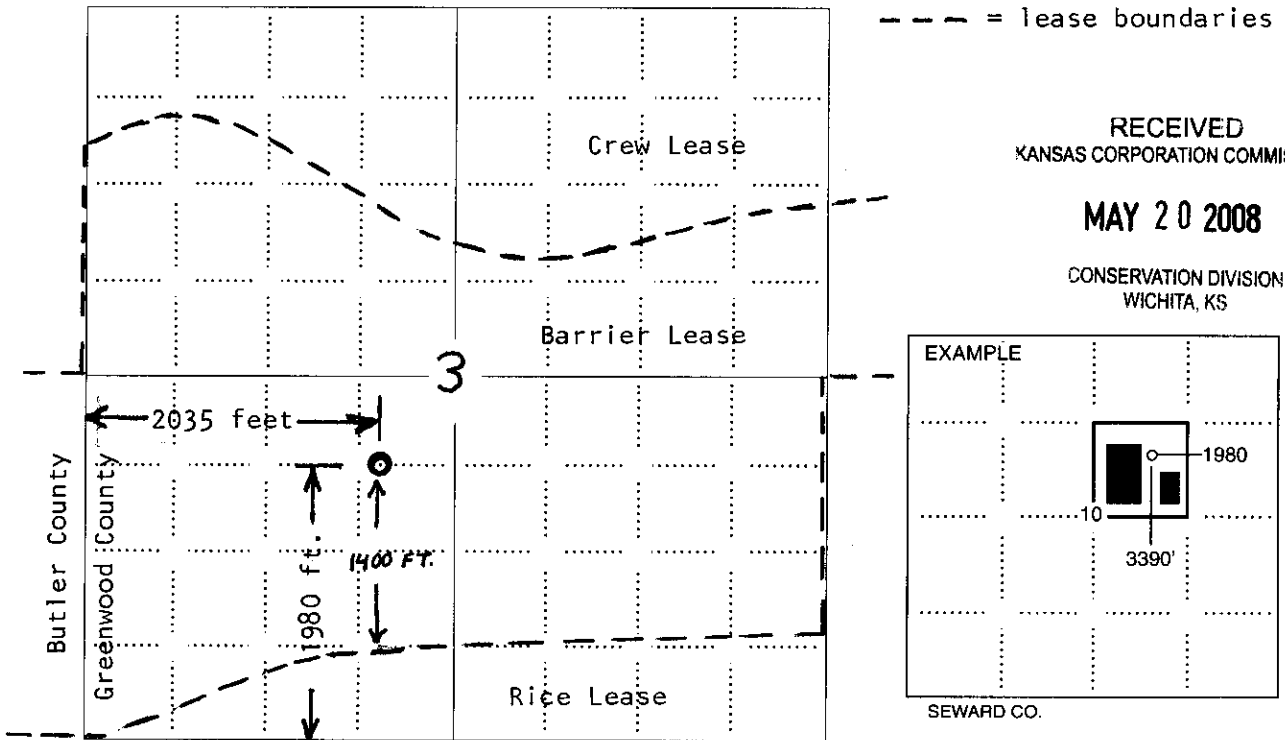

NOTE: In all cases locate the spot of the proposed drilling location.

In plotting the proposed location of the well, you must show:

1. The manner in which you are using the depicted plat by identifying section lines, i.e. 1 section, 1 section with 8 surrounding sections, 4 sections, etc.
2. The distance of the proposed drilling location from the south / north and east / west outside section lines.
3. The distance to the nearest lease or unit boundary line (in footage).
4. If proposed location is located within a prorated or spaced field a certificate of acreage attribution plat must be attached: (CO-7 for oil wells; CG-8 for gas wells).

**KANSAS CORPORATION COMMISSION
OIL & GAS CONSERVATION DIVISION
APPLICATION FOR SURFACE PIT**

Form CDP-1
April 2004
Form must be Typed

Submit in Duplicate

Operator Name: <u>Jackson Brothers, L.L.C.</u>		License Number: <u>5697</u>
Operator Address: <u>116 East Third St. Eureka, KS 67045-1747</u>		
Contact Person: <u>Roscoe G. Jackson II</u>		Phone Number: <u>(620) 583-5122</u>
Lease Name & Well No.: <u>Barrier 45</u>		Pit Location (QQQQ): <u>near center- NE - SW</u>
Type of Pit: <input type="checkbox"/> Emergency Pit <input type="checkbox"/> Burn Pit <input type="checkbox"/> Settling Pit <input checked="" type="checkbox"/> Drilling Pit <input type="checkbox"/> Workover Pit <input type="checkbox"/> Haul-Off Pit <small>(If WP Supply API No. or Year Drilled)</small>		Pit is: <input checked="" type="checkbox"/> Proposed <input type="checkbox"/> Existing If Existing, date constructed: _____ Pit capacity: (total) <u>650</u> (bbls)
Is the pit located in a Sensitive Ground Water Area? <input type="checkbox"/> Yes <input checked="" type="checkbox"/> No		Chloride concentration: _____ mg/l <small>(For Emergency Pits and Settling Pits only)</small>
Is the bottom below ground level? <input checked="" type="checkbox"/> Yes <input type="checkbox"/> No		How is the pit lined if a plastic liner is not used? <u>Natural clays of the Clime-Sogn soil complex.</u>
Artificial Liner? <input type="checkbox"/> Yes <input checked="" type="checkbox"/> No		
Pit dimensions (all but working pits): <u>30</u> Length (feet) <u>10</u> Width (feet) <input type="checkbox"/> N/A: Steel Pits Depth from ground level to deepest point: <u>6</u> (feet) <input type="checkbox"/> No Pit		
If the pit is lined give a brief description of the liner material, thickness and installation procedure.		Describe procedures for periodic maintenance and determining liner integrity, including any special monitoring.
		RECEIVED MAY 20 2008 CONSERVATION DIVISION WICHITA, KS
Distance to nearest water well within one-mile of pit (None known to operator) <u>N/A</u> feet Depth of water well _____ feet		Depth to shallowest fresh water _____ feet. Source of information: <input type="checkbox"/> measured <input type="checkbox"/> well owner <input type="checkbox"/> electric log <input type="checkbox"/> KDWR
Emergency, Settling and Burn Pits ONLY: Producing Formation: _____ Number of producing wells on lease: _____ Barrels of fluid produced daily: _____ Does the slope from the tank battery allow all spilled fluids to flow into the pit? <input type="checkbox"/> Yes <input type="checkbox"/> No		Drilling, Workover and Haul-Off Pits ONLY: Type of material utilized in drilling/workover: <u>fresh-water drilling mud.</u> Number of working pits to be utilized: <u>2</u> Abandonment procedure: <u>Let air dry then backfill.</u> Drill pits must be closed within 365 days of spud date.
I hereby certify that the above statements are true and correct to the best of my knowledge and belief.		
<u>19 May 2008</u> Date		<u>Roscoe G Jackson II</u> Signature of Applicant or Agent

KCC OFFICE USE ONLY		Steel Pit <input type="checkbox"/>	RFAC <input type="checkbox"/>	RFAS <input type="checkbox"/>
Date Received: <u>5/20/08</u>	Permit Number: _____	Permit Date: <u>5/20/08</u>	Lease Inspection: <input type="checkbox"/> Yes <input checked="" type="checkbox"/> No	

Mail to: KCC - Conservation Division, 130 S. Market - Room 2078, Wichita, Kansas 67202

15-073-24081-00-00