

For KCC Use:
 Effective Date: 5-26-08
 District # 4
 SGA? Yes No

KANSAS CORPORATION COMMISSION
 OIL & GAS CONSERVATION DIVISION

Form C-1
 October 2007
 Form must be Typed
 Form must be Signed
 All blanks must be Filled

NOTICE OF INTENT TO DRILL

Must be approved by KCC five (5) days prior to commencing well

Expected Spud Date June 19 2008
 month day year

Spot Description: 215'W of
SE SE SW Sec 16 Twp. 12 S Rng. 33 E W

OPERATOR: License # 5003
 Name: McCoy Petroleum Corporation
 Address 1: 8080 E. Central, Suite #300
 Address 2:
 City: Wichita State: KS Zip: 67206-2366
 Contact Person: Scott Hampel
 Phone: 316-636-2737 x 104

330 feet from N / S Line of Section
3185 feet from E / W Line of Section
 Is SECTION: Regular Irregular?
 (Note: Locate well on the Section Plat on reverse side)

CONTRACTOR: License # 30606
 Name: Murfin Drilling Company

County: Logan
 Lease Name: DUNLAP "B" Well #: 1-16
 Field Name: Wildcat
 Is this a Prorated / Spaced Field? Yes No

Well Drilled For: Oil Gas Seismic: # of Holes Other:
 Well Class: Enh Rec Storage Disposal Wildcat Other
 Type Equipment: Mud Rotary Air Rotary Cable

Target Information(s): Lansing
 Nearest Lease or unit boundary (in footage): 330'
 Ground Surface Elevation: 3134 feet MSL
 Water well within one-quarter mile: Yes No
 Public water supply well within one mile: Yes No

If OWWO: old well information as follows:
 Operator:
 Well Name:
 Original Completion Date: Original Total Depth:

Depth to bottom of fresh water: 150'
 Depth to bottom of usable water: 1650' 1720'
 Surface Pipe by Alternate: I II
 Length of Surface Pipe Planned to be set: 220'+
 Length of Conductor Pipe (if any): None
 Projected Total Depth: 4750'
 Formation at Total Depth: Mississippian

Directional, Deviated or Horizontal wellbore? Yes No
 if Yes, true vertical depth:
 Bottom Hole Location:
 KCC DKT #:

Water Source for Drilling Operations:
 Well Farm Pond Other: Haul Water
 DWR Permit #:
 (Note: Apply for Permit with DWR)
 Will Cores be taken? Yes No
 If Yes, proposed zone:

AFFIDAVIT

The undersigned hereby affirms that the drilling, completion and eventual plugging of this well will comply with K.S.A. 55 et. seq.
 It is agreed that the following minimum requirements will be met:

1. Notify the appropriate district office *prior* to spudding of well;
2. A copy of the approved notice of intent to drill *shall be* posted on each drilling rig;
3. The minimum amount of surface pipe as specified below *shall be set* by circulating cement to the *top*, in all cases surface pipe *shall be set* through all unconsolidated materials plus a minimum of 20 feet into the underlying formation.
4. If the well is dry hole, an agreement between the operator and the district office on plug length and placement is necessary *prior to plugging*;
5. The appropriate district office will be notified before well is either plugged or production casing is cemented in;
6. If an ALTERNATE II COMPLETION, production pipe shall be cemented from below any unable water to surface within **120 days** of plug date. Or pursuant to Appendix "B" - Eastern Kansas surface casing order #133,891-C, which applies to the KCC District 3 area, alternate II cementation must be completed within 30 days of the spud date or the well shall be plugged. **In all cases, NOTIFY district office** prior to any cementing.

RECEIVED
 KANSAS CORPORATION COMMISSION
 MAY 20 2008
 CONSERVATION DIVISION
 WICHITA, KS

I hereby certify that the statements made herein are true and to the best of my knowledge and belief.

Date: 5/19/08 Signature of Operator or Agent: Scott Hampel Title: Vice President - Production

For KCC Use ONLY
 API # 15 - 109-20812-00-00
 Conductor pipe required None feet
 Minimum surface pipe required 200 feet per ALT. I II
 Approved by: SB 5-21-08
 This authorization expires: 5-21-09
 (This authorization void if drilling not started within 12 months of effective date.)
 Spud date: Agent:

Remember to:
 - File Drill Pit Application (form CDP-1) with Intent to Drill;
 - File Completion Form ACO-1 within 120 days of spud date;
 - File acreage attribution plat according to field proration orders;
 - Notify appropriate district office 48 hours prior to workover or re-entry;
 - Submit plugging report (CP-4) after plugging is completed (within 60 days);
 - Obtain written approval before disposing or injecting salt water.
 - If this permit has expired (See: authorized expiration date) please check the box below and return to the address below.
 Well Not Drilled - Permit Expired Date:
 Signature of Operator or Agent:

IN ALL CASES PLOT THE INTENDED WELL ON THE PLAT BELOW

Plat of acreage attributable to a well in a prorated or spaced field

If the intended well is in a prorated or spaced field, please fully complete this side of the form. If the intended well is in a prorated or spaced field complete the plat below showing that the well will be properly located in relationship to other wells producing from the common source of supply. Please show all the wells and within 1 mile of the boundaries of the proposed acreage attribution unit for gas wells and within 1/2 mile of the boundaries of the proposed acreage attribution unit for oil wells.

API No. 15 - 109-20812-00-00
 Operator: McCoy Petroleum Corporation
 Lease: DUNLAP "B" #1-16
 Well Number: #1-16
 Field: Wildcat
 Number of Acres attributable to well: _____
 QTR / QTR / QTR of acreage: SE SE SW

Location of Well: County: 215' W of SE SE SW, Logan Co., KS
 _____ 330 feet from N S (check one) Line of Section
 _____ 3185 feet from E W (check one) Line of Section
 Sec 16 Twp 12 S. R. 33 East West
 Is Section: Regular Irregular?
 If Section is Irregular, locate well from nearest corner boundary.
 Section corner used: NE NW SE SW

PLAT

*(Show location of the well and shade attributable acreage for prorated or spaced wells)
 (Show footage to the nearest lease or unit boundary fine.)*

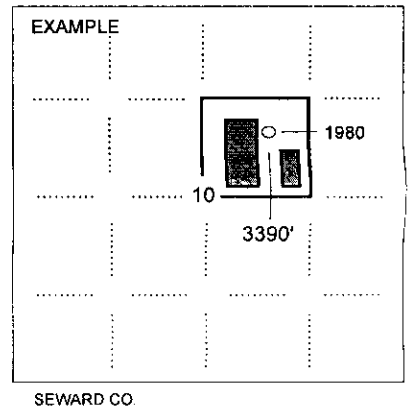
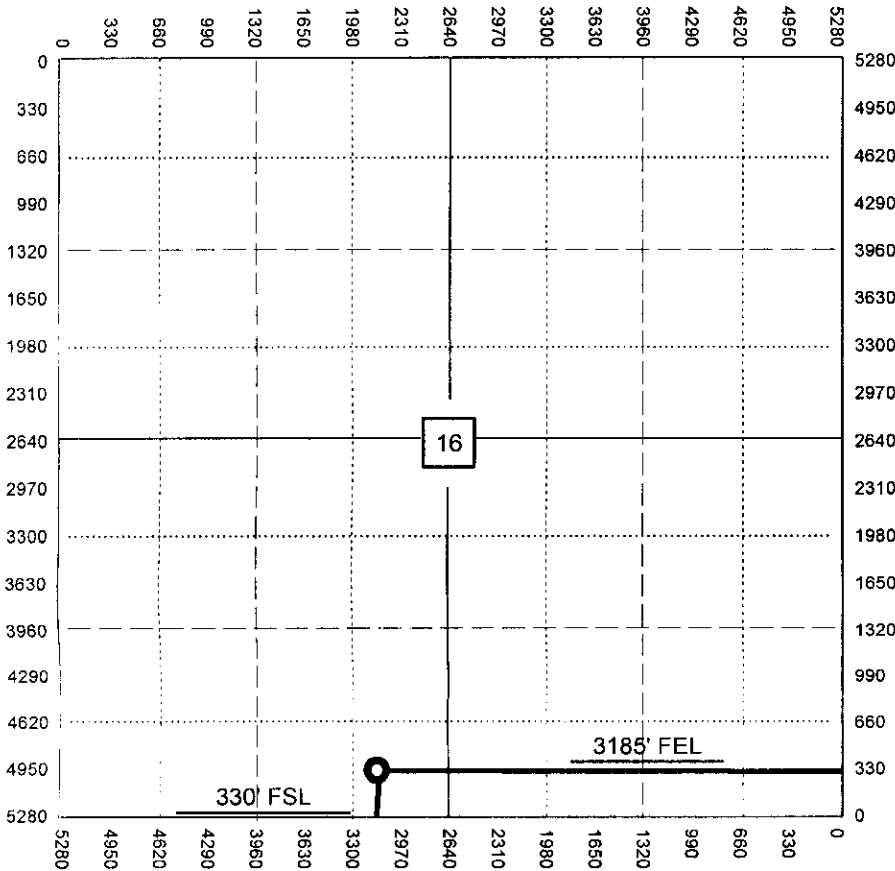

NOTE: In all cases locate the spot of the proposed drilling location.

In plotting the proposed location of the well, you must show.

1. The manner in which you are using the depicted plat by identifying section lines, i.e. 1 section, 1 section with 8 surrounding sections, 4 sections, etc.
2. The distance of the proposed drilling location from the south / north and east / west outside section lines.
3. The distance to the nearest lease or unit boundary line (in footage).
4. If proposed location is located within a prorated or spaced field a certificate of acreage attribution plat must be attached: (CO-7 for oil wells; CG-8 for gas wells).

**KANSAS CORPORATION COMMISSION
OIL & GAS CONSERVATION DIVISION
APPLICATION FOR SURFACE PIT**

Form CDP-1
April 2004
Form must be Typed

Submit in Duplicate

Operator Name: McCoy Petroleum Corporation		License Number: 5003
Operator Address: 8080 E. Central, Suite #300, Wichita, KS 67206-2366		
Contact Person: Scott Hampel		Phone Number: 316-636-2737x104
Lease Name & Well No.: DUNLAP "B" #1-16		Pit Location (QQQQ): 215'W of SE SE SW
Type of Pit: <input type="checkbox"/> Emergency Pit <input type="checkbox"/> Burn Pit <input type="checkbox"/> Settling Pit <input checked="" type="checkbox"/> Drilling Pit <input type="checkbox"/> Workover Pit <input type="checkbox"/> Haul-Off Pit <small>(If WP Supply API No. or Year Drilled)</small>	Pit is: <input checked="" type="checkbox"/> Proposed <input type="checkbox"/> Existing If Existing, date constructed: _____ Pit capacity: 3600 (bbls)	Sec 16 Twp 12s R 33 <input type="checkbox"/> East <input checked="" type="checkbox"/> West 330 Feet from <input type="checkbox"/> North / <input checked="" type="checkbox"/> South Line of Section 3185 Feet from <input checked="" type="checkbox"/> East / <input type="checkbox"/> West Line of Section Logan County
Is the pit located in a Sensitive Ground Water Area? <input type="checkbox"/> Yes <input checked="" type="checkbox"/> No		Chloride concentration: _____ mg/l <small>(For Emergency Pits and Settling Pits only)</small>
Is the bottom below ground level? <input checked="" type="checkbox"/> Yes <input type="checkbox"/> No	Artificial Liner? <input type="checkbox"/> Yes <input checked="" type="checkbox"/> No	How is the pit lined if a plastic liner is not used? Bentonite / Drilling Mud
Pit dimensions (all but working pits): 80 Length (feet) 80 Width (feet) N/A: Steel Pits Depth from ground level to deepest point: 4 (feet)		
If the pit is lined give a brief description of the liner material, thickness and installation procedure.		Describe procedures for periodic maintenance and determining liner integrity, including any special monitoring.
Distance to nearest water well within one-mile of pit NA feet Depth of water well NA feet		Depth to shallowest fresh water NA feet. Source of information: <input type="checkbox"/> measured <input checked="" type="checkbox"/> well owner <input type="checkbox"/> electric log <input type="checkbox"/> KDWR
Emergency, Settling and Burn Pits ONLY: Producing Formation: _____ Number of producing wells on lease: _____ Barrels of fluid produced daily: _____ Does the slope from the tank battery allow all spilled fluids to flow into the pit? <input type="checkbox"/> Yes <input type="checkbox"/> No		Drilling, Workover and Haul-Off Pits ONLY: Type of material utilized in drilling/workover: Bentonite Number of working pits to be utilized: 3 Abandonment procedure: Let dry, backfill, return surface to original condition. Drill pits must be closed within 365 days of spud date.
I hereby certify that the above statements are true and correct to the best of my knowledge and belief.		
5/19/08 Date		 Signature of Applicant or Agent Scott Hampel

KCC OFFICE USE ONLY			
Date Received: 5/20/08	Permit Number: _____	Permit Date: 5/20/08	Lease Inspection: <input type="checkbox"/> Yes <input checked="" type="checkbox"/> No

Mail to: KCC - Conservation Division, 130 S. Market - Room 2078, Wichita, Kansas 67202

**RECEIVED
KANSAS CORPORATION COMMISSION**

MAY 20 2008

CONSERVATION DIVISION
WICHITA, KS

15-109-20812-00-00