

For KCC Use: 5-28-08  
Effective Date: 5-28-08  
District # 3  
SGA?  Yes  No

KANSAS CORPORATION COMMISSION  
OIL & GAS CONSERVATION DIVISION

Form C-1  
October 2007  
Form must be Typed  
Form must be Signed  
All blanks must be Filled

NOTICE OF INTENT TO DRILL

Must be approved by KCC five (5) days prior to commencing well

Expected Spud Date: May 26, 2008  
month day year

OPERATOR: License# 32711  
Name: Mike Becker  
Address 1: 15135 Broadmoor  
Address 2: \_\_\_\_\_  
City: Stanley State: KS Zip: 66223  
Contact Person: Mike Becker  
Phone: 913-271-5179

CONTRACTOR: License# 32711  
Name: Mike Becker

Spot Description: \_\_\_\_\_  
NE NE NW NW Sec. 24 Twp. 31 S. R. 21  E  W  
(1/4/1/4) 165 feet from  N /  S Line of Section  
1,120 feet from  E /  W Line of Section

Is SECTION:  Regular  Irregular?  
(Note: Locate well on the Section Plat on reverse side)

County: Cherokee  
Lease Name: Kruger Well #: 5  
Field Name: McCune

Is this a Prorated / Spaced Field?  Yes  No  
Target Formation(s): Bartlesville  
Nearest Lease or unit boundary line (in footage): 1/4 mile to north (1020')

Ground Surface Elevation: 860 feet MSL  
Water well within one-quarter mile:  Yes  No  
Public water supply well within one mile:  Yes  No

Depth to bottom of fresh water: 120 feet  
Depth to bottom of usable water: 1,000 feet  
Surface Pipe by Alternate:  I  II  
Length of Surface Pipe Planned to be set: 20 feet

Length of Conductor Pipe (if any): n/a  
Projected Total Depth: 300 feet  
Formation at Total Depth: Bartlesville

Water Source for Drilling Operations:  
 Well  Farm Pond  Other: Water tank  
DWR Permit #: \_\_\_\_\_

(Note: Apply for Permit with DWR )  
Will Cores be taken?  Yes  No  
If Yes, proposed zone: \_\_\_\_\_

Well Drilled For:  Oil  Gas  Seismic; # of Holes \_\_\_\_\_  
 Enh Rec  Storage  Disposal  Other: \_\_\_\_\_  
Well Class:  Infield  Pool Ext.  Wildcat  Other: \_\_\_\_\_  
Type Equipment:  Mud Rotary  Air Rotary  Cable  
 If OWWO: old well information as follows:  
Operator: \_\_\_\_\_  
Well Name: \_\_\_\_\_  
Original Completion Date: \_\_\_\_\_ Original Total Depth: \_\_\_\_\_

Directional, Deviated or Horizontal wellbore?  Yes  No  
If Yes, true vertical depth: \_\_\_\_\_  
Bottom Hole Location: \_\_\_\_\_  
KCC DKT #: \_\_\_\_\_

AFFIDAVIT

The undersigned hereby affirms that the drilling, completion and eventual plugging of this well will comply with K.S.A. 55 et. seq.  
It is agreed that the following minimum requirements will be met:

1. Notify the appropriate district office **prior** to spudding of well;
2. A copy of the approved notice of intent to drill **shall be** posted on each drilling rig;
3. The minimum amount of surface pipe as specified below **shall be set** by circulating cement to the top; in all cases surface pipe shall be set through all unconsolidated materials plus a minimum of 20 feet into the underlying formation.
4. If the well is dry hole, an agreement between the operator and the district office on plug length and placement is necessary **prior to plugging**;
5. The appropriate district office will be notified before well is either plugged or production casing is cemented in;
6. If an ALTERNATE II COMPLETION, production pipe shall be cemented from below any usable water to surface within **120 DAYS** of spud date. Or pursuant to Appendix "B" - Eastern Kansas surface casing order #133,891-C, which applies to the KCC District 3 area, alternate II cementing must be completed within 30 days of the spud date or the well shall be plugged. **In all cases, NOTIFY district office** prior to any cementing.

I hereby certify that the statements made herein are true and correct to the best of my knowledge and belief.  
Date: 5-20-08 Signature of Operator or Agent: Mike Becker Title: operator

RECEIVED  
KANSAS CORPORATION COMMISSION  
MAY 22 2008  
CONSERVATION DIVISION  
WICHITA, KS

For KCC Use ONLY  
API # 15 - 021-20287-00-00  
Conductor pipe required None feet  
Minimum surface pipe required 20 feet per ALT.  I  II  
Approved by: SB 5-23-08  
This authorization expires: 5-23-09  
(This authorization void if drilling not started within 12 months of approval date.)  
Spud date: \_\_\_\_\_ Agent: \_\_\_\_\_

Remember to:  
- File Drill Pit Application (form CDP-1) with Intent to Drill;  
- File Completion Form ACO-1 within 120 days of spud date;  
- File acreage attribution plat according to field proration orders;  
- Notify appropriate district office 48 hours prior to workover or re-entry;  
- Submit plugging report (CP-4) after plugging is completed (within 60 days);  
- Obtain written approval before disposing or injecting salt water.  
- If this permit has expired (See: authorized expiration date) please check the box below and return to the address below.  
 Well Not Drilled - Permit Expired Date: \_\_\_\_\_  
Signature of Operator or Agent: \_\_\_\_\_

24  
31  
21  
 E  
 W

**IN ALL CASES PLOT THE INTENDED WELL ON THE PLAT BELOW**

*Plat of acreage attributable to a well in a prorated or spaced field*

**If the intended well is in a prorated or spaced field, please fully complete this side of the form.** If the intended well is in a prorated or spaced field complete the plat below showing that the well will be properly located in relationship to other wells producing from the common source of supply. Please show all the wells and within 1 mile of the boundaries of the proposed acreage attribution unit for gas wells and within 1/2 mile of the boundaries of the proposed acreage attribution unit for oil wells.

API No. 15 - 021-20287-00-00  
Operator: Mike Becker  
Lease: Kruger  
Well Number: 5  
Field: McCune

Location of Well: County: Cherokee  
165 feet from  N /  S Line of Section  
1,120 feet from  E /  W Line of Section  
Sec. 24 Twp. 31 S. R. 21  E  W

Number of Acres attributable to well: 40 acres  
QTR/QTR/QTR/QTR of acreage: NE - NE - NW - NW

Is Section:  Regular or  Irregular

**If Section is Irregular, locate well from nearest corner boundary.**  
Section corner used:  NE  NW  SE  SW

**PLAT**

(Show location of the well and shade attributable acreage for prorated or spaced wells.)  
(Show footage to the nearest lease or unit boundary line.)

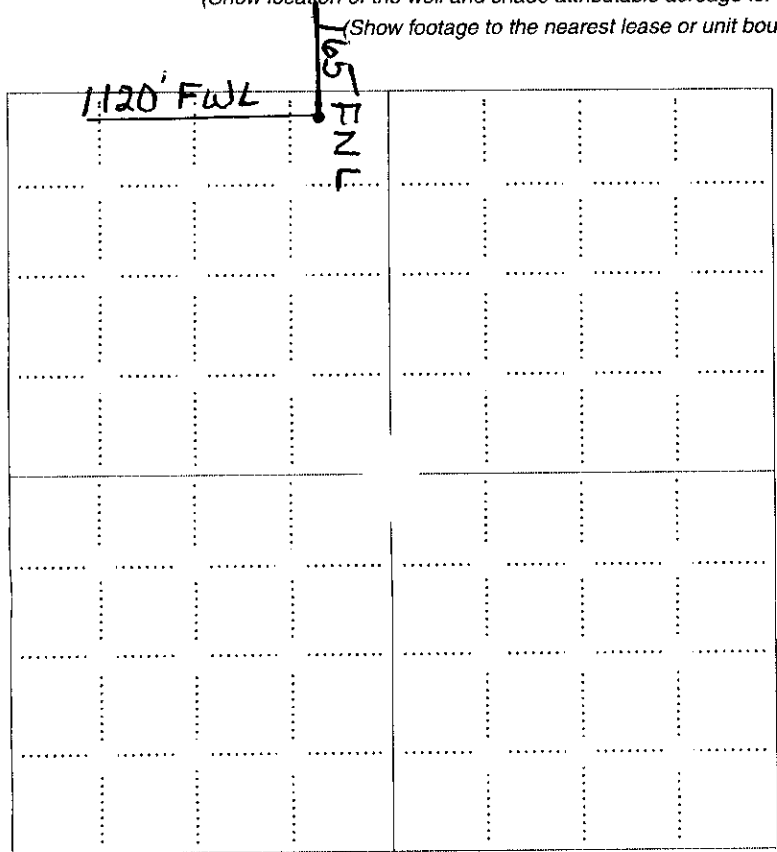

RECEIVED  
KANSAS CORPORATION COMMISSION  
MAY 22 2008  
CONSERVATION DIVISION  
WICHITA, KS

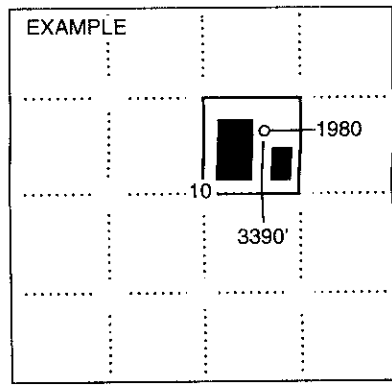

**NOTE: In all cases locate the spot of the proposed drilling locaton.**

**In plotting the proposed location of the well, you must show:**

1. The manner in which you are using the depicted plat by identifying section lines, i.e. 1 section, 1 section with 8 surrounding sections, 4 sections, etc.
2. The distance of the proposed drilling location from the south / north and east / west outside section lines.
3. The distance to the nearest lease or unit boundary line (in footage).
4. If proposed location is located within a prorated or spaced field a certificate of acreage attribution plat must be attached: (CO-7 for oil wells; CG-8 for gas wells).

KANSAS CORPORATION COMMISSION  
OIL & GAS CONSERVATION DIVISION

Form CDP-1  
April 2004  
Form must be Typed

APPLICATION FOR SURFACE PIT

Submit in Duplicate

Operator Name: <b>Mike Becker</b>		License Number: <b>32711</b>	
Operator Address: <b>15135 Broadmoor</b>		<b>Stanley KS 66223</b>	
Contact Person: <b>Mike Becker</b>		Phone Number: <b>913-271-5179</b>	
Lease Name & Well No.: <b>Kruger 5</b>		Pit Location (QQQQ): <b>NE NE NW NW</b>	
Type of Pit: <input type="checkbox"/> Emergency Pit <input type="checkbox"/> Burn Pit <input type="checkbox"/> Settling Pit <input checked="" type="checkbox"/> Drilling Pit <input type="checkbox"/> Workover Pit <input type="checkbox"/> Haul-Off Pit <small>(If WP Supply API No. or Year Drilled)</small>		Pit is: <input checked="" type="checkbox"/> Proposed <input type="checkbox"/> Existing If Existing, date constructed: _____ Pit capacity: <b>200</b> (bbls)	
		Sec. <b>24</b> Twp. <b>31</b> R. <b>21</b> <input checked="" type="checkbox"/> East <input type="checkbox"/> West <b>165</b> Feet from <input checked="" type="checkbox"/> North / <input type="checkbox"/> South Line of Section <b>1,120</b> Feet from <input type="checkbox"/> East / <input checked="" type="checkbox"/> West Line of Section <b>Cherokee</b> County	
Is the pit located in a Sensitive Ground Water Area? <input type="checkbox"/> Yes <input checked="" type="checkbox"/> No		Chloride concentration: _____ mg/l <small>(For Emergency Pits and Settling Pits only)</small>	
Is the bottom below ground level? <input checked="" type="checkbox"/> Yes <input type="checkbox"/> No		Artificial Liner? <input type="checkbox"/> Yes <input checked="" type="checkbox"/> No	
		How is the pit lined if a plastic liner is not used? <b>Clay</b>	
Pit dimensions (all but working pits): <b>25</b> Length (feet) <b>8</b> Width (feet) <input type="checkbox"/> N/A: Steel Pits		Depth from ground level to deepest point: <b>6</b> (feet) <input type="checkbox"/> No Pit	
If the pit is lined give a brief description of the liner material, thickness and installation procedure. <b>n/a</b>		Describe procedures for periodic maintenance and determining liner integrity, including any special monitoring. <b>n/a</b>	
Distance to nearest water well within one-mile of pit <b>n/a</b> ✓ feet    Depth of water well _____ feet		Depth to shallowest fresh water <b>120</b> feet. Source of information: <input type="checkbox"/> measured <input checked="" type="checkbox"/> well owner <input type="checkbox"/> electric log <input type="checkbox"/> KDWR	
<b>Emergency, Settling and Burn Pits ONLY:</b> Producing Formation: _____ Number of producing wells on lease: _____ Barrels of fluid produced daily: _____ Does the slope from the tank battery allow all spilled fluids to flow into the pit? <input type="checkbox"/> Yes <input type="checkbox"/> No		<b>Drilling, Workover and Haul-Off Pits ONLY:</b> Type of material utilized in drilling/workover: <b>water</b> Number of working pits to be utilized: <b>1</b> Abandonment procedure: <b>Drain water, fill back in with dirt</b> Drill pits must be closed within 365 days of spud date.	
I hereby certify that the above statements are true and correct to the best of my knowledge and belief.			
<b>5-20-08</b> Date		<b>Mike Becker</b> Signature of Applicant or Agent	
		RECEIVED KANSAS CORPORATION COMMISSION <b>MAY 22 2008</b> CONSERVATION DIVISION WICHITA, KS	
<b>KCC OFFICE USE ONLY</b>			
		Steel Pit <input type="checkbox"/> RFAC <input type="checkbox"/> RFAS <input type="checkbox"/>	
Date Received: <b>5/22/08</b> Permit Number: _____		Permit Date: <b>5/22/08</b> Lease Inspection: <input type="checkbox"/> Yes <input checked="" type="checkbox"/> No	

15-021-20287-00-00