

Give All Information Completely
Make Required Affidavit
Mail or Deliver Report to:
Conservation Division
State Corporation Commission
800 Bittling Building
Wichita, Kansas

15-163-00341-00-00

WELL PLUGGING RECORD

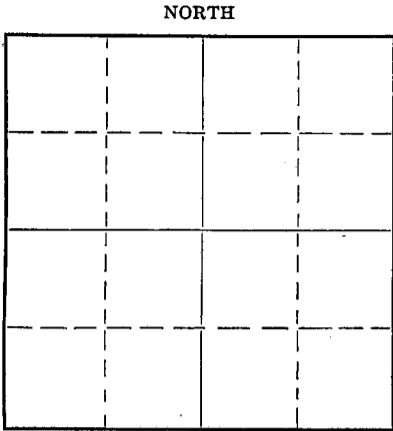

Locate well correctly on above Section Plat

Rocks..... County. Sec. 2 Twp. 10 Rge. 16 (E) W (W)
Location as "NE/CNW $\frac{1}{4}$ SW $\frac{1}{4}$ " or footage from lines C E/2 SE/4 SW/4
Lease Owner Transit Corporation
Lease Name Erway Well No. 1
Office Address 3111 Apco Tower, Oklahoma City, Oklahoma
Character of Well (completed as Oil, Gas or Dry Hole) Dry Hole
Date well completed..... 4-6-1951
Application for plugging filed..... 4-6-1951
Application for plugging approved..... 4-6-1951
Plugging commenced..... 4-6-1951
Plugging completed..... 4-6-1951
Reason for abandonment of well or producing formation.....

If a producing well is abandoned, date of last production..... 19.....
Was permission obtained from the Conservation Division or its agents before plugging was commenced? Yes

Name of Conservation Agent who supervised plugging of this well Eldon Petty, Hays, Kansas
Producing formation..... Depth to top..... Bottom..... Total Depth of Well 3493' Feet
Show depth and thickness of all water, oil and gas formations.

OIL, GAS OR WATER RECORDS

CASING RECORD

Formation	Content	From	To	Size	Put In	Pulled Out
				8 5/8	114	None

Describe in detail the manner in which the well was plugged, indicating where the mud fluid was placed and the method or methods used in introducing it into the hole. If cement or other plugs were used, state the character of same and depth placed, from..... feet to..... feet for each plug set.

Filled hole with heavy drilling mud to 114' set Halliburton Plug. Cemented with 15 sacks cement. Filled hole with heavy drilling mud to 40' set Halliburton plug. Cemented to surface with 10 sacks cement.

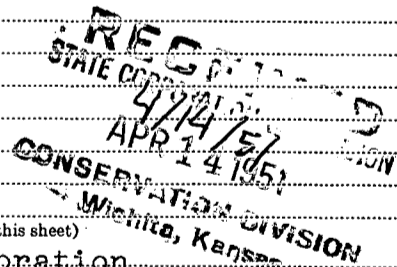

(If additional description is necessary, use BACK of this sheet)

Correspondence regarding this well should be addressed to Transit Corporation
Address 3111 Apco Tower, Oklahoma City, Oklahoma

STATE OF Oklahoma, COUNTY OF Oklahoma, ss.
..... (employee of owner) Transit Corporation of the above-described well,
being first duly sworn on oath, says: That I have knowledge of the facts, statements, and matters herein contained and the log of the above-described well as filed and that the same are true and correct. So help me God.

(Signature) [Signature]
Oklahoma City, Oklahoma (Address)

SUBSCRIBED AND SWORN to before me this 12th day of April 19 51

My commission expires March 13, 1953
[Signature] Notary Public.

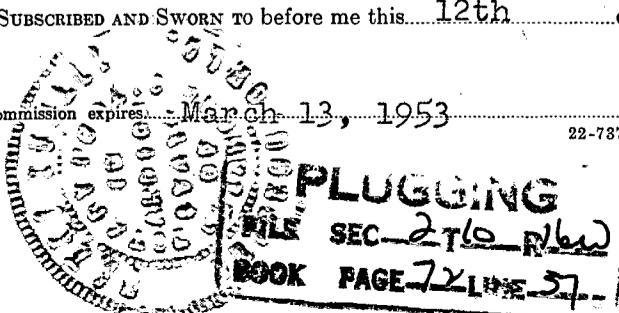

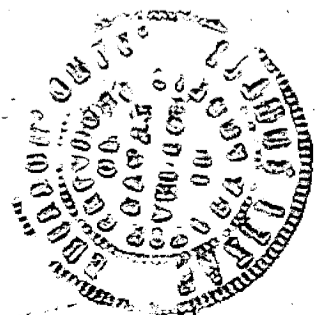
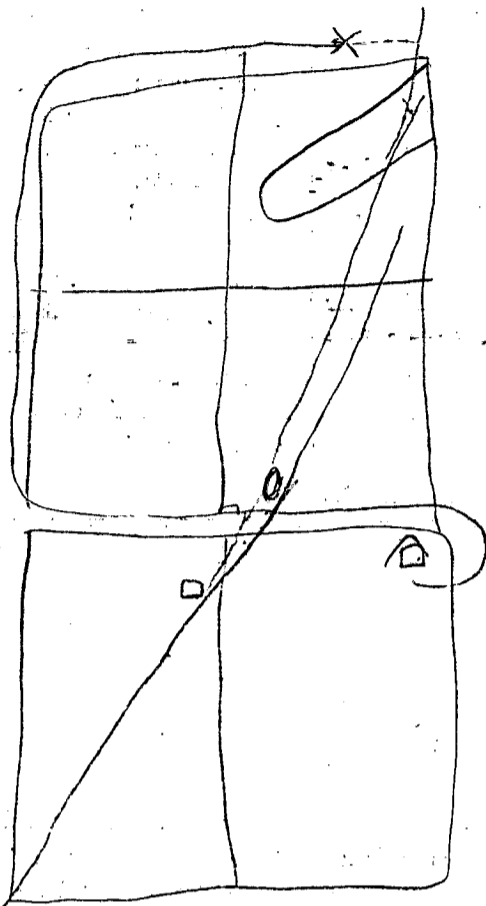
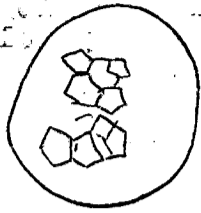

Transit Corporation, etal

ERWAY # 1

C E/2 SE/4 SW/4 Sec. 2-10S-16W
Rooks County, Kansas

FORMATION	FROM	TO	REMARKS
Surface Clay & Sand	0	20	8 5/8" C.S.A. @ 114' Cement- ed with 75 sacks cement.
Blue Shale Shells	20	114	
Shale	114	460	
Sand	460	520	
Shale & Shells	520	640	
Sand	640	770	
Shale & Shells	770	1128	
Anhydrite	1128	1165	
Shale & Shells	1165	1930	
Shale & Lime	1930	2060	
Lime Broken	2060	2135	
Lime & Shale	2135	2290	
Shale & Lime	2290	2860	
Broken Lime	2860	2920	
Lime	2920	3220	
Lime Hard	3220	3260	
Lime	3260	3375	
Shale Lime	3375	3482	
Lime	3482	3493	
Total Depth		3493'	

I hereby certify the foregoing to be a true and accurate Drilling Log of the formations encountered in the above well.

TRANSIT CORPORATION

By: L. J. Kruse
L. J. Kruse, Ass't Secy.

Subscribed and sworn to before me this 12th day of April, 1951.

My Commission Expires: March 13, 1953

Had Tuley
Notary Public
STATE CORPORATION COMMISSION

APR 14 1951

CONSERVATION DIVISION

PLUGGING
FILE SEC 2 T 10 R 16 W
BOOK PAGE 72 OF 37