

15-065-02021-00-00

STATE OF KANSAS  
STATE CORPORATION COMMISSION

WELL PLUGGING RECORD

Give All Information Completely  
Make Required Affidavit  
Mail or Deliver Report to:  
Conservation Division  
State Corporation Commission  
212 North Market, Insurance Bldg.  
Wichita, Kansas

Graham County, Sec. 27 Twp. 8S Rge. 24 (W)

Location as "NE/CNW/SE" or footage from lines C E/2 E/2 SE/4

Lease Owner JOHN O. FARMER, INC.

Lease Name KOBLER "B" Well No. 1

Office Address Russell, Kansas

Character of Well (completed as Oil, Gas or Dry Hole) Dry

Date well completed 11/27 19 59

Application for plugging filed 11/27 19 59

Application for plugging approved 11/27 19 59

Plugging commenced 11/27 19 59

Plugging completed 11/27 19 59

Reason for abandonment of well or producing formation Dry

If a producing well is abandoned, date of last production 19

Was permission obtained from the Conservation Division or its agents before plugging was commenced? yes

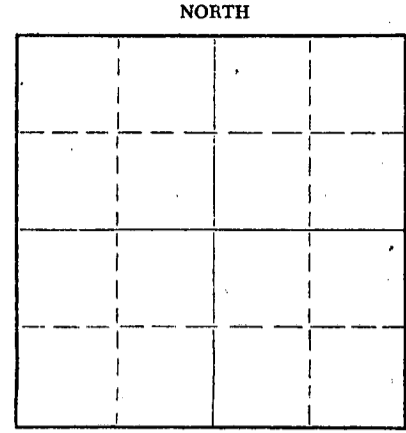

Locate well correctly on above Section Plat

Name of Conservation Agent who supervised plugging of this well Fabricius, Hill City, Kansas

Producing formation Depth to top Bottom Total Depth of Well 3940 Feet

Show depth and thickness of all water, oil and gas formations.

OIL, GAS OR WATER RECORDS

CASING RECORD

FORMATION	CONTENT	FROM	TO	SIZE	PUT IN	PULLED OUT
				8-5/8"	160'	None

Describe in detail the manner in which the well was plugged, indicating where the mud fluid was placed and the method or methods used in introducing it into the hole. If cement or other plugs were used, state the character of same and depth placed, from feet to feet for each plug set.

- First plug set at 600 feet with 20 sacks cement
- Second plug set at 160 feet with 20 sacks cement
- Third plug set at 40 feet with 10 sacks cement

RECEIVED  
CORPORATION COMMISSION  
12-8-1959  
DEC 8 1959  
CONSERVATION DIVISION  
Wichita, Kansas

(If additional description is necessary, use BACK of this sheet)  
Name of Plugging Contractor JOHN O. FARMER, INC.  
Address Russell, Kansas

STATE OF Kansas COUNTY OF Russell, ss.  
I, JOHN O. FARMER (owner or operator) of the above-described well, being first duly sworn on oath, says: That I have knowledge of the facts, statements, and matters herein contained and the log of the above-described well as filed and that the same are true and correct. So help me God.

(Signature) John O. Farmer  
Russell, Kansas (Address)

Subscribed and sworn to before me this 1st day of December, 19 59  
October 11, 1962  
Lucille Kennedy Notary Public.



OPERATOR JOHN O. FARMER, INC.

FORMATION RECORD

ADDRESS Russell, Kansas

Give detailed description and thickness of all formation drilled through, contents of sand, whether dry, water, oil or gas.

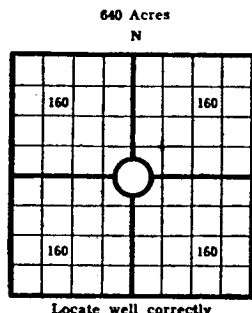

640 Acres N  
 COUNTY Graham SEC. 27 TWP. 8S RGE. 24W  
 COMPANY OPERATING JOHN O. FARMER, INC.  
 OFFICE ADDRESS Russell, Kansas  
 DRILLING STARTED 11/18 1959 DRILLING FINISHED 11/27 1959  
 DATE OF FIRST PRODUCTION \_\_\_\_\_ COMPLETED \_\_\_\_\_  
 WELL LOCATED C E/2 E/2 SE/4 1/4 \_\_\_\_\_, North of South  
 Line and \_\_\_\_\_ ft. East of West Line of Quarter Section  
 Elevation (Relative to sea level) DERRICK FLOOR 2376 GROUND, 2373  
 CHARACTER OF WELL (Oil, gas or dryhole) Dry

Formation	Top	Bottom	Formation	Top	Bottom
FARM NAME			KOBLER "B" #1		
Surface	0	160			
Shale & sand	160	1660			
Shale & redbed	1660	2058			
Anhydrite	2058	2102			
Shale & shells	2102	2475			
Shale & lime	2475	3215			
Lime & shale	3215	3710			
Lime	3710	3760			
Lime & shale	3760	3775			
Lime	3775	3875			
Lime & shale	3875	3940			
T.D.		3940			
			<b>SAMPLE TOPS:</b>		
			<b>ELEVATION:</b>	KB	2378
			Anhydrite		2058
			Heebner		3677
			Toronto		3700
			Lansing		3715
			B/KC		3928
			T.D.		3940
			<b>D &amp; A</b>		

OIL OR GAS SANDS OR ZONES

Name	From	To	Name	From	To
1			4		
2			5		
3			6		

Perforating Record If Any

Formation	From	To	No. of Shots	Formation	From	To	Size of Shot

CASING RECORD

Amount Set				Amount Pulled				Packer Record			
Size	Wt.	Thds.	Make	Ft.	In.	Ft.	In.	Size	Length	Depth Set	Make
8-5/8				160							

Liner Record: Amount \_\_\_\_\_ Kind \_\_\_\_\_ Top \_\_\_\_\_ Bottom \_\_\_\_\_

CEMENTING AND MUDDING

Size	Amount Set		Sacks Cement	Chemical		Method of Cementing	Amount	Mudding Method	Results (See Note)
	Ft.	In.		Gal.	Make				
8-5/8	160		130						

Note: What method was used to protect sands if outer strings were pulled?

NOTE: Were bottom hole plugs used? If so, state kind, depth set and results obtained

TOOLS USED

Rotary Tools were used from \_\_\_\_\_ feet to \_\_\_\_\_ Cable tools were used from \_\_\_\_\_ feet to \_\_\_\_\_ feet, and from \_\_\_\_\_ feet to \_\_\_\_\_ feet, and from \_\_\_\_\_ feet to \_\_\_\_\_ feet to \_\_\_\_\_

Type Rig \_\_\_\_\_

INITIAL PRODUCTION TEST

Describe initial test: whether by flow through tubing or casing or by pumping \_\_\_\_\_

Amount of Oil Production \_\_\_\_\_ bbls. Size of choke, if any \_\_\_\_\_ Length of test \_\_\_\_\_ Water Production \_\_\_\_\_ bbls. Gravity of oil \_\_\_\_\_ Type of Pump if pump is used, describe \_\_\_\_\_

I, the undersigned, being first duly sworn upon oath, state that this well record is true, correct and complete according to the records of this office and to the best of my knowledge and belief.

*John O. Farmer* President  
 Name and title of representative of company

Subscribed and sworn to before me this 1st day of December, 1959

My Commission expires 10/11/62  
*Paul R. Kinsey* Notary Public

DEC 8 1959  
 CONSERVATION DIVISION  
 Wichita, Kansas

15-065-0201-00-24W 8S 27 SEC 1 COUNTY GRAHAM WELL NO. KOBLER "B" FARM NAME