

For KCC Use: 6-7-08  
 Effective Date: \_\_\_\_\_  
 District # 2  
 SGA?  Yes  No

KANSAS CORPORATION COMMISSION  
 OIL & GAS CONSERVATION DIVISION

Form C-1

October 2007

Form must be Typed  
 Form must be Signed  
 All blanks must be Filled

NOTICE OF INTENT TO DRILL

Must be approved by KCC five (5) days prior to commencing well

Expected Spud Date: 06-02-08  
 month day year

OPERATOR: License# 3372  
 Name: Dixon Energy, Inc.  
 Address 1: 8100 E. 22nd Street North, Building 300 Suite 200  
 Address 2: \_\_\_\_\_  
 City: Wichita State: KS Zip: 67226  
 Contact Person: Micheal W. Dixon  
 Phone: 316-264-9632

CONTRACTOR: License# 5123  
 Name: Pickrell Drilling

|   |   |   |
|---|---|---|
| Well Drilled For:   | Well Class:   | Type Equipment:   |
| <input checked="" type="checkbox"/> Oil <input checked="" type="checkbox"/> Gas             | <input type="checkbox"/> Enh Rec<br><input type="checkbox"/> Storage<br><input type="checkbox"/> Disposal   | <input checked="" type="checkbox"/> Mud Rotary<br><input type="checkbox"/> Air Rotary<br><input type="checkbox"/> Cable |
| <input type="checkbox"/> Seismic; # of Holes _____<br><input type="checkbox"/> Other: _____ | <input type="checkbox"/> Infield<br><input type="checkbox"/> Pool Ext.<br><input checked="" type="checkbox"/> Wildcat<br><input type="checkbox"/> Other |   |

If OWWO: old well information as follows:  
 Operator: \_\_\_\_\_  
 Well Name: \_\_\_\_\_  
 Original Completion Date: \_\_\_\_\_ Original Total Depth: \_\_\_\_\_

Directional, Deviated or Horizontal wellbore?  Yes  No  
 If Yes, true vertical depth: \_\_\_\_\_  
 Bottom Hole Location: \_\_\_\_\_  
 KCC DKT #: \_\_\_\_\_

Spot Description: \_\_\_\_\_  
NW NE SW NW Sec. 18 Twp. 30 S. R. 10  E  W  
 (a/a/a/a) 1,450 feet from  N /  S Line of Section  
980 feet from  E /  W Line of Section

Is SECTION:  Regular  Irregular?

(Note: Locate well on the Section Plat on reverse side)

County: Kingman  
 Lease Name: Roll "A" Well #: 2  
 Field Name: W.C

Is this a Prorated / Spaced Field?  Yes  No

Target Formation(s): Mississippian-Arbuckle

Nearest Lease or unit boundary line (in footage): 980'

Ground Surface Elevation: NA east 1800 feet MSL

Water well within one-quarter mile:  Yes  No

Public water supply well within one mile:  Yes  No

Depth to bottom of fresh water: 150'

Depth to bottom of usable water: 180'

Surface Pipe by Alternate:  I  II

Length of Surface Pipe Planned to be set: 250'

Length of Conductor Pipe (if any): NA

Projected Total Depth: 4900'

Formation at Total Depth: Arbuckle

Water Source for Drilling Operations:

Well  Farm Pond  Other: \_\_\_\_\_

DWR Permit #: \_\_\_\_\_

(Note: Apply for Permit with DWR)

Will Cores be taken?  Yes  No

If Yes, proposed zone: \_\_\_\_\_

AFFIDAVIT

The undersigned hereby affirms that the drilling, completion and eventual plugging of this well will comply with K.S.A. 55 et. seq.

It is agreed that the following minimum requirements will be met:

1. Notify the appropriate district office **prior** to spudding of well;
2. A copy of the approved notice of intent to drill **shall be** posted on each drilling rig;
3. The minimum amount of surface pipe as specified below **shall be set** by circulating cement to the top; in all cases surface pipe **shall be set** through all unconsolidated materials plus a minimum of 20 feet into the underlying formation.
4. If the well is dry hole, an agreement between the operator and the district office on plug length and placement is necessary **prior to plugging**;
5. The appropriate district office will be notified before well is either plugged or production casing is cemented in;
6. If an ALTERNATE II COMPLETION, production pipe shall be cemented from below any usable water to surface within **120 DAYS** of spud date. Or pursuant to Appendix "B" - Eastern Kansas surface casing order #133,891-C, which applies to the KCC District 3 area, alternate II cementing must be completed within 30 days of the spud date or the well shall be plugged. **In all cases, NOTIFY district office** prior to any cementing.

I hereby certify that the statements made herein are true and correct to the best of my knowledge and belief.

Date: 5-30-08 Signature of Operator or Agent: \_\_\_\_\_ Title: President

RECEIVED  
 KANSAS CORPORATION COMMISSION

MAY 30 2008

CONSERVATION DIVISION  
 WICHITA, KS

**For KCC Use ONLY**  
 API # 15 - 095-22151-0000  
 Conductor pipe required None feet  
 Minimum surface pipe required 200 feet per ALT.  I  II  
 Approved by: [Signature] 6-2-08  
 This authorization expires: 6-2-09  
 (This authorization void if drilling not started within 12 months of approval date.)  
 Spud date: \_\_\_\_\_ Agent: \_\_\_\_\_

Remember to:

- File Drill Pit Application (form GDP-1) with Intent to Drill;
- File Completion Form ACO-1 within 120 days of spud date;
- File acreage attribution plat according to field proration orders;
- Notify appropriate district office 48 hours prior to workover or re-entry;
- Submit plugging report (CP-4) after plugging is completed (within 60 days);
- Obtain written approval before disposing or injecting salt water.
- If this permit has expired (See: authorized expiration date) please check the box below and return to the address below.

Well Not Drilled - Permit Expired Date: \_\_\_\_\_  
 Signature of Operator or Agent: \_\_\_\_\_

18  
30  
10  
 E  
 W

**IN ALL CASES PLOT THE INTENDED WELL ON THE PLAT BELOW**

*Plat of acreage attributable to a well in a prorated or spaced field*

**If the intended well is in a prorated or spaced field, please fully complete this side of the form.** If the intended well is in a prorated or spaced field complete the plat below showing that the well will be properly located in relationship to other wells producing from the common source of supply. Please show all the wells and within 1 mile of the boundaries of the proposed acreage attribution unit for gas wells and within 1/2 mile of the boundaries of the proposed acreage attribution unit for oil wells.

API No. 15 - 095-22151-0000  
 Operator: Dixon Energy, Inc.  
 Lease: Rolf "A"  
 Well Number: 2  
 Field: W.C

Number of Acres attributable to well: \_\_\_\_\_  
 QTR/QTR/QTR/QTR of acreage: \_\_\_\_\_ - \_\_\_\_\_ - \_\_\_\_\_ - \_\_\_\_\_

Location of Well: County: Kingman  
 \_\_\_\_\_ feet from  N /  S Line of Section  
 \_\_\_\_\_ feet from  E /  W Line of Section  
 Sec. 18 Twp. 30 S. R. 10  E  W

Is Section:  Regular or  Irregular

**If Section is Irregular, locate well from nearest corner boundary.**

Section corner used:  NE  NW  SE  SW

**PLAT**

*(Show location of the well and shade attributable acreage for prorated or spaced wells.)*

*(Show footage to the nearest lease or unit boundary line.)*

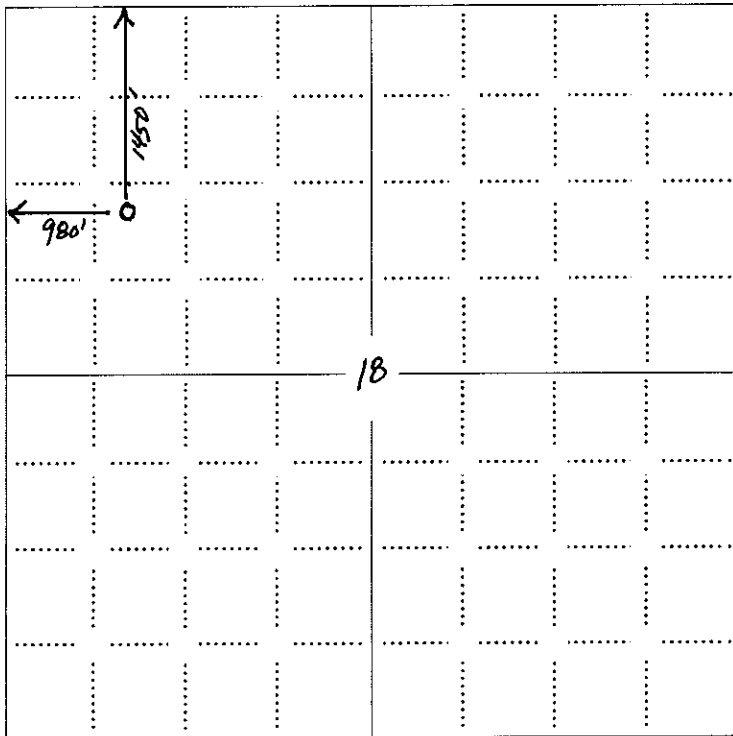

RECEIVED  
 KANSAS CORPORATION COMMISSION  
**MAY 30 2008**  
 CONSERVATION DIVISION  
 WICHITA, KS

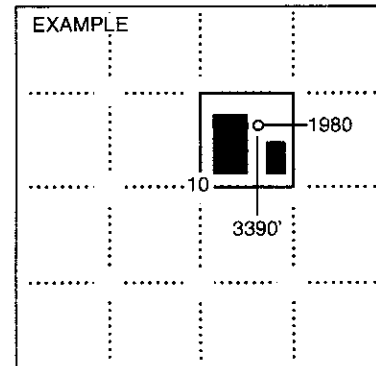

**NOTE: In all cases locate the spot of the proposed drilling location.**

**In plotting the proposed location of the well, you must show:**

1. The manner in which you are using the depicted plat by identifying section lines, i.e. 1 section, 1 section with 8 surrounding sections, 4 sections, etc.
2. The distance of the proposed drilling location from the south / north and east / west outside section lines.
3. The distance to the nearest lease or unit boundary line (in footage).
4. If proposed location is located within a prorated or spaced field a certificate of acreage attribution plat must be attached: (CO-7 for oil wells; CG-8 for gas wells).

**KANSAS CORPORATION COMMISSION  
OIL & GAS CONSERVATION DIVISION  
APPLICATION FOR SURFACE PIT**

Form CDP-1  
April 2004  
Form must be Typed

*Submit in Duplicate*

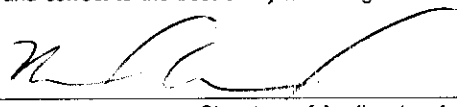
|  |  |  |
|--|--|--|
| Operator Name: <b>Dixon Energy, Inc.</b>   |  | License Number: <b>3372</b>  |
| Operator Address: <b>8100 E. 22nd Street North, Building 300 Suite 200</b>   |  | <b>Wichita KS 67226</b>  |
| Contact Person: <b>Micheal W. Dixon</b>  |  | Phone Number: <b>316-264-9632</b>  |
| Lease Name & Well No.: <b>Rolf "A" 2</b>   |  | Pit Location (QQQQ):<br><b>NW NE SW NW</b>   |
| Type of Pit:<br><input type="checkbox"/> Emergency Pit <input type="checkbox"/> Burn Pit<br><input type="checkbox"/> Settling Pit <input checked="" type="checkbox"/> Drilling Pit<br><input type="checkbox"/> Workover Pit <input type="checkbox"/> Haul-Off Pit<br><small>(If WP Supply API No. or Year Drilled)</small> | Pit is:<br><input type="checkbox"/> Proposed <input type="checkbox"/> Existing<br>If Existing, date constructed: _____<br>Pit capacity: _____ (bbls) | Sec. <u>18</u> Twp. <u>30</u> R. <u>10</u> <input type="checkbox"/> East <input checked="" type="checkbox"/> West<br><u>1,450</u> Feet from <input checked="" type="checkbox"/> North / <input type="checkbox"/> South Line of Section<br><u>980</u> Feet from <input type="checkbox"/> East / <input checked="" type="checkbox"/> West Line of Section<br><b>Kingman</b> County |
| Is the pit located in a Sensitive Ground Water Area? <input checked="" type="checkbox"/> Yes <input type="checkbox"/> No   |  | Chloride concentration: _____ mg/l<br><small>(For Emergency Pits and Settling Pits only)</small>   |
| Is the bottom below ground level?<br><input checked="" type="checkbox"/> Yes <input type="checkbox"/> No   | Artificial Liner?<br><input type="checkbox"/> Yes <input checked="" type="checkbox"/> No   | How is the pit lined if a plastic liner is not used?   |
| Pit dimensions (all but working pits): <u>50</u> Length (feet) <u>50</u> Width (feet) <input type="checkbox"/> N/A: Steel Pits<br>Depth from ground level to deepest point: <u>5</u> (feet) <input type="checkbox"/> No Pit  |  |  |
| If the pit is lined give a brief description of the liner material, thickness and installation procedure.  |  | Describe procedures for periodic maintenance and determining liner integrity, including any special monitoring.  |
| Distance to nearest water well within one-mile of pit<br><u>1150</u> feet    Depth of water well <u>100</u> feet   |  | Depth to shallowest fresh water <u>80</u> feet.<br>Source of information:<br><input checked="" type="checkbox"/> measured <input type="checkbox"/> well owner <input type="checkbox"/> electric log <input type="checkbox"/> KDWR  |
| <b>Emergency, Settling and Burn Pits ONLY:</b><br>Producing Formation: _____<br>Number of producing wells on lease: _____<br>Barrels of fluid produced daily: _____<br>Does the slope from the tank battery allow all spilled fluids to flow into the pit? <input type="checkbox"/> Yes <input type="checkbox"/> No        |  | <b>Drilling, Workover and Haul-Off Pits ONLY:</b><br>Type of material utilized in drilling/workover: <u>Drilling Mud</u><br>Number of working pits to be utilized: <u>2</u><br>Abandonment procedure: <u>Let dry and backfill</u><br>Drill pits must be closed within 365 days of spud date.   |
| I hereby certify that the above statements are true and correct to the best of my knowledge and belief.  |  | <b>RECEIVED</b><br>KANSAS CORPORATION COMMISSION   |
| <u>5-30-08</u><br>Date   | <br>Signature of Applicant or Agent                              | <b>MAY 30 2008</b><br>CONSERVATION DIVISION<br>WICHITA, KS   |
| <b>KCC OFFICE USE ONLY</b>   |  |  |
| Date Received: <u>5/30/08</u> Permit Number: _____   |  | Steel Pit <input type="checkbox"/> RFAC <input type="checkbox"/> RFAS <input checked="" type="checkbox"/>  |
| Permit Date: <u>6/2/08</u> Lease Inspection: <input checked="" type="checkbox"/> Yes <input type="checkbox"/> No   |  |  |

15-095-22151-0000



Kathleen Sebelius, Governor  
Brian J. Moline, Chair  
Michael C. Moffet, Commissioner  
Robert E. Krehbiel, Commissioner

June 2, 2008

Mr. Michael W. Dixon  
Dixon Energy, Inc.  
8100 E 22<sup>nd</sup> St North Bldg 300 Ste 200  
Wichita, KS 67226

Re: Drilling Pit Application  
Rolf A Well No. 2  
NW/4 Sec. 18-30S-10W  
Kingman County, Kansas

Dear Mr. Dixon:

District staff has inspected the above referenced location and has determined that the reserve pit shall be constructed **without slots**, the bottom shall be flat and reasonably level, and **all pits must be lined with bentonite**. The free fluids must be removed. The fluids are to be removed from the reserve pit as soon as the Hutchinson Salt section has been drilled through and displacement of the fluids into the reserve pit has occurred. The fluids should be removed again within 72 hours after drilling operations have ceased.

**If production casing is set all completion fluids shall be removed from the working pits daily. NO completion fluids or non-exempt wastes shall be placed in the reserve pit.**

The fluids should be taken to an authorized disposal well. Please call the District Office at (316) 630-4000 when the fluids have been removed. Please file form CDP-5 (August 2004), Exploration and Production Waste Transfer, within 30 days of fluid removal. Conservation division forms are available through our office and on the KCC web site: [www.kcc.state.ks.us/conservation/forms](http://www.kcc.state.ks.us/conservation/forms).

**A copy of this letter should be posted in the doghouse along with the approved Intent to Drill.** If you have any questions or concerns please feel free to contact the undersigned at the above address.

Sincerely,

Kathy Haynes  
Environmental Protection and Remediation Department

cc: File