

For KCC Use:
Effective Date: 6-17-08
District # _____
SGA? Yes No

KANSAS CORPORATION COMMISSION
OIL & GAS CONSERVATION DIVISION

Form C-1
October 2007
Form must be Typed
Form must be Signed
All blanks must be Filled

NOTICE OF INTENT TO DRILL

Must be approved by KCC five (5) days prior to commencing well

Expected Spud Date: June 20 2008
month day year

OPERATOR: License# 33989
Name: Bengalla Land and Cattle Company
Address 1: 427 South Boston, Suite 1046
Address 2: _____
City: Tulsa State: OK Zip: 74103 + 4 1 1 5
Contact Person: Jennifer Sexton
Phone: (918) 587-8022
CONTRACTOR: License# 33784
Name: Trinidad Drilling Limited Partnership

Well Drilled For:	Well Class:	Type Equipment:
<input type="checkbox"/> Oil	<input type="checkbox"/> Enh Rec	<input checked="" type="checkbox"/> Mud Rotary
<input checked="" type="checkbox"/> Gas	<input type="checkbox"/> Storage	<input type="checkbox"/> Air Rotary
<input type="checkbox"/> Seismic ; _____ # of Holes	<input type="checkbox"/> Disposal	<input type="checkbox"/> Cable
<input type="checkbox"/> Other: _____	<input checked="" type="checkbox"/> Infield	
	<input type="checkbox"/> Pool Ext.	
	<input type="checkbox"/> Wildcat	
	<input type="checkbox"/> Other	

If OWWO: old well information as follows:
Operator: _____
Well Name: _____
Original Completion Date: _____ Original Total Depth: _____

Directional, Deviated or Horizontal wellbore? Yes No
If Yes, true vertical depth: _____
Bottom Hole Location: _____
KCC DKT #: _____

Spot Description: _____
_____ C - NW Sec. 8 Twp. 25 S. R. 30 E W
(20/0/0) 1,320 feet from N / S Line of Section
1,320 feet from E / W Line of Section
Is SECTION: Regular Irregular?

(Note: Locate well on the Section Plat on reverse side)

County: Gray
Lease Name: Sandra Well #: 1-8
Field Name: _____

Is this a Prorated / Spaced Field? Yes No

Target Formation(s): Council Grove
Nearest Lease or unit boundary line (in footage): 660'

Ground Surface Elevation: 2863 feet MSL

Water well within one-quarter mile: Yes No

Public water supply well within one mile: Yes No

Depth to bottom of fresh water: 320'

Depth to bottom of usable water: 1050'

Surface Pipe by Alternate: I II

Length of Surface Pipe Planned to be set: 600'

Length of Conductor Pipe (if any): None

Projected Total Depth: 3100'

Formation at Total Depth: Council Grove

Water Source for Drilling Operations:
 Well Farm Pond Other: water to be hauled

DWR Permit #: _____
(Note: Apply for Permit with DWR)

Will Cores be taken? Yes No

If Yes, proposed zone: _____

AFFIDAVIT

RECEIVED
KANSAS CORPORATION COMMISSION

The undersigned hereby affirms that the drilling, completion and eventual plugging of this well will comply with K.S.A. 55 et. seq.

It is agreed that the following minimum requirements will be met:

1. Notify the appropriate district office **prior** to spudding of well;
2. A copy of the approved notice of intent to drill **shall be** posted on each drilling rig;
3. The minimum amount of surface pipe as specified below **shall be set** by circulating cement to the top; in all cases surface pipe **shall be set** within 20 feet into the underlying formation.
4. If the well is dry hole, an agreement between the operator and the district office on plug length and placement is necessary **prior to plugging**;
5. The appropriate district office will be notified before well is either plugged or production casing is cemented in;
6. If an ALTERNATE II COMPLETION, production pipe shall be cemented from below any **usable** water to surface within **120 DAYS** of spud date.
Or pursuant to Appendix "B" - Eastern Kansas surface casing order #133,891-C, which applies to the KCC District 3 area, alternate II cementing must be completed within 30 days of the spud date or the well shall be plugged. **In all cases, NOTIFY district office** prior to any cementing.

I hereby certify that the statements made herein are true and correct to the best of my knowledge and belief.

Date: 06/06/08 Signature of Operator or Agent: Jennifer Sexton Title: VP Operations

For KCC Use ONLY
API # 15 - 069-20306-0000
Conductor pipe required None feet
Minimum surface pipe required 340 feet per ALT. I II
Approved by: [Signature] 6-12-08
This authorization expires: 6-12-09
(This authorization void if drilling not started within 12 months of approval date.)
Spud date: _____ Agent: _____

Remember to:

- File Drill Pit Application (form CDP-1) with Intent to Drill;
- File Completion Form ACO-1 within 120 days of spud date;
- File acreage attribution plat according to field proration orders;
- Notify appropriate district office 48 hours prior to workover or re-entry;
- Submit plugging report (CP-4) after plugging is completed (within 60 days);
- Obtain written approval before disposing or injecting salt water.
- If this permit has expired (See: authorized expiration date) please check the box below and return to the address below.

Well Not Drilled - Permit Expired Date: _____
Signature of Operator or Agent: _____

8
25
30
 E
 W

IN ALL CASES PLOT THE INTENDED WELL ON THE PLAT BELOW

Plat of acreage attributable to a well in a prorated or spaced field

If the intended well is in a prorated or spaced field, please fully complete this side of the form. If the intended well is in a prorated or spaced field complete the plat below showing that the well will be properly located in relationship to other wells producing from the common source of supply. Please show all the wells and within 1 mile of the boundaries of the proposed acreage attribution unit for gas wells and within 1/2 mile of the boundaries of the proposed acreage attribution unit for oil wells.

API No. 15 - 069-20306-0000
 Operator: Bengalia Land and Cattle Company
 Lease: Saundra
 Well Number: 1-8
 Field: _____
 Number of Acres attributable to well: _____
 QTR/QTR/QTR/QTR of acreage: _____ - _____ - C - NW

Location of Well: County: Gray
 _____ feet from N / S Line of Section
 _____ feet from E / W Line of Section
 Sec. 8 Twp. 25 S. R. 30 E W

Is Section: Regular or Irregular

If Section is Irregular, locate well from nearest corner boundary.

Section corner used: NE NW SE SW

PLAT

*(Show location of the well and shade attributable acreage for prorated or spaced wells.)
 (Show footage to the nearest lease or unit boundary line.)*

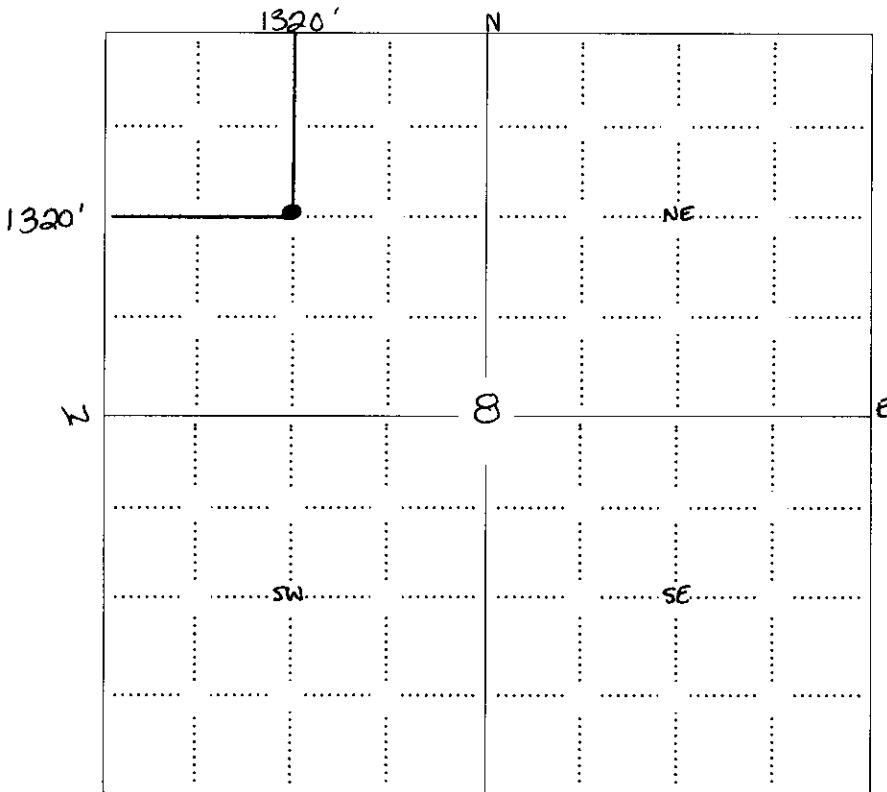

NOTE: In all cases locate the spot of the proposed drilling locaton.

RECEIVED
 KANSAS CORPORATION COMMISSION
 JUN 10 2008
 CONSERVATION DIVISION
 WICHITA, KS

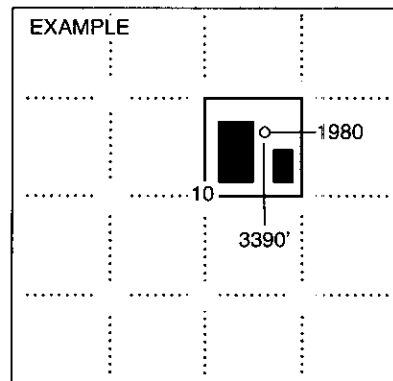

SEWARD CO.

In plotting the proposed location of the well, you must show:

1. The manner in which you are using the depicted plat by identifying section lines, i.e. 1 section, 1 section with 8 surrounding sections, 4 sections, etc.
2. The distance of the proposed drilling location from the south / north and east / west outside section lines.
3. The distance to the nearest lease or unit boundary line (in footage).
4. If proposed location is located within a prorated or spaced field a certificate of acreage attribution plat must be attached: (C0-7 for oil wells; CG-8 for gas wells).

15709-20306-0000

24S-31W

24S-30W

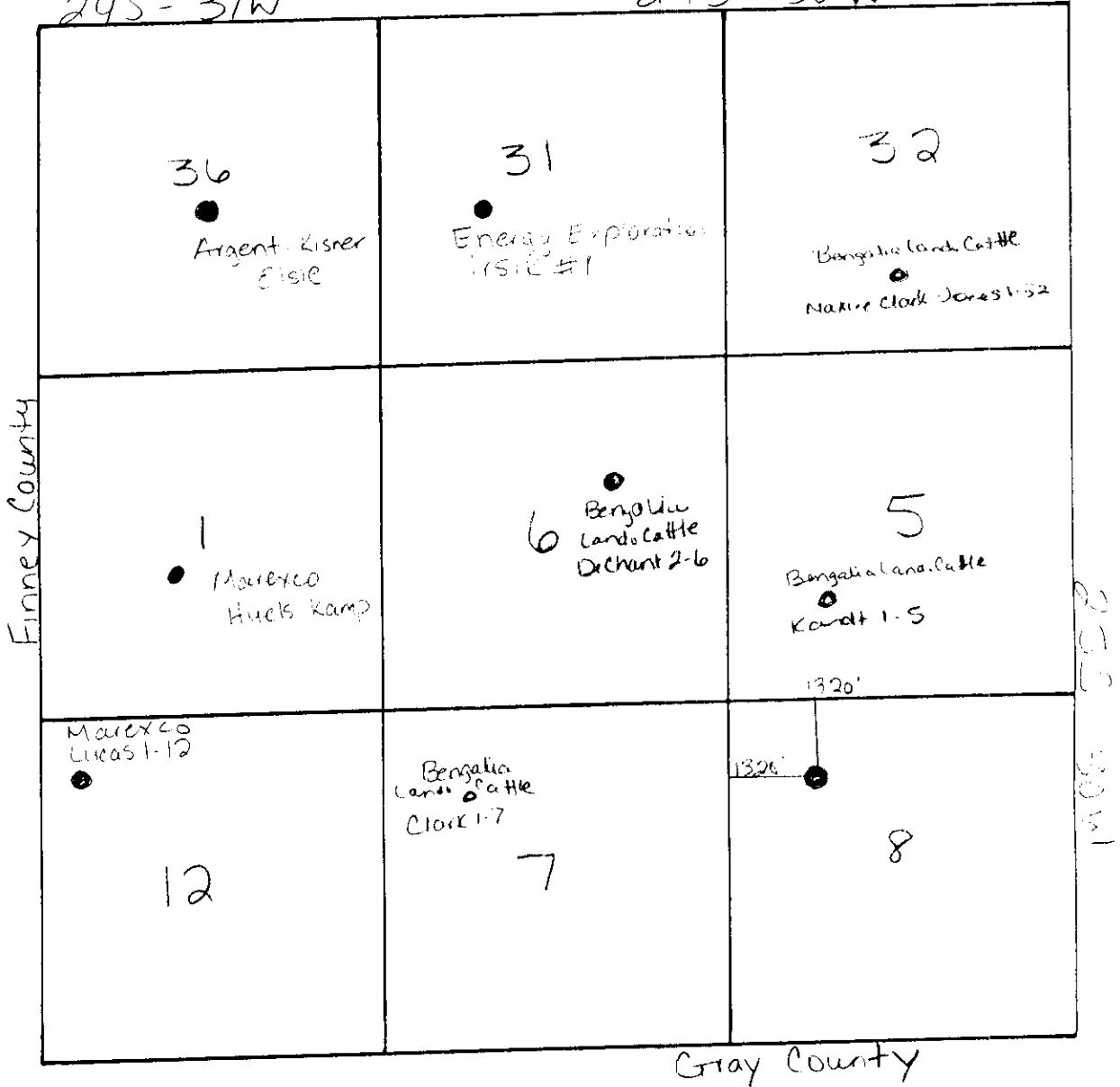

Saundra #1-8

RECEIVED
KANSAS CORPORATION COMMISSION

JUN 10 2008

CONSERVATION DIVISION
WICHITA, KS

**KANSAS CORPORATION COMMISSION
OIL & GAS CONSERVATION DIVISION
APPLICATION FOR SURFACE PIT**

Form CDP-1
April 2004
Form must be Typed

Submit in Duplicate

Operator Name: Bengalia Land and Cattle Company		License Number: 33989
Operator Address: 427 South Boston, Suite 1046		
Contact Person: Jennifer Sexton		Phone Number: (918) 587-8022
Lease Name & Well No.: Saundra # 1-8		Pit Location (QQQQ): C NW
Type of Pit: <input type="checkbox"/> Emergency Pit <input type="checkbox"/> Burn Pit <input type="checkbox"/> Settling Pit <input checked="" type="checkbox"/> Drilling Pit <input type="checkbox"/> Workover Pit <input type="checkbox"/> Haul-Off Pit <small>(If WP Supply API No. or Year Drilled)</small>		Pit is: <input checked="" type="checkbox"/> Proposed <input type="checkbox"/> Existing If Existing, date constructed: _____ Pit capacity: 23,000 (bbls)
Is the pit located in a Sensitive Ground Water Area? <input checked="" type="checkbox"/> Yes <input type="checkbox"/> No		Chloride concentration: _____ mg/l <small>(For Emergency Pits and Settling Pits only)</small>
Is the bottom below ground level? <input checked="" type="checkbox"/> Yes <input type="checkbox"/> No	Artificial Liner? <input type="checkbox"/> Yes <input checked="" type="checkbox"/> No	How is the pit lined if a plastic liner is not used?
Pit dimensions (all but working pits): <u>150</u> Length (feet) <u>150</u> Width (feet) <input type="checkbox"/> N/A: Steel Pits Depth from ground level to deepest point: <u>8</u> (feet) <input type="checkbox"/> No Pit		
If the pit is lined give a brief description of the liner material, thickness and installation procedure.		Describe procedures for periodic maintenance and determining liner integrity, including any special monitoring.
Distance to nearest water well within one-mile of pit <u>463</u> feet Depth of water well <u>285</u> feet		Depth to shallowest fresh water <u>160 143</u> feet. Source of information: <input type="checkbox"/> measured <input type="checkbox"/> well owner <input type="checkbox"/> electric log <input checked="" type="checkbox"/> KDWR
Emergency, Settling and Burn Pits ONLY: Producing Formation: _____ Number of producing wells on lease: _____ Barrels of fluid produced daily: _____ Does the slope from the tank battery allow all spilled fluids to flow into the pit? <input type="checkbox"/> Yes <input type="checkbox"/> No		Drilling, Workover and Haul-Off Pits ONLY: Type of material utilized in drilling/workover: <u>Mud</u> Number of working pits to be utilized: <u>1</u> Abandonment procedure: <u>Dewater, evaporate, close</u> Drill pits must be closed within 365 days of spud date.
I hereby certify that the above statements are true and correct to the best of my knowledge and belief.		RECEIVED KANSAS CORPORATION COMMISSION JUN 10 2008 CONSERVATION DIVISION WICHITA, KS
Date: <u>6.9.08</u>		Signature of Applicant or Agent: <u>Jennifer Sexton</u>
KCC OFFICE USE ONLY		
Date Received: <u>6/10/08</u> Permit Number: _____ Permit Date: <u>6/11/08</u> Lease Inspection: <input checked="" type="checkbox"/> Yes <input type="checkbox"/> No		Steel Pit <input type="checkbox"/> RFAC <input checked="" type="checkbox"/> RFAS <input checked="" type="checkbox"/>

15-069-203060000

Mail to: KCC - Conservation Division, 130 S. Market - Room 2078, Wichita, Kansas 67202



Kathleen Sebelius, Governor
Thomas E. Wright, Chairman
Michael C. Moffet, Commissioner
Joseph F. Harkins, Commissioner

June 11, 2008

Ms. Jennifer Sexton
Bengalia Land and Cattle Co.
427 So. Boston Ste 1046
Tulsa, OK 74103-4115

RE: Drilling Pit Application
Saundra Lease Well No. 1-8
NW/4 Sec. 08-25S-30W
Gray County, Kansas

Dear Ms. Sexton:

District staff has inspected the above referenced location and has determined that the reserve pit shall be constructed **without slots**, the bottom shall be flat and reasonably level, and **lined with bentonite or native clay**. The free fluids must be removed. The fluids are to be removed from the reserve pit as soon as the Hutchinson Salt section has been drilled through and displacement of the fluids into the reserve pit has occurred. The fluids should be removed again as soon as practical after drilling operations have ceased.

If production casing is set all completion fluids shall be removed from the working pits daily. NO completion fluids or non-exempt wastes shall be placed in the reserve pit.

The fluids should be taken to an authorized disposal well. Please call the District Office at (620) 225-8888 when the fluids have been removed. Please file form CDP-5, Exploration and Production Waste Transfer, within 30 days of fluid removal. Conservation division forms are available through our office and on the KCC web site: www.kcc.state.ks.us/conservation/forms.

A copy of this letter should be posted in the doghouse along with the approved Intent to Drill.

If you have any questions or concerns please feel free to contact the undersigned at the above address.

Sincerely,

Kathy Haynes
Environmental Protection and Remediation Department

Cc: File