

For KCC Use: 6-2108  
 Effective Date: \_\_\_\_\_  
 District #: 4  
 SGA?  Yes  No

KANSAS CORPORATION COMMISSION  
 OIL & GAS CONSERVATION DIVISION

Form C-1  
 October 2007  
 Form must be Typed  
 Form must be Signed  
 All blanks must be Filled

NOTICE OF INTENT TO DRILL

Must be approved by KCC five (5) days prior to commencing well

Expected Spud Date: June 26 2008  
month day year

OPERATOR: License# 33269  
 Name: Central Operating, Inc  
 Address 1: 1600 Broadway Suite 1050  
 Address 2: \_\_\_\_\_  
 City: Denver State: Co Zip: 80202  
 Contact Person: P.A. Brew  
 Phone: 303-894-9578  
 CONTRACTOR: License# 30606  
 Name: Murfin Drilling Co

Well Drilled For:  Oil  Gas  Seismic; # of Holes \_\_\_\_\_  
 Enh Rec  Storage  Disposal  
 Other: \_\_\_\_\_  
 Well Class:  Infield  Pool Ext.  Wildcat  Other  
 Type Equipment:  Mud Rotary  Air Rotary  Cable

If OWWO: old well information as follows:  
 Operator: \_\_\_\_\_  
 Well Name: \_\_\_\_\_  
 Original Completion Date: \_\_\_\_\_ Original Total Depth: \_\_\_\_\_

Directional, Deviated or Horizontal wellbore?  Yes  No  
 If Yes, true vertical depth: \_\_\_\_\_  
 Bottom Hole Location: \_\_\_\_\_  
 KCC DKT #: \_\_\_\_\_

Spot Description: NEW  
 SW - SE - NW - NE Sec. 15 Twp. 5 S. R. 29  E  W  
1,210 feet from  N /  S Line of Section  
1,843 feet from  E /  W Line of Section

Is SECTION:  Regular  Irregular?  
 (Note: Locate well on the Section Plat on reverse side)  
 County: Decatur  
 Lease Name: Vaughn Well #: 14-15  
 Field Name: Prairie Dog East  
 Is this a Prorated / Spaced Field?  Yes  No  
 Target Formation(s): Lansing - Kansas City

\* Nearest Lease or unit boundary line (in footage): 110  
 Ground Surface Elevation: 2760 feet MSL  
 Water well within one-quarter mile:  Yes  No  
 Public water supply well within one mile:  Yes  No  
 Depth to bottom of fresh water: 150  
 Depth to bottom of usable water: 150-150  
 Surface Pipe by Alternate:  1  2  
 Length of Surface Pipe Planned to be set: 170 200' minimum  
 Length of Conductor Pipe (if any): \_\_\_\_\_  
 Projected Total Depth: 4500'  
 Formation at Total Depth: Kansas City

Water Source for Drilling Operations:  
 Well  Farm Pond  Other:  
 DWR Permit #: \_\_\_\_\_  
 (Note: Apply for Permit with DWR)   
 Will Cores be taken?  Yes  No  
 If Yes, proposed zone: \_\_\_\_\_

\* Declaration of pooling attached.

AFFIDAVIT

The undersigned hereby affirms that the drilling, completion and eventual plugging of this well will comply with K.S.A. 55 et. seq.  
 It is agreed that the following minimum requirements will be met:

1. Notify the appropriate district office *prior* to spudding of well;
2. A copy of the approved notice of intent to drill *shall be* posted on each drilling rig;
3. The minimum amount of surface pipe as specified below *shall be set* by circulating cement to the top; in all cases surface pipe *shall be set* through all unconsolidated materials plus a minimum of 20 feet into the underlying formation;
4. If the well is dry hole, an agreement between the operator and the district office on plug length and placement is necessary *prior to plugging*;
5. The appropriate district office will be notified before well is either plugged or production casing is cemented in;
6. If an ALTERNATE II COMPLETION, production pipe shall be cemented from below any usable water to surface within **120 DAYS** of spud date. Or pursuant to Appendix "B" - Eastern Kansas surface casing order #133,891-C, which applies to the KCC District 3 area, alternate II cementing must be completed within 30 days of the spud date or the well shall be plugged. *In all cases, NOTIFY district office prior to any cementing.*

I hereby certify that the statements made herein are true and correct to the best of my knowledge and belief.

Date: June 12/08 Signature of Operator or Agent: P.A. Brew Title: President

For KCC Use ONLY  
 API # 15 - 039-21056-0000  
 Conductor pipe required None feet  
 Minimum surface pipe required 200 feet per ALT.    
 Approved by: P.A. Brew 6-16-08  
 This authorization expires: 6-16-09  
 (This authorization void if drilling not started within 12 months of approval date.)  
 Spud date: \_\_\_\_\_ Agent: \_\_\_\_\_

Remember to:

- File Drill Pit Application (form CDP-1) with Intent to Drill;
- File Completion Form ACO-1 within 120 days of spud date;
- File acreage attribution plat according to field proration orders;
- Notify appropriate district office 48 hours prior to workover or re-entry;
- Submit plugging report (CP-4) after plugging is completed (within 60 days);
- Obtain written approval before disposing or injecting salt water.
- If this permit has expired (See: authorized expiration date) please check the box below and return to the address below.

Well Not Drilled - Permit Expired Date: \_\_\_\_\_  
 Signature of Operator or Agent: \_\_\_\_\_

15  
5  
29

Mail to: KCC - Conservation Division, 130 S. Market - Room 2078, Wichita, Kansas 67202

RECEIVED  
 KANSAS CORPORATION COMMISSION

JUN 13 2008

CONSERVATION DIVISION  
 WICHITA, KS

**IN ALL CASES PLOT THE INTENDED WELL ON THE PLAT BELOW**

*Plat of acreage attributable to a well in a prorated or spaced field*

*If the intended well is in a prorated or spaced field, please fully complete this side of the form. If the intended well is in a prorated or spaced field complete the plat below showing that the well will be properly located in relationship to other wells producing from the common source of supply. Please show all the wells and within 1 mile of the boundaries of the proposed acreage attribution unit for gas wells and within 1/2 mile of the boundaries of the proposed acreage attribution unit for oil wells.*

API No. 15 - 039-21056-0000  
 Operator: Central Operating, Inc  
 Lease: Vaughn  
 Well Number: 14-15  
 Field: Prairie Dog East  
 Number of Acres attributable to well: 10  
 QTR/QTR/QTR/QTR of acreage: SW - SE - NW - NE

Location of Well: County: Decatur  
 1,210 feet from  N /  S Line of Section  
 1,843 feet from  E /  W Line of Section  
 Sec. 15 Twp. 5 S. R. 29  E  W

Is Section:  Regular or  Irregular

If Section is Irregular, locate well from nearest corner boundary.

Section corner used:  NE  NW  SE  SW

**PLAT**

*(Show location of the well and shade attributable acreage for prorated or spaced wells.)  
 (Show footage to the nearest lease or unit boundary line.)*

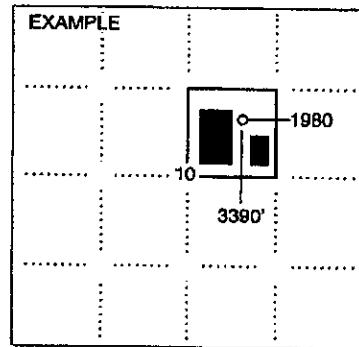
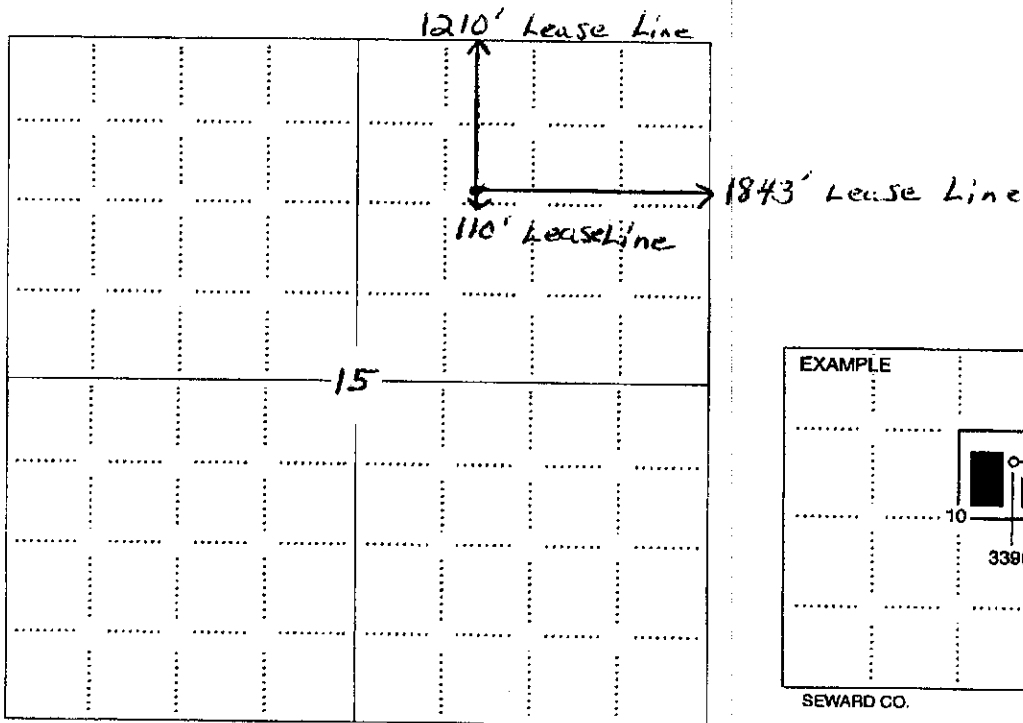

**NOTE:** In all cases locate the spot of the proposed drilling location.

**In plotting the proposed location of the well, you must show:**

1. The manner in which you are using the depicted plat by identifying section lines, i.e. 1 section, 4 sections, etc.
2. The distance of the proposed drilling location from the south / north and east / west outside section lines.
3. The distance to the nearest lease or unit boundary line (in footage).
4. If proposed location is located within a prorated or spaced field a certificate of acreage attribution plat must be attached: (CO-7 for oil wells; CG-8 for gas wells).

SEWARD CO.

RECEIVED  
 KANSAS CORPORATION COMMISSION

JUN 13 2008

CONSERVATION DIVISION  
 WICHITA, KS

**KANSAS CORPORATION COMMISSION  
OIL & GAS CONSERVATION DIVISION  
APPLICATION FOR SURFACE PIT**

Form CDP-1  
April 2004  
Form must be Typed

*Submit In Duplicate*

|   |   |   |  |
|---|---|---|--|
| Operator Name: <b>Central Operating, Inc</b>  |   | License Number: <b>33269</b>  |  |
| Operator Address: <b>1600 Broadway Suite 1050</b>   |   | <b>Denver Co 80202</b>  |  |
| Contact Person: <b>P.A. Brew</b>  |   | Phone Number: <b>303-894-9576</b>   |  |
| Lease Name & Well No.: <b>Vaughn 14-15</b>  |   | Pit Location (QQQQ):<br><b>SW SE NW NE</b>  |  |
| Type of Pit:<br><input type="checkbox"/> Emergency Pit <input type="checkbox"/> Burn Pit<br><input type="checkbox"/> Settling Pit <input checked="" type="checkbox"/> Drilling Pit<br><input type="checkbox"/> Workover Pit <input type="checkbox"/> Haul-Off Pit<br><i>(If WOP Supply API No. or Year Drilled)</i> |   | Pit is:<br><input checked="" type="checkbox"/> Proposed <input type="checkbox"/> Existing<br>If Existing, date constructed: _____<br>Pit capacity: _____ (bbls)   |  |
|   |   | Sec. <u>15</u> Twp. <u>5</u> R. <u>29</u> <input type="checkbox"/> East <input checked="" type="checkbox"/> West<br><u>1,210</u> Feet from <input checked="" type="checkbox"/> North / <input type="checkbox"/> South Line of Section<br><u>1,843</u> Feet from <input checked="" type="checkbox"/> East / <input type="checkbox"/> West Line of Section<br><b>Decatur</b> County |  |
| Is the pit located in a Sensitive Ground Water Area? <input type="checkbox"/> Yes <input checked="" type="checkbox"/> No  |   | Chloride concentration: _____ mg/l<br><i>(For Emergency Pits and Settling Pits only)</i>  |  |
| Is the bottom below ground level? <input checked="" type="checkbox"/> Yes <input type="checkbox"/> No   |   | Artificial Liner? <input type="checkbox"/> Yes <input checked="" type="checkbox"/> No   |  |
|   |   | How is the pit lined if a plastic liner is not used?<br><b>Lined with clay soil, Native and fresh mud</b>   |  |
| Pit dimensions (all but working pits): <u>100</u> Length (feet) <u>100</u> Width (feet) <input type="checkbox"/> N/A: Steel Pits<br>Depth from ground level to deepest point: <u>4</u> (feet) <input type="checkbox"/> No Pit   |   |   |  |
| If the pit is lined give a brief description of the liner material, thickness and installation procedure.   |   | Describe procedures for periodic maintenance and determining liner integrity, including any special monitoring.   |  |
| Distance to nearest water well within one-mile of pit<br><u>4445</u> feet    Depth of water well <u>98</u> feet   |   | Depth to shallowest fresh water <u>55</u> feet.<br>Source of information:<br><input type="checkbox"/> measured <input type="checkbox"/> well owner <input type="checkbox"/> electric log <input checked="" type="checkbox"/> KDWR   |  |
| <b>Emergency, Settling and Burn Pits ONLY:</b><br>Producing Formation: _____<br>Number of producing wells on lease: _____<br>Barrels of fluid produced daily: _____<br>Does the slope from the tank battery allow all spilled fluids to flow into the pit? <input type="checkbox"/> Yes <input type="checkbox"/> No |   | <b>Drilling, Workover and Haul-Off Pits ONLY:</b><br>Type of material utilized in drilling/workover: <u>Fresh Mud</u><br>Number of working pits to be utilized: <u>4</u><br>Abandonment procedure: <u>Allow pits to evaporate until dry and backfill when conditions allow</u><br>Drill pits must be closed within 365 days of spud date.   |  |
| I hereby certify that the above statements are true and correct to the best of my knowledge and belief.   |   | RECEIVED<br>KANSAS CORPORATION COMMISSION   |  |
| <u>June 12/08</u><br>Date   | <u>P.A. Brew</u><br>Signature of Applicant or Agent | <b>JUN 13 2008</b>  |  |
| <b>KCC OFFICE USE ONLY</b>  |   |   |  |
| Date Received: <u>6/13/08</u> Permit Number: _____  |   | Permit Date: <u>6/16/08</u> Lease Inspection: <input type="checkbox"/> Yes <input checked="" type="checkbox"/> No   |  |
| Steel Pit <input type="checkbox"/> RFAC <input type="checkbox"/> RFAS <input type="checkbox"/> ✓ DIST   |   |   |  |

15039-810560000

Mail to: KCC - Conservation Division, 130 S. Market - Room 2078, Wichita, Kansas 67202