

For KCC Use:
Effective Date: 4-22-08
District # 4
SGA? Yes No

KANSAS CORPORATION COMMISSION
OIL & GAS CONSERVATION DIVISION

Form C-1
October 2007
Form must be Typed
Form must be Signed
All blanks must be Filled

NOTICE OF INTENT TO DRILL

Must be approved by KCC five (5) days prior to commencing well

Expected Spud Date: July 15th 2008
month day year

OPERATOR: License# 6009
Name: Double Eagle Exploration, Inc.
Address 1: 221 S. Broadway, #310
Address 2:
City: Wichita State: KS Zip: 67202
Contact Person: Jim Robinson
Phone: 316-264-0422
CONTRACTOR: License# 33493
Name: American Eagle Drilling, LLC

Spot Description: ~~Hlad B#1~~
N/2 SE SE Sec. 17 Twp. 14 S. R. 12 E W
990 feet from N / S Line of Section
660 feet from E / W Line of Section
Is SECTION: Regular Irregular?

Well Drilled For: Oil Gas Seismic Other
Well Class: Enh Rec Storage Disposal # of Holes Other
Type Equipment: Mud Rotary Air Rotary Cable
 If OWWO: old well information as follows:

(Note: Locate well on the Section Plat on reverse side)
County: Russell
Lease Name: Hlad Well #: B#1
Field Name: Mahoney
Is this a Prorated / Spaced Field? Yes No
Target Formation(s): Lansing/KC
Nearest Lease or Unit boundary line (in footage): 660'
Ground Surface Elevation: 1762 feet MSL
Water well within one-quarter mile: Yes No
Public water supply well within one mile: Yes No
Depth to bottom of fresh water: 180
Depth to bottom of usable water: 300
Surface Pipe by Alternate: I II
Length of Surface Pipe Planned to be set: 360
Length of Conductor Pipe (if any):
Projected Total Depth: 3700
Formation at Total Depth: Arbuckle
Water Source for Drilling Operations:
 Well Farm Pond Other:
DWR Permit #: (Note: Apply for Permit with DWR
Will Cores be taken? Yes No
If Yes, proposed zone

Operator:
Well Name:
Original Completion Date: Original Total Depth:
Directional, Deviated or Horizontal wellbore? Yes No
If Yes, true vertical depth:
Bottom Hole Location: RECEIVED
KCC DKT #: KANSAS CORPORATION COMMISSION

JUN 16 2008

AFFIDAVIT

RECEIVED
KANSAS CORPORATION COMMISSION

The undersigned hereby affirms that the drilling, completion and eventual plugging of this well will comply with K.S.A. 55 et. seq.
It is agreed that the following minimum requirements will be met:

JUN 11 2008

1. Notify the appropriate district office **prior** to spudding of well;
2. A copy of the approved notice of intent to drill **shall be** posted on each drilling rig;
3. The minimum amount of surface pipe as specified below **shall be set** by circulating cement to the top; in all cases surface pipe **shall be set** through all unconsolidated materials plus a minimum of 20 feet into the underlying formation.
4. If the well is dry hole, an agreement between the operator and the district office on plug length and placement is necessary **prior to plugging**;
5. The appropriate district office will be notified before well is either plugged or production casing is cemented in;
6. If an ALTERNATE II COMPLETION, production pipe shall be cemented from below any usable water to surface within **120 DAYS** of spud date.
Or pursuant to Appendix "B" - Eastern Kansas surface casing order #133,891-C, which applies to the KCC District 3 area, alternate II cementing must be completed within 30 days of the spud date or the well shall be plugged. **In all cases, NOTIFY district office** prior to any cementing.

CONSERVATION DIVISION
WICHITA, KS

I hereby certify that the statements made herein are true and correct to the best of my knowledge and belief.

Date: 6-10-08 Signature of Operator or Agent: Jim Robinson Title: Representative

For KCC Use ONLY
API # 15 - 167-23520-0000
Conductor pipe required None feet
Minimum surface pipe required 320 feet per ALT. I II
Approved by: mas 6-17-08
This authorization expires: 6-17-09
(This authorization void if drilling not started within 12 months of approval date.)
Spud date Agent:

Remember to:
- File Drill Pit Application (form CDP-1) with Intent to Drill;
- File Completion Form ACO-1 within 120 days of spud date.
- File acreage attribution plat according to field proration orders.
- Notify appropriate district office 48 hours prior to workover or re-entry;
- Submit plugging report (CP-4) after plugging is completed (within 60 days);
- Obtain written approval before disposing or injecting salt water.
- If this permit has expired (See: authorized expiration date) please check the box below and return to the address below.
 Well Not Drilled - Permit Expired Date: Signature of Operator or Agent:

17-14-12
 E W

IN ALL CASES PLOT THE INTENDED WELL ON THE PLAT BELOW

Plat of acreage attributable to a well in a prorated or spaced field

If the intended well is in a prorated or spaced field, please fully complete this side of the form. If the intended well is in a prorated or spaced field complete the plat below showing that the well will be properly located in relationship to other wells producing from the common source of supply. Please show all the wells and within 1 mile of the boundaries of the proposed acreage attribution unit for gas wells and within 1/2 mile of the boundaries of the proposed acreage attribution unit for oil wells.

API No. 15 - 167-23520-0000

Operator: Double Eagle Exploration, Inc.

Lease: Hlad

Well Number: B#1

Field: Mahoney

Number of Acres attributable to well: _____

QTR/QTR/QTR/QTR of acreage: - N/2 - SE - SE

Location of Well: County: Russell

990 feet from N / S Line of Section

660 feet from E / W Line of Section

Sec. 17 Twp. 14 S. R. 12 E W

Is Section: Regular or Irregular

If Section is Irregular, locate well from nearest corner boundary.

Section corner used: NE NW SE SW

PLAT

(Show location of the well and shade attributable acreage for prorated or spaced wells.)

(Show footage to the nearest lease or unit boundary line.)

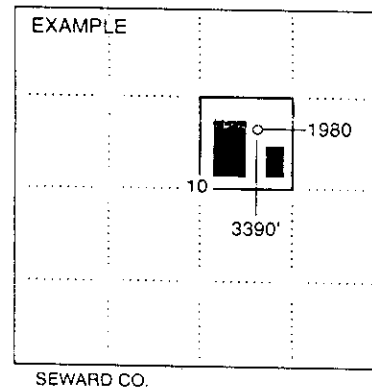
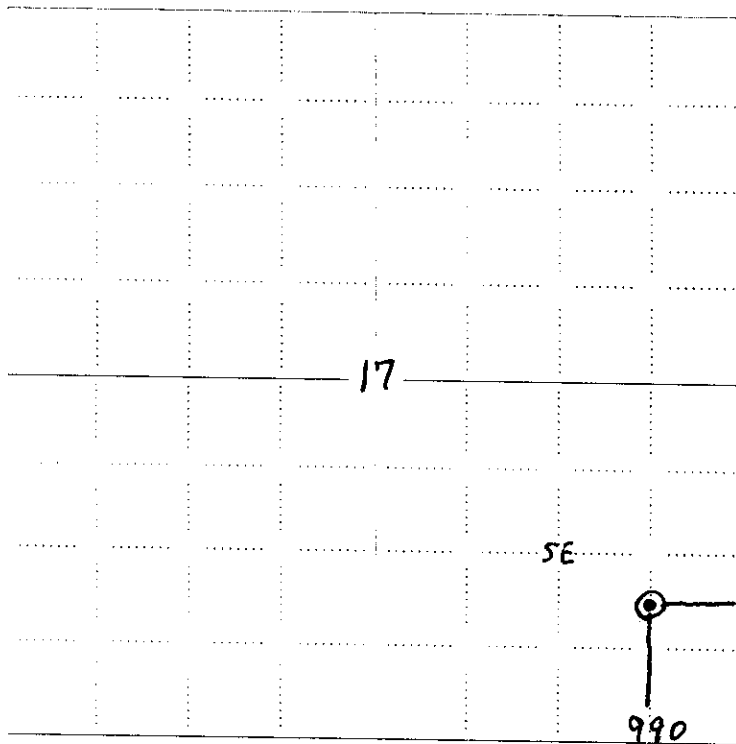

NOTE: In all cases locate the spot of the proposed drilling locaton.

In plotting the proposed location of the well, you must show:

1. The manner in which you are using the depicted plat by identifying section lines, i.e. 1 section, 1 section with 8 surrounding sections, 4 sections, etc.
2. The distance of the proposed drilling location from the south / north and east / west outside section lines.
3. The distance to the nearest lease or unit boundary line (in footage).
4. If proposed location is located within a prorated or spaced field a certificate of acreage attribution plat must be attached: (CO-7 for oil wells; CG-8 for gas wells).

**KANSAS CORPORATION COMMISSION
OIL & GAS CONSERVATION DIVISION
APPLICATION FOR SURFACE PIT**

Form CDP-1
April 2004
Form must be Typed

Submit in Duplicate

Operator Name: <u>Double Eagle Exploration, Inc.</u>		License Number: <u>6009</u>
Operator Address: <u>221 S. Broadway, #310 Wichita, KS. 67202</u>		
Contact Person: <u>Jim Robinson</u>		Phone Number: (<u>316</u>) <u>264</u> - <u>0422</u>
Lease Name & Well No.: <u>Hlad B#1</u>		Pit Location (QQQQ): <u> </u> - <u>N/2</u> - <u>SE</u> - <u>SE</u> Sec. <u>17</u> Twp. <u>14S</u> R. <u>12</u> <input type="checkbox"/> East <input checked="" type="checkbox"/> West <u>990</u> Feet from <input type="checkbox"/> North / <input checked="" type="checkbox"/> South Line of Section <u>650</u> Feet from <input checked="" type="checkbox"/> East / <input type="checkbox"/> West Line of Section <u>Russell</u> County
Type of Pit: <input type="checkbox"/> Emergency Pit <input type="checkbox"/> Burn Pit <input type="checkbox"/> Settling Pit <input checked="" type="checkbox"/> Drilling Pit <input type="checkbox"/> Workover Pit <input type="checkbox"/> Haul-Off Pit <small>(If WP Supply API No. or Year Drilled)</small>	Pit is: <input checked="" type="checkbox"/> Proposed <input type="checkbox"/> Existing If Existing, date constructed: Pit capacity: <u>200</u> (bbls)	
Is the pit located in a Sensitive Ground Water Area? <input type="checkbox"/> Yes <input checked="" type="checkbox"/> No		Chloride concentration: _____ mg/l <small>(For Emergency Pits and Settling Pits only)</small>
Is the bottom below ground level? <input checked="" type="checkbox"/> Yes <input type="checkbox"/> No	Artificial Liner? <input checked="" type="checkbox"/> Yes <input type="checkbox"/> No	How is the pit lined if a plastic liner is not used?
Pit dimensions (all but working pits): <u>100</u> Length (feet) <u>100</u> Width (feet) _____ N/A: Steel Pits Depth from ground level to deepest point: <u>6</u> (feet)		
If the pit is lined give a brief description of the liner material, thickness and installation procedure.		Describe procedures for periodic maintenance and determining liner integrity, including any special monitoring.
		RECEIVED KANSAS CORPORATION COMMISSION JUN 11 2008 CONSERVATION DIVISION WICHITA, KS
Distance to nearest water well within one-mile of pit <u>3594</u> feet None Depth of water well <u>193</u> feet	Depth to shallowest fresh water <u>176</u> feet.	Source of information: _____ measured _____ well owner _____ electric log <input checked="" type="checkbox"/> KDWR
Emergency, Settling and Burn Pits ONLY: Producing Formation: _____ Number of producing wells on lease: _____ Barrels of fluid produced daily: _____ Does the slope from the tank battery allow all spilled fluids to flow into the pit? <input type="checkbox"/> Yes <input type="checkbox"/> No	Drilling, Workover and Haul-Off Pits ONLY: Type of material utilized in drilling/workover: <u>Fresh Mud</u> Number of working pits to be utilized: <u>3</u> Abandonment procedure: <u>Allow to dry & backfill</u> Drill pits must be closed within 365 days of spud date.	
I hereby certify that the above statements are true and correct to the best of my knowledge and belief.		
<u>6-10-08</u> Date	 Signature of Applicant or Agent	RECEIVED KANSAS CORPORATION COMMISSION JUN 16 2008 CONSERVATION DIVISION WICHITA, KS
KCC OFFICE USE ONLY		
Date Received: <u>6/16/08</u> Permit Number: _____	Permit Date: <u>6/16/08</u> Lease Inspection: <input type="checkbox"/> Yes <input checked="" type="checkbox"/> No	

Mail to: KCC - Conservation Division, 130 S. Market - Room 2078, Wichita, Kansas 67202

15-167-235-20000