

For KCC Use: 6-29-08  
 Effective Date: 6-29-08  
 District # 1  
 SGA?  Yes  No

KANSAS CORPORATION COMMISSION  
 OIL & GAS CONSERVATION DIVISION  
**NOTICE OF INTENT TO DRILL**

Form C-1  
 December 2002  
 Form must be Typed  
 Form must be Signed  
 All blanks must be Filled

Must be approved by KCC five (5) days prior to commencing well

Expected Spud Date July 1, 2008  
month day year

OPERATOR: License# 6044  
 Name: Stelbar Oil Corporation, Inc.  
 Address: 1625 N. Waterfront Parkway, #200  
Wichita, KS 67206-6602  
 City/State/Zip:  
 Contact Person: Roscoe L. Mendenhall  
 Phone: 316 / 264-8378

CONTRACTOR: License# 5142  
 Name: Sterling Drilling Company

|  |   |  |
|--|---|--|
| <b>Well Drilled For:</b>                     | <b>Well Class:</b>                          | <b>Type Equipment:</b>                         |
| <input checked="" type="checkbox"/> Oil      | <input type="checkbox"/> Enh Rec            | <input checked="" type="checkbox"/> Mud Rotary |
| <input type="checkbox"/> Gas                 | <input type="checkbox"/> Storage            | <input type="checkbox"/> Air Rotary            |
| <input type="checkbox"/> OWO                 | <input type="checkbox"/> Disposal           | <input type="checkbox"/> Cable                 |
| <input type="checkbox"/> Seismic; # of Holes | <input checked="" type="checkbox"/> Wildcat |  |
| <input type="checkbox"/> Other               | <input type="checkbox"/> Other              |  |

If OWWO: old well information as follows:  
 Operator: \_\_\_\_\_  
 Well Name: \_\_\_\_\_  
 Original Completion Date: \_\_\_\_\_ Original Total Depth: \_\_\_\_\_

Directional, Deviated or Horizontal wellbore?  Yes  No  
 If Yes, true vertical depth: \_\_\_\_\_  
 Bottom Hole Location: \_\_\_\_\_  
 KCC DKT #: \_\_\_\_\_

Spot SE/4 SE/4 NE/4 Sec. 3 Twp. 30 S. R. 41  East  West  
2010 feet from  N /  S Line of Section  
460 feet from  E /  W Line of Section

Is SECTION  Regular  Irregular?  
 County: Stanton  
 Lease Name: Carr Well #: 2-3

Field Name: \_\_\_\_\_  
 Is this a Prorated / Spaced Field?  Yes  No  
 Target Formation(s): Mississippian

Nearest Lease or unit boundary: 460'  
 Ground Surface Elevation: 3370 feet MSL

Water well within one-quarter mile:  Yes  No  
 Public water supply well within one mile:  Yes  No

Depth to bottom of fresh water: 260 Ft.  
 Depth to bottom of usable water: 620 Ft. 640

Surface Pipe by Alternate:  1  2  
 Length of Surface Pipe Planned to be set: 1700 Ft.

Length of Conductor Pipe required: None  
 Projected Total Depth: 5600 Ft.  
 Formation at Total Depth: Mississippian

Water Source for Drilling Operations:  
 Well  Farm Pond  Other \_\_\_\_\_  
 DWR Permit #: Not Yet Available

(Note: Apply for Permit with DWR)   
 Will Cores be taken?  Yes  No  
 If Yes, proposed zone: \_\_\_\_\_

PRORATED & SPACED: HULLTON

**AFFIDAVIT**

RECEIVED  
 KANSAS CORPORATION COMMISSION

The undersigned hereby affirms that the drilling, completion and eventual plugging of this well will comply with K.S.A. 55 et. seq.  
 It is agreed that the following minimum requirements will be met:

1. Notify the appropriate district office *prior* to spudding of well;
2. A copy of the approved notice of intent to drill *shall be* posted on each drilling rig;
3. The minimum amount of surface pipe as specified below *shall be set* by circulating cement to the top; in all cases surface pipe *shall* through all unconsolidated materials plus a minimum of 20 feet into the underlying formation.
4. If the well is dry hole, an agreement between the operator and the district office on plug length and placement is necessary *prior to plugging*;
5. The appropriate district office will be notified before well is either plugged or production casing is cemented in;
6. If an ALTERNATE II COMPLETION, production pipe shall be cemented from below any usable water to surface within **120 days** of spud date. Or pursuant to Appendix "B" - Eastern Kansas surface casing order #133,891-C, which applies to the KCC District 3 area, alternate II cementing must be completed within 30 days of the spud date or the well shall be plugged. *In all cases, NOTIFY district office prior to any cementing.*

I hereby certify that the statements made herein are true and to the best of my knowledge and belief.  
 Date: 06/20/2008 Signature of Operator or Agent: Roscoe L. Mendenhall Title: Vice-Pres./Operations

**For KCC Use ONLY**  
 API # 15 - 187-21130-00-00  
 Conductor pipe required None feet  
 Minimum surface pipe required 660 feet per Alt. 1  
 Approved by: RM 6-24-08  
 This authorization expires: 0-24-09  
 (This authorization void if drilling not started within 6 months of effective date.)  
 Spud date: \_\_\_\_\_ Agent: \_\_\_\_\_

- Remember to:**
- File Drill Pit Application (form CDP-1) with Intent to Drill;
  - File Completion Form ACO-1 within 120 days of spud date;
  - File acreage attribution plat according to field proration orders;
  - Notify appropriate district office 48 hours prior to workover or re-entry;
  - Submit plugging report (CP-4) after plugging is completed;
  - Obtain written approval before disposing or injecting salt water.
- If this permit has expired (See: authorized expiration date) please check the box below and return to the address below.  
 Well Not Drilled - Permit Expired  
 Signature of Operator or Agent: \_\_\_\_\_  
 Date: \_\_\_\_\_

Mail to: KCC - Conservation Division, 130 S. Market - Room 2078, Wichita, Kansas 67202

3  
 30  
 41W

**IN ALL CASES PLOT THE INTENDED WELL ON THE PLAT BELOW**

*Plat of acreage attributable to a well in a prorated or spaced field*

*If the intended well is in a prorated or spaced field, please fully complete this side of the form. If the intended well is in a prorated or spaced field complete the plat below showing that the well will be properly located in relationship to other wells producing from the common source of supply. Please show all the wells and within 1 mile of the boundaries of the proposed acreage attribution unit for gas wells and within 1/2 mile of the boundaries of the proposed acreage attribution unit for oil wells.*

API No. 15 - 187-21130-00-00  
 Operator: Stelbar Oil Corporation, Inc.  
 Lease: Carr  
 Well Number: 2-3  
 Field: \_\_\_\_\_  
 Number of Acres attributable to well: 40  
 QTR / QTR / QTR of acreage: SE/4 - SE/4 - NE/4

Location of Well: County: Stanton  
2010 feet from  N /  S Line of Section  
460 feet from  E /  W Line of Section  
 Sec. 3 Twp. 30 S. R. 41  East  West

Is Section:  Regular or  Irregular

If Section is Irregular, locate well from nearest corner boundary.  
 Section corner used:  NE  NW  SE  SW

**PLAT**

*(Show location of the well and shade attributable acreage for prorated or spaced wells.)  
 (Show footage to the nearest lease or unit boundary line.)*

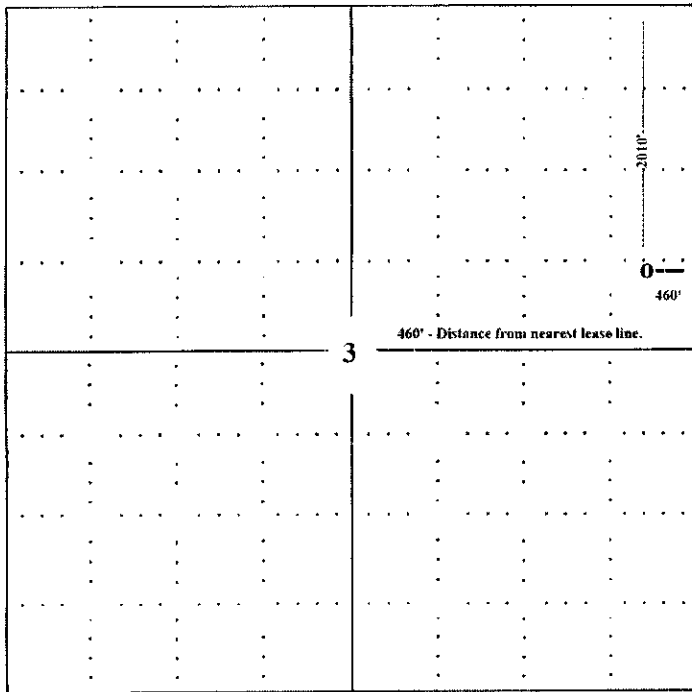

Section 3-T30S-R41W, Stanton County, Kansas

RECEIVED  
 KANSAS CORPORATION COMMISSION  
**JUN 23 2008**  
 CONSERVATION DIVISION  
 WICHITA, KS

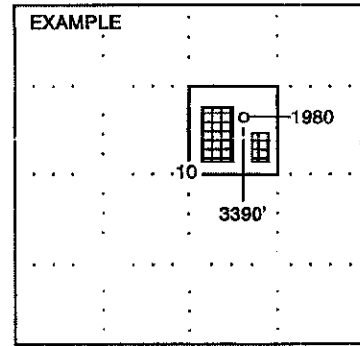

SEWARD CO.

**NOTE: In all cases locate the spot of the proposed drilling locaton.**

**In plotting the proposed location of the well, you must show:**

1. The manner in which you are using the depicted plat by identifying section lines, i.e. 1 section, 1 section with 8 surrounding sections, 4 sections, etc.
2. The distance of the proposed drilling location from the section's south / north and east / west.
3. The distance to the nearest lease or unit boundary line.
4. If proposed location is located within a prorated or spaced field a certificate of acreage attribution plat must be attached: (C0-7 for oil wells; CG-8 for gas wells).

**KANSAS CORPORATION COMMISSION  
OIL & GAS CONSERVATION DIVISION  
APPLICATION FOR SURFACE PIT**

Form CDP-1  
April 2004  
Form must be Typed

*Submit in Duplicate*

|   |  |   |
|---|--|---|
| Operator Name: <b>Stelbar Oil Corporation, Inc.</b>   |  | License Number: <b>6044</b>   |
| Operator Address: <b>1625 N. Waterfront Parkway, Suite #200, Wichita, KS 67206-6602</b>   |  |   |
| Contact Person: <b>Roscoe L. Mendenhall</b>   |  | Phone Number: ( <b>316</b> ) <b>264 - 8378</b>  |
| Lease Name & Well No.: <b>Carr #2-3</b>   |  | Pit Location (QQQQ):<br><b>SE/4 SE/4 NE/4</b>   |
| Type of Pit:<br><input type="checkbox"/> Emergency Pit <input type="checkbox"/> Burn Pit<br><input type="checkbox"/> Settling Pit <input checked="" type="checkbox"/> Drilling Pit<br><input type="checkbox"/> Workover Pit <input type="checkbox"/> Haul-Off Pit<br><small>(If W/P Supply API No. or Year Drilled)</small>       | Pit is:<br><input checked="" type="checkbox"/> Proposed <input type="checkbox"/> Existing<br>If Existing, date constructed: _____<br>Pit capacity:<br><b>10,700</b> (bbls) | Sec. <b>3</b> Twp. <b>30S</b> R. <b>41</b> <input type="checkbox"/> East <input checked="" type="checkbox"/> West<br><b>2010</b> Feet from <input checked="" type="checkbox"/> North / <input type="checkbox"/> South Line of Section<br><b>460</b> Feet from <input checked="" type="checkbox"/> East / <input type="checkbox"/> West Line of Section<br><b>Stanton</b> County |
| Is the pit located in a Sensitive Ground Water Area? <input type="checkbox"/> Yes <input checked="" type="checkbox"/> No  |  | Chloride concentration: _____ mg/l<br><small>(For Emergency Pits and Settling Pits only)</small>  |
| Is the bottom below ground level?<br><input checked="" type="checkbox"/> Yes <input type="checkbox"/> No  | Artificial Liner?<br><input type="checkbox"/> Yes <input checked="" type="checkbox"/> No   | How is the pit lined if a plastic liner is not used?  |
| Pit dimensions (all but working pits): <b>100 Ft.</b> Length (feet) <b>100 Ft.</b> Width (feet)    _____ N/A: Steel Pits<br>Depth from ground level to deepest point: <b>6 Ft.</b> (feet)   |  |   |
| If the pit is lined give a brief description of the liner material, thickness and installation procedure.   |  | Describe procedures for periodic maintenance and determining liner integrity, including any special monitoring.   |
|   |  | RECEIVED<br>KANSAS CORPORATION COMMISSION<br><b>JUN 23 2008</b><br>CONSERVATION DIVISION<br>WICHITA, KS   |
| Distance to nearest water well within one-mile of pit<br><b>3219</b> feet    Depth of water well <b>280</b> feet  |  | Depth to shallowest fresh water <b>80 Ft.</b> feet.<br>Source of information:<br>_____ measured    _____ well owner    _____ electric log <input checked="" type="checkbox"/> KDWR  |
| <b>Emergency, Settling and Burn Pits ONLY:</b><br>Producing Formation: _____<br>Number of producing wells on lease: _____<br>Barrels of fluid produced daily: _____<br>Does the slope from the tank battery allow all spilled fluids to flow into the pit? <input type="checkbox"/> Yes <input type="checkbox"/> No               |  | <b>Drilling, Workover and Haul-Off Pits ONLY:</b><br>Type of material utilized in drilling/workover: <b>Drilling Mud.</b><br>Number of working pits to be utilized: <b>Three (3).</b><br>Abandonment procedure: <b>Allow pits to dry and fill with soil.</b><br>Drill pits must be closed within 365 days of spud date.   |
| I hereby certify that the above statements are true and correct to the best of my knowledge and belief.<br><b>STELBAR OIL CORPORATION, INC.</b><br><br>Signature of Applicant or Agent (Roscoe L. Mendenhall)<br><b>June 20, 2008</b><br>Date |  |   |
| <b>KCC OFFICE USE ONLY</b>  |  |   |
| Date Received: <b>6/23/08</b> Permit Number: _____ Permit Date: <b>6/23/08</b> Lease Inspection: <input type="checkbox"/> Yes <input checked="" type="checkbox"/> No  |  |   |

15-187-21130-00-00

**ADOBE FILL-IN FORM ON INTERNET**

FORM DATE

General Administrative

- 09/2005 ■ License Application OPL-1
- 04/2004 ■ Request for Change of Operator; Transfer of Injection or Surface Pit Permit T-1

Well Permitting

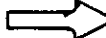
- 
 10/2007 ■ Notice of Intent to Drill C-1 Please use updated form on future filings.
- 04/2004 ■ Application for Surface Pit CDP-1
- 12/1993 ■ Cathodic Protection Borehole Intent to Drill CB-1

Well Completion Reports and Other Well Application

- 09/1999 ■ Well Completion Form ACO-1
- 09/2005 ■ Commingling Application ACO-4
- 05/1988 ■ Dual Completion Report ACO-5
- 09/2005 ■ Well Location Exception Application Check List ACO-17
- 09/2005 ■ Venting-Flaring of Gas ACO-18
- 09/2005 ■ Extended Gas Venting Affidavit CG-3
- 09/2005 ■ Coalbed Natural Gas Venting Affidavit CG-4
- 10/2004 ■ Temporary Abandonment Application CP-111
- 09/2003 ■ Verified Affidavit For Vacuum Operations V-1

Surface Pits and Waste Transfer

- 04/2004 ■ Application for Surface Pit CDP-1
- 04/2004 ■ Closure of Surface Pit CDP-4
- 04/2004 ■ Exploration and Production Waste Transfer CDP-5

Well Plugging Report

- 09/2003 ■ Well Plugging Application CP-1
- 12/2003 ■ Well Plugging Record CP-4
- 08/2003 ■ Seismic Hole Affidavit

Oil & Gas Well Testing Report

- 10/1996 ■ Oil Productivity Test & GOR Report C-5
- 10/1996 ■ Multi-Point Back Pressure Test CG-1
- 07/2003 ■ One Point Stabilized Open Flow or Deliverability Test G-2

Gas Gathering Report

- 04/1998 ■ Gas Gathering Report GG-1
- 04/1998 ■ Gas Gathering Segment Report GG-1a

Oil and Gas Producer's Report

- 06/1989 ■ Summary of Oil Producers Report CO-8, CO-8A
- 08/2000 ■ Gas Producer/Purchaser Monthly Report CG-7, CG-7A

Acreage Attribution and Well Spacing Report

- 12/1994 ■ Oil Acreage Attribution Plat CO-7
- 12/1994 ■ Gas Acreage Attribution Plat CG-8
- 05/1989 ■ Application for Well Spacing ACO-7

New Pool and Certificate of Enhancement Projects (Severance Tax Exemptions) Request

- 10/2005 ■ New Pool Determination-Discovery Allowable ACO-16
- 10/1999 ■ Application for Enhanced Recovery Project Certification CER-1, and Calculation Sheet Base Production Calculation and Certification CER 1-A

Underground Injection Control Report

- 07/2003 ■ UIC Application U-1
- 07/2003 ■ Annual Report U3-C. This form is required on an annual basis due each March 1.
- 07/2003 ■ Notice of Injection (of commencement or termination of injection) U-5
- 07/2003 ■ Application to Amend Injection Order U-8
- 07/2003 ■ Notice to Modify Injection Order U-9

Wireline Service

- 08/2003 ■ Monthly Wireline Service Company Report MWSC-1