

WELL PLUGGING RECORD

Give All Information Completely
Make Required Affidavit
Mail or Deliver Report to:
Conservation Division
State Corporation Commission
211 No. Broadway
Wichita, Kansas

NORTH

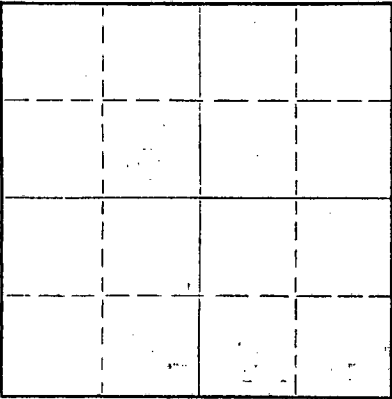

Locate well correctly on above Section Plat

Sheridan County, Sec. 15 Twp. 9 Rge. (E) 26 (W)
Location as "NE/CNWxSWx" or footage from lines NW NW SW
Lease Owner Jones, Shelburne & Farmer, Inc.
Lease Name Epler Well No. #1
Office Address Russell, Kansas
Character of Well (completed as Oil, Gas or Dry Hole) dry
Date well completed 12-16 19 55
Application for plugging filed 12-16 19 55
Application for plugging approved 12-16 19 55
Plugging commenced 12-16 19 55
Plugging completed 12-16 19 55
Reason for abandonment of well or producing formation dry

If a producing well is abandoned, date of last production 19
Was permission obtained from the Conservation Division or its agents before plugging was commenced? Yes

Name of Conservation Agent who supervised plugging of this well Eldon Petty
Producing formation _____ Depth to top _____ Bottom _____ Total Depth of Well 4150 Feet
Show depth and thickness of all water, oil and gas formations.

OIL, GAS OR WATER RECORDS

CASING RECORD

FORMATION	CONTENT	FROM	TO	SIZE	PUT IN	PULLED OUT
				8 5/8	210	None

Describe in detail the manner in which the well was plugged, indicating where the mud fluid was placed and the method or methods used in introducing it into the hole. If cement or other plugs were used, state the character of same and depth placed, from _____ feet to _____ feet for each plug set.

1. Filled hole with heavy mud.
2. Pushed plug to 205'.
3. Dumped one-half sack hulls on top of plug.
4. Mixed 15 sacks cement and dumped on top of hulls.
5. Filled hole to top.
6. Pushed plug to 40'.
7. Dumped in one-half sack of hulls.
8. Mixed 10 sacks cement and filled hole to top with same.

STATE OF KANSAS
RECORDED
12-22-1955

Name of Plugging Contractor Jones, Shelburne & Farmer, Inc.
Address Russell, Kansas

STATE OF Kansas, COUNTY OF Russell, ss.
John O. Farmer (employee of owner) or (owner or operator) of the above-described well, being first duly sworn on oath, says: That I have knowledge of the facts, statements, and matters herein contained and the log of the above-described well as filed and that the same are true and correct. So help me God.

(Signature) John O. Farmer
Russell, Kansas (Address)

SUBSCRIBED AND SWORN to before me this 21st day of December, 19 55
My commission expires October 11, 1958
Notary Public.



PLUGGING
FILE SEC. 15 T. 9 R. 26 W
BOOK PAGE 26 LINE 11

ADDRESS Russell, Kansas

Give detailed description and thickness of all formations drilled through, contents of sand, whether dry, water, oil or gas.

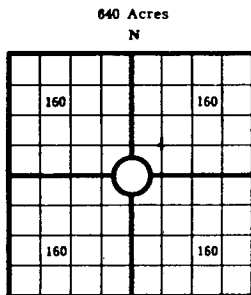

640 Acres
N
Locate well correctly

COUNTY Sheridan SEC 15 TWP 9 RGE 26
 COMPANY OPERATING Jones, Shelburne & Farmer, Inc.
 OFFICE ADDRESS Russell, Kansas
 FARM NAME Epler WELL NO. 1
 DRILLING STARTED 12-5-55 DRILLING FINISHED 12-16-55
 DATE OF FIRST PRODUCTION _____ COMPLETED _____
 WELL LOCATED NW 1/4 NW 1/4 SW 1/4 North of South
 Line and _____ ft. East of West Line of Quarter Section
 Elevation (Relative to sea level) DERRICK FLOOR 266 GROUND
 CHARACTER OF WELL (Oil, gas or dryhole) dry

OIL OR GAS SANDS OR ZONES

Name	From	To	Name	From	To
1			4		
2			5		
3			6		

Perforating Record If Any

Shot Record

Formation	From	To	No. of Shots	Formation	From	To	Size of Shot

CASING RECORD

Amount Set				Amount Pulled				Packer Record			
Size	Wt.	Thds.	Make	Ft.	In.	Ft.	In.	Size	Length	Depth Set	Make
8 5/8				210							

Liner Record: Amount _____ Kind _____ Top _____ Bottom _____

CEMENTING AND MUDDING

Size	Amount Set		Sacks Cement	Chemical		Method of Cementing	Amount	Mudding Method	Results (See Note)
	Ft.	In.		Gal.	Make				
8 5/8	210		150						

Note: What method was used to protect sands if outer strings were pulled? _____

NOTE: Were bottom hole plugs used? _____ If so, state kind, depth set and results obtained _____

TOOLS USED

Rotary Tools were used from _____ feet to _____ Cable tools were used from _____ feet to _____
 _____ feet, _____ from _____ feet to _____ feet, and from _____ feet to _____
 Type Rig _____

INITIAL PRODUCTION TEST

Describe initial test, whether by flow through tubing or casing or by pumping _____
 Amount of Oil Production _____ bbls. Size of choke, if any _____ Length of test _____ Water _____
 Production _____ bbls. Gravity of oil _____ Type of Pump if pump is used, describe _____

Formation	Top	Bottom	Formation	Top	Bottom
Surface	0	210			
Shale & shells	210	870			
Shale & sand	870	1730			
Shale & shells	1730	1960			
Shale & sand	1960	2050			
Shale & shells	2050	2110			
Redbed	2110	2317			
Anhydrite	2317	2360			
Shale & shells	2360	2795			
Lime & shale	2795	2895			
Shells & shale	2895	2925			
Lime & shale	2925	3820			
Lime	3820	3870			
Lime & shale	3870	3915			
Lime	3915	4105			
Lime & shale	4105	4150			

TOPS:

Elev 2663
 Heebner 3870
 Toronto
 Lansing 3908
 BKC 4144
 T.D., 4150

I, the undersigned, being first duly sworn upon oath, state that this well record is true, correct and complete according to the records of this office and the best of my knowledge and belief.

John D. Service Vice-Pres.
 Name and title of representative of company

Subscribed and sworn to before me this 19th day of December, 1955
 M. Commission expires July 14, 1958
Donnie Price
 Notary Public.

FARM NAME Epler, Sheridan, SEC. 15., TWP. 9, RGE. 26., WELL NO. 1, COUNTY Sheridan

PLUGGING
 DEC 15 9 1955
 R. B. ...