

Give All Information Completely
Make Required Affidavit
Mail or Deliver Report to:
Conservation Division
State Corporation Commission
212 North Market, Insurance Bldg.
Wichita, Kansas

24 15-179-00089-00-00

WELL PLUGGING RECORD

NORTH

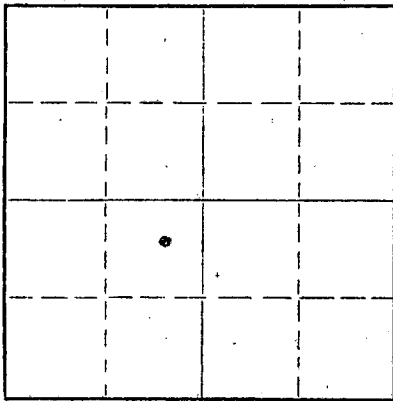

Locate well correctly on above
Section Plat

Sheridan County. Sec. 5 Twp. 8S Rge. (X) 26 (W)
Location as "NE/CNWxSWx" or footage from lines C NE SW
Lease Owner Texaco Inc.
Lease Name William Albers Well No. 1
Office Address 614 Bitting Bldg., Wichita, Kansas
Character of Well (completed as Oil, Gas or Dry Hole) Dry
Date well completed 2-16-61 19
Application for plugging filed 2-17-61 (Confirming) 19
Application for plugging approved 2-16-61 - Verbal 19
Plugging commenced 2-16-61 19
Plugging completed 2-16-61 19
Reason for abandonment of well or producing formation Dry Hole

If a producing well is abandoned, date of last production _____ 19
Was permission obtained from the Conservation Division or its agents before plugging was commenced? Yes - Verbal

Name of Conservation Agent who supervised plugging of this well Gilbert P. Lieker
Producing formation _____ Depth to top _____ Bottom _____ Total Depth of Well 4657 Feet
Show depth and thickness of all water, oil and gas formations.

OIL, GAS OR WATER RECORDS

CASING RECORD

FORMATION	CONTENT	FROM	TO	SIZE	PUT IN	PULLED OUT
None						

Describe in detail the manner in which the well was plugged, indicating where the mud fluid was placed and the method or methods used in introducing it into the hole. If cement or other plugs were used, state the character of same and depth placed, from _____ feet to _____ feet for each plug set.

4657-400 w/hvy mud
Wooden Plug @ 400
400-340 w/20 sx cmt
340-210 w/hvy mud
Wooden Plug @ 210
210-154 w/20 sx cmt
154-40 w/hvy mud
Wooden Plug @ 40
40-bottom of cellar w/10 sx cmt.

RECEIVED
STATE CORPORATION COMMISSION

FEB 23 1961

CONSERVATION DIVISION
Wichita, Kansas

2-23-61

(If additional description is necessary, use BACK of this sheet)
Name of Plugging Contractor Prime Drilling Co.
Address 814 Union Center, Wichita, Kansas

STATE OF Kansas, COUNTY OF Sedgwick, ss.
M. C. Harrell (employee of owner) or (owner or operator) of the above-described well, being first duly sworn on oath, says: That I have knowledge of the facts, statements, and matters herein contained and the log of the above-described well as filed and that the same are true and correct. So help me God.

(Signature) M. C. Harrell
614 Bitting Bldg., Wichita, Kansas
(Address)

SUBSCRIBED AND SWORN TO before me this 17th day of February, 19 61

My commission expires 2-20-64
A. E. Boyd
Notary Public.



15-179-00089-00-00

TEXACO INC.—LOG OF WELL
TULSA DIVISION

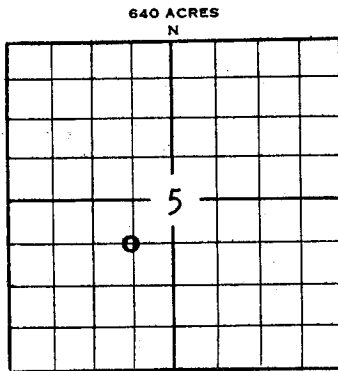

WELL WILLIAM ALBERS NO. 1 L. D. FILE NO. 175512
 LOC. Ctr. NE SW SEC. 5 TWP. 8S RGE. 26W
Staked 660 S & 660 W of NE Cor. of SW/4
 DIST. Wichita CO.-PARISH Sheridan STATE Kansas
 COMM. DRLG. 2-4-61 COMP. DRLG. 2-16-61 DAYS DRLG. 13
 ROT. FROM 0 TO 4657 CABLE FROM - TO -
 CONTR. OR CO. RIG NO. Prime Drlg. Co. T. D. DRILLED 4657

COMP. T. D. 4657 ZERO ELEV. _____ GRD. ELEV. 2544 CSG. FLG. ELEV. _____
 DATE OF FIRST PROD. Dry Hole OFFICIAL COMP. DATE 2-17-61
 LOGS RUN Sonic

CASING RECORD

SIZE INCHES	DEPTH FEET	WEIGHT #/FT.	GRADE	RANGE	REMARKS—QUAN. CMT., TEMP. SURV., ETC.
8-5/8	300	24	J	2	Set & Cmt'd. @311' w/225 Sacks Pozmix, 2% C.C. Cmt. Circ.

RECEIVED
 STATE CONSERVATION COMMISSION
 FEB 23 1961
 CONSERVATION DIVISION
 Wichita, Kansas

COMPLETION DATA

FORMATION	Dry	LOG	T O P S
DATE OF TEST		Topeka	3502
DEPTH OF PROD. INTERVAL		Heebner	3716
INITIAL PRODUCTION: OIL - BPD		Lansing	3756
GAS - MCF		Marmaton	4006
WATER - BPD		Cherokee	4173
GOR		Congomorate	4272
BHP - PSI		Miss	4320
CORRECTED API GRAVITY		Viola	4496
PRODUCING CONDITIONS		Simpson	4600
ARTIFICIAL STIMULATION		Arbuckle	4604

REMARKS

WELL W. Albers No. 1 FIELD Wildcat AREA Hays

13-179-00089-00-00

REC'D

FEB 21 '61

WPCAL DIST.

ROTARY DRILLING LOG

OPERATOR: Texaco, Inc.
William Albers No. 1
C NE SW Sec. 5-8-26W,
Sheridan County, Kansas

CONTRACTOR: Prime Drilling Company
COMM: 2-4-61
COMP: 2-17-61

Remarks: Set 8-5/8" surface casing
at 311' cemented with 225
sx. Poz., 2% C.C.

Formations:

Shale & Shell	100'
Sand	135'
Shale	1141'
Shale & Shells	1635'
Shale & Shells & Red Bed	2150'
Shale & Shells	2350'
Shale	2580'
Shale & Lime	3235'
Lime	3285'
Lime & Shale	3490'
Shale & Lime	3600'
Lime	4270'
Lime & Shale	4319'
Lime	4369'
Lime - Cherty	4408'
Lime & Chert	4444'
Lime	4657'
Rotary Total Depth (D&A)	4657'

We certify the above log is true and
correct to the best of our knowledge
and belief.

PRIME DRILLING COMPANY

R.R. McNicol

R. R. McNicol

STATE DEPARTMENT OF
STATE DEPARTMENT OF HIGHWAYS

FEB 23 1961

CONSERVATION DIVISION
Wichita, Kansas

2-23-61