

STATE OF KANSAS
STATE CORPORATION COMMISSION
200 Colorado Derby Building
Wichita, Kansas 67202

WELL PLUGGING RECORD
K.A.R.-82-3-117

API NUMBER 15-193-20,420-002

LEASE NAME Kindig

WELL NUMBER #2 "OWWO"

3300' Ft. from S Section Line

660' Ft. from E Section Line

SEC. 30 TWP. 8S RGE. 32 ~~XXX~~ (W)

COUNTY Thomas

Date Well Completed 10-4-91

Plugging Commenced 10-4-91

Plugging Completed 10-4-91

TYPE OR PRINT
NOTICE: Fill out completely
and return to Cons. Div.
office within 30 days.

LEASE OPERATOR Red Oak Energy, Inc.

ADDRESS 200 W. Douglas - Suite 510

Wichita, KS 67202

PHONE# (316) 265-9925 OPERATORS LICENSE NO. 3581

Character of Well D & A

(Oil, Gas, D&A, SWD, Input, Water Supply Well)

The plugging proposal was approved on October 4, 1991 (date)

by Carl Goodrow (KCC District Agent's Name).

Is ACO-1 filed? No If not, is well log attached? No

Producing Formation _____ Depth to Top _____ Bottom T.D. 2224'

Show depth and thickness of all water, oil and gas formations.

OIL, GAS OR WATER RECORDS

CASING RECORD

STATE CORPORATION COMMISSION
RECEIVED
10-16-91
OCT 16 1991
Wichita, Kansas

Formation	Content	From	To	Size	Put In	Pulled out
				8 5/8"	302'	None

Describe in detail the manner in which the well was plugged, indicating where the mud fluid was placed and the method or methods used in introducing it into the hole. If cement or other plugs were used, state the character of same and depth placed, from ___ feet to ___ feet each set.

Spotted 100 sx. cement at 1950' thru drill pipe.
Spotted 40 sx. cement at 340' thru drill pipe.
Spotted 10 sx. cement & wiper plug at 40' thru drill pipe.
Spotted 15 sx. cement in rathole.

(If additional description is necessary, use BACK of this form.)

Name of Plugging Contractor White & Ellis Drilling, Inc. License No. 5420

Address P. O. Box 48848, Wichita, KS 67201-8848

NAME OF PARTY RESPONSIBLE FOR PLUGGING FEES: Red Oak Energy, Inc.

STATE OF KANSAS COUNTY OF SEDGWICK, ss.

Michael L. Considine (Employee of Operator) or (Operator) of
above-described well, being first duly sworn on oath, says: That I have knowledge of the facts,
statements, and matters herein contained and the log of the above-described well as filed that
the same are true and correct, so help me God.

(Signature) Michael L. Considine

(Address) P. O. Box 48848
Wichita, KS 67201-8848

SUBSCRIBED AND SWORN TO before me this 8th day of October, 19 91

My Commission Expires:

Carolyn J. Tjaden
Notary Public
CAROLYN J. TJADEN
NOTARY PUBLIC
STATE OF KANSAS
My Appt. Exp. Sept. 5, 1992

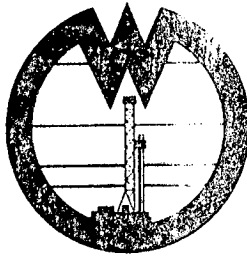

RECEIVED
STATE CORPORATION COMMISSION
10-16-91
OCT 16 1991

WHITE

AND ELLIS DRILLING, Inc.

18-193-20420-00-01

DRILLERS LOG

OPERATOR: Red Oak Energy, Inc., 200 W. Douglas - #510, Wichita, KS 67202

CONTRACTOR: White & Ellis Drilling, Inc. 401 E. Douglas - Suite 500
Wichita, Kansas 67202

Lease Name Kindig Well No. #2 "OWWO"

Sec. 30 T. 8S R. 32S Spot C SE NE

County Thomas State Kansas Elev. _____

Casing Record:

Surface: 8 5/8" @ 302' with _____ sx.

Production: _____ @ _____ with _____ sx.

Type Well: D & A Total Depth 2224'

Drilling Commenced 10-2-91 Drilling Completed 10-4-91

Formation	From	To	Tops.
Cement	0	35	
Open Hole	35	300	
Cement	300	375	
70% Shale - 30% Cement	375	415	
Open Hole	415	1411	
Cement & Shale	1411	1935	
Sandy Shale	1935	2009	
Shale & Sand	2009	2224	

EFFECTIVE DATE: 9-22-91

"DWWO"
Thomas 420A

FORM MUST BE TYPED
FORM C-1 4/90

State of Kansas
NOTICE

FORM MUST BE SIGNED
ALL BLANKS MUST BE FILLED

Must be approved by the K.C.C. _____ days prior to commencing well

Expected Spud Date SEPTEMBER 10 1991
month day year

C SE NE Sec 30 Twp 8 S, Rg 32 East West

OPERATOR: License # 3581
Name: RED DAK ENERGY, INC.
Address: 200 W DOUGLAS, STE 510
City/State/Zip: WICHITA, KS 67202
Contact Person: KEVIN C. DAVIS
Phone: (316)265-9925

3300' feet from South line of Section
660' feet from East line of Section
(Note: Locate well on Section Plat on Reverse Side)

CONTRACTOR: License # 5420
Name: White and Ellis Drilling

County: THOMAS
Lease Name: KINDIG Well #: 2 OWWO
Field Name: KINDIG

Well Drilled For: Well Class: Type Equipment:
 Oil ... Inj ... Infield Mud Rotary
 Gas ... Storage Pool Ext. ... Air Rotary
 OWWO ... Disposal ... Wildcat ... Cable
... Seismic; ... # of Holes

Is this a Prorated Field? yes no
Target Formation(s): BASE OF KANSAS CITY
Nearest lease or unit boundary: 660
Ground Surface Elevation: 3123 feet MSL
Domestic well within 330 feet: yes no
Municipal well within one mile: yes no
Depth to bottom of fresh water: 180
Depth to bottom of usable water: 250
Surface Pipe by Alternate: 1 2
Length of Surface Pipe Planned to be set: 302 8.5/8 SE
Length of Conductor pipe required: NONE
Projected Total Depth: 4730
Formation at Total Depth: MISSISSIPPIAN
Water Source for Drilling Operations:
... well ... farm pond other

If OWWO: old well information as follows:
Operator: WEST KANSAS CRUDE, INC.
Well Name: KINDIG #2
Comp. Date: 11/9/86 Old Total Depth 4730

DWR Permit #: _____
Will Cores Be Taken?: yes no
If yes, proposed zone: _____

Directional, Deviated or Horizontal wellbore? yes no

Judy 10-2-91
Bob Kasper - White & Ellis
Spud 10-2-91
Set 302
Alt I completion

The undersigned hereby affirms that the drilling, completion and eventual plugging of this well will comply with K.S.A. 55-101, et. seq.

- It is agreed that the following minimum requirements will be met:
1. The appropriate district office shall be notified before setting surface pipe;
 2. The minimum amount of surface pipe as specified above shall be set by circulating cement to the top; in all cases surface pipe shall be set through all unconsolidated materials plus a minimum of 20 feet into the underlying formation;
 3. If the well is dry, a plugging proposal shall be submitted to the district office. An agreement between the operator and the district office on plug length and placement is necessary prior to plugging;
 4. The appropriate district office will be notified before well is either plugged or production casing is cemented in;
 5. If an Alternate II completion, production pipe shall be cemented from below any usable water to surface within 120 days of spud date. In all cases, notify district office prior to any cementing.

I hereby certify that the statements made herein are true and to the best of my knowledge and belief.
Date: Sept 12, 1991 Signature of Operator or Agent: Kevin C. Davis Title: PRES.

RECEIVED
STATE CORPORATION COMMISSION

SEP 16 1991

Conservation Division
Wichita, Kansas

FOR KCC USE:
API # 15- 193-20,420-100-01
Conductor: _____ feet
Minimum surface pipe required 300 feet per Alt. ①
Approved by: mlw 9-17-91
EFFECTIVE DATE: 9-22-91
This authorization expires: 3-17-92
(This authorization void if drilling not started within 6 months of effective date.)
Spud date: 10-2-91 Agent: mlw

SEP 18 1991

30
2
3200

REMEMBER TO:

- File Drill Pit Application (form CDP-1) with Intent to Drill;
- File Completion Form ACO-1 within 120 days of spud date;
- File acreage attribution plat according to field proration orders;
- Notify appropriate district office 48 hours prior to workover or re-entry;
- Submit plugging report (CP-4) after plugging is completed;
- Obtain written approval before disposing or injecting salt water.

IN ALL CASES PLOT THE INTENDED WELL ON THE PLAT BELOW

~~202200001~~
 PLAT OF ACREAGE ATTRIBUTABLE TO A WELL IN A PRORATED OR SPACED FIELD

If the intended well is in a prorated or spaced field, please fully complete this side of the form. If the intended well is in a prorated or spaced field complete the plat below showing that the well will be properly located in relationship to other wells producing from the common source of supply. Please show all the wells within 1 mile of the boundaries of the proposed acreage attribution unit for gas wells and within 1/2 mile of the boundaries of the proposed acreage attribution unit for oil wells.

API NO. 15- _____
 OPERATOR _____
 LEASE _____
 WELL NUMBER _____
 FIELD _____

LOCATION OF WELL: COUNTY Gove
4390 feet from south/north line of section
1650 feet from east/west line of section
 SECTION 16 TWP 15 RG 29W

NUMBER OF ACRES ATTRIBUTABLE TO WELL _____
 QTR/QTR/QTR OF ACREAGE _____

IS SECTION X REGULAR or _____ IRREGULAR
IF SECTION IS IRREGULAR, LOCATE WELL FROM NEAREST CORNER BOUNDARY.

Section corner used: _____ NE _____ NW _____ SE _____ SW

PLAT

(Show location of the well and shade attributable acreage for prorated or spaced wells.)
 (Show footage to the nearest lease or unit boundary line.)

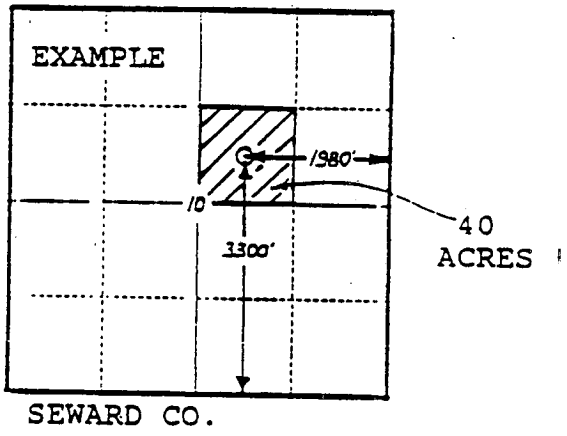
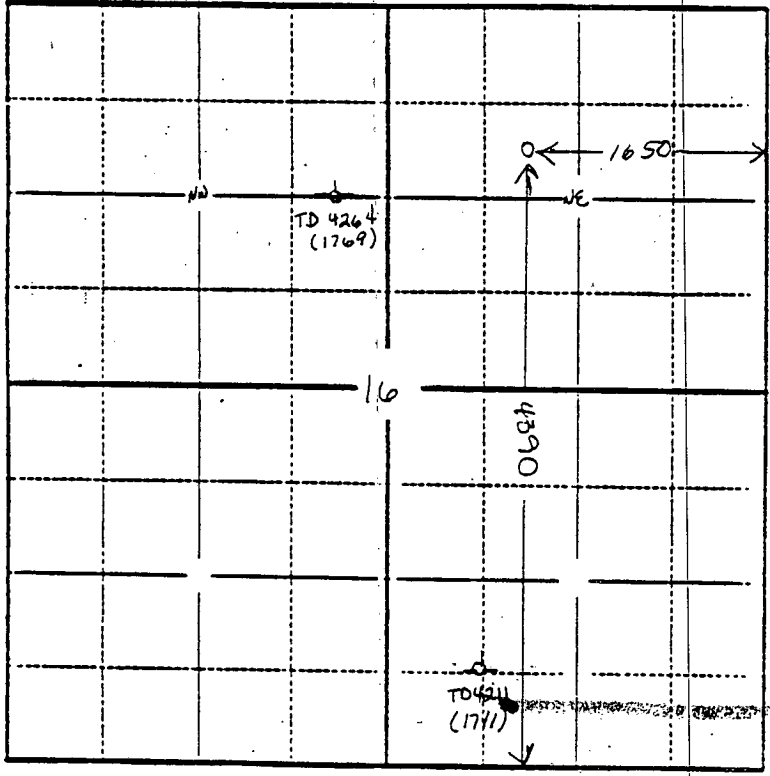

In plotting the proposed location of the well, you must show:

- 1) The manner in which you are using the depicted plat by identifying section lines, i.e. 1 section, 1 section with 8 surrounding sections, 4 sections, etc.;
- 2) the distance of the proposed drilling location from the section's south/north and east/west; and
- 3) the distance to the nearest lease or unit boundary line.