

For KCC Use: 7-6-08
 Effective Date: _____
 District # _____
 SGA? Yes No

KANSAS CORPORATION COMMISSION
 OIL & GAS CONSERVATION DIVISION

Form C-1
 October 2007
 Form must be Typed
 Form must be Signed
 All blanks must be Filled

NOTICE OF INTENT TO DRILL

Must be approved by KCC five (5) days prior to commencing well

Expected Spud Date: July 5, 2008
month day year

OPERATOR: License# 33856
 Name: WHITE EXPLORATION, INC.
 Address 1: 2400 N. Woodlawn, Suite 115
 Address 2: _____
 City: Wichita State: KS Zip: 67220
 Contact Person: Kenneth S. White
 Phone: (316) 682-6300
 CONTRACTOR: License# 30606
 Name: Murfin Drilling Co., Inc.

Spot Description: _____
NE SE NE Sec. 23 Twp. 30 S. R. 41 E W
 1,720 feet from N / S Line of Section
 330 feet from E / W Line of Section
 Is SECTION: Regular Irregular?

(Note: Locate well on the Section Plat on reverse side)

County: Stanton
 Lease Name: Love "A" Well #: 1
 Field Name: unnamed

Is this a Prorated / Spaced Field? Yes No
 Target Formation(s): Morrow
 Nearest Lease or unit boundary line (in footage): 330'

Ground Surface Elevation: 3348 feet MSL
 Water well within one-quarter mile: Yes No
 Public water supply well within one mile: Yes No

Depth to bottom of fresh water: 260
 Depth to bottom of usable water: 620
 Surface Pipe by Alternate: I II
 Length of Surface Pipe Planned to be set: 1650'
 Length of Conductor Pipe (if any): none
 Projected Total Depth: 5600'
 Formation at Total Depth: Mississippi

Water Source for Drilling Operations:
 Well Farm Pond Other: Not known at this time
 DWR Permit #: _____

(Note: Apply for Permit with DWR)

Will Cores be taken? Yes No
 If Yes, proposed zone: _____

Well Drilled For: Oil Gas Seismic Other
 Enh Rec Storage Disposal
 # of Holes _____
 Well Class: Infield Pool Ext. Wildcat Other
 Type Equipment: Mud Rotary Air Rotary Cable
 If OWWO: old well information as follows:

Operator: _____
 Well Name: _____
 Original Completion Date: _____ Original Total Depth: _____

Directional, Deviated or Horizontal wellbore? Yes No
 If Yes, true vertical depth: _____
 Bottom Hole Location: _____
 KCC DK1 #: _____

PRORATED & SPACED: HUBBARD

AFFIDAVIT

The undersigned hereby affirms that the drilling, completion and eventual plugging of this well will comply with K.S.A. 55 et. seq.
 It is agreed that the following minimum requirements will be met:

1. Notify the appropriate district office **prior** to spudding of well;
2. A copy of the approved notice of intent to drill **shall be** posted on each drilling rig;
3. The minimum amount of surface pipe as specified below **shall be set** by circulating cement to the top; in all cases surface pipe shall be cemented through all unconsolidated materials plus a minimum of 20 feet into the underlying formation.
4. If the well is dry hole, an agreement between the operator and the district office on plug length and placement is necessary **prior to plugging**;
5. The appropriate district office will be notified before well is either plugged or production casing is cemented in;
6. If an ALTERNATE II COMPLETION, production pipe shall be cemented from below any usable water to surface within **120 DAYS** of spud date. Or pursuant to Appendix "B" - Eastern Kansas surface casing order #133,891-C, which applies to the KCC District 3 area, alternate II cementing must be completed within 30 days of the spud date or the well shall be plugged. **In all cases, NOTIFY district office** prior to any cementing.

I hereby certify that the statements made herein are true and correct to the best of my knowledge and belief.

Date: June 27, 2008 Signature of Operator or Agent: Kenneth S. White Title: President

For KCC Use ONLY
 API # 15 - 187-21131-0000
 Conductor pipe required None feet
 Minimum surface pipe required 640 feet per ALT. I II
 Approved by: DWA 7-1-08
 This authorization expires: 7-1-09
 (This authorization void if drilling not started within 12 months of approval date.)
 Spud date: _____ Agent: _____

Remember to:

- File Drill Pit Application (form CDP-1) with Intent to Drill;
- File Completion Form ACO-1 within 120 days of spud date;
- File acreage attribution plat according to field proration orders;
- Notify appropriate district office 48 hours prior to workover or re-entry;
- Submit plugging report (CP-4) after plugging is completed (within 60 days);
- Obtain written approval before disposing or injecting salt water.
- If this permit has expired (See: authorized expiration date) please check the box below and return to the address below.

Well Not Drilled - Permit Expired Date: _____
 Signature of Operator or Agent: _____

RECEIVED
 KANSAS CORPORATION COMMISSION
 JUN 30 2008

CONSERVATION DIVISION
 WICHITA, KS

23
 30
 41
 E
 W

IN ALL CASES PLOT THE INTENDED WELL ON THE PLAT BELOW

Plat of acreage attributable to a well in a prorated or spaced field

If the intended well is in a prorated or spaced field, please fully complete this side of the form. If the intended well is in a prorated or spaced field complete the plat below showing that the well will be properly located in relationship to other wells producing from the common source of supply. Please show all the wells and within 1 mile of the boundaries of the proposed acreage attribution unit for gas wells and within 1/2 mile of the boundaries of the proposed acreage attribution unit for oil wells.

API No. 15 - 187-21131-0000
 Operator: WHITE EXPLORATION, INC.
 Lease: Love "A"
 Well Number: 1
 Field: unnamed
 Number of Acres attributable to well: _____
 QTR/QTR/QTR/QTR of acreage: _____

Location of Well: County: Stanton
 _____ feet from N / S Line of Section
1,720
 _____ feet from E / W Line of Section
330
 Sec. 23 Twp. 30 S. R. 41 E W

Is Section: Regular or Irregular

If Section is Irregular, locate well from nearest corner boundary.

Section corner used: NE NW SE SW

PLAT

(Show location of the well and shade attributable acreage for prorated or spaced wells.)

(Show footage to the nearest lease or unit boundary line.)

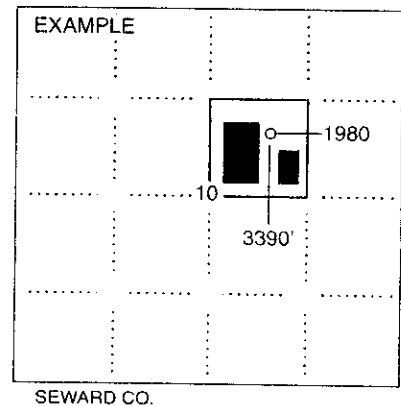
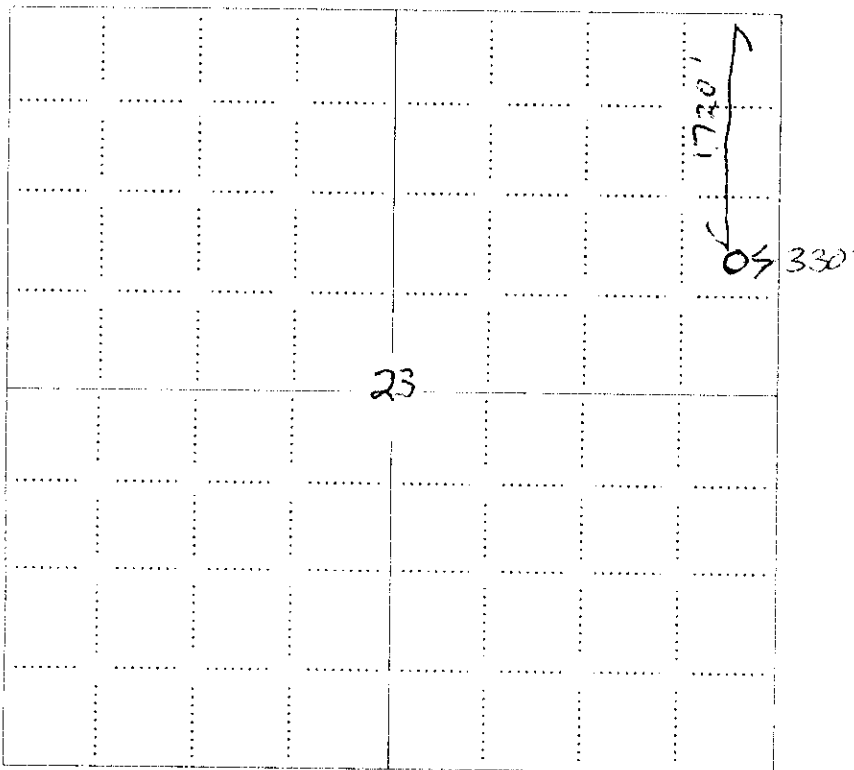

NOTE: In all cases locate the spot of the proposed drilling locaton.

In plotting the proposed location of the well, you must show:

1. The manner in which you are using the depicted plat by identifying section lines, i.e. 1 section, 1 section with 8 surrounding sections, 4 sections, etc.
2. The distance of the proposed drilling location from the south / north and east / west outside section lines.
3. The distance to the nearest lease or unit boundary line (in footage).
4. If proposed location is located within a prorated or spaced field a certificate of acreage attribution plat must be attached: (CO-7 for oil wells; CG-8 for gas wells).

KANSAS CORPORATION COMMISSION
OIL & GAS CONSERVATION DIVISION

Form CDP-1
April 2004
Form must be Typed

APPLICATION FOR SURFACE PIT

Submit in Duplicate

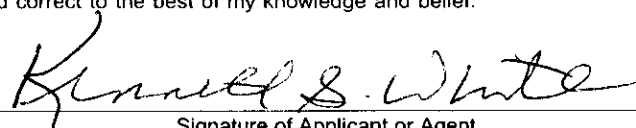
Operator Name: WHITE EXPLORATION, INC.		License Number: 33856	
Operator Address: 2400 N. Woodlawn, Suite 115		Wichita KS 67220	
Contact Person: Kenneth S. White		Phone Number: (316) 682-6300	
Lease Name & Well No.: Love "A" 1		Pit Location (QQQQ): S2 . NE . SE . NE	
Type of Pit: <input type="checkbox"/> Emergency Pit <input type="checkbox"/> Burn Pit <input type="checkbox"/> Settling Pit <input checked="" type="checkbox"/> Drilling Pit <input type="checkbox"/> Workover Pit <input type="checkbox"/> Haul-Off Pit <small>(If WP Supply API No. or Year Drilled)</small>		Pit is: <input checked="" type="checkbox"/> Proposed <input type="checkbox"/> Existing If Existing, date constructed: _____ Pit capacity: _____ (bbbls)	
		Sec. 23 Twp. 30 R. 41 <input type="checkbox"/> East <input checked="" type="checkbox"/> West 1,720 Feet from <input checked="" type="checkbox"/> North / <input type="checkbox"/> South Line of Section 330 Feet from <input checked="" type="checkbox"/> East / <input type="checkbox"/> West Line of Section Stanton County	
Is the pit located in a Sensitive Ground Water Area? <input type="checkbox"/> Yes <input checked="" type="checkbox"/> No		Chloride concentration: _____ mg/l <small>(For Emergency Pits and Settling Pits only)</small>	
Is the bottom below ground level? <input checked="" type="checkbox"/> Yes <input type="checkbox"/> No		Artificial Liner? <input type="checkbox"/> Yes <input checked="" type="checkbox"/> No	
		How is the pit lined if a plastic liner is not used? Bentonite in Drilling Mud	
Pit dimensions (all but working pits): 100 Length (feet) 100 Width (feet)		<input type="checkbox"/> N/A: Steel Pits	
Depth from ground level to deepest point: 4 (feet)		<input type="checkbox"/> No Pit	
If the pit is lined give a brief description of the liner material, thickness and installation procedure.		Describe procedures for periodic maintenance and determining liner integrity, including any special monitoring.	
		RECEIVED KANSAS CORPORATION COMMISSION JUN 30 2008 CONSERVATION DIVISION WICHITA, KS	
Distance to nearest water well within one-mile of pit 1392 feet Depth of water well 380 feet		Depth to shallowest fresh water 203 feet. Source of information: JR-KGS <input type="checkbox"/> measured <input type="checkbox"/> well owner <input type="checkbox"/> electric log <input type="checkbox"/> KDWR	
Emergency, Settling and Burn Pits ONLY: Producing Formation: _____ Number of producing wells on lease: _____ Barrels of fluid produced daily: _____ Does the slope from the tank battery allow all spilled fluids to flow into the pit? <input type="checkbox"/> Yes <input type="checkbox"/> No		Drilling, Workover and Haul-Off Pits ONLY: Type of material utilized in drilling/workover: Chemical Mud Number of working pits to be utilized: 3 Abandonment procedure: allow to dry and backfill Drill pits must be closed within 365 days of spud date.	
I hereby certify that the above statements are true and correct to the best of my knowledge and belief.			
June 27, 2008 Date		 Signature of Applicant or Agent	

15-187-21131-0000

KCC OFFICE USE ONLY		Steel Pit <input type="checkbox"/>	RFAC <input type="checkbox"/>	RFAS <input type="checkbox"/>
Date Received: 6/30/08	Permit Number: _____	Permit Date: 6/30/08	Lease Inspection: <input type="checkbox"/> Yes <input checked="" type="checkbox"/> No	