

For KCC Use: 7-12-08
 Effective Date: _____
 District # _____
 SGA? Yes No

KANSAS CORPORATION COMMISSION
OIL & GAS CONSERVATION DIVISION
NOTICE OF INTENT TO DRILL
Must be approved by KCC five (5) days prior to commencing well

Form C-1
 December 2002
Form must be Typed
Form must be Signed
All blanks must be Filled

Expected Spud Date 07 08 2008
month day year

OPERATOR: License# 33596
 Name: UNIT PETROLEUM COMPANY
 Address: PO BOX 702500
 City/State/Zip: TULSA, OK 74170
 Contact Person: MICHAEL DUNN
 Phone: 918-493-7700

CONTRACTOR: License# 33596
 Name: UNIT PETROLEUM

| | | |
|--|---|--|
| Well Drilled For: | Well Class: | Type Equipment: |
| <input type="checkbox"/> Oil | <input type="checkbox"/> Enh Rec | <input type="checkbox"/> Infield |
| <input checked="" type="checkbox"/> Gas | <input type="checkbox"/> Storage | <input checked="" type="checkbox"/> Mud Rotary |
| <input type="checkbox"/> OWWO | <input type="checkbox"/> Disposal | <input type="checkbox"/> Air Rotary |
| <input type="checkbox"/> Seismic; # of Holes _____ | <input checked="" type="checkbox"/> Wildcat | <input type="checkbox"/> Cable |
| <input type="checkbox"/> Other _____ | <input type="checkbox"/> Other _____ | |

If OWWO: old well information as follows:
 Operator: _____
 Well Name: _____
 Original Completion Date: _____ Original Total Depth: _____
 Directional, Deviated or Horizontal wellbore? Yes No
 If Yes, true vertical depth: _____
 Bottom Hole Location: _____
 KCC DKT #: _____

Spot _____ East
 _____ NW/4 Sec. 8 Twp. 35 S. R. 21 West
1320 feet from N / S Line of Section
1320 feet from E / W Line of Section
 Is SECTION Regular Irregular?

(Note: Locate well on the Section Plat on reverse side)
 County: CLARK
 Lease Name: TUTTLE "A" Well #: 1
 Field Name: TUTTLE WEST

Is this a Prorated / Spaced Field? Yes No
 Target Formation(s): MORROW, CHESTER, ST. GENEVIEVE
 Nearest Lease or unit boundary: 1320'

Ground Surface Elevation: 1854 feet MSL
 Water well within one-quarter mile: Yes No
 Public water supply well within one mile: Yes No

Depth to bottom of fresh water: 180
 Depth to bottom of usable water: 180
 Surface Pipe by Alternate: 1 2
 Length of Surface Pipe Planned to be set: 700'
 Length of Conductor Pipe required: NONE
 Projected Total Depth: 5900'
 Formation at Total Depth: ST. GENEVIEVE

Water Source for Drilling Operations:
 Well Farm Pond Other _____
 DWR Permit #: APPLYING FOR

(Note: Apply for Permit with DWR)
 Will Cores be taken? Yes No
 If Yes, proposed zone: _____

AFFIDAVIT

RECEIVED
 KANSAS CORPORATION COMMISSION

The undersigned hereby affirms that the drilling, completion and eventual plugging of this well will comply with K.S.A. 55 et. seq.

It is agreed that the following minimum requirements will be met:

1. Notify the appropriate district office **prior** to spudding of well;
2. A copy of the approved notice of intent to drill **shall be** posted on each drilling rig;
3. The minimum amount of surface pipe as specified below **shall be set** by circulating cement to the top; in all cases surface pipe **shall be set** through all unconsolidated materials plus a minimum of 20 feet into the underlying formation.
4. If the well is dry hole, an agreement between the operator and the district office on plug length and placement is necessary **prior to plugging**;
5. The appropriate district office will be notified before well is either plugged or production casing is cemented in;
6. If an ALTERNATE II COMPLETION, production pipe shall be cemented from below any usable water to surface within **120 days** of spud date. Or pursuant to Appendix "B" - Eastern Kansas surface casing order #133,891-C, which applies to the KCC District 3 area, alternate II cementing must be completed within 30 days of the spud date or the well shall be plugged. **In all cases, NOTIFY district office** prior to any cementing.

I hereby certify that the statements made herein are true and to the best of my knowledge and belief.

Date: 7-01-08 Signature of Operator or Agent: Frank Young Title: FRANK YOUNG, V.P.

JUL 03 2008

CONSERVATION DIVISION
 WICHITA, KS

Remember to:

- File Drill Pit Application (form CDP-1) with Intent to Drill;
- File Completion Form ACO-1 within 120 days of spud date;
- File acreage attribution plat according to field proration orders;
- Notify appropriate district office 48 hours prior to workover or re-entry;
- Submit plugging report (CP-4) after plugging is completed;
- Obtain written approval before disposing or injecting salt water.
- If this permit has expired (See: authorized expiration date) please check the box below and return to the address below.

Well Not Drilled - Permit Expired
 Signature of Operator or Agent: _____
 Date: _____

8 35 21W

For KCC Use ONLY

API # 15 - 025-21460-0000

Conductor pipe required None feet

Minimum surface pipe required 200 feet per Alt. 1

Approved by: [Signature] 7-7-08 OX

This authorization expires: 7-7-09
(This authorization void if drilling not started within 12 months of approval date.)

Spud date: _____ Agent: _____

IN ALL CASES PLOT THE INTENDED WELL ON THE PLAT BELOW

Plat of acreage attributable to a well in a prorated or spaced field

If the intended well is in a prorated or spaced field, please fully complete this side of the form. If the intended well is in a prorated or spaced field complete the plat below showing that the well will be properly located in relationship to other wells producing from the common source of supply. Please show all the wells and within 1 mile of the boundaries of the proposed acreage attribution unit for gas wells and within 1/2 mile of the boundaries of the proposed acreage attribution unit for oil wells.

API No. 15 - 025-21460-0000
 Operator: UNIT PETROLEUM COMPANY
 Lease: TUTTLE "A"
 Well Number: 1
 Field: TUTTLE WEST
 Number of Acres attributable to well: 640
 QTR / QTR / QTR of acreage: - C - NW/4

Location of Well: County: CLARK
1320 feet from N / S Line of Section
1320 feet from E / W Line of Section
 Sec. 8 Twp. 35 S. R. 21 East West

Is Section: Regular or Irregular

If Section is Irregular, locate well from nearest corner boundary.

Section corner used: NE NW SE SW

PLAT

(Show location of the well and shade attributable acreage for prorated or spaced wells.)

(Show footage to the nearest lease or unit boundary line.)

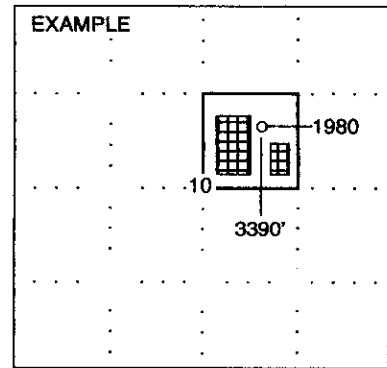
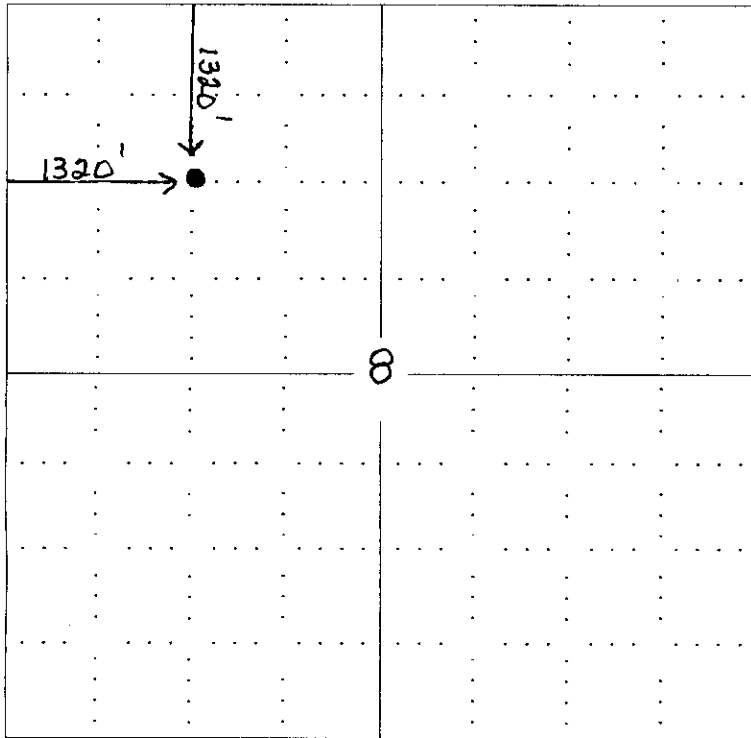

SEWARD CO.

NOTE: In all cases locate the spot of the proposed drilling location.

In plotting the proposed location of the well, you must show:

1. The manner in which you are using the depicted plat by identifying section lines, i.e. 1 section, 1 section with 8 surrounding sections, 4 sections, etc.
2. The distance of the proposed drilling location from the section's south / north and east / west.
3. The distance to the nearest lease or unit boundary line.
4. If proposed location is located within a prorated or spaced field a certificate of acreage attribution plat must be attached: (CO-7 for oil wells; CG-8 for gas wells).

**KANSAS CORPORATION COMMISSION
OIL & GAS CONSERVATION DIVISION
APPLICATION FOR SURFACE PIT**

Form CDP-1
April 2004
Form must be Typed

Submit in Duplicate

| | | |
|--|---|---|
| Operator Name: UNIT PETROLEUM COMPANY | | License Number: 33596 |
| Operator Address: PO BOX 702500 TULSA, OK 74170 | | |
| Contact Person: MICHAEL DUNN | | Phone Number: (918) 493 - 7700 |
| Lease Name & Well No.: TUTTLE "A" #1 | | Pit Location (QQQQ): C NW |
| Type of Pit: <input type="checkbox"/> Emergency Pit <input type="checkbox"/> Burn Pit <input type="checkbox"/> Settling Pit <input checked="" type="checkbox"/> Drilling Pit <input type="checkbox"/> Workover Pit <input type="checkbox"/> Haul-Off Pit <small>(If WP Supply API No. or Year Drilled)</small> | Pit is: <input checked="" type="checkbox"/> Proposed <input type="checkbox"/> Existing If Existing, date constructed: _____ Pit capacity: 1600 (bbls) | Sec. 8 Twp. 35S R. 21 <input type="checkbox"/> East <input checked="" type="checkbox"/> West 1320 Feet from <input checked="" type="checkbox"/> North / <input checked="" type="checkbox"/> South Line of Section 1320 Feet from <input type="checkbox"/> East / <input checked="" type="checkbox"/> West Line of Section CLARK County |
| Is the pit located in a Sensitive Ground Water Area? <input checked="" type="checkbox"/> Yes <input checked="" type="checkbox"/> No | | Chloride concentration: _____ mg/l <small>(For Emergency Pits and Settling Pits only)</small> |
| Is the bottom below ground level? <input type="checkbox"/> Yes <input checked="" type="checkbox"/> No | Artificial Liner? <input type="checkbox"/> Yes <input checked="" type="checkbox"/> No | How is the pit lined if a plastic liner is not used? |
| Pit dimensions (all but working pits): _____ Length (feet) _____ Width (feet) X N/A: Steel Pits Depth from ground level to deepest point: _____ (feet) | | |
| If the pit is lined give a brief description of the liner material, thickness and installation procedure. | | Describe procedures for periodic maintenance and determining liner integrity, including any special monitoring. |
| Distance to nearest water well within one-mile of pit _____ feet Depth of water well _____ feet | Depth to shallowest fresh water _____ feet. Source of information: _____ measured _____ well owner _____ electric log _____ KDWR | |
| Emergency, Settling and Burn Pits ONLY: Producing Formation: _____ Number of producing wells on lease: _____ Barrels of fluid produced daily: _____ Does the slope from the tank battery allow all spilled fluids to flow into the pit? <input type="checkbox"/> Yes <input type="checkbox"/> No | Drilling, Workover and Haul-Off Pits ONLY: Type of material utilized in drilling/workover: DRILLING MUD Number of working pits to be utilized: _____ Abandonment procedure: _____ Drill pits must be closed within 365 days of spud date. | |
| I hereby certify that the above statements are true and correct to the best of my knowledge and belief. | | |
| <u>6/23/08</u> Date |  Signature of Applicant or Agent | RECEIVED KANSAS CORPORATION COMMISSION JUL 03 2008 CONSERVATION DIVISION WICHITA, KS |
| KCC OFFICE USE ONLY | | |
| Date Received: <u>7/3/08</u> | Permit Number: _____ | Permit Date: <u>7/3/08</u> Lease Inspection: <input type="checkbox"/> Yes <input checked="" type="checkbox"/> No |

15-025-21460-0000



*Kathleen Sebelius, Governor
Thomas E. Wright, Chairman
Michael C. Moffet, Commissioner
Joseph F. Harkins, Commissioner*

July 3, 2008

Mr. Michael Dunn
Unit Petroleum Co
PO Box 702500
Tulsa, OK 74170

RE: Drilling Pit Application
Tuttle A Lease Well No. 1
NW/4 Sec. 08-35S-21W
Clark County, Kansas

Dear Mr. Dunn:

According to the drilling pit application referenced above, no earthen pits are to be used at this location. Steel pits are to be used. Please inform the Commission in writing as to which disposal well you utilized to dispose of the contents in the steel pits and the amount of fluid that was disposed. Please file form CDP-5 (August 2004), Exploration and Production Waste Transfer, within 30 days of fluid removal.

Should a haul-off pit be necessary please file form CDP-1 (April 2004), Application for Surface Pit. The Haul-Off Pit Application Filing Requirement checklist must also be completed. This location will have to be inspected prior to approval of the haul-off pit application. Conservation division forms are available through our office and on the KCC web site: www.kcc.state.ks.us/conservation/forms.

A copy of this letter should be posted in the doghouse along with the approved Intent to Drill. If you have any questions or concerns please feel free to contact the District Office at (620) 225-8888.

CONSERVATION DIVISION

Finney State Office Building, 130 S. Market, Room 2078, Wichita, KS 67202-3802
(316) 337-6200 • Fax: (316) 337-6211 • <http://kcc.ks.gov/>

**HAUL-OFF PIT APPLICATION
FILING REQUIREMENTS**

82-3-607. DISPOSAL OF DIKE AND PIT CONTENTS.

- (a) Each operator shall perform one of the following when disposing of dike or pit contents:
- (1) Remove the liquid contents to a disposal well or other oil and gas operation approved by the commission or to road maintenance or construction locations approved by the department;
 - (2) dispose of reserve pit waste down the annular space of a well completed according to the alternate I requirements of K.A.R. 82-3-106, if the waste to be disposed of was generated during the drilling and completion of the well; or
 - (3) dispose of the remaining solid contents in any manner required by the commission. The requirements may include any of the following:
 - (A) Burial in place, in accordance with the grading and restoration requirements in K.A.R. 82-3-602 (f);
 - (B) removal and placement of the contents in an on-site disposal area approved by the commission;
 - (C) removal and placement of the contents in an off-site disposal area on acreage owned by the same landowner or to another producing lease or unit operated by the same operator, if prior written permission from the landowner has been obtained; or
 - (D) removal of the contents to a permitted off-site disposal area approved by the department.
- (b) Each violation of this regulation shall be punishable by the following:
- (1) A \$1,000 penalty for the first violation;
 - (2) a \$2,500 penalty for the second violation; and
 - (3) a \$5,000 penalty and an operator license review for the third violation.

Complete and return with Haul-Off Pit Application, Form CDP1(2004)

Haul-off pit will be located in an on-site disposal area: Yes No

Haul-off pit is located in an off-site disposal area on acreage owned by the same landowner:
Yes No If yes, written permission from the land owner must be obtained. Attach written permission to haul-off pit application.

Haul-off pit is located in an off-site disposal area on another **producing** lease or unit operated by the same operator: Yes No If yes, written permission from the land owner must be obtained. Attach permission and a copy of the lease assignment that covers the acreage where the haul-off pit is to be located, to the haul-off pit application.

KCC -- Conservation Division Forms -- 11/01/2007

Unit Petr

Internet KCC Home Page -- <http://kcc.ks.gov>

Conservation Division Home Page -- <http://kcc.ks.gov/conservation/index.htm>

Conservation Division Forms -- <http://kcc.ks.gov/conservation/forms/index.htm>

ADOBE FILL-IN FORM ON INTERNET

FORM DATE

- General Administrative**
- 09/2005 ■ License Application OPL-1
 - 04/2004 ■ Request for Change of Operator; Transfer of Injection or Surface Pit Permit T-1

Well Permitting

- 10/2007 ■ Notice of Intent to Drill C-1 Please use updated form on future filings.
- 04/2004 ■ Application for Surface Pit CDP-1
- 12/1993 ■ Cathodic Protection Borehole Intent to Drill CB-1

Well Completion Reports and Other Well Application

- 09/1999 ■ Well Completion Form ACO-1
- 09/2005 ■ Commingling Application ACO-4
- 05/1988 ■ Dual Completion Report ACO-5
- 09/2005 ■ Well Location Exception Application Check List ACO-17
- 09/2005 ■ Venting-Flaring of Gas ACO-18
- 09/2005 ■ Extended Gas Venting Affidavit CG-3
- 09/2005 ■ Coalbed Natural Gas Venting Affidavit CG-4
- 10/2004 ■ Temporary Abandonment Application CP-111
- 09/2003 ■ Verified Affidavit For Vacuum Operations V-1

Surface Pits and Waste Transfer

- 04/2004 ■ Application for Surface Pit CDP-1
- 04/2004 ■ Closure of Surface Pit CDP-4
- 04/2004 ■ Exploration and Production Waste Transfer CDP-5

Well Plugging Report

- 09/2003 ■ Well Plugging Application CP-1
- 12/2003 ■ Well Plugging Record CP-4
- 08/2003 ■ Seismic Hole Affidavit

Oil & Gas Well Testing Report

- 10/1996 ■ Oil Productivity Test & GOR Report C-5
- 10/1996 ■ Multi-Point Back Pressure Test CG-1
- 07/2003 ■ One Point Stabilized Open Flow or Deliverability Test G-2

Gas Gathering Report

- 04/1998 ■ Gas Gathering Report GG-1
- 04/1998 ■ Gas Gathering Segment Report GG-1a

Oil and Gas Producer's Report

- 06/1989 ■ Summary of Oil Producers Report CO-8, CO-8A
- 08/2000 ■ Gas Producer/Purchaser Monthly Report CG-7, CG-7A

Acreage Attribution and Well Spacing Report

- 12/1994 ■ Oil Acreage Attribution Plat CO-7
- 12/1994 ■ Gas Acreage Attribution Plat CG-8
- 05/1989 ■ Application for Well Spacing ACO-7

New Pool and Certificate of Enhancement Projects (Severance Tax Exemptions) Request

- 10/2005 ■ New Pool Determination-Discovery Allowable ACO-16
- 10/1999 ■ Application for Enhanced Recovery Project Certification CER-1, and Calculation Sheet Base Production Calculation and Certification CER 1-A

Underground Injection Control Report

- 07/2003 ■ UIC Application U-1
- 07/2003 ■ Annual Report U3-C. This form is required on an annual basis due each March 1.
- 07/2003 ■ Notice of Injection (of commencement or termination of injection) U-5
- 07/2003 ■ Application to Amend Injection Order U-8
- 07/2003 ■ Notice to Modify Injection Order U-9

Wireline Service

- 08/2003 ■ Monthly Wireline Service Company Report MWSC-1