

For KCC Use: **7-15-08**  
Effective Date: **7-15-08**  
District # **1**  
SGA? ☐ Yes ☒ No

KANSAS CORPORATION COMMISSION  
OIL & GAS CONSERVATION DIVISION

NOTICE OF INTENT TO DRILL

Must be approved by KCC five (5) days prior to commencing well

Form C-1  
October 2007  
Form must be Typed  
Form must be Signed  
All blanks must be Filled

Expected Spud Date: **07/19/2008**  
month day year

OPERATOR: License# **5447** ✓  
Name: **OXY USA, Inc.**  
Address 1: **P O Box 2528**  
Address 2:  
City: **Liberal** State: **KS** Zip: **67880** +  
Contact Person: **Jarod Powell**  
Phone: **620-629-4200**

CONTRACTOR: License# **30606** ✓  
Name: **Murfin Drilling Company, Inc.**

Well Drilled For: ☐ Oil ☒ Gas ☐ Enh Rec ☐ Storage ☐ Disposal ☐ Seismic; # of Holes ☐ Other:  
Well Class: ☒ Infield ☐ Pool Ext. ☐ Wildcat ☐ Other  
Type Equipment: ☒ Mud Rotary ☐ Air Rotary ☐ Cable

☐ If OWWO: old well information as follows:

Operator: \_\_\_\_\_  
Well Name: \_\_\_\_\_  
Original Completion Date: \_\_\_\_\_ Original Total Depth: \_\_\_\_\_

Directional, Deviated or Horizontal wellbore? ☐ Yes ☒ No  
If Yes, true vertical depth: \_\_\_\_\_  
Bottom Hole Location: \_\_\_\_\_  
KCC DKT #: \_\_\_\_\_

Spot Description:  
NE NE SW SW Sec. 27 Twp. 30 S. R. 33 ☐ E ☒ W  
(Q/Q/Q) 1,250 feet from ☐ N / ☒ S Line of Section  
1,250 feet from ☐ E / ☒ W Line of Section

Is SECTION: ☒ Regular ☐ Irregular?

(Note: Locate well on the Section Plat on reverse side)

County: **Haskell**  
Lease Name: **Tiller** Well #: **4-27**  
Field Name: **Hugoton**

Is this a Prorated / Spaced Field? ☐ Yes ☐ No

Target Formation(s): **Chase**

Nearest Lease or unit boundary line (in footage): **1250**

Ground Surface Elevation: **2933.28** feet MSL

Water well within one-quarter mile: ☐ Yes ☒ No

Public water supply well within one mile: ☐ Yes ☒ No

Depth to bottom of fresh water: **500**

Depth to bottom of usable water: **620**

Surface Pipe by Alternate: ☒ I ☐ II

Length of Surface Pipe Planned to be set: **640 minimum**

Length of Conductor Pipe (if any): \_\_\_\_\_

Projected Total Depth: **2980**

Formation at Total Depth: **Chase**

Water Source for Drilling Operations:

☒ Well ☐ Farm Pond ☐ Other: \_\_\_\_\_

DWR Permit #: \_\_\_\_\_

(Note: Apply for Permit with DWR ☒)

Will Cores be taken? ☐ Yes ☒ No

If Yes, proposed zone: \_\_\_\_\_

**PRORATED & SPACED: HUGOTON**

AFFIDAVIT

The undersigned hereby affirms that the drilling, completion and eventual plugging of this well will comply with K.S.A. 55 et. seq.

It is agreed that the following minimum requirements will be met:

1. Notify the appropriate district office **prior** to spudding of well;
2. A copy of the approved notice of intent to drill **shall be** posted on each drilling rig;
3. The minimum amount of surface pipe as specified below **shall be set** by circulating cement to the top; in all cases surface pipe **shall be set** through all unconsolidated materials plus a minimum of 20 feet into the underlying formation.
4. If the well is dry hole, an agreement between the operator and the district office on plug length and placement is necessary **prior to plugging**;
5. The appropriate district office will be notified before well is either plugged or production casing is cemented in;
6. If an ALTERNATE II COMPLETION, production pipe shall be cemented from below any usable water to surface within **120 DAYS** of spud date. Or pursuant to Appendix "B" - Eastern Kansas surface casing order #133,891-C, which applies to the KCC District 3 area, alternate II cementing must be completed within 30 days of the spud date or the well shall be plugged. **In all cases, NOTIFY district office** prior to any cementing.

I hereby certify that the statements made herein are true and correct to the best of my knowledge and belief.

Date: **07/08/2008** Signature of Operator or Agent: **Paul Powell** Title: **Capital Assets**

For KCC Use ONLY

API # 15 - **081-21820-0000**  
Conductor pipe required **None** feet  
Minimum surface pipe required **640** feet per ALT. ☒ I ☐ II  
Approved by: **Rum 7-10-08**  
This authorization expires: **7-10-09**  
(This authorization void if drilling not started within 12 months of approval date.)  
Spud date: \_\_\_\_\_ Agent: \_\_\_\_\_

Remember to:

- File Drill Pit Application (form CDP-1) with Intent to Drill;
- File Completion Form ACO-1 within 120 days of spud date;
- File acreage attribution plat according to field proration orders;
- Notify appropriate district office 48 hours prior to workover or re-entry;
- Submit plugging report (CP-4) after plugging is completed (within 60 days);
- Obtain written approval before disposing or injecting salt water.
- If this permit has expired (See: authorized expiration date) please check the box below and return to the address below.

☐ Well Not Drilled - Permit Expired Date: \_\_\_\_\_  
Signature of Operator or Agent: \_\_\_\_\_

RECEIVED  
KANSAS CORPORATION COMMISSION

JUL 09 2008

CONSERVATION DIVISION  
WICHITA, KS

27 30 33 ☐ E ☒ W

**IN ALL CASES PLOT THE INTENDED WELL ON THE PLAT BELOW***Plat of acreage attributable to a well in a prorated or spaced field*

**If the intended well is in a prorated or spaced field, please fully complete this side of the form.** If the intended well is in a prorated or spaced field complete the plat below showing that the well will be properly located in relationship to other wells producing from the common source of supply. Please show all the wells and within 1 mile of the boundaries of the proposed acreage attribution unit for gas wells and within 1/2 mile of the boundaries of the proposed acreage attribution unit for oil wells.

API No. 15 - 081-21820-0000  
 Operator: OXY USA, Inc.  
 Lease: Tiller  
 Well Number: 4-27  
 Field: Hugoton

Number of Acres attributable to well: 640  
 QTR/QTR/QTR/QTR of acreage: NE - NE - SW - SW

Location of Well: County: Haskell  
 1,250 feet from ☐ N / ☒ S Line of Section  
 1,250 feet from ☐ E / ☒ W Line of Section  
 Sec. 27 Twp. 30 S. R. 33 ☐ E ☒ W

Is Section: ☒ Regular or ☐ Irregular

**If Section is Irregular, locate well from nearest corner boundary.**

Section corner used: ☐ NE ☐ NW ☐ SE ☐ SW

**PLAT**

*(Show location of the well and shade attributable acreage for prorated or spaced wells.)*

*(Show footage to the nearest lease or unit boundary line.)*

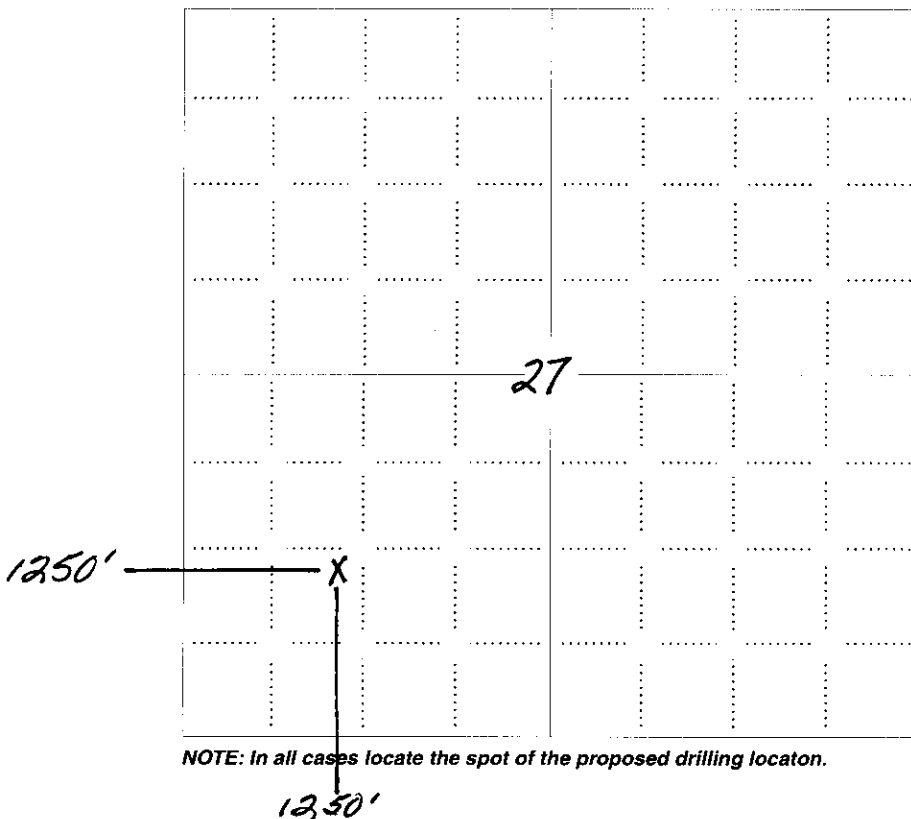

**NOTE: In all cases locate the spot of the proposed drilling location.**

RECEIVED  
KANSAS CORPORATION COMMISSION

JUL 09 2008

CONSERVATION DIVISION  
WICHITA, KS

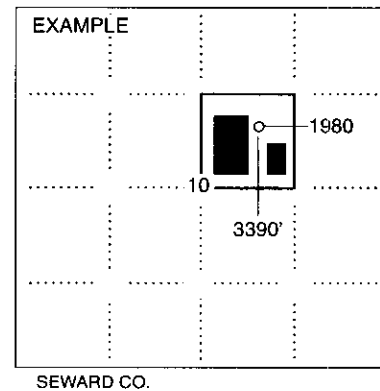

**In plotting the proposed location of the well, you must show:**

1. The manner in which you are using the depicted plat by identifying section lines, i.e. 1 section, 1 section with 8 surrounding sections, 4 sections, etc.
2. The distance of the proposed drilling location from the south / north and east / west outside section lines.
3. The distance to the nearest lease or unit boundary line (in footage).
4. If proposed location is located within a prorated or spaced field a certificate of acreage attribution plat must be attached: (CO-7 for oil wells; CG-8 for gas wells).

# PLAT AND CERTIFICATION OF ACREAGE ATTRIBUTABLE TO A GAS WELL

Kansas Corporation Commission, Conservation Division  
Finney State Office Building, 130 South Market, Room 2078  
Wichita, Kansas 67202

API NUMBER 15-081-21820-0000  
OPERATOR OXY USA Inc.  
LEASE Tiller  
WELL NUMBER 4-27  
FIELD Hugoton  
NUMBER OF ACRES ATTRIBUTABLE TO WELL 640  
QTR/QTR/QTR OF ACREAGE NE — SW — SW

LOCATION OF WELL: COUNTY Haskell  
1250 Feet from south / north line of section  
1250 Feet from east / west line of section  
SECTION 27 TWP 30 (S) RG 33 E / (W)  
IS SECTION X REGULAR or IRREGULAR  
IF SECTION IS IRREGULAR, LOCATE WELL FROM  
NEAREST CORNER BOUNDARY, (check line below)  
Section corner used: NE NW SE SW

(Show the location of the well and shade attributable acreage for prorated or spaced wells). (Show the footage to the nearest lease or unit boundary line; and show footage to the nearest common source supply well).

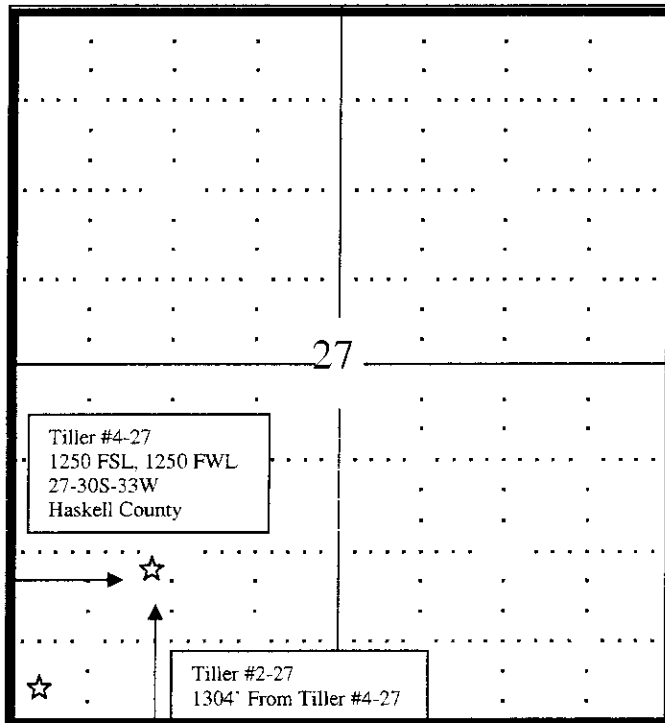

RECEIVED  
KANSAS CORPORATION COMMISSION  
JUL 09 2008  
CONSERVATION DIVISION  
WICHITA, KS

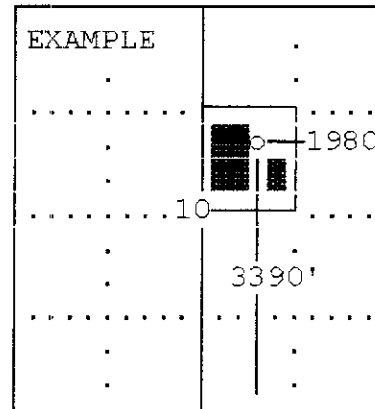

The undersigned hereby certifies as \_\_\_\_\_ Capital Assets \_\_\_\_\_ (title) for

OXY USA Inc. (Co.), a duly authorized agent, that all information shown hereon is true and correct to the best of my knowledge and belief, that all acreage claimed attributable to the well named herein is held by production from that well and hereby make application for an allowable to be assigned to the well upon the filing of this form and the State test, whichever is later.

Subscribed and sworn to before me on this 8th day of July, 2008

Signature [Signature]  
[Signature]  
Notary Public

My Commission expires November 8, 2010

FORM CG-8 (12/94)

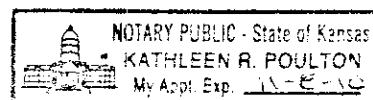

KANSAS CORPORATION COMMISSION  
OIL & GAS CONSERVATION DIVISION  
**APPLICATION FOR SURFACE PIT**

Form CDP-1  
April 2004  
Form must be Typed

*Submit in Duplicate*

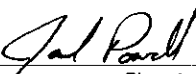
Operator Name: <b>OXY USA Inc.</b>		License Number: <b>5447</b>	
Operator Address: <b>P. O. Box 2528, Liberal, KS 67901</b>			
Contact Person: <b>Mike Fink</b>		Phone Number: ( <b>620</b> ) <b>624 - 3569</b>	
Lease Name & Well No.: <b>Tiller #4-27</b>		Pit Location (QQQQ): <b>NE NE SW SW</b> Sec. <b>27</b> Twp. <b>30S</b> R. <b>33</b> <input type="checkbox"/> East <input checked="" type="checkbox"/> West <b>1250</b> Feet from <input type="checkbox"/> North / <input checked="" type="checkbox"/> South Line of Section <b>1250</b> Feet from <input type="checkbox"/> East / <input checked="" type="checkbox"/> West Line of Section <b>Haskell</b> County	
Type of Pit: <input type="checkbox"/> Emergency Pit <input type="checkbox"/> Burn Pit <input type="checkbox"/> Settling Pit <input checked="" type="checkbox"/> Drilling Pit <input type="checkbox"/> Workover Pit <input type="checkbox"/> Haul-Off Pit <small>(If WP Supply API No. or Year Drilled)</small>	Pit is: <input checked="" type="checkbox"/> Proposed <input type="checkbox"/> Existing If Existing, date constructed: _____ Pit capacity: <b>16,000</b> (bbls)		
Is the pit located in a Sensitive Ground Water Area? <input type="checkbox"/> Yes <input checked="" type="checkbox"/> No		Chloride concentration: _____ mg/l <small>(For Emergency Pits and Settling Pits only)</small>	
Is the bottom below ground level? <input checked="" type="checkbox"/> Yes <input type="checkbox"/> No	Artificial Liner? <input type="checkbox"/> Yes <input checked="" type="checkbox"/> No	How is the pit lined if a plastic liner is not used? <b>Bentonite &amp; Cuttings</b>	
Pit dimensions (all but working pits): <b>150</b> Length (feet) <b>150</b> Width (feet) <b>N/A: Steel Pits</b> Depth from ground level to deepest point: <b>4</b> (feet)			
If the pit is lined give a brief description of the liner material, thickness and installation procedure.		Describe procedures for periodic maintenance and determining liner integrity, including any special monitoring.	
Distance to nearest water well within one-mile of pit <b>2727</b> feet    Depth of water well <b>460</b> feet		Depth to shallowest fresh water <b>273</b> feet. Source of information: _____ measured _____ well owner _____ electric log <b>(2) KDWR</b>	
<b>Emergency, Settling and Burn Pits ONLY:</b> Producing Formation: _____ Number of producing wells on lease: _____ Barrels of fluid produced daily: _____ Does the slope from the tank battery allow all spilled fluids to flow into the pit? <input type="checkbox"/> Yes <input type="checkbox"/> No		<b>Drilling, Workover and Haul-Off Pits ONLY:</b> Type of material utilized in drilling/workover: <b>Fresh Water Mud</b> Number of working pits to be utilized: <b>1</b> Abandonment procedure: <b>Evaporation and Backfill</b> Drill pits must be closed within 365 days of spud date.	
<div style="display: flex; justify-content: space-between;"> <div> <p>I hereby certify that the above statements are true and correct to the best of my knowledge and belief.</p> <p style="text-align: center;">07/08/08 Date</p> </div> <div style="text-align: center;">             Signature of Applicant or Agent         </div> <div style="text-align: right;"> <p><b>RECEIVED</b> KANSAS CORPORATION COMMISSION</p> <p><b>JUL 09 2008</b></p> </div> </div>			

**KCC OFFICE USE ONLY**

CONSERVATION DIVISION  
WICHITA, KS

Date Received: **7/9/08** Permit Number: \_\_\_\_\_ Permit Date: **7/9/08** Lease Inspection: ☐ Yes ☒ No

Mail to: KCC - Conservation Division, 130 S. Market - Room 2078, Wichita, Kansas 67202

15-081-21820-0000