

For KCC Use: 7-19-08
 Effective Date: _____
 District # 3
 SGA? Yes No

KANSAS CORPORATION COMMISSION
 OIL & GAS CONSERVATION DIVISION

Form C-1
 October 2007
 Form must be Typed
 Form must be Signed
 All blanks must be Filled

NOTICE OF INTENT TO DRILL

Must be approved by KCC five (5) days prior to commencing well

Expected Spud Date: July 12, 2008
 month day year

OPERATOR: License# 33344
 Name: Quest Cherokee, LLC
 Address 1: 210 W. Park Ave., Suite 2750
 Address 2: _____
 City: Oklahoma City State: OK Zip: 73102 + _____
 Contact Person: Richard Marlin
 Phone: 405-702-7480
 CONTRACTOR: License# 33837 or another Licensed by KCC
 Name: TXD Services LP

Well Drilled For: Oil Gas Enh Rec Storage Disposal Seismic; # of Holes _____ Other: Coalbed Methane
 Well Class: Infield Pool Ext. Wildcat Other _____
 Type Equipment: Mud Rotary Air Rotary Cable
 If OWWO: old well information as follows:
 Operator: _____
 Well Name: _____
 Original Completion Date: _____ Original Total Depth: _____

Directional, Deviated or Horizontal wellbore? Yes No
 If Yes, true vertical depth: _____
 Bottom Hole Location: _____
 KCC DKT #: _____

Spot Description: _____
 _____ SW NE Sec. 29 Twp. 28 S. R. 19 E W
 (100/100) 1,980 feet from N / S Line of Section
 1,980 feet from E / W Line of Section
 Is SECTION: Regular Irregular?

(Note: Locate well on the Section Plat on reverse side)
 County: Neosho
 Lease Name: Shaw, George A. Well #: 29-3
 Field Name: Cherokee Basin CBM
 Is this a Prorated / Spaced Field? Yes No
 Target Formation(s): Cherokee Coals
 Nearest Lease or unit boundary line (in footage): 660
 Ground Surface Elevation: 925 feet MSL
 Water well within one-quarter mile: Yes No
 Public water supply well within one mile: Yes No
 Depth to bottom of fresh water: 100
 Depth to bottom of usable water: 150
 Surface Pipe by Alternate: I II
 Length of Surface Pipe Planned to be set: 25
 Length of Conductor Pipe (if any): _____
 Projected Total Depth: 1500
 Formation at Total Depth: Cherokee Coals
 Water Source for Drilling Operations: Well Farm Pond Other: Air
 DWR Permit #: _____ (Note: Apply for Permit with DWR)
 Will Cores be taken? Yes No
 If Yes, proposed zone: _____

AFFIDAVIT

RECEIVED
 KANSAS CORPORATION COMMISSION

JUL 10 2008

CONSERVATION DIVISION
 WICHITA, KS

The undersigned hereby affirms that the drilling, completion and eventual plugging of this well will comply with K.S.A. 55 et. seq.
 It is agreed that the following minimum requirements will be met:

1. Notify the appropriate district office **prior** to spudding of well;
2. A copy of the approved notice of intent to drill **shall be** posted on each drilling rig;
3. The minimum amount of surface pipe as specified below **shall be set** by circulating cement to the top; in all cases surface pipe shall be set through all unconsolidated materials plus a minimum of 20 feet into the underlying formation.
4. If the well is dry hole, an agreement between the operator and the district office on plug length and placement is necessary **prior to plugging**;
5. The appropriate district office will be notified before well is either plugged or production casing is cemented in;
6. If an ALTERNATE II COMPLETION, production pipe shall be cemented from below any usable water to surface within **120 DAYS** of spud date. Or pursuant to Appendix "B" - Eastern Kansas surface casing order #133,891-C, which applies to the KCC District 3 area, alternate II cementing must be completed within 30 days of the spud date or the well shall be plugged. **In all cases, NOTIFY district office** prior to any cementing.

I hereby certify that the statements made herein are true and correct to the best of my knowledge and belief.

Date: July 7, 2008 Signature of Operator or Agent: Richard Marlin Title: Vice President

For KCC Use ONLY
 API # 15 - 133-27484-0000
 Conductor pipe required None feet
 Minimum surface pipe required 20 feet per ALT. I II
 Approved by: 7-14-08
 This authorization expires: 7-14-09
 (This authorization void if drilling not started within 12 months of approval date.)
 Spud date: _____ Agent: _____

Remember to:

- File Drill Pit Application (form CDP-1) with Intent to Drill;
- File Completion Form ACO-1 within 120 days of spud date;
- File acreage attribution plat according to field proration orders;
- Notify appropriate district office 48 hours prior to workover or re-entry;
- Submit plugging report (CP-4) after plugging is completed (within 60 days);
- Obtain written approval before disposing or injecting salt water.
- If this permit has expired (See: authorized expiration date) please check the box below and return to the address below.

Well Not Drilled - Permit Expired Date: _____
 Signature of Operator or Agent: _____

29
28
19
 E W

IN ALL CASES PLOT THE INTENDED WELL ON THE PLAT BELOW

Plat of acreage attributable to a well in a prorated or spaced field

If the intended well is in a prorated or spaced field, please fully complete this side of the form. If the intended well is in a prorated or spaced field complete the plat below showing that the well will be properly located in relationship to other wells producing from the common source of supply. Please show all the wells and within 1 mile of the boundaries of the proposed acreage attribution unit for gas wells and within 1/2 mile of the boundaries of the proposed acreage attribution unit for oil wells.

API No. 15 - 133-27484-0000
Operator: Quest Cherokee, LLC
Lease: Shaw, George A.
Well Number: 29-3
Field: Cherokee Basin CBM

Location of Well: County: Neosho
1,980 feet from N / S Line of Section
1,980 feet from E / W Line of Section
Sec. 29 Twp. 28 S. R. 19 E W

Number of Acres attributable to well: _____
QTR/QTR/QTR/QTR of acreage: _____ - _____ - SW - NE

Is Section: Regular or Irregular

If Section is Irregular, locate well from nearest corner boundary.

Section corner used: NE NW SE SW

PLAT

(Show location of the well and shade attributable acreage for prorated or spaced wells.)

(Show footage to the nearest lease or unit boundary line.)

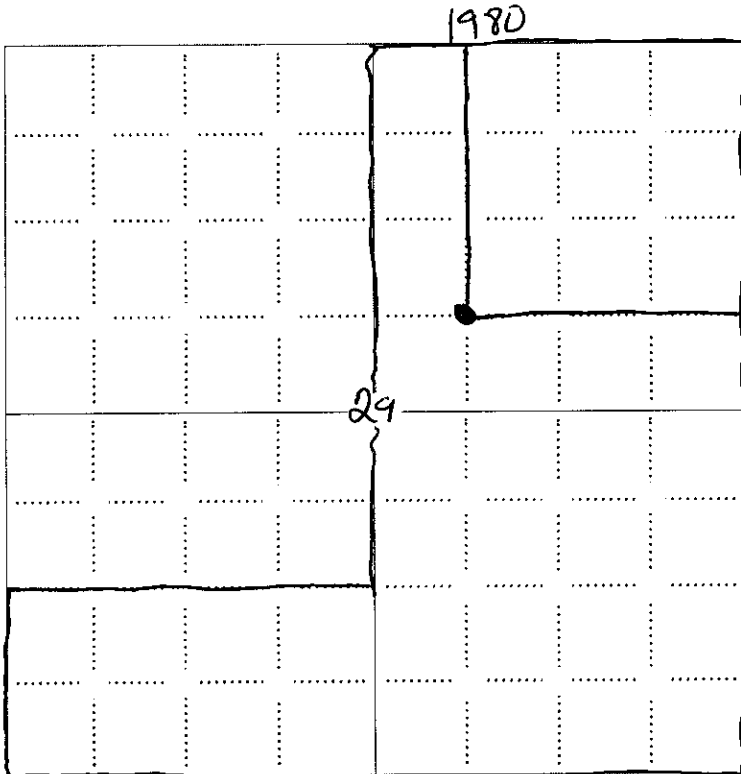

RECEIVED
KANSAS CORPORATION COMMISSION

JUL 10 2008

CONSERVATION DIVISION
WICHITA, KS

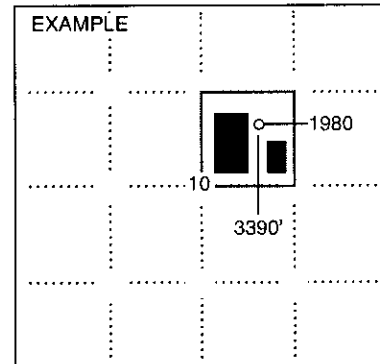

SEWARD CO.

NOTE: In all cases locate the spot of the proposed drilling location.

In plotting the proposed location of the well, you must show:

1. The manner in which you are using the depicted plat by identifying section lines, i.e. 1 section, 1 section with 8 surrounding sections, 4 sections, etc.
2. The distance of the proposed drilling location from the south / north and east / west outside section lines.
3. The distance to the nearest lease or unit boundary line (in footage).
4. If proposed location is located within a prorated or spaced field a certificate of acreage attribution plat must be attached: (CO-7 for oil wells; CG-8 for gas wells).

**KANSAS CORPORATION COMMISSION
OIL & GAS CONSERVATION DIVISION
APPLICATION FOR SURFACE PIT**

Form CDP-1
April 2004
Form must be Typed

Submit in Duplicate

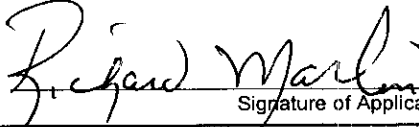
Operator Name: Quest Cherokee, LLC		License Number: 33344
Operator Address: 210 W. Park Ave., Suite 2750		Oklahoma City OK 73102
Contact Person: Richard Marlin		Phone Number: 405-702-7480
Lease Name & Well No.: Shaw, George A. 29-3		Pit Location (QQQQ): _____ SW _____ NE
Type of Pit: <input type="checkbox"/> Emergency Pit <input type="checkbox"/> Burn Pit <input type="checkbox"/> Settling Pit <input checked="" type="checkbox"/> Drilling Pit <input type="checkbox"/> Workover Pit <input type="checkbox"/> Haul-Off Pit <small>(If WP Supply API No. or Year Drilled)</small>	Pit is: <input checked="" type="checkbox"/> Proposed <input type="checkbox"/> Existing If Existing, date constructed: _____ Pit capacity: 300 (bbls)	Sec. 29 Twp. 28 R. 19 <input checked="" type="checkbox"/> East <input type="checkbox"/> West 1,980 Feet from <input checked="" type="checkbox"/> North / <input type="checkbox"/> South Line of Section 1,980 Feet from <input checked="" type="checkbox"/> East / <input type="checkbox"/> West Line of Section Neosho County
Is the pit located in a Sensitive Ground Water Area? <input checked="" type="checkbox"/> Yes <input checked="" type="checkbox"/> No		Chloride concentration: _____ mg/l <small>(For Emergency Pits and Settling Pits only)</small>
Is the bottom below ground level? <input checked="" type="checkbox"/> Yes <input type="checkbox"/> No	Artificial Liner? <input type="checkbox"/> Yes <input checked="" type="checkbox"/> No	How is the pit lined if a plastic liner is not used? Air Drilling Well Native Soil (AB)
Pit dimensions (all but working pits): _____ Length (feet) _____ Width (feet) _____ Depth from ground level to deepest point: _____ (feet)		<input type="checkbox"/> N/A: Steel Pits <input type="checkbox"/> No Pit
If the pit is lined give a brief description of the liner material, thickness and installation procedure. Well is being air drilled.		Describe procedures for periodic maintenance and determining liner integrity, including any special monitoring. Well is being air drilled with operations lasting approx. 3 days
Distance to nearest water well within one-mile of pit _____ NA / feet Depth of water well _____ feet	Depth to shallowest fresh water _____ feet. Source of information: <input type="checkbox"/> measured <input type="checkbox"/> well owner <input type="checkbox"/> electric log <input type="checkbox"/> KDWR	RECEIVED KANSAS CORPORATION COMMISSION JUL 10 2008 CONSERVATION DIVISION WICHITA, KS
Emergency, Settling and Burn Pits ONLY: Producing Formation: _____ Number of producing wells on lease: _____ Barrels of fluid produced daily: _____ Does the slope from the tank battery allow all spilled fluids to flow into the pit? <input type="checkbox"/> Yes <input type="checkbox"/> No	Drilling, Workover and Haul-Off Pits ONLY: Type of material utilized in drilling/workover: Air Drilled Number of working pits to be utilized: 1 Abandonment procedure: Air Dry, Back fill and cover. Drill pits must be closed within 365 days of spud date.	
I hereby certify that the above statements are true and correct to the best of my knowledge and belief.		
July 7, 2008 Date	 Signature of Applicant or Agent	
KCC OFFICE USE ONLY		
Date Received: <u>7/10/08</u> Permit Number: _____ Permit Date: <u>7/11/08</u> Lease Inspection: <input checked="" type="checkbox"/> Yes <input type="checkbox"/> No	Steel Pit <input type="checkbox"/> RFAC <input checked="" type="checkbox"/> RFAS <input type="checkbox"/>	

15733-27484-0000



Kathleen Sebelius, Governor
Thomas E. Wright, Chairman
Michael C. Moffet, Commissioner
Joseph F. Harkins, Commissioner

July 11, 2008

Richard Marlin
Quest Cherokee, LLC
210 W. Park Ave Ste 2750
Oklahoma City, OK 73102

RE: Drilling Pit Application
Shaw, George A Lease Well No. 29-3
NE/4 Sec. 29-28S-19E
Neosho County, Kansas

Dear Mr. Marlin:

District staff has inspected the above referenced location and has determined that the reserve pit shall be constructed **without slots**, the bottom shall be flat and reasonably level, and the free fluids must be removed. The fluids are to be removed from the reserve pit as soon as practical after drilling operations have ceased.

If production casing is set all completion fluids shall be removed from the working pits daily. NO completion fluids or non-exempt wastes shall be placed in the reserve pit.

The fluids should be taken to an authorized disposal well. Please call the District Office at (620) 432-2300 when the fluids have been removed. Please file form CDP-5 (August 2004), Exploration and Production Waste Transfer, within 30 days of fluid removal. Conservation division forms are available through our office and on the KCC web site:
www.kcc.state.ks.us/conservation/forms.

A copy of this letter should be posted in the doghouse along with the approved Intent to Drill.

If you have any questions or concerns please feel free to contact the undersigned at the above address.

Sincerely,

Kathy Haynes
Environmental Protection and Remediation Department

cc: File