

For KCC Use: **7-2008**  
 Effective Date: **2**  
 District # **2**  
 SGA?  Yes  No

KANSAS CORPORATION COMMISSION  
 OIL & GAS CONSERVATION DIVISION

Form C-1  
 October 2007  
 Form must be Typed  
 Form must be Signed  
 All blanks must be Filled

**NOTICE OF INTENT TO DRILL**

Must be approved by KCC five (5) days prior to commencing well

Expected Spud Date: **7/20/2008**  
 month day year

Spot Description: 160' S  
 W/2 - E/2 - NE/4 - Sec. 18 Twp. 17 S. R. 10  E  W  
 1,480 feet from  N /  S Line of Section  
 990 feet from  E /  W Line of Section

OPERATOR: License# **33186**  
 Name: LB Exploration, Inc.  
 Address 1: 2135 2nd Road  
 Address 2:  
 City: Holyrood State: KS Zip: 67450  
 Contact Person: Michael Petermann  
 Phone: 785-252-8034

Is SECTION:  Regular  Irregular?  
 (Note: Locate well on the Section Plat on reverse side)

CONTRACTOR: License# **33905**  
 Name: Royal Drilling, Inc.

County: Ellsworth  
 Lease Name: Kootz 18 Well #: 1  
 Field Name: Kraft-Prusa

Well Drilled For:  Oil  Gas  Seismic  Other  
 Enh Rec  Storage  Disposal  
 # of Holes  
 Well Class:  Infield  Pool Ext.  Wildcat  Other  
 Type Equipment:  Mud Rotary  Air Rotary  Cable

Is this a Prorated / Spaced Field?  Yes  No  
 Target Formation(s): Arbuckle  
 Nearest Lease or unit boundary line (in footage): 330'  
 Ground Surface Elevation: 1841 feet MSL  
 Water well within one-quarter mile:  Yes  No  
 Public water supply well within one mile:  Yes  No  
 Depth to bottom of fresh water: 100  
 Depth to bottom of usable water: 320  
 Surface Pipe by Alternate:  I  II  
 Length of Surface Pipe Planned to be set: approx. 640'

Operator:  
 Well Name:  
 Original Completion Date: Original Total Depth:

Length of Conductor Pipe (if any):  
 Projected Total Depth: 3350'  
 Formation at Total Depth: Arbuckle

Directional, Deviated or Horizontal wellbore?  Yes  No  
 If Yes, true vertical depth:  
 Bottom Hole Location:  
 KCC DKT #:

Water Source for Drilling Operations:  
 Well  Farm Pond  Other:  
 DWR Permit #:  
 (Note: Apply for Permit with DWR)  
 Will Cores be taken?  Yes  No  
 If Yes, proposed zone:

**AFFIDAVIT**

RECEIVED  
 KANSAS CORPORATION COMMISSION

The undersigned hereby affirms that the drilling, completion and eventual plugging of this well will comply with K.S.A. 55 et. seq.  
 It is agreed that the following minimum requirements will be met:

**JUL 14 2008**

1. Notify the appropriate district office **prior** to spudding of well;
2. A copy of the approved notice of intent to drill **shall be** posted on each drilling rig;
3. The minimum amount of surface pipe as specified below **shall be set** by circulating cement to the top; in all cases surface pipe **shall be** through all unconsolidated materials plus a minimum of 20 feet into the underlying formation.
4. If the well is dry hole, an agreement between the operator and the district office on plug length and placement is necessary **prior to plugging**;
5. The appropriate district office will be notified before well is either plugged or production casing is cemented in;
6. If an ALTERNATE II COMPLETION, production pipe shall be cemented from below any usable water to surface within **120 DAYS** of spud date. Or pursuant to Appendix "B" - Eastern Kansas surface casing order #133,891-C, which applies to the KCC District 3 area, alternate II cementing must be completed within 30 days of the spud date or the well shall be plugged. **In all cases, NOTIFY district office** prior to any cementing.

CONSERVATION DIVISION  
 WICHITA, KS

I hereby certify that the statements made herein are true and correct to the best of my knowledge and belief.

Date: **7/11/2008** Signature of Operator or Agent: *Michael Petermann* Title: **President**

**For KCC Use ONLY**  
 API # 15 - **053-21224-0000**  
 Conductor pipe required: **None** feet  
 Minimum surface pipe required: **340** feet per ALT.  I  II  
 Approved by: **RUA 7-15-08**  
 This authorization expires: **7-15-09**  
 (This authorization void if drilling not started within 12 months of approval date.)  
 Spud date: Agent:

**Remember to:**

- File Drill Pit Application (form CDP-1) with Intent to Drill;
- File Completion Form ACO-1 within 120 days of spud date;
- File acreage attribution plat according to field proration orders;
- Notify appropriate district office 48 hours prior to workover or re-entry;
- Submit plugging report (CP-4) after plugging is completed (within 60 days);
- Obtain written approval before disposing or injecting salt water.
- If this permit has expired (See: authorized expiration date) please check the box below and return to the address below.

Well Not Drilled - Permit Expired Date:  
 Signature of Operator or Agent:

18  
 17  
 10  
 E  
 W

**IN ALL CASES PLOT THE INTENDED WELL ON THE PLAT BELOW**

*Plat of acreage attributable to a well in a prorated or spaced field*

**If the intended well is in a prorated or spaced field, please fully complete this side of the form.** If the intended well is in a prorated or spaced field complete the plat below showing that the well will be properly located in relationship to other wells producing from the common source of supply. Please show all the wells and within 1 mile of the boundaries of the proposed acreage attribution unit for gas wells and within 1/2 mile of the boundaries of the proposed acreage attribution unit for oil wells.

API No. 15 - 053-21224-0000  
Operator: LB Exploration, Inc.  
Lease: Kootz 18  
Well Number: 1  
Field: Kraft-Prusa

Location of Well: County: Ellsworth  
1,480 feet from  N /  S Line of Section  
990 feet from  E /  W Line of Section  
Sec. 18 Twp. 17 S. R. 10  E  W

Number of Acres attributable to well: \_\_\_\_\_  
QTR/QTR/QTR/QTR of acreage:  W/2  E/2  NE/4

Is Section:  Regular or  Irregular

**If Section is Irregular, locate well from nearest corner boundary.**

Section corner used:  NE  NW  SE  SW

**PLAT**

*(Show location of the well and shade attributable acreage for prorated or spaced wells.)*

*(Show footage to the nearest lease or unit boundary line.)*

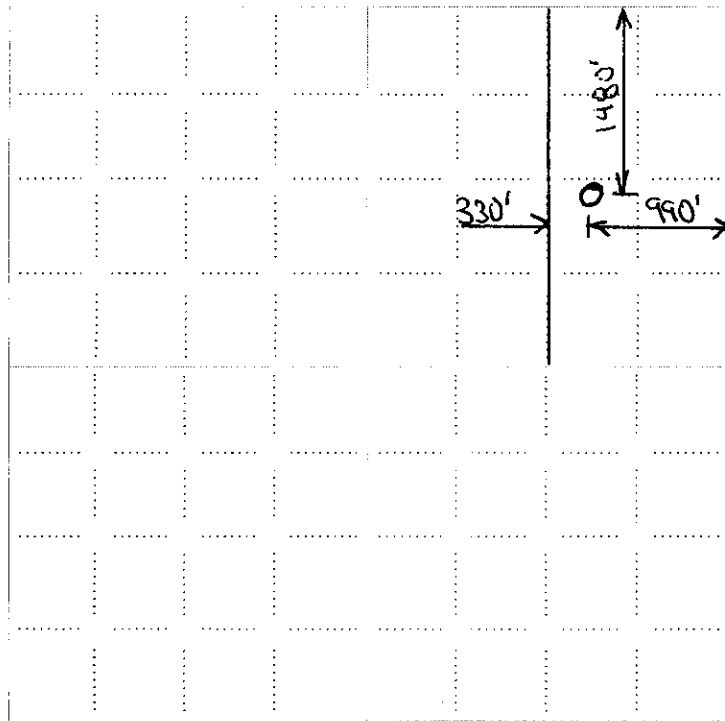

**NOTE: In all cases locate the spot of the proposed drilling locaton.**

RECEIVED  
KANSAS CORPORATION COMMISSION

JUL 14 2008

CONSERVATION DIVISION  
WICHITA, KS

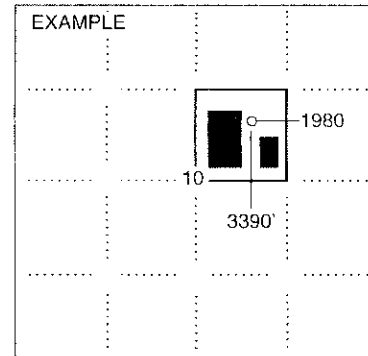

SEWARD CO.

**In plotting the proposed location of the well, you must show:**

1. The manner in which you are using the depicted plat by identifying section lines, i.e. 1 section, 1 section with 8 surrounding sections, 4 sections, etc.
2. The distance of the proposed drilling location from the south / north and east / west outside section lines.
3. The distance to the nearest lease or unit boundary line (in footage).
4. If proposed location is located within a prorated or spaced field a certificate of acreage attribution plat must be attached: (CO-7 for oil wells; CG-8 for gas wells).

**KANSAS CORPORATION COMMISSION  
OIL & GAS CONSERVATION DIVISION  
APPLICATION FOR SURFACE PIT**

Form CDP-1  
April 2004  
Form must be Typed

*Submit in Duplicate*

Operator Name: <b>LB Exploration, Inc.</b>		License Number: <b>33186</b>	
Operator Address: <b>2135 2nd Road</b>		<b>Holyrood KS 67450</b>	
Contact Person: <b>Michael Petermann</b>		Phone Number: <b>785-252-8034</b>	
Lease Name & Well No.: <b>Kootz 18 1</b>		Pit Location (QQQQ): <b>160'S W/2 E/2 NE/4</b>	
Type of Pit: <input type="checkbox"/> Emergency Pit <input type="checkbox"/> Burn Pit <input type="checkbox"/> Settling Pit <input checked="" type="checkbox"/> Drilling Pit <input type="checkbox"/> Workover Pit <input type="checkbox"/> Haul-Off Pit <small>(If WP Supply API No. or Year Drilled)</small>	Pit is: <input checked="" type="checkbox"/> Proposed <input type="checkbox"/> Existing If Existing, date constructed:  Pit capacity: <b>400</b> (bbls)	Sec. <b>18</b> Twp. <b>17</b> R. <b>10</b> <input type="checkbox"/> East <input checked="" type="checkbox"/> West 1,480 Feet from <input checked="" type="checkbox"/> North / <input type="checkbox"/> South Line of Section 990 Feet from <input checked="" type="checkbox"/> East / <input type="checkbox"/> West Line of Section <b>Ellsworth</b> County	
Is the pit located in a Sensitive Ground Water Area? <input type="checkbox"/> Yes <input checked="" type="checkbox"/> No		Chloride concentration: _____ mg/l <small>(For Emergency Pits and Settling Pits only)</small>	
Is the bottom below ground level? <input checked="" type="checkbox"/> Yes <input type="checkbox"/> No	Artificial Liner? <input type="checkbox"/> Yes <input checked="" type="checkbox"/> No	How is the pit lined if a plastic liner is not used? <b>Native Mud</b>	
Pit dimensions (all but working pits): <b>80</b> Length (feet) <b>80</b> Width (feet) <input type="checkbox"/> N/A: Steel Pits		Depth from ground level to deepest point: <b>6</b> (feet) <input type="checkbox"/> No Pit	
If the pit is lined give a brief description of the liner material, thickness and installation procedure.		Describe procedures for periodic maintenance and determining liner integrity, including any special monitoring.	
Distance to nearest water well within one-mile of pit <b>4,623</b> feet    Depth of water well <b>85</b> feet <b>190</b> feet		Depth to shallowest fresh water <b>40</b> feet. Source of information: <input type="checkbox"/> measured <input type="checkbox"/> well owner <input type="checkbox"/> electric log <input checked="" type="checkbox"/> KDWR	
<b>Emergency, Settling and Burn Pits ONLY:</b> Producing Formation: _____ Number of producing wells on lease: _____ Barrels of fluid produced daily: _____ Does the slope from the tank battery allow all spilled fluids to flow into the pit? <input type="checkbox"/> Yes <input type="checkbox"/> No		<b>Drilling, Workover and Haul-Off Pits ONLY:</b> Type of material utilized in drilling/workover: <b>Fresh mud</b> Number of working pits to be utilized: <b>3</b> Abandonment procedure: <b>Evaporate and backfill</b>  Drill pits must be closed within 365 days of spud date.	
I hereby certify that the above statements are true and correct to the best of my knowledge and belief.			
Date: <b>7/11/08</b>		Signature of Applicant or Agent: 	
RECEIVED KANSAS CORPORATION COMMISSION <b>JUL 14 2008</b> CONSERVATION DIVISION WICHITA, KS			
<b>KCC OFFICE USE ONLY</b>			
Date Received: <b>7/14/08</b> Permit Number: _____		Steel Pit <input type="checkbox"/> RFAC <input type="checkbox"/> RFAS <input type="checkbox"/>	
Permit Date: <b>7/14/08</b> Lease Inspection: <input type="checkbox"/> Yes <input checked="" type="checkbox"/> No			

15-053-2124-0000