

For KCC Use:

Effective Date: 7-23-08District #: 3
SGA? ☐ Yes ☒ NoKANSAS CORPORATION COMMISSION
OIL & GAS CONSERVATION DIVISIONForm C-1
October 2007Form must be Typed
Form must be Signed
All blanks must be Filled

NOTICE OF INTENT TO DRILL

Must be approved by KCC five (5) days prior to commencing well

Expected Spud Date: August 1, 2008
month day yearOPERATOR: License# 33927 ✓
Name: MegaWest Energy Kansas Corp
Address 1: PO Box 149
Address 2: _____
City: Chetopa State: KS Zip: 67336 + _____
Contact Person: Rick Richelhoff
Phone: 403-971-0800CONTRACTOR: License# 33803 ✓
Name: Drilling USA, INC Mitchell Drilling USA, IncWell Drilled For: ☒ Oil ☐ Gas ☐ Enh Rec ☐ Storage ☐ Disposal ☐ Seismic; # of Holes _____
Other: _____
Well Class: ☐ Infield ☒ Pool Ext. ☐ Wildcat ☐ Other _____
Type Equipment: ☐ Mud Rotary ☒ Air Rotary ☐ Cable☐ If OWWO: old well information as follows:Operator: _____
Well Name: _____
Original Completion Date: _____ Original Total Depth: _____Directional, Deviated or Horizontal wellbore? ☐ Yes ☒ No

If Yes, true vertical depth: _____

Bottom Hole Location: _____

KCC DKT #: _____

Spot Description: _____
NE NW NE Sec. 10 Twp. 35 S. R. 21 ☒ E ☐ W
(0/0/0) 280 feet from ☒ N ☐ S Line of Section
1,720 feet from ☒ E ☐ W Line of SectionIs SECTION: ☒ Regular ☐ Irregular?

(Note: Locate well on the Section Plat on reverse side)

County: LabetteLease Name: Barr Well #: Barr MW 9Field Name: ChetopaIs this a Prorated / Spaced Field? ☐ Yes ☒ NoTarget Formation(s): Bartlesville ✓Nearest Lease or unit boundary line (in footage): 375 ✓Ground Surface Elevation: 800 feet MSLWater well within one-quarter mile: ☐ Yes ☒ No ✓Public water supply well within one mile: ☐ Yes ☒ NoDepth to bottom of fresh water: 50Depth to bottom of usable water: 100Surface Pipe by Alternate: ☐ I ☒ IILength of Surface Pipe Planned to be set: 20

Length of Conductor Pipe (if any): _____

Projected Total Depth: 140Formation at Total Depth: Bartlesville ✓

Water Source for Drilling Operations:

☐ Well ☐ Farm Pond ☒ Other: Air Rotary ✓

DWR Permit #: _____

(Note: Apply for Permit with DWR ☐)Will Cores be taken? ☐ Yes ☒ No

If Yes, proposed zone: _____

AFFIDAVIT

RECEIVED
KANSAS CORPORATION COMMISSION

JUL 18 2008

CONSERVATION DIVISION
WICHITA, KS

The undersigned hereby affirms that the drilling, completion and eventual plugging of this well will comply with K.S.A. 55 et. seq.

It is agreed that the following minimum requirements will be met:

1. Notify the appropriate district office **prior** to spudding of well;
2. A copy of the approved notice of intent to drill **shall be** posted on each drilling rig;
3. The minimum amount of surface pipe as specified below **shall be set** by circulating cement to the top; in all cases surface pipe **shall be set** through all unconsolidated materials plus a minimum of 20 feet into the underlying formation.
4. If the well is dry hole, an agreement between the operator and the district office on plug length and placement is necessary **prior to plugging**;
5. The appropriate district office will be notified before well is either plugged or production casing is cemented in;
6. If an ALTERNATE II COMPLETION, production pipe shall be cemented from below any usable water to surface within **120 DAYS** of spud date. Or pursuant to Appendix "B" - Eastern Kansas surface casing order #133,891-C, which applies to the KCC District 3 area, alternate II cementing must be completed within 30 days of the spud date or the well shall be plugged. **In all cases, NOTIFY district office** prior to any cementing.

I hereby certify that the statements made herein are true and correct to the best of my knowledge and belief.

Date: July 14, 2008 Signature of Operator or Agent: _____ Title: Production Technologist

For KCC Use ONLY

API # 15 - 099-24503-0000Conductor pipe required None feetMinimum surface pipe required 20 feet per ALT. ☐ I ☒ IIApproved by: RM 7-18-08This authorization expires: 7-18-09

(This authorization void if drilling not started within 12 months of approval date.)

Spud date: _____ Agent: _____

Remember to:

- File Drill Pit Application (form CDP-1) with Intent to Drill;
- File Completion Form ACO-1 within 120 days of spud date;
- File acreage attribution plat according to field proration orders;
- Notify appropriate district office 48 hours prior to workover or re-entry;
- Submit plugging report (CP-4) after plugging is completed (within 60 days);
- Obtain written approval before disposing or injecting salt water.
- If this permit has expired (See: authorized expiration date) please check the box below and return to the address below.

☐ Well Not Drilled - Permit Expired Date: _____
Signature of Operator or Agent: _____10 35 21 ☒ E ☐ W

Mail to: KCC - Conservation Division, 130 S. Market - Room 2073, Wichita, Kansas 67202

IN ALL CASES PLOT THE INTENDED WELL ON THE PLAT BELOW*Plat of acreage attributable to a well in a prorated or spaced field*

If the intended well is in a prorated or spaced field, please fully complete this side of the form. If the intended well is in a prorated or spaced field complete the plat below showing that the well will be properly located in relationship to other wells producing from the common source of supply. Please show all the wells and within 1 mile of the boundaries of the proposed acreage attribution unit for gas wells and within 1/2 mile of the boundaries of the proposed acreage attribution unit for oil wells.

API No. 15 - 099-24503-0000Operator: MegaWest Energy Kansas CorpLease: BarrWell Number: Barr MW 9Field: Chetopa

Number of Acres attributable to well: _____

QTR/QTR/QTR/QTR of acreage: _____ - NE - NW - NE

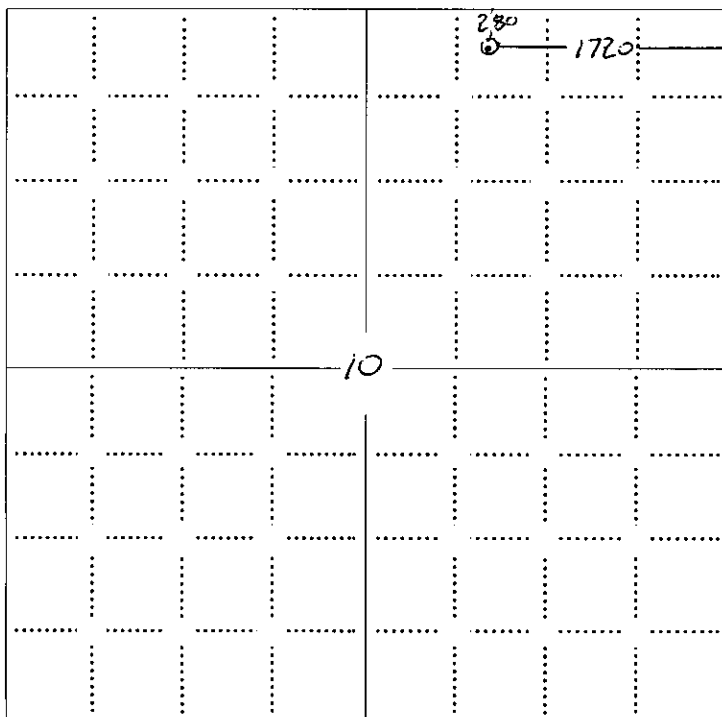
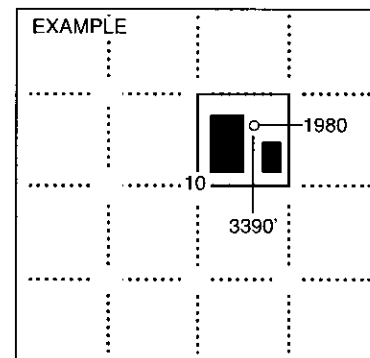
Location of Well: County: Labette280 feet from ☒ N / ☐ S Line of Section1,720 feet from ☒ E / ☐ W Line of SectionSec. 10 Twp. 35 S. R. 21 ☒ E ☐ WIs Section: ☒ Regular or ☐ Irregular**If Section Is Irregular, locate well from nearest corner boundary.**Section corner used: ☐ NE ☐ NW ☐ SE ☐ SW**PLAT***(Show location of the well and shade attributable acreage for prorated or spaced wells.)**(Show footage to the nearest lease or unit boundary line.)*RECEIVED
KANSAS CORPORATION COMMISSION**JUL 18 2008**CONSERVATION DIVISION
WICHITA, KS

SEWARD CO.

NOTE: In all cases locate the spot of the proposed drilling location.**In plotting the proposed location of the well, you must show:**

1. The manner in which you are using the depicted plat by identifying section lines, i.e. 1 section, 1 section with 8 surrounding sections, 4 sections, etc.
2. The distance of the proposed drilling location from the south / north and east / west outside section lines.
3. The distance to the nearest lease or unit boundary line (in footage).
4. If proposed location is located within a prorated or spaced field a certificate of acreage attribution plat must be attached: (CO-7 for oil wells; CG-8 for gas wells).

**KANSAS CORPORATION COMMISSION
OIL & GAS CONSERVATION DIVISION
APPLICATION FOR SURFACE PIT**

Form GDP-1
April 2004
Form must be Typed

Submit in Duplicate

Operator Name: MegaWest Energy Kansas Corp		License Number: 33927	
Operator Address: PO Box 149, Chetopa, KS 67336			
Contact Person: Rick Richelhoff		Phone Number: 403-971-0800	
Lease Name & Well No.: Barr MW 9		Pit Location (QQQQ): - <u>NE</u> - <u>NW</u> - <u>NE</u> Sec. <u>10</u> Twp. <u>35</u> R. <u>21</u> <input checked="" type="checkbox"/> East <input type="checkbox"/> West <u>280</u> Feet from <input checked="" type="checkbox"/> North / <input type="checkbox"/> South Line of Section <u>1,720</u> Feet from <input checked="" type="checkbox"/> East / <input type="checkbox"/> West Line of Section <u>Labette</u> County	
Type of Pit: <input type="checkbox"/> Emergency Pit <input type="checkbox"/> Burn Pit <input type="checkbox"/> Settling Pit <input checked="" type="checkbox"/> Drilling Pit <input type="checkbox"/> Workover Pit <input type="checkbox"/> Haul-Off Pit <small>(If WP Supply API No. or Year Drilled)</small>		Pit is: <input checked="" type="checkbox"/> Proposed <input type="checkbox"/> Existing If Existing, date constructed: _____ Pit capacity: _____ (bbls)	
Is the pit located in a Sensitive Ground Water Area? <input type="checkbox"/> Yes <input checked="" type="checkbox"/> No		Chloride concentration: _____ mg/l <small>(For Emergency Pits and Settling Pits only)</small>	
Is the bottom below ground level? <input type="checkbox"/> Yes <input checked="" type="checkbox"/> No		Artificial Liner? <input type="checkbox"/> Yes <input checked="" type="checkbox"/> No	
How is the pit lined if a plastic liner is not used?			
Pit dimensions (all but working pits): _____ Length (feet) _____ Width (feet) <input type="checkbox"/> N/A: Steel Pits Depth from ground level to deepest point: _____ (feet) <input checked="" type="checkbox"/> No Pit			
If the pit is lined give a brief description of the liner material, thickness and installation procedure.		Describe procedures for periodic maintenance and determining liner integrity, including any special monitoring. No pit will be constructed	
Distance to nearest water well within one-mile of pit NA feet Depth of water well _____ feet		Depth to shallowest fresh water <u>50</u> feet. Source of information: <input type="checkbox"/> measured <input type="checkbox"/> well owner <input checked="" type="checkbox"/> electric log <input type="checkbox"/> KDWR	
Emergency, Settling and Burn Pits ONLY: Producing Formation: _____ Number of producing wells on lease: _____ Barrels of fluid produced daily: _____ Does the slope from the tank battery allow all spilled fluids to flow into the pit? <input type="checkbox"/> Yes <input type="checkbox"/> No		Drilling, Workover and Haul-Off Pits ONLY: Type of material utilized in drilling/workover: _____ Number of working pits to be utilized: _____ Abandonment procedure: No Pit Drill pits must be closed within 365 days of spud date.	
I hereby certify that the above statements are true and correct to the best of my knowledge and belief. <div style="display: flex; justify-content: space-between;"> <div> July 14, 2008 Date </div> <div> Signature of Applicant or Agent </div> </div>			
<div style="display: flex; justify-content: space-between;"> <div> KCC OFFICE USE ONLY Date Received: <u>7/18/08</u> Permit Number: _____ Permit Date: <u>7/18/08</u> Lease Inspection: <input type="checkbox"/> Yes <input type="checkbox"/> No </div> <div> Steel Pit <input type="checkbox"/> RFAC <input type="checkbox"/> RFAS <input type="checkbox"/> NO PIT </div> </div>			

Mail to: KCC - Conservation Division, 130 S. Market - Room 2078, Wichita, Kansas 67202

15099-24503-0000

RECEIVED
KANSAS CORPORATION COMMISSION
JUL 18 2008
CONSERVATION DIVISION
WICHITA, KS