

\* 7-21-08

**CORRECTED**

\* Correction to Lease Name

For KCC Use:  
Effective Date: 6-24-08  
District # \_\_\_\_\_  
SGA?  Yes  No

**KANSAS CORPORATION COMMISSION  
OIL & GAS CONSERVATION DIVISION**

Form C-1  
October 2007  
Form must be Typed  
Form must be Signed  
All blanks must be Filled

**NOTICE OF INTENT TO DRILL**

Must be approved by KCC five (5) days prior to commencing well

Expected Spud Date: June 16, 2008  
month day year

OPERATOR: License# 34110  
Name: Teton North America LLC  
Address 1: P.O. Box 1378  
Address 2: \_\_\_\_\_  
City: Hays State: KS Zip: 67601 + \_\_\_\_\_  
Contact Person: Brian Karlin  
Phone: 785-623-3290  
CONTRACTOR: License# 5142  
Name: Sterling Drilling Company

Spot Description: 120' South & 30' West of  
C 22 Sec. 22 Twp. 17 S. R. 13  E  W  
1,960 feet from  N /  S Line of Section  
1,350 feet from  E /  W Line of Section

Is SECTION:  Regular  Irregular?  
(Note: Locate well on the Section Plat on reverse side)

County: Barton  
Lease Name: Hoffman-Ochs Well #: 1-22  
Field Name: TRAPP

Is this a Prorated / Spaced Field?  Yes  No  
Target Formation(s): Arbuckle  
Nearest Lease or unit boundary line (in footage): 1290'

Ground Surface Elevation: 1900 feet MSL  
Water well within one-quarter mile:  Yes  No  
Public water supply well within one mile:  Yes  No

Depth to bottom of fresh water: 100'  
Depth to bottom of usable water: 340'  
Surface Pipe by Alternate:  I  II  
Length of Surface Pipe Planned to be set: +/- 820'  
Length of Conductor Pipe (if any): none  
Projected Total Depth: +/- 3500'  
Formation at Total Depth: Arbuckle

Water Source for Drilling Operations:  
 Well  Farm Pond  Other: \_\_\_\_\_  
DWR Permit #: \_\_\_\_\_

(Note: Apply for Permit with DWR)   
Will Cores be taken?  Yes  No  
If Yes, proposed zone: \_\_\_\_\_

Well Drilled For:  Oil  Gas  Seismic; # of Holes \_\_\_\_\_  
 Enh Rec  Storage  Disposal  
 Other: \_\_\_\_\_  
Well Class:  Infield  Pool Ext.  Wildcat  Other  
Type Equipment:  Mud Rotary  Air Rotary  Cable  
Operator: \_\_\_\_\_  
Well Name: \_\_\_\_\_  
Original Completion Date: \_\_\_\_\_ Original Total Depth: \_\_\_\_\_

Directional, Deviated or Horizontal wellbore?  Yes  No  
If Yes, true vertical depth: \_\_\_\_\_  
Bottom Hole Location: \_\_\_\_\_  
KCC DKT #: \_\_\_\_\_

# WAS: Lease name: Hoffman Ochs  
IS: " " : Ochs

**AFFIDAVIT**

The undersigned hereby affirms that the drilling, completion and eventual plugging of this well will comply with K.S.A. 55 et. seq.  
It is agreed that the following minimum requirements will be met:

1. Notify the appropriate district office **prior** to spudding of well;
2. A copy of the approved notice of intent to drill **shall be** posted on each drilling rig;
3. The minimum amount of surface pipe as specified below **shall be set** by circulating cement to the top. In all cases surface pipe **shall be set** through all unconsolidated materials plus a minimum of 20 feet into the underlying formation.
4. If the well is dry hole, an agreement between the operator and the district office on plug length and placement is necessary **prior to plugging**;
5. The appropriate district office will be notified before well is either plugged or production casing is cemented in;
6. If an ALTERNATE II COMPLETION, production pipe shall be cemented from below any usable water to surface within **120 DAYS** of spud date.  
Or pursuant to Appendix "B" - Eastern Kansas surface casing order #133,891-C, which applies to the KCC District 3 area, alternate II cementing must be completed within 30 days of the spud date or the well shall be plugged. **In all cases, NOTIFY district office** prior to any cementing.

I hereby certify that the statements made herein are true and correct to the best of my knowledge and belief.

Date: 6-16-2008 Signature of Operator or Agent: Brian Karlin Title: Production Foreman  
7-18-2008 Signature of Operator or Agent: Dana [Signature] Title: Sr. Production Analyst

For KCC Use ONLY  
API # 15 - 009-25221-0000  
Conductor pipe required None feet  
Minimum surface pipe required 360 feet per ALT.  I  II  
Approved by: [Signature] 6-19-08 / [Signature] 7-21-08  
This authorization expires: 6-19-09  
(This authorization void if drilling not started within 12 months of approval date.)  
Spud date: \_\_\_\_\_ Agent: \_\_\_\_\_

- File Drill Pit Application (form CDP-1) with Intent to Drill;
  - File Completion Form ACO-1 within 120 days of spud date;
  - File acreage attribution plat according to field proration orders;
  - Notify appropriate district office 48 hours prior to workover or re-entry;
  - Submit plugging report (CP-4) after plugging is completed (within 60 days);
  - Obtain written approval before disposing or injecting salt water.
  - If this permit has expired (See: authorized expiration date) please check the box below and return to the address below.
- Well Not Drilled - Permit Expired Date: \_\_\_\_\_  
Signature of Operator or Agent: \_\_\_\_\_

Mail to: KCC - Conservation Division, 130 S. Market - Room 2078, Wichita, Kansas 67202

RECEIVED KANSAS CORPORATION COMMISSION  
JUL 2 1 2008  
RECEIVED KANSAS CORPORATION COMMISSION  
JUN 1 8 2008  
CONSERVATION DIVISION  
WICHITA, KS

22  
17  
13  
 E  
 W

\* Correction  
to  
Lease  
Name

**IN ALL CASES PLOT THE INTENDED WELL ON THE PLAT BELOW**

Plat of acreage attributable to a well in a prorated or spaced field

**CORRECTED**

If the intended well is in a prorated or spaced field, please fully complete this side of the form. If the intended well is in a prorated or spaced field complete the plat below showing that the well will be properly located in relationship to other wells producing from the common source of supply. Please show all the wells and within 1 mile of the boundaries of the proposed acreage attribution unit for gas wells and within 1/2 mile of the boundaries of the proposed acreage attribution unit for oil wells.

API No. 15 - 009-25221-000  
 Operator: Teton North America LLC  
 Lease: ~~Normal-Gas~~ Ochs  
 Well Number: 1-22  
 Field: Trapp  
 Number of Acres attributable to well: \_\_\_\_\_  
 QTR/QTR/QTR/QTR of acreage: C - E/2 - SE/4

Location of Well: County: Barton  
 1,860 feet from  N /  S Line of Section  
 1,350 feet from  E /  W Line of Section  
 Sec. 22 Twp. 17 S. R. 13  E  W

Is Section:  Regular or  Irregular

If Section is irregular, locate well from nearest corner boundary.  
 Section corner used:  NE  NW  SE  SW

RECEIVED  
 KANSAS CORPORATION COMMISSION  
 JUL 21 2008  
 CONSERVATION DIVISION  
 WICHITA, KS

**PLAT**

(Show location of the well and shade attributable acreage for prorated or spaced wells.)  
 (Show footage to the nearest lease or unit boundary line.)

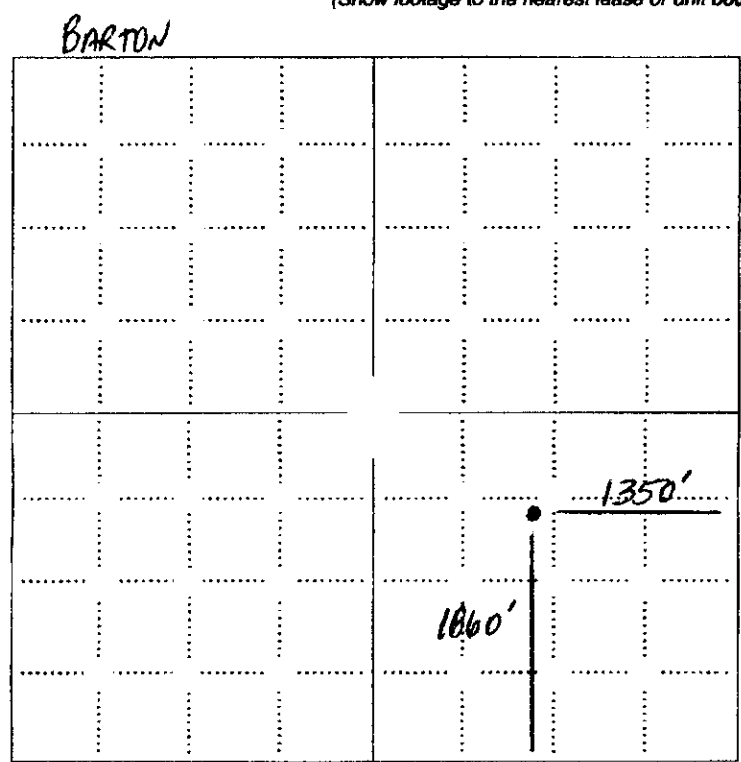

RECEIVED  
 KANSAS CORPORATION COMMISSION  
 JUN 18 2008  
 CONSERVATION DIVISION  
 WICHITA, KS

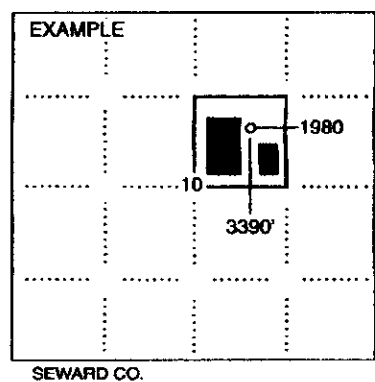

NOTE: In all cases locate the spot of the proposed drilling location.

**In plotting the proposed location of the well, you must show:**

1. The manner in which you are using the depicted plat by identifying section lines, i.e. 1 section, 1 section with 8 surrounding sections, 4 sections, etc.
2. The distance of the proposed drilling location from the south / north and east / west outside section lines.
3. The distance to the nearest lease or unit boundary line (in footage).
4. If proposed location is located within a prorated or spaced field a certificate of acreage attribution plat must be attached: (CO-7 for oil wells; CG-8 for gas wells).

\* Correction  
to  
lease  
Name

KANSAS CORPORATION COMMISSION  
OIL & GAS CONSERVATION DIVISION  
APPLICATION FOR SURFACE PIT

RECEIVED  
KANSAS CORPORATION COMMISSION

JUL 21 2008

Form CDP-1  
April 2004  
Form must be Typed

CONSERVATION DIVISION  
WICHITA, KS

Submit in Duplicate

**CORRECTED**

Operator Name: Teton North America LLC		License Number: 34110	
Operator Address: P.O. Box 1378		Hays KS 67601	
Contact Person: Brian Karlin		Phone Number: 785-623-3290	
Lease Name & Well No: <del>Hoffman Ochs</del> Ochs 1-22		Pit Location (QQQQ): app. C <del>E/2</del> SE/4	
Type of Pit: <input type="checkbox"/> Emergency Pit <input type="checkbox"/> Burn Pit <input type="checkbox"/> Settling Pit <input checked="" type="checkbox"/> Drilling Pit <input type="checkbox"/> Workover Pit <input type="checkbox"/> Haul-Off Pit <small>(If WP Supply API No. or Year Drilled)</small>	Pit is: <input checked="" type="checkbox"/> Proposed <input type="checkbox"/> Existing If Existing, date constructed:  Pit capacity: 3,000 (bbls)	Sec. 22 Twp. 17 R. 13 <input type="checkbox"/> East <input checked="" type="checkbox"/> West 1,860 Feet from <input type="checkbox"/> North / <input checked="" type="checkbox"/> South Line of Section 1,350 Feet from <input checked="" type="checkbox"/> East / <input type="checkbox"/> West Line of Section Barton County	
Is the pit located in a Sensitive Ground Water Area? <input type="checkbox"/> Yes <input checked="" type="checkbox"/> No		Chloride concentration: _____ mg/l <small>(For Emergency Pits and Settling Pits only)</small>	
Is the bottom below ground level? <input checked="" type="checkbox"/> Yes <input type="checkbox"/> No	Artificial Liner? <input type="checkbox"/> Yes <input checked="" type="checkbox"/> No	How is the pit lined if a plastic liner is not used? Lined with soil and drilling mud.	
Pit dimensions (all but working pits):    70    Length (feet)    70    Width (feet) <input type="checkbox"/> N/A: Steel Pits Depth from ground level to deepest point:    5    (feet) <input type="checkbox"/> No Pit			
If the pit is lined give a brief description of the liner material, thickness and installation procedure.		Describe procedures for periodic maintenance and determining liner integrity, including any special monitoring.	
Distance to nearest water well within one-mile of pit 2611 feet    Depth of water well 108 feet		Depth to shallowest fresh water 49 feet Source of information: JR-RGS <input type="checkbox"/> measured <input type="checkbox"/> well owner <input type="checkbox"/> electric log <input type="checkbox"/> KDWR	
<b>Emergency, Settling and Burn Pits ONLY:</b> Producing Formation: _____ Number of producing wells on lease: _____ Barrels of fluid produced daily: _____ Does the slope from the tank battery allow all spilled fluids to flow into the pit? <input type="checkbox"/> Yes <input type="checkbox"/> No		<b>Drilling, Workover and Haul-Off Pits ONLY:</b> Type of material utilized in drilling/workover: drilling mud Number of working pits to be utilized: 3 Abandonment procedure: Allow liquid to evaporate. Let the cuttings dry and then backfill. Drill pits must be closed within 365 days of spud date.	
I hereby certify that the above statements are true and correct to the best of my knowledge and belief. 7-18-2008    6-16-2008    Date Signature of Applicant or Agent: Brian Karlin, Daranthy Buckner			
<b>KCC OFFICE USE ONLY</b>		Steel Pit <input type="checkbox"/> RFAC <input type="checkbox"/> RFAS <input type="checkbox"/>	
Date Received: 6/18/08    Permit Number: _____		Permit Date: 6/18/08    Lease Inspection: <input type="checkbox"/> Yes <input checked="" type="checkbox"/> No	

Mail to: KCC - Conservation Division, 130 S. Market - Room 3378, Wichita, Kansas 67202

15-009-25221-0002

RECEIVED  
KANSAS CORPORATION COMMISSION

JUN 18 2008

CONSERVATION DIVISION  
WICHITA, KS