

For KCC Use: 7-28-08
 Effective Date: 7-28-08
 District # 3
 SGA? Yes No

KANSAS CORPORATION COMMISSION
 OIL & GAS CONSERVATION DIVISION

Form C-1
 October 2007
Form must be Typed
Form must be Signed
All blanks must be Filled

NOTICE OF INTENT TO DRILL

Must be approved by KCC five (5) days prior to commencing well

Expected Spud Date: July 25, 2008
 month day year

Spot Description:
 SE NE SE Sec. 12 Twp. 32 S. R. 15 E W
 (00/00) 1680 feet from N / S Line of Section
 630 feet from E / W Line of Section

OPERATOR: License# 33074
 Name: Dart Cherokee Basin Operating Co LLC
 Address 1: 211 W Myrtle
 Address 2:
 City: Independence State: KS Zip: 67301
 Contact Person: Bill Barks
 Phone: 620-331-7870

Is SECTION: Regular Irregular?

(Note: Locate well on the Section Plat on reverse side)

CONTRACTOR: License# 5675
 Name: McPherson Drilling

County: Montgomery
 Lease Name: D&C Chism Well #: C4-12
 Field Name: Cherokee Basin Coal Gas Area

Is this a Prorated / Spaced Field? Yes No

Target Formation(s): Mississippian

Nearest Lease or unit boundary line (in footage): 330 Feet

Ground Surface Elevation: 794 feet MSL

Water well within one-quarter mile: Yes No

Public water supply well within one mile: Yes No

Depth to bottom of fresh water: 150' + -

Depth to bottom of usable water: 175'

Surface Pipe by Alternate: I II

Length of Surface Pipe Planned to be set: 40'

Length of Conductor Pipe (if any):

Projected Total Depth: 1404 Feet

Formation at Total Depth: Mississippian

Water Source for Drilling Operations:
 Well Farm Pond Other:

DWR Permit #: (Note: Apply for Permit with DWR)

Will Cores be taken? Yes No

If Yes, proposed zone:

Well Drilled For: Oil Gas Enh Rec Storage Disposal Seismic; # of Holes Other:
 Well Class: Infield Pool Ext. Wildcat Other
 Type Equipment: Mud Rotary Air Rotary Cable
 If OWWO: old well information as follows:

Operator:
 Well Name:
 Original Completion Date: Original Total Depth:

Directional, Deviated or Horizontal wellbore? Yes No

If Yes, true vertical depth:

Bottom Hole Location:

KCC DKT #:

AFFIDAVIT

RECEIVED
 KANSAS CORPORATION COMMISSION

The undersigned hereby affirms that the drilling, completion and eventual plugging of this well will comply with K.S.A. 55 et. seq.
 It is agreed that the following minimum requirements will be met:

JUL 16 2008

1. Notify the appropriate district office **prior** to spudding of well;
2. A copy of the approved notice of intent to drill **shall be posted** on each drilling rig;
3. The minimum amount of surface pipe as specified below **shall be set** by circulating cement to the top; in all cases surface pipe shall be set through all unconsolidated materials plus a minimum of 20 feet into the underlying formation.
4. If the well is dry hole, an agreement between the operator and the district office on plug length and placement is necessary **prior to plugging**;
5. The appropriate district office will be notified before well is either plugged or production casing is cemented in;
6. If an ALTERNATE II COMPLETION, production pipe shall be cemented from below any usable water to surface within **120 DAYS** of spud date. Or pursuant to Appendix "B" - Eastern Kansas surface casing order #133,891-C, which applies to the KCC District 3 area, alternate II cementing must be completed within 30 days of the spud date or the well shall be plugged. **In all cases, NOTIFY district office** prior to any cementing.

I hereby certify that the statements made herein are true and correct to the best of my knowledge and belief.

Date: July 15, 2008 Signature of Operator or Agent: [Signature] Title: Operations Manager

For KCC Use ONLY
 API # 15 - 125-31726-0000
 Conductor pipe required None feet
 Minimum surface pipe required 20 feet per ALT. I II
 Approved by: [Signature] 7-23-08
 This authorization expires: 7-23-09
 (This authorization void if drilling not started within 12 months of approval date.)
 Spud date: Agent:

Remember to:

- File Drill Pit Application (form CDP-1) with Intent to Drill;
- File Completion Form ACO-1 within 120 days of spud date;
- File acreage attribution plat according to field proration orders;
- Notify appropriate district office 48 hours prior to workover or re-entry;
- Submit plugging report (CP-4) after plugging is completed (within 60 days);
- Obtain written approval before disposing or injecting salt water.
- If this permit has expired (See: authorized expiration date) please check the box below and return to the address below.

Well Not Drilled - Permit Expired Date: E W
 Signature of Operator or Agent:

Mail to: KCC - Conservation Division, 130 S. Market - Room 2078, Wichita, Kansas 67202

IN ALL CASES PLOT THE INTENDED WELL ON THE PLAT BELOW

Plat of acreage attributable to a well in a prorated or spaced field

If the intended well is in a prorated or spaced field, please fully complete this side of the form. If the intended well is in a prorated or spaced field complete the plat below showing that the well will be properly located in relationship to other wells producing from the common source of supply. Please show all the wells and within 1 mile of the boundaries of the proposed acreage attribution unit for gas wells and within 1/2 mile of the boundaries of the proposed acreage attribution unit for oil wells.

API No. 15 - 125-31726-0000
 Operator: Dart Cherokee Basin Operating Co LLC
 Lease: D&C Chism
 Well Number: C4-12
 Field: Cherokee Basin Coal Gas Area
 Number of Acres attributable to well: 40
 QTR/QTR/QTR/QTR of acreage: SE - NE - SE

Location of Well: County: Montgomery
 1660 feet from N / S Line of Section
 630 feet from E / W Line of Section
 Sec. 12 Twp. 32 S. R. 15 E W

Is Section: Regular or Irregular

If Section is Irregular, locate well from nearest corner boundary.

Section corner used: NE NW SE SW

PLAT

(Show location of the well and shade attributable acreage for prorated or spaced wells.)

(Show footage to the nearest lease or unit boundary line.)

T32S

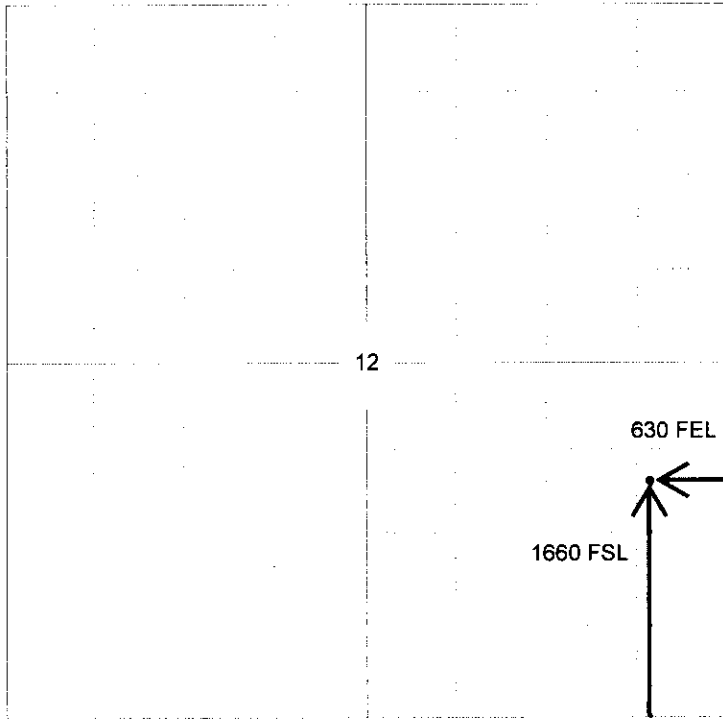

NOTE: In all cases locate the spot of the proposed drilling location.

R15E

RECEIVED
KANSAS CORPORATION COMMISSION

JUL 16 2008

CONSERVATION DIVISION
WICHITA, KS

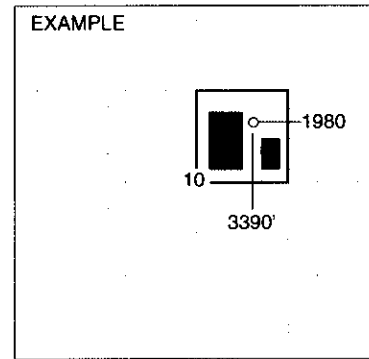

Montgomery County

In plotting the proposed location of the well, you must show:

1. The manner in which you are using the depicted plat by identifying section lines, i.e. 1 section, 1 section with 8 surrounding sections, 4 sections, etc.
2. The distance of the proposed drilling location from the south / north and east / west outside section lines.
3. The distance to the nearest lease or unit boundary line (in footage).
4. If proposed location is located within a prorated or spaced field a certificate of acreage attribution plat must be attached: (CO-7 for oil wells; CG-8 for gas wells).

**KANSAS CORPORATION COMMISSION
OIL & GAS CONSERVATION DIVISION
APPLICATION FOR SURFACE PIT**

Form CDP-1
April 2004
Form must be Typed

Submit in Duplicate

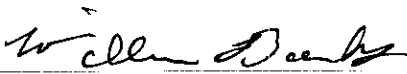
Operator Name: Dart Cherokee Basin Operating Co LLC		License Number: 33074	
Operator Address: 211 W Myrtle		Independence KS 67301	
Contact Person: Bill Barks		Phone Number: 620-331-7870	
Lease Name & Well No.: D&C Chism C4-12		Pit Location (QQQQ): SE NE SE Sec. <u>12</u> Twp. <u>32</u> R. <u>15</u> <input checked="" type="checkbox"/> East <input type="checkbox"/> West <u>1660</u> Feet from <input type="checkbox"/> North / <input checked="" type="checkbox"/> South Line of Section <u>630</u> Feet from <input checked="" type="checkbox"/> East / <input type="checkbox"/> West Line of Section Montgomery County	
Type of Pit: <input type="checkbox"/> Emergency Pit <input type="checkbox"/> Burn Pit <input type="checkbox"/> Settling Pit <input checked="" type="checkbox"/> Drilling Pit <input type="checkbox"/> Workover Pit <input type="checkbox"/> Haul-Off Pit <small>(If WP Supply API No. or Year Drilled)</small>		Pit is: <input checked="" type="checkbox"/> Proposed <input type="checkbox"/> Existing If Existing, date constructed: _____ Pit capacity: 926 (bbls)	
Is the pit located in a Sensitive Ground Water Area? <input type="checkbox"/> Yes <input checked="" type="checkbox"/> No		Chloride concentration: _____ mg/l <small>(For Emergency Pits and Settling Pits only)</small>	
Is the bottom below ground level? <input checked="" type="checkbox"/> Yes <input type="checkbox"/> No		Artificial Liner? <input type="checkbox"/> Yes <input checked="" type="checkbox"/> No	
		How is the pit lined if a plastic liner is not used? Natural Clays	
Pit dimensions (all but working pits): <u>35</u> Length (feet) <u>30</u> Width (feet) <input type="checkbox"/> N/A: Steel Pits Depth from ground level to deepest point: <u>5</u> (feet) <input type="checkbox"/> No Pit			
If the pit is lined give a brief description of the liner material, thickness and installation procedure.		Describe procedures for periodic maintenance and determining liner integrity, including any special monitoring.	
Distance to nearest water well within one-mile of pit <u>1148</u> feet Depth of water well <u>150</u> feet		Depth to shallowest fresh water <u>40</u> feet. Source of information: <input type="checkbox"/> measured <input type="checkbox"/> well owner <input type="checkbox"/> electric log <input checked="" type="checkbox"/> KDWR	
Emergency, Settling and Burn Pits ONLY: Producing Formation: _____ Number of producing wells on lease: _____ Barrels of fluid produced daily: _____ Does the slope from the tank battery allow all spilled fluids to flow into the pit? <input type="checkbox"/> Yes <input type="checkbox"/> No		Drilling, Workover and Haul-Off Pits ONLY: Type of material utilized in drilling/workover: <u>None</u> Air Rig Number of working pits to be utilized: <u>0</u> Abandonment procedure: <u>Air Dry & Backfill</u> Drill pits must be closed within 365 days of spud date.	
I hereby certify that the above statements are true and correct to the best of my knowledge and belief.		RECEIVED KANSAS CORPORATION COMMISSION	
July 15, 2008 Date		 Signature of Applicant or Agent	
		JUL 16 2008 CONSERVATION DIVISION WICHITA, KS	
KCC OFFICE USE ONLY			
Date Received: <u>7/16/08</u> Permit Number: _____		Steel Pit <input type="checkbox"/> RFAC <input type="checkbox"/> RFAS <input type="checkbox"/>	
Permit Date: <u>7/16/08</u> Lease Inspection: <input type="checkbox"/> Yes <input checked="" type="checkbox"/> No			

15-125-17216-0000

July 15, 2008

Justin R Myers
4476 N Pennsylvania Ave
Independence, KS 67301

Re: Eastern Kansas Surface Casing Order

Dear Mr. Myers:

The Eastern Kansas Surface Casing Order #133,891-C for Area 2, paragraph 2 states, **"No well shall be drilled closer than 660 feet of an existing domestic or municipal water well without written owner notification, a copy of which must be attached to the drilling intent form during filing. Special casing and cementing requirements may be imposed in those areas producing fresh and usable water."**

Based on information supplied by the Kansas Geological Survey, we believe you have a water well within 660 feet of our proposed gas well, D&C Chism C4-12., located 1660' FSL, 630' FEL, Sec 12-T32S-R15E, Montgomery County.

This document shall serve as landowner notification in accordance with the above referenced regulation.

Please feel free to contact me if you have any questions regarding this notice.

Thank you,



Bill Barks
Operations Manager
Dart Oil & Gas

RECEIVED
KANSAS CORPORATION COMMISSION

JUL 16 2008

CONSERVATION DIVISION
WICHITA, KS

15-125-31726-0000

July 15, 2008

Jackie and Shelda Myers
4512 N Pennsylvania Ave
Independence, KS 67301

Re: Eastern Kansas Surface Casing Order

Dear Mr. Myers:

The Eastern Kansas Surface Casing Order #133,891-C for Area 2, paragraph 2 states, **"No well shall be drilled closer than 660 feet of an existing domestic or municipal water well without written owner notification, a copy of which must be attached to the drilling intent form during filing. Special casing and cementing requirements may be imposed in those areas producing fresh and usable water."**

Based on information supplied by the Kansas Geological Survey, we believe you have a water well within 660 feet of our proposed gas well, D&C Chism C4-12., located 1660' FSL, 630' FEL, Sec 12-T32S-R15E, Montgomery County.

This document shall serve as landowner notification in accordance with the above referenced regulation.

Please feel free to contact me if you have any questions regarding this notice.

Thank you,



Bill Barks
Operations Manager
Dart Oil & Gas

RECEIVED
KANSAS CORPORATION COMMISSION

JUL 16 2008

CONSERVATION DIVISION
WICHITA, KS