

CORRECTION TO FOOTAGE LOCATION

KANSAS CORPORATION COMMISSION
OIL & GAS CONSERVATION DIVISION

Form C-1
October 2007

For KCC Use:
Effective Date: 7-16-08
District #: 2
SGA? Yes No

#7-2308
CORRECTED

Form must be Typed
Form must be Signed
Air blanks must be Filled

NOTICE OF INTENT TO DRILL

Must be approved by KCC five (5) days prior to commencing well

Expected Spud Date: JUNE 5 2008
month day year

Spot Description: 2018 8 120' W OF CENTER
SW NE Sec. 30 Twp. 19 S. R. 10 E W
2,000 2,200 feet from N / S Line of Section
2,100 feet from E / W Line of Section

OPERATOR: License# 3882
Name: SAMUEL GARY JR & ASSOCIATES, INC.
Address 1: 1560 BROADWAY
Address 2: SUITE 2100
City: DENVER State: CO Zip: 80202
Contact Person: TOM FERTAL
Phone: 303-831-4673
CONTRACTOR: License# 33905
Name: ROYAL DRILLING

Is SECTION: Regular Irregular?
(Note: Locate well on the Section Plat on reverse side)

County: RICE
Lease Name: GATTON CORP Well #: 1-30
Field Name: WILDCAT

Well Drilled For: Oil Gas Seismic; # of Holes Other:
 Enh Rec Storage Disposal
Well Class: Infield Pool Ext. Wildcat Other
Type Equipment: Mud Rotary Air Rotary Cable

Is this a Prorated / Spaced Field? Yes No
Target Formation(s): ARBUCKLE

Nearest Lease or unit boundary line (in footage): 440'
Ground Surface Elevation: EST 1770 feet MSL

Water well within one-quarter mile: Yes No
Public water supply well within one mile: Yes No

Depth to bottom of fresh water: 100
Depth to bottom of usable water: 280

Surface Pipe by Alternate: I II
Length of Surface Pipe Planned to be set: 320'

Length of Conductor Pipe (if any): NONE
Projected Total Depth: 3450'

Formation at Total Depth: ARBUCKLE

Water Source for Drilling Operations: Well Farm Pond Other:

DWR Permit #: (Note: Apply for Permit with DWR)

Will Cores be taken? Yes No
If Yes, proposed zone:

If OWWO: old well information as follows:
Operator: _____
Well Name: _____
Original Completion Date: _____ Original Total Depth: _____

Directional, Deviated or Horizontal wellbore? Yes No

If Yes, true vertical depth: _____

Bottom Hole Location: _____

KCC DKT #: _____

LOCATION WAS: 2000' FNL
IT IS: 2200' FNL

AFFIDAVIT

The undersigned hereby affirms that the drilling, completion and eventual plugging of this well will comply with K.S.A. 55 et. seq.
It is agreed that the following minimum requirements will be met:

RECEIVED KANSAS CORPORATION COM
KANSAS CORPORATION COM

JUL 22 2008

MAY 13 2008

CONSERVATION DIVISIO
WICHITA, KS

- 1. Notify the appropriate district office prior to spudding of well;
- 2. A copy of the approved notice of intent to drill shall be posted on each drilling rig;
- 3. The minimum amount of surface pipe as specified below shall be set by circulating cement to the top; in all cases WICHITA PIPE shall be set through all unconsolidated materials plus a minimum of 20 feet into the underlying formation.
- 4. If the well is dry hole, an agreement between the operator and the district office on plug length and placement is necessary prior to plugging;
- 5. The appropriate district office will be notified before well is either plugged or production casing is cemented in;
- 6. If an ALTERNATE II COMPLETION, production pipe shall be cemented from below any usable water to surface within 120 DAYS of spud date. Or pursuant to Appendix "B" - Eastern Kansas surface casing order #133,891-C, which applies to the KCC District 3 area, alternate II cementing must be completed within 30 days of the spud date or the well shall be plugged. In all cases, NOTIFY district office prior to any cementing.

I hereby certify that the statements made herein are true and correct to the best of my knowledge and belief.

Date: MAY 12, 2008 Signature of Operator or Agent: Thomas Fertal Title: SR. GEOLOGIST

For KCC Use ONLY
API # 15 - 159-22577-0000
Conductor pipe required None feet
Minimum surface pipe required 300 feet per ALT. I II
Approved by: RWS 7-11-08 / JWS 7-23-08
This authorization expires: 7-11-09
(This authorization void if drilling not started within 12 months of approval date.)
Spud date: _____ Agent: _____

Remember to:

- File Drill Pit Application (form CDP-1) with intent to Drill;
- File Completion Form ACO-1 within 120 days of spud date;
- File acreage attribution plat according to field proration orders;
- Notify appropriate district office 48 hours prior to workover or re-entry;
- Submit plugging report (CP-4) after plugging is completed (within 60 days);
- Obtain written approval before disposing or injecting salt water.
- If this permit has expired (See: authorized expiration date) please check the box below and return to the address below.

Well Not Drilled - Permit Expired Date: _____
Signature of Operator or Agent: _____

30
19
10
 E
 W

Side Two
CORRECTION TO FOOTAGE LOCATION

IN ALL CASES PLOT THE INTENDED WELL ON THE PLAT BELOW

CORRECTED

Plat of acreage attributable to a well in a prorated or spaced field

If the intended well is in a prorated or spaced field, please fully complete this side of the form. If the intended well is in a prorated or spaced field complete the plat below showing that the well will be properly located in relationship to other wells producing from the common source of supply. Please show all the wells and within 1 mile of the boundaries of the proposed acreage attribution unit for gas wells and within 1/2 mile of the boundaries of the proposed acreage attribution unit for oil wells.

API No. 15 - _____
 Operator: SAMUEL GARY JR & ASSOCIATES, INC.
 Lease: GATTON CORP
 Well Number: 1-30
 Field: WILDCAT

Location of Well: County: RICE
 * ~~2,000~~ 2200 feet from N / S Line of Section
2,100 feet from E / W Line of Section
 Sec. 30 Twp. 19 S. R. 10 E W

Number of Acres attributable to well: _____
 QTR/QTR/QTR/QTR of acreage: _____ - _____ - SW - NE

Is Section: Regular or Irregular

If Section is Irregular, locate well from nearest corner boundary.

Section corner used: NE NW SE SW

PLAT

(Show location of the well and shade attributable acreage for prorated or spaced wells.)

(Show footage to the nearest lease or unit boundary line.)

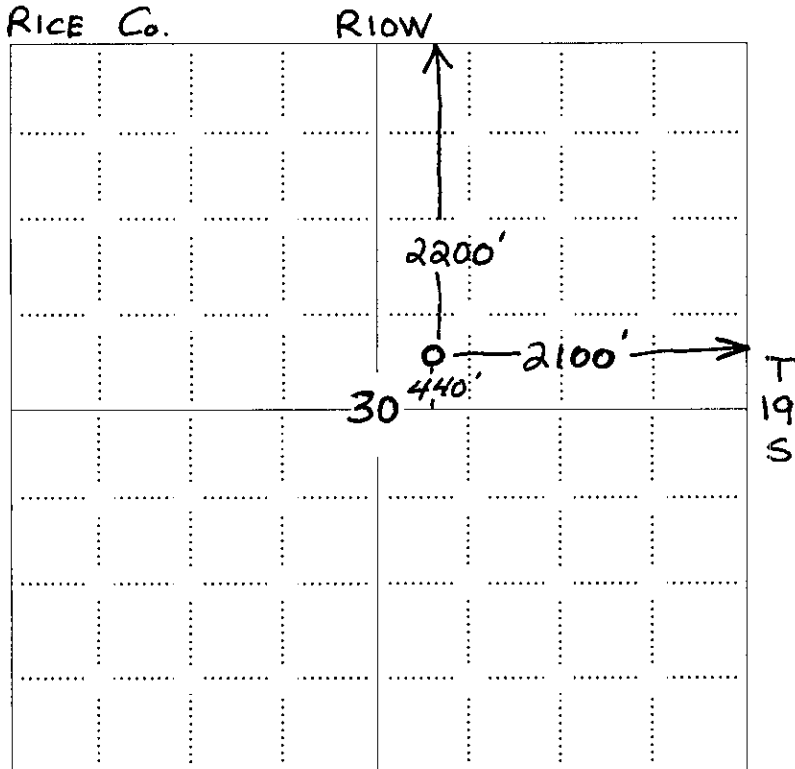

440' from the nearest lease boundary

RECEIVED
KANSAS CORPORATION COMMISSION

JUL 22 2008

CONSERVATION DIVISION
WICHITA, KS

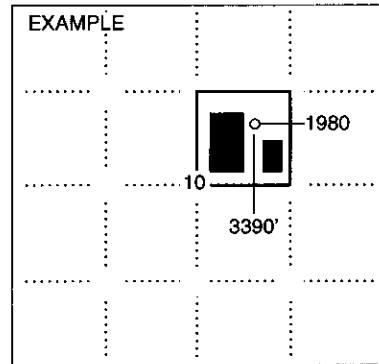

SEWARD CO.

NOTE: In all cases locate the spot of the proposed drilling location.

In plotting the proposed location of the well, you must show:

1. The manner in which you are using the depicted plat by identifying section lines, i.e. 1 section, 1 section with 8 surrounding sections, 4 sections, etc.
2. The distance of the proposed drilling location from the south / north and east / west outside section lines.
3. The distance to the nearest lease or unit boundary line (in footage).
4. If proposed location is located within a prorated or spaced field a certificate of acreage attribution plat must be attached: (C0-7 for oil wells; CG-8 for gas wells).

CORRECTION TO FOOTAGE LOCATION

KANSAS CORPORATION COMMISSION
OIL & GAS CONSERVATION DIVISION
APPLICATION FOR SURFACE PIT

Form GDP-1
April 2004
Form must be Typed

Submit in Duplicate

CORRECTED

Operator Name: SAMUEL GARY JR & ASSOCIATES, INC.		License Number: 3882	
Operator Address: 1560 BROADWAY		SUITE 2100 DENVER CO 80202	
Contact Person: TOM FERTAL		Phone Number: 303 - 831 - 4673	
Lease Name & Well No.: GATTON CORP 1-30		Pit Location (QQQQ): <u>SW</u> SW NE	
Type of Pit: <input type="checkbox"/> Emergency Pit <input type="checkbox"/> Burn Pit <input type="checkbox"/> Settling Pit <input type="checkbox"/> Drilling Pit <input type="checkbox"/> Workover Pit <input type="checkbox"/> Haul-Off Pit (If WP Supply API No. or Year Drilled)		Pit is: <input checked="" type="checkbox"/> Proposed <input type="checkbox"/> Existing If Existing, date constructed: * 2008 2200 Pit capacity: 4,000 (bbls)	
Is the pit located in a Sensitive Ground Water Area? <input checked="" type="checkbox"/> Yes <input checked="" type="checkbox"/> No		Chloride concentration: _____ mg/l (For Emergency Pits and Settling Pits only)	
Is the bottom below ground level? <input checked="" type="checkbox"/> Yes <input type="checkbox"/> No		Artificial Liner? <input type="checkbox"/> Yes <input checked="" type="checkbox"/> No	
How is the pit lined if a plastic liner is not used? NATIVE MUD AND CLAY			
Pit dimensions (all but working pits): <u>75</u> Length (feet) <u>75</u> Width (feet)		<input type="checkbox"/> N/A: Steel Pits	
Depth from ground level to deepest point: <u>4</u> (feet)		<input type="checkbox"/> No Pit	
If the pit is lined give a brief description of the liner material, thickness and installation procedure.		Describe procedures for periodic maintenance and determining liner integrity, including any special monitoring.	
		RECEIVED KANSAS CORPORATION COMMISSION JUL 22 2008 CONSERVATION DIVISION WICHITA, KS	
Distance to nearest water well within one-mile of pit <u>558</u> feet Depth of water well <u>65</u> feet		Depth to shallowest fresh water <u>10</u> feet. Source of information: <input type="checkbox"/> measured <input type="checkbox"/> well owner <input type="checkbox"/> electric log <input checked="" type="checkbox"/> KDWR	
Emergency, Settling and Burn Pits ONLY: Producing Formation: _____ Number of producing wells on lease: _____ Barrels of fluid produced daily: _____ Does the slope from the tank battery allow all spilled fluids to flow into the pit? <input type="checkbox"/> Yes <input type="checkbox"/> No		Drilling, Workover and Haul-Off Pits ONLY: Type of material utilized in drilling/workover: FRESH MUD Number of working pits to be utilized: <u>3</u> Abandonment procedure: ALLOW TO DRY, THEN BACKFILL Drill pits must be closed within 365 days of spud date.	
I hereby certify that the above statements are true and correct to the best of my knowledge and belief. <u>7-12-08</u> MAY 12, 2008 Date		RECEIVED KANSAS CORPORATION COMMISSION MAY 13 2008 CONSERVATION DIVISION WICHITA, KS	
Signature of Applicant or Agent <u>Thomas J Fertal</u>			
KCC OFFICE USE ONLY			
Date Received: <u>5/13/08</u> Permit Number: _____		Steel Pit <input type="checkbox"/> RFAC <input checked="" type="checkbox"/> RFAS <input type="checkbox"/> <u>7/22/08</u> Permit Date: <u>7/11/08</u> Lease Inspection: <input checked="" type="checkbox"/> Yes <input type="checkbox"/> No Bent	

15159-28577-0000