

For KCC Use: 8-208
 Effective Date: 4
 District # _____
 SGA? Yes No

KANSAS CORPORATION COMMISSION
 OIL & GAS CONSERVATION DIVISION
NOTICE OF INTENT TO DRILL

Form C-1
 October 2007
 Form must be Typed
 Form must be Signed
 All blanks must be Filled

Must be approved by KCC five (5) days prior to commencing well

Expected Spud Date: August 23 2008
month day year

OPERATOR: License# 32705 ✓
 Name: Raney Oil Company, LLC
 Address 1: 3425 Tam O'Shanter Dr.
 Address 2: _____
 City: Lawrence State: KS Zip: 66047
 Contact Person: Thomas Raney
 Phone: 785 749-0672

CONTRACTOR: License# 33493 ✓
 Name: American Eagle Drilling

Well Drilled For: Oil Gas
 Enh Rec Storage Disposal
 Seismic; # of Holes _____
 Other: _____

Well Class: Infield Pool Ext. Wildcat Other

Type Equipment: Mud Rotary Air Rotary Cable

If OWWO: old well information as follows:

Operator: _____
 Well Name: _____
 Original Completion Date: _____ Original Total Depth: _____

Directional, Deviated or Horizontal wellbore? Yes No
 If Yes, true vertical depth: _____
 Bottom Hole Location: _____
 KCC DKT #: _____

Spot Description: ~~E/2 SE SW~~
E/2 SE SW Sec. 3 Twp. 10 S. R. 21 E W
 (area) 850 feet from N / S Line of Section
2260 feet from E / W Line of Section
 Is SECTION: Regular Irregular?

(Note: Locate well on the Section Plat on reverse side)
 County: Graham
 Lease Name: Miller Lambert Marcotte Well #: 13
 Field Name: _____

Is this a Prorated / Spaced Field? Yes No
 Target Formation(s): Arbuckle ✓
 Nearest Lease or unit boundary line (in footage): 400 ✓

Ground Surface Elevation: approx 2260 feet MSL
 Water well within one-quarter mile: Yes No
 Public water supply well within one mile: Yes No

Depth to bottom of fresh water: approx 180 / 150
 Depth to bottom of usable water: approx 550 / 950
 Surface Pipe by Alternate: I II 250'

Length of Surface Pipe Planned to be set: _____
 Length of Conductor Pipe (if any): 3800
 Projected Total Depth: Arbuckle
 Formation at Total Depth: _____

Water Source for Drilling Operations:
 Well Farm Pond Other: _____
 DWR Permit #: _____ (Note: Apply for Permit with DWR)

Will Cores be taken? Yes No
 If Yes, proposed zone: _____

AFFIDAVIT

RECEIVED

The undersigned hereby affirms that the drilling, completion and eventual plugging of this well will comply with K.S.A. 55 et. seq. KANSAS CORPORATION COMMISSION
 It is agreed that the following minimum requirements will be met:

JUL 25 2008

1. Notify the appropriate district office **prior** to spudding of well;
2. A copy of the approved notice of intent to drill **shall be** posted on each drilling rig;
3. The minimum amount of surface pipe as specified below **shall be set** by circulating cement to the top; in all cases surface pipe **shall be set** through all unconsolidated materials plus a minimum of 20 feet into the underlying formation.
4. If the well is dry hole, an agreement between the operator and the district office on plug length and placement is **necessary prior to plugging**;
5. The appropriate district office will be notified before well is either plugged or production casing is cemented in;
6. If an ALTERNATE II COMPLETION, production pipe shall be cemented from below any usable water to surface within **120 DAYS** of spud date. Or pursuant to Appendix "B" - Eastern Kansas surface casing order #133,891-C, which applies to the KCC District 3 area, alternate II cementing must be completed within 30 days of the spud date or the well shall be plugged. **In all cases, NOTIFY district office** prior to any cementing.

I hereby certify that the statements made herein are true and correct to the best of my knowledge and belief.

Date: 7.23.08 Signature of Operator or Agent: [Signature] Title: member Raney Oil

For KCC Use ONLY
 API # 15 - 065-23457-0000
 Conductor pipe required None feet
 Minimum surface pipe required 200 feet per ALT. I II
 Approved by: [Signature]
 This authorization expires: 7-28-09
 (This authorization void if drilling not started within 12 months of approval date.)
 Spud date: _____ Agent: _____

Remember to:

- File Drill Pit Application (form CDP-1) with Intent to Drill;
- File Completion Form ACO-1 within 120 days of spud date;
- File acreage attribution plat according to field proration orders;
- Notify appropriate district office 48 hours prior to workover or re-entry;
- Submit plugging report (CP-4) after plugging is completed (within 60 days);
- Obtain written approval before disposing or injecting salt water.
- If this permit has expired (See: authorized expiration date) please check the box below and return to the address below.

Well Not Drilled - Permit Expired Date: _____
 Signature of Operator or Agent: _____

3
10
21
 E
 W

IN ALL CASES PLOT THE INTENDED WELL ON THE PLAT BELOW

Plat of acreage attributable to a well in a prorated or spaced field

If the intended well is in a prorated or spaced field, please fully complete this side of the form. If the intended well is in a prorated or spaced field complete the plat below showing that the well will be properly located in relationship to other wells producing from the common source of supply. Please show all the wells and within 1 mile of the boundaries of the proposed acreage attribution unit for gas wells and within 1/2 mile of the boundaries of the proposed acreage attribution unit for oil wells.

API No. 15 - 065-23457-0000
Operator: Raney Oil Company, LLC
Lease: Miller Lambert
Well Number: 13
Field: Marcotte
Number of Acres attributable to well: 10
QTR/QTR/QTR/QTR of acreage: E/2 - SE - SW

Location of Well: County: Graham
850 feet from N / S Line of Section
2260 feet from E / W Line of Section
Sec. 3 Twp. 10 S. R. 21 E W

Is Section: Regular or Irregular

If Section is irregular, locate well from nearest corner boundary.

Section corner used: NE NW SE SW

PLAT

*(Show location of the well and shade attributable acreage for prorated or spaced wells.)
(Show footage to the nearest lease or unit boundary line.)*

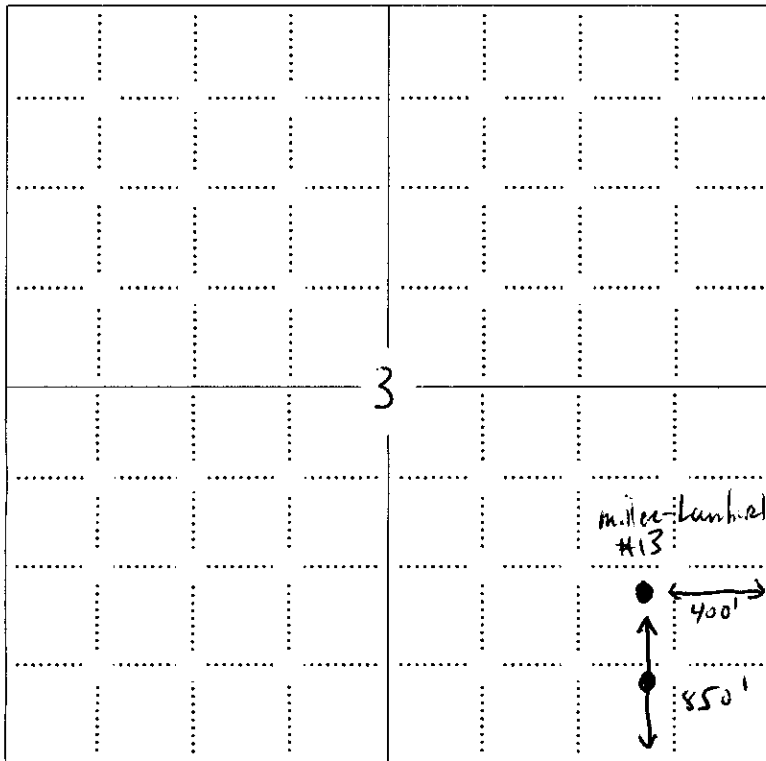

RECEIVED
KANSAS CORPORATION COMMISSION

JUL 25 2008

CONSERVATION DIVISION
WICHITA, KS

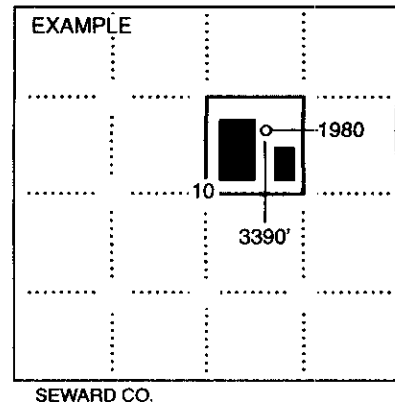

NOTE: In all cases locate the spot of the proposed drilling location.

In plotting the proposed location of the well, you must show:

1. The manner in which you are using the depicted plat by identifying section lines, i.e. 1 section, 1 section with 8 surrounding sections, 4 sections, etc.
2. The distance of the proposed drilling location from the south / north and east / west outside section lines.
3. The distance to the nearest lease or unit boundary line (in footage).
4. If proposed location is located within a prorated or spaced field a certificate of acreage attribution plat must be attached: (CO-7 for oil wells; CG-8 for gas wells).

KANSAS CORPORATION COMMISSION
OIL & GAS CONSERVATION DIVISION

Form CDP-1
April 2004
Form must be Typed

APPLICATION FOR SURFACE PIT

Submit in Duplicate

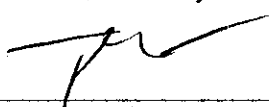
Operator Name: Raney Oil Company, LLC		License Number: 32705	
Operator Address: 3425 Tam O'Shanter Dr.		Lawrence KS 66047	
Contact Person: Thomas Raney		Phone Number: 785 749-0672	
Lease Name & Well No.: Miller Lambert 13		Pit Location (QQQQ): <u>SW NE SE SW</u>	
Type of Pit: <input type="checkbox"/> Emergency Pit <input type="checkbox"/> Burn Pit <input type="checkbox"/> Settling Pit <input checked="" type="checkbox"/> Drilling Pit <input type="checkbox"/> Workover Pit <input type="checkbox"/> Haul-Off Pit <i>(If WP Supply API No. or Year Drilled)</i>		Pit is: <input checked="" type="checkbox"/> Proposed <input type="checkbox"/> Existing If Existing, date constructed: _____ Pit capacity: 150 (bbls)	
		Sec. <u>3</u> Twp. <u>10</u> R. <u>21</u> <input type="checkbox"/> East <input checked="" type="checkbox"/> West <u>850</u> Feet from <input type="checkbox"/> North / <input checked="" type="checkbox"/> South Line of Section <u>2260</u> Feet from <input type="checkbox"/> East / <input checked="" type="checkbox"/> West Line of Section Graham County	
Is the pit located in a Sensitive Ground Water Area? <input type="checkbox"/> Yes <input checked="" type="checkbox"/> No		Chloride concentration: <u>10,000</u> mg/l <i>(For Emergency Pits and Settling Pits only)</i>	
Is the bottom below ground level? <input checked="" type="checkbox"/> Yes <input type="checkbox"/> No		Artificial Liner? <input checked="" type="checkbox"/> Yes <input type="checkbox"/> No	
How is the pit lined if a plastic liner is not used?			
Pit dimensions (all but working pits): <u>20</u> Length (feet) <u>8</u> Width (feet) <input type="checkbox"/> N/A: Steel Pits Depth from ground level to deepest point: <u>4</u> (feet) <input type="checkbox"/> No Pit			
If the pit is lined give a brief description of the liner material, thickness and installation procedure. Commercial pit liner		Describe procedures for periodic maintenance and determining liner integrity, including any special monitoring. Daily inspection	
Distance to nearest water well within one-mile of pit <u>4828</u> feet Depth of water well <u>80</u> feet		Depth to shallowest fresh water <u>190 48</u> feet. Source of information: <input type="checkbox"/> measured <input type="checkbox"/> well owner <input type="checkbox"/> electric log <input checked="" type="checkbox"/> KDWR	
Emergency, Settling and Burn Pits ONLY: Producing Formation: _____ Number of producing wells on lease: _____ Barrels of fluid produced daily: _____ Does the slope from the tank battery allow all spilled fluids to flow into the pit? <input type="checkbox"/> Yes <input type="checkbox"/> No		Drilling, Workover and Haul-Off Pits ONLY: Type of material utilized in drilling/workover: <u>fresh water</u> Number of working pits to be utilized: <u>1</u> let dry and backfill Abandonment procedure: _____ Drill pits must be closed within 365 days of spud date.	
I hereby certify that the above statements are true and correct to the best of my knowledge and belief.			
<u>7.23.08</u> Date		 Signature of Applicant or Agent	
		RECEIVED KANSAS CORPORATION COMMISSION JUL 25 2008 CONSERVATION DIVISION WICHITA, KS	
KCC OFFICE USE ONLY Steel Pit <input type="checkbox"/> RFAC <input type="checkbox"/> RFAS <input type="checkbox"/>			
Date Received: <u>7/25/08</u> Permit Number: _____ Permit Date: <u>7/25/08</u> Lease Inspection: <input type="checkbox"/> Yes <input checked="" type="checkbox"/> No			

15-065-23457000