

15-065-20882-00-08

STATE OF KANSAS  
STATE CORPORATION COMMISSION

WELL PLUGGING RECORD

Give All Information Completely  
Make Required Affidavit  
Mail or Deliver Report to  
Conservation Division  
State Corporation Comm.  
245 North Water  
Wichita, KS 67202

Graham County, Sec. 10 Twp. 8S Rge. 25 E/W  
Location as "NE/CNW $\frac{1}{4}$ /SW $\frac{1}{4}$ " or footage from lines  
SE SW SE

Lease Owner The Maurice L. Brown Co.  
Lease Name TOLL Well No. 1

Office Address 1500 Vickers KSB&T Bldg, Wichita, Kansas 67202

Character of Well (Completed as Oil, Gas or Dry Hole)  
Dry Hole

Date Well completed November 25 19 76

Application for plugging filed (Verbally) November 25 19 76

Application for plugging approved (Verb.) November 25 19 76

Plugging commenced November 25 19 76

Plugging completed November 25 19 76

Reason for abandonment of well or producing formation  
No commercial quantity of oil or gas encountered

If a producing well is abandoned, date of last production  
19

Was permission obtained from the Conservation Division or  
its agents before plugging was commenced? Yes

Name of Conservation Agent who supervised plugging of this well

Producing formation Depth to top Bottom Total Depth of Well

Show depth and thickness of all water, oil and gas formations.

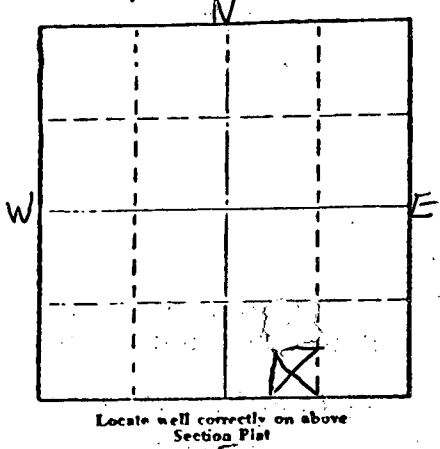

OIL, GAS OR WATER RECORDS

CASING RECORD

FORMATION	CONTENT	FROM	TO	SIZE	PUT IN	PULLED OUT

Describe in detail the manner in which the well was plugged, indicating where the mud fluid was placed and the method or methods used in introducing it into the hold. If cement or other plugs were used, state the character of same and depth placed, from feet to feet for each plug set.

Set 1st plug at 950' with 70 sx.

Set 2nd plug at 250' with 20 sx.

Set 3rd plug at 40' with 10 sx.

Job complete at 12:30 a.m. 11-25-76.

RECEIVED  
STATE CORPORATION COMMISSION

NOV 30 1976  
11/30/76

CONSERVATION DIVISION  
Wichita, Kansas

(If additional description is necessary, use BACK of this sheet)

Name of Plugging Contractor Earl Flanders

STATE OF Kansas COUNTY OF Sedgwick ss.  
Jack L. Partridge, Asst. Sec.-Treas. (employee of owner) or (owner or operator) of the above-described

well, being first duly sworn on oath, says: That I have knowledge of the facts, statements, and matters herein contained and the log of the above-described well as filed and that the same are true and correct. So help me God.

(Signature) Jack L. Partridge  
801 Union Center, Wichita, Kansas 67202  
(Address)

Subscribed and sworn to before me this 29th day of November 19 76

My commission expires

Kathy S. Goertz  
Kathy S. Goertz Notary Public.



CONTRACTOR'S WELL LOG

OPERATOR: The Maurice L. Brown Co.  
 CONTRACTOR: Abercrombie Drilling, Inc.  
 WELL NAME: TOLL #1  
 LOCATION: SE SW SE, Section 10-8S-25W  
 Graham County, Kansas  
 SPUD DATE: November 15, 1976  
 COMPLETION DATE: November 25, 1976

0	20	Clay & Sand
20	50	Rock
50	900	Shale
900	970	Sand
970	1485	Shale
1485	1620	Shale & Sand
1620	1810	Sand
1810	2056	Shale
2056	2088	Anhydrite
2088	2768	Shale
2768	3500	Shale & Lime
3500	3900	Lime
	3900	Rotary Total Depth

Spud at 5:45 p.m. 11-15-76. Drilled 255' of 12 1/4" hole. Ran 6 jts. of new 8 5/8" surface pipe (Tally 243.87') Set at 253.87'. Cemented with 190 sx. of Class "A" Common Cement, 2% gel, 3% Ca. Cl. Cement did circulate. Plug was down at 10:10 p.m. 11-15-76.

T.D. 3900', Set 1st plug at 950' with 70 sx., 2nd plug at 250' with 20 sx., 3rd plug at 40' with 10 sx. Job complete at 12:30 a.m. 11-25-76.

SAMPLE TOPS:  
 Anhydrite 2056'  
 B/Anhydrite 2088'

RECEIVED  
 NOV 30 1976 11/30/76  
 CONSERVATION DIVISION  
 Wichita, Kansas

STATE OF KANSAS )  
 ) SS  
 COUNTY OF SEDGWICK )

Jack L. Partridge, Assistant Secretary Treasurer of Abercrombie Drilling, Inc., does hereby state that the above and foregoing is a true and correct copy of the log of the TOLL #1, SE SW SE, Section 10-8S-25W, Graham County, Kansas.

ABERCROMBIE DRILLING, INC.

COPY

BY: Jack L. Partridge  
 Jack L. Partridge, Asst. Sec.-Treas.

Subscribed and sworn to before me, a Notary Public, in and for the aforesaid county and state as of this 29th day of November, 1976.

 KATHY S. GOERTZ  
 Sedgwick County, Ks.  
 My Appt Exp. 10-5-80

Kathy S. Goertz  
 Kathy S. Goertz, Notary Public