

STATE CORPORATION COMMISSION OF KANSAS
OIL & GAS CONSERVATION DIVISION
WELL COMPLETION OR RECOMPLETION FORM
ACO-1 WELL HISTORY
DESCRIPTION OF WELL AND LEASE

API NO. 15-065-22,454-00-00
County...GRAHAM
N. 1/4 N. 2 SW 28 Sec 28 Twp 8 S Rge 24 East West

Operator: License # 7448
Name Burch, EXPIRATION F.N.C.
Address 11275 E. 1st Box 96, W.B.Y.
City/State/Zip PARKER, CO. 66134

2325 Ft North from Southeast Corner of Section
4950 Ft West from Southeast Corner of Section
(Note: Locate well in section plat below)

Purchaser...CLEER - C. P. R. K.

Lease Name...SHIER, K. O. K. Well # 1
Field Name...HOLLY NORTH

Operator Contact Person...DAVID Burch
Phone 303-711-4417

Producing Formation...HANSING K.G.
Elevation: Ground 2371 KB 2376

Contractor: License # 4073
Name WESTERN KANSAS DRILLING CO.

Wellsite Geologist...RON MACEY
Phone 303-573-6634

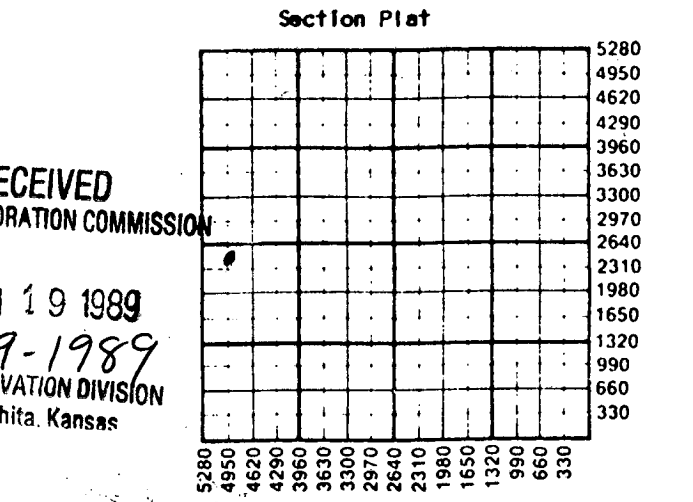

RECEIVED
STATE CORPORATION COMMISSION
JAN 19 1989
CONSERVATION DIVISION
Wichita, Kansas

Designate Type of Completion
X New Well Re-Entry Workover
X Oil SWD Temp Abd
Gas Inj Delayed Comp
Dry Other (Core, Water Supply etc.)

If ONWO: old well info as follows:
Operator
Well Name
Comp. Date Old Total Depth

WATER SUPPLY INFORMATION
Disposition of Produced Water: X Disposal
Docket # Repressuring

WELL HISTORY
Drilling Method: X Mud Rotary Air Rotary Cable
5-19-88 5-29-88 6-13-88
Spud Date Date Reached TD Completion Date
4415 3939
Total Depth PBTD

Questions on this portion of the ACO-1 call:
Water Resources Board (913) 296-3717
Source of Water:
Division of Water Resources Permit #
Groundwater...Ft North from Southeast Corner (Well) ...Ft West from Southeast Corner of Sec Twp Rge East West
Surface Water...Ft North from Southeast Corner (Stream, pond etc)...Ft West from Southeast Corner Sec Twp Rge East West
Other (explain) (purchased from city, R.W.D. #)

Amount of Surface Pipe Set and Cemented at 232 feet
Multiple Stage Cementing Collar Used? Yes X No
If yes, show depth set...feet
If alternate 2 completion, cement circulated from...feet depth to...w...SX cmt
Cement Company Name...HALL'S DRILLING
Invoice # 614134

INSTRUCTIONS: This form shall be completed in triplicate and filed with the Kansas Corporation Commission, 200 Colorado Derby Building, Wichita, Kansas 67202, within 120 days of the spud date of any well. Rule 82-3-130, 82-3-107 and 82-3-106 apply. Information on side two of this form will be held confidential for a period of 12 months if requested in writing and submitted with the form. See rule 82-3-107 for confidentiality in excess of 12 months. One copy of all wireline logs and drillers time log shall be attached with this form. Submit CP-4 form with all plugged wells. Submit CP-111 form with all temporarily abandoned wells.

All requirements of the statutes, rules and regulations promulgated to regulate the oil and gas industry have been fully complied with and the statements herein are complete and correct to the best of my knowledge.

Signature...David Burch
Title...G.M. Date 1/17/89

K.C.C. OFFICE USE ONLY
F Letter of Confidentiality Attached
C Wireline Log Received
C Drillers Timelog Received
Distribution
KCC SWD/Rep NGPA
KGS Plug Other (Specify)
1-19-89 X(4)

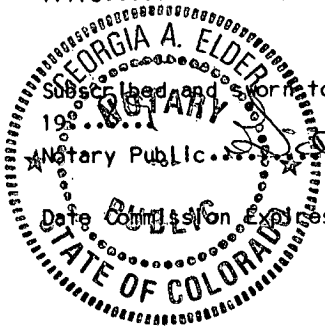

Subscribed and sworn to before me this...day of...
Notary Public...Georgia A. Elder
Date... My Commission Expires 7-25-92

Sec 28 Twp 8 Rge 24W

15-065-22454-00-00

SIDE TWO

Operator Name Burch Exploration Inc. Lease Name Shierkolk Well # 1

Sec 28 Twp 8 S Rge 24 W East West County GRAHAM

WELL LOG

INSTRUCTIONS: Show important tops and base of formations penetrated. Detail all cores. Report all drill stem tests giving interval tested, time tool open and closed, flowing and shut-in pressures, whether shut-in pressure reached static level, hydrostatic pressures, bottom hole temperature, fluid recovery, and flow rates if gas to surface during test. Attach extra sheet if more space is needed. Attach copy of log.

Drill Stem Tests Taken Yes No
Samples Sent to Geological Survey Yes No
Cores Taken Yes No

Formation Description Log Sample

TEST #1 - 3710-3730(LKC) 15-30-45-60 REC 310' GIP, 120' F.O., 186' OCMW, 124' OCW, 1000' W. SIP 1210-1201, FP 105-261/300-669 HP 1993-1953
TEST #2 3736-3750(LKC) PACKER FAILURE
TEST #3 3730-3750(LKC) 15-30-60-75, REC 310' GIP 80' F.O., 40' MCO, SIP 1042-1004, FP 45-45/55-55, HP 2030-1984
TEST #4 3761-3775(LKC) 20-40-80-120, REC 180' GIP 20' F.O., 40' OCM, 60' OSMW. SIP 1175-1036 FP. 30-30/36-72 HP. 2077-1964
TEST #5 3798-3830(LKC) 15-30-45-60, REC 120' GIP 15' F.O., 145' OCMW, 240' SOCMW, 1116 SOCW. SIP. 1385-1375, FP 152-343/343-706 HP 2026-2017
TEST #6, 3879-3891(LKC) 15-30-60-75, REC 630' GIP 120' F.O., 62' MCO, 124' OCW, 372 OSW SIP 1343-1298, FP 62-92/132-306, HP 3435-3298

Name	Top	Bottom
ANHYDRITE	2060'	
HEEBNER	3652'	
LANSING	3692'	
BASE LKC	3914'	
MARMATON	4,022'	
MISSISSIPPIAN	4,200'	
XIOLA	4,290'	
ARBUCKLE	4,410'	

NO PRODUCTION RECORDED

CASING RECORD New Used Report all strings set-conductor, surface, intermediate, production, etc.

Purpose of String	Size Hole Drilled	Size Casing Set (in O.D.)	Weight Lbs/Ft.	Setting Depth	Type of Cement	#Sacks Used	Type and Percent Additives
Surface	12 1/4"	5 7/8"	24 lbs	232'	POZ MIX	250	
Production	7 7/8"	5 1/2"	13.5	3911'	HEB	255	8% GEL
					EF-2	110	60/40 POZ MIX

PERFORATION RECORD Specify Footage of Each Interval Perforated Acid, Fracture, Shot, Cement Squeeze Record (Amount and Kind of Material Used) Depth

Shots Per Foot	Specify Footage of Each Interval Perforated	Acid, Fracture, Shot, Cement Squeeze Record (Amount and Kind of Material Used)	Depth
4 shots	3880-3886 T.R.	100% POZ	3880-3886
4 "	3768-3774 T.R.	100% POZ	3768-3774

TUBING RECORD Size 2 7/8 Set At 3792 Packer at 3792 Liner Run Yes No

Date of First Production _____ Producing Method Flowing Pumping Gas Lift Other (explain).....

Estimated Production Per 24 Hours	Oil Bbls	Gas MCF	Water Bbls	Gas-Oil Ratio	Gravity
	123	0	80		

METHOD OF COMPLETION Production Interval

Disposition of gas: Vented Open Hole Perforation Sold Other (Specify) Used on Lease Dually Completed Commingled