

STATE CORPORATION COMMISSION OF KANSAS  
OIL & GAS CONSERVATION DIVISION  
WELL COMPLETION OR RECOMPLETION FORM  
ACO-1 WELL HISTORY  
DESCRIPTION OF WELL AND LEASE

API NO. 15-..... 065-22,473-00-00

County Graham

NE NE SE 29 Twp 85 Rge 24 East X West

2310 Ft North from Southeast Corner of Section  
230 Ft West from Southeast Corner of Section  
(Note: Locate well in section plat below)

Lease Name Keith A Well # 1

Field Name Holly North Holly North

Producing Formation LANSING

Elevation: Ground 2407 KB 2402

Operator: License # 7448  
Name Bur. Ch. Exploration, Inc.  
Address 11225 E. LINCOLN BLVD. WY.  
City/State/Zip PARKER, CO. 80134

Purchaser Cheer-Creek

Operator Contact Person David J. Burch  
Phone 303-511-9417

Contractor: License # 4083  
Name WESTERN KANSAS DRILLING INC.

Wellsite Geologist RON MACKAY  
Phone 303-513-6634

Designate Type of Completion  
 New Well  Re-Entry  Workover  
 Oil  SWD  Temp Abd  
 Gas  Inj  Delayed Comp  
 Dry  Other (Core, Water Supply etc)

If ONNO: old well info as follows:  
Operator .....  
Well Name .....  
Comp. Date ..... Old Total Depth.....

WELL HISTORY  
Drilling Method:  
 Mud Rotary  Air Rotary  Cable  
7-8-88 7-15-88 8-11-88  
Spud Date Date Reached TD Completion Date  
4438 3970  
Total Depth PBTD

Amount of Surface Pipe Set and Cemented at 203 feet  
Multiple Stage Cementing Collar Used?  Yes  No  
If yes, show depth set.....feet  
If alternate 2 completion, cement circulated from.....feet depth to.....w/.....SX cmt  
Cement Company Name .....  
Invoice # .....

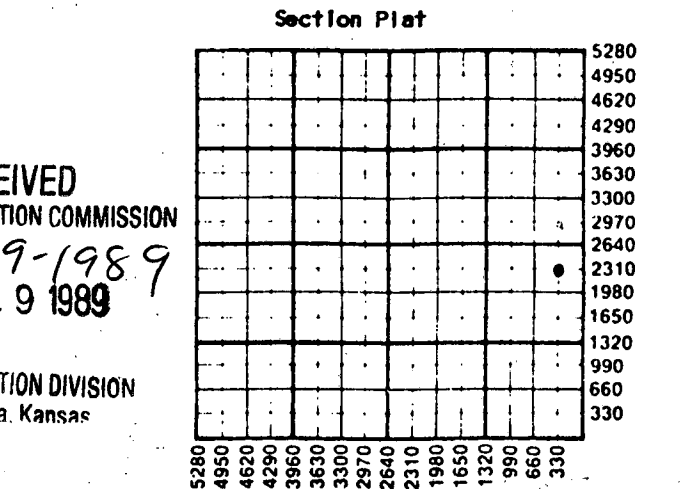

WATER SUPPLY INFORMATION  
Disposition of Produced Water:  Disposal  Repressuring  
Docket # .....

Questions on this portion of the ACO-1 call:  
Water Resources Board (913) 296-3717  
Source of Water:  
Division of Water Resources Permit #.....  
 Groundwater.....Ft North from Southeast Corner (Well) .....Ft West from Southeast Corner of Sec Twp Rge East West  
 Surface Water.....Ft North from Southeast Corner (Stream, pond etc).....Ft West from Southeast Corner Sec Twp Rge East West  
 Other (explain).....  
(purchased from city, R.W.D. #)

INSTRUCTIONS: This form shall be completed in triplicate and filed with the Kansas Corporation Commission, 200 Colorado Derby Building, Wichita, Kansas 67202, within 120 days of the spud date of any well. Rule 82-3-130, 82-3-107 and 82-3-106 apply. Information on side two of this form will be held confidential for a period of 12 months if requested in writing and submitted with the form. See rule 82-3-107 for confidentiality in excess of 12 months. One copy of all wireline logs and drillers time log shall be attached with this form. Submit CP-4 form with all plugged wells. Submit CP-111 form with all temporarily abandoned wells.

All requirements of the statutes, rules and regulations promulgated to regulate the oil and gas industry have been fully complied with and the statements herein are complete and correct to the best of my knowledge.

Signature David Burch  
Title GM Date 1/17/89

Subscribed and sworn to before me this 17 day of Jan  
Georgia A. Dore  
My Commission Expires 7-25-92

K.C.C. OFFICE USE ONLY  
F  Letter of Confidentiality Attached  
C  Wireline Log Received  
C  Drillers Timelog Received  
Distribution  
 KCC  SWD/Rep  NGPA  
 KGS  Plug  Other  
(Specify)  
1-19-89 (4)

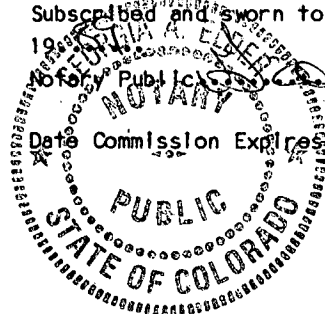

Sec 29 Twp 8 Rge 24

15-065-22473-00-00

SIDE TWO

Operator Name Burch Exploration Inc. Lease Name Keith A Well # 1

Sec. 29 Twp. S 5 Rge. 24  East  West

County GRAHAM

WELL LOG

INSTRUCTIONS: Show important tops and base of formations penetrated. Detail all cores. Report all drill stem tests giving interval tested, time tool open and closed, flowing and shut-in pressures, whether shut-in pressure reached static level, hydrostatic pressures, bottom hole temperature, fluid recovery, and flow rates if gas to surface during test. Attach extra sheet if more space is needed. Attach copy of log.

Drill Stem Tests Taken  Yes  No  
Samples Sent to Geological Survey  Yes  No  
Cores Taken  Yes  No

Formation Description  Log  Sample

TEST #1 3747'-3763'(LKC) 15-30-30-45, REC 30' F.O.  
120' OCM, 180' OCW SIP 1227-2027,  
FP 86-100/144-182, HP 2083-2027  
TEST #2 3761-3788(LKC) 20-40-60-75, REC 45' F.O.  
160' OCM, 240' OCW, SIP 1242-1221  
FP 77-94/127-199 HP 2121-2175  
TEST #3 3793-3803(LKC) 20-40-70-80, REC 2' F.O.  
28' OCM, SIP 1082-1077, FP 48-48/54-54  
N.P. 2092-2044  
TEST #4 3835-3860(LKC) 15-30-45-60, REC 240 GIP  
25' F.O., 95' OCM, 240' W, SIP 1288-1288  
FP 104-123/130-196, HP 2127-2100  
TEST #5 3886-3908(LKC) 10-20-20-30, REC 60' OCM  
240' OCMW, 960' W, SIP 1200-1114  
FP 173-211/278-403 HP 2046-2036  
TEST #6 3912-3927(LKC) 15-30-30-45, REC 280 GIP  
160' F.O. 120' OCMW, 240' SW, SIP 1268-1254  
FP 119-134/172-235 HP 2161-2137

Name	Top	Bottom
Anhydrite	2103	
Hebner	3687	
TORONTO	3713	
LANSING	3726	
BASE LKC	3951	

CASING RECORD <input type="checkbox"/> New <input type="checkbox"/> Used Report all strings set-conductor, surface, intermediate, production, etc.							
Purpose of String	Size Hole Drilled	Size Casing Set (In O.D.)	Weight Lbs./Ft.	Setting Depth	Type of Cement	#Sacks Used	Type and Percent Additives
SURFACE	12 1/4	8 5/8	2.8	225'	PO2 MIX	250	
PRODUCTION	7 7/8	5 1/2	14.5	4438'	HDL PO2 MIX REGULAR	255 180	EA 5% CALSEAL 18% SALT
PERFORATION RECORD				Acid, Fracture, Shot, Cement Squeeze Record			
Shots Per Foot	Specify Footage of Each Interval Perforated			(Amount and Kind of Material Used)		Depth	
4	3928 To 3912			2.00 2.00 1.50 1.50 1.50			
4	3918 To 3870			1.00 " " " "			
4	3856 To 3860			2.00 " " " "			
4	3808 To 3804			1.00 " " " "			
TUBING RECORD				Liner Run <input type="checkbox"/> Yes <input type="checkbox"/> No			
Date of First Production		Size <u>2 7/8</u> Set At		Packer at <u>3841</u>			
<u>8-18-1988</u>		Producing Method <input type="checkbox"/> Flowing <input checked="" type="checkbox"/> Pumping <input type="checkbox"/> Gas Lift <input type="checkbox"/> Other (explain).....					
Estimated Production Per 24 Hours		Oil	Gas	Water	Gas-Oil Ratio	Gravity	
73 Bbls			0 MCF	20 Bbls	CFPB	27 60	

METHOD OF COMPLETION  Open Hole  Perforation  
Disposition of gas:  Vented  Sold  Used on Lease  
 Other (Specify) .....  
 Dually Completed  Commingled